

HITACHI

LIST NO. 0338

ELECTRIC TOOL PARTS LIST

■ BELT SANDER
Model SB 10T

1993 · 10 · 1
(E3)

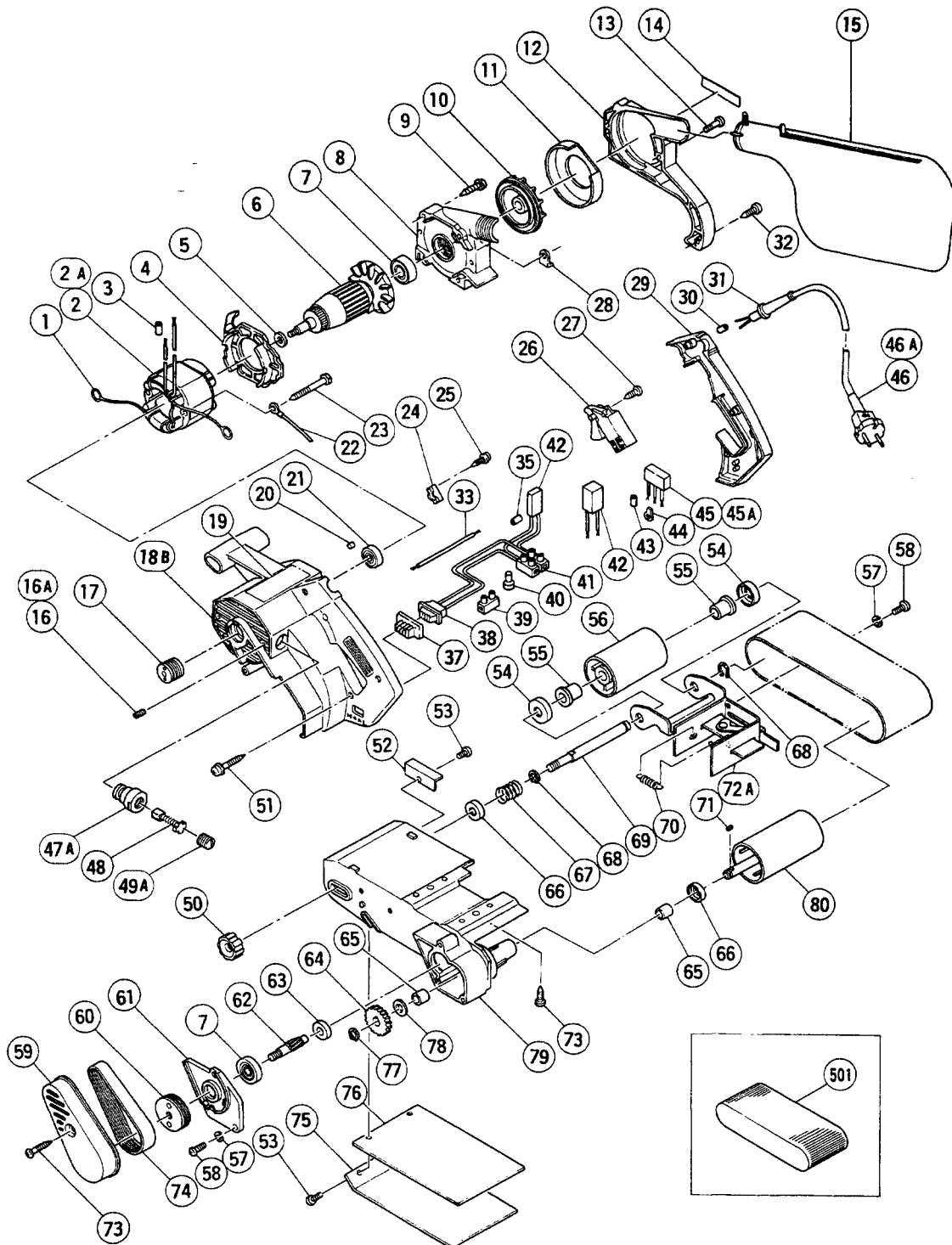

PARTS

SB 10T

ITEM NO.	CODE NO.	DESCRIPTION	NO. USED	REMARKS
1	930-703	BRUSH TERMINAL	2	
*	2	340-104C	1	INCLUD.1,3
*	2	340-104D	1	INCLUD.1,3
	2	340-104E	1	INCLUD.1,3
	2	340-104F	1	INCLUD.1,3
*	2	340-104K	1	INCLUD.1 FOR SUI,NZL
*	2	953-142J	1	INCLUD.1 FOR FIN
*	2	953-142H	1	INCLUD.1 FOR GBR
*	2	953-142K	1	INCLUD.1 FOR GBR
*	2A	340-104L	1	INCLUD.1 FOR ITA,FRG,FRA,HOL,DEN,POR, ESP,SWE,AUT,SAF,NOR
	3	981-373	1	TUBE (D)
	4	953-185	1	FAN GUIDE
	5	954-234	1	BEARING WASHER (B)
*	6	953-145U	1	ARMATURE ASS'Y 110V - 115V INCLUD.5,7,21
*	6	953-145D	1	ARMATURE 120V - 127V
*	6	953-145E	1	ARMATURE 220V
*	6	953-145F	1	ARMATURE 230V - 240V FOR KUW,NGU,AUS,GBR,ITA,FRG,HOL,DEN, SWE,AUT,NOR,ESP
	7	620-0VV	2	BALL BEARING 6200VVCMP2S
	8	953-146	1	INNER COVER
	9	986-011	4	TAPPING SCREW (W/SP. WASHER) D5X30
	10	953-053	1	DUST FAN
	11	953-158	1	DUST GUIDE
	12	953-157	1	DUST COVER
	13	949-223	2	MACHINE SCREW M4X25 (10 PCS.)
	14	957-561	1	HITACHI LABEL
	15	953-078	1	DUST BAG
	16	932-668	2	HEX. SOCKET SET SCREW M4X10 TILL 8.1988
	16A	938-477	2	HEX. SOCKET SET SCREW M5X8 SINCE 7.1988
	17	987-532	1	PULLEY (A)
	18B	985-590	1	HOUSING ASS'Y INCLUD.16A,47A
	19		1	NAME PLATE
	20	931-701	1	BEARING LOCK
	21	629-VVM	1	BALL BEARING 629VVMC2EPS2L
*	22	953-033	1	INTERNAL WIRE FOR SUI
*	22	961-421Z	1	INTERNAL WIRE FOR FIN
	23	953-174	2	HEX. HD. TAPPING SCREW D5X55
	24	937-631	1	CORD CLIP
	25	984-750	2	TAPPING SCREW (W/FLANGE) D4X16
*	26	931-573	1	SWITCH (2P PILLAR TYPE) W/LOCK
*	26	953-178	1	SWITCH (2P PILLAR TYPE) W/SAFETY LOCK FOR FRA
	27	954-017	1	TAPPING SCREW D4X12
	28	953-169	1	PLATE
	29	953-164	1	HANDLE COVER
*	30	981-373	2	TUBE (D) FOR CORD
*	31	958-049Z	1	CORD ARMOR D8.2
*	31	940-778	1	CORD ARMOR D10.7
	32	958-705	1	TAPPING SCREW D4X25
	33		1	INTERNAL WIRE
	35	981-373	1	TUBE (D)

*: ALTERNATIVE PARTS

PARTS

SB 10T

ITEM NO.	CODE NO.	DESCRIPTION	NO. USED	REMARKS	
	37	971 - 792	SLIDE SWITCH COVER	1	
*	38	953 - 171	SLIDE SWITCH (1P SOLDER TYPE)	1	
*	38	995 - 582	SLIDE SWITCH (1P SOLDER TYPE)	1	FOR USA
*	39	938 - 307Z	PILLAR TERMINAL	1	FOR FIN
	40	859 - 140	CONNECTOR 50091 (10 PCS.)	2	
*	41	958 - 308Z	PILLAR TERMINAL (A)	1	FOR USA
*	42	956 - 613	DIODE 100V - 127V	1	
*	42	956 - 614	DIODE 200V - 240V	1	
*	42	953 - 250P	DIODE 115V	1	FOR CAN,USA
*	42		CONTROLLER CIRCUIT 240V	1	FOR AUS
*	43	981 - 373	TUBE (D)	2	FOR NOISE SUPPRESSOR
*	44	938 - 108	TERMINAL	1	FOR NOISE SUPPRESSOR
*	45	980 - 283Z	NOISE SUPPRESSOR	1	FOR SUI
*	45A	994 - 273	NOISE SUPPRESSOR	1	
*	46	500 - 201Z	CORD	1	(CORD ARMOR D10.7)
*	46	500 - 223Z	CORD	1	(CORD ARMOR D10.7) FOR KUW SIN
*	46	500 - 226Z	CORD	1	(CORD ARMOR D8.2) FOR NGU,NZL,AUS
*	46	500 - 231Z	CORD	1	(CORD ARMOR D8.2) FOR SAF
*	46	500 - 234Z	CORD	1	(CORD ARMOR D8.2) FOR ITA,FRG,FRA, HOL,DEN,AUT,INA,SUR
*	46	500 - 237Z	CORD	1	(CORD ARMOR D8.2) FOR GBR (110V)
*	46	500 - 240Z	CORD	1	(CORD ARMOR D8.2) FOR USA,CAN
*	46	500 - 245Z	CORD	1	(CORD ARMOR D10.7) FOR SYR
*	46	500 - 247Z	CORD	1	(CORD ARMOR D10.7) FOR FIN,SWE,NOR
*	46	500 - 248Z	CORD	1	(CORD ARMOR D10.7) FOR SUI
*	46A	500 - 435Z	CORD	1	(CORD ARMOR D8.2) FOR GBR (240V)
	47A	958 - 900	BRUSH HOLDER	2	
	48	999 - 043	CARBON BRUSH (1 PAIR)	2	
	49A	945 - 181	BRUSH CAP	2	
	50	995 - 578	KNOB NUT	1	
	51	956 - 636	TAPPING SCREW (W/WASHER) D4X25	3	
	52	953 - 158	STRIKING GUIDE	1	
	53	949 - 216	MACHINE SCREW M4X10 (10 PCS.)	3	
	54	953 - 043	WASHER	2	
	55	953 - 042	METAL	2	
	56	995 - 586	IDLE PULLEY ASS'Y	1	INCLUD.55
	57	949 - 453	SPRING WASHER M4 (10 PCS.)	5	
	58	949 - 218	MACHINE SCREW M4X14 (10 PCS.)	5	
	59	953 - 155	BELT COVER	1	
	60	953 - 154	PULLEY (B)	1	
	61	953 - 153	GEAR COVER	1	
	62	953 - 152	PINION	1	
	63	935 - 522	METAL	1	
	64	995 - 576	GEAR	1	
	65	953 - 175	METAL D10X14X12	2	
	66	953 - 161	WASHER	2	
	67	995 - 577	SPRING	1	
	68	939 - 542	RETAINING RING FOR D12 SHAFT (10 PCS.)	2	
	69	995 - 587	SHAFT	1	
	70	953 - 083	SPRING	1	
	71	944 - 109	FEATHER KEY 3X3X8	1	

*: ALTERNATIVE PARTS

PARTS

SB 10T

ITEM NO.	CODE NO.	DESCRIPTION	NO. USED	REMARKS
72A	995-585	FORK ASS'Y	1	INCLUD.70
73	954-004	TAPPING SCREW D4X16	5	
74	958-874	BELT	1	
75	995-580	SHOE PLATE	1	
76	995-579	SHOE CUSHION	1	
77	939-540	RETAINING RING FOR D10 SHAFT (10 PCS.)	1	
78	948-213	WASHER (B) D19	1	
79	995-581	BODY ASS'Y	1	INCLUD.63,65
80	995-575	DRIVE PULLEY	1	

STANDARD ACCESSORIES

ITEM NO.	CODE NO.	DESCRIPTION	NO. USED	REMARKS
501	995-552	SANDING BELTS 100X610 WA80 (10 PCS.)	1	

OPTIONAL ACCESSORIES

ITEM NO.	CODE NO.	DESCRIPTION	NO. USED	REMARKS
601	995-574	SANDING FRAME ASS'Y	1	INCLUD.602 - 606
602	995-583	ADJUSTING BOLT	1	
603	993-843	KNOB BOLT M6X14	1	
604	951-039	MACHINE SCREW (W/SP. WASHER) M4X12	2	
605	995-588	BOTTOM PLATE (A)	2	
606	995-589	BOTTOM PLATE (B)	4	
607	995-550	SANDING BELTS 100X610 WA40 (10 PCS.)	1	
608	995-551	SANDING BELTS 100X610 WA60 (10 PCS.)	1	
609	995-553	SANDING BELTS 100X610 WA100 (10 PCS.)	1	
610	995-554	SANDING BELTS 100X610 WA120 (10 PCS.)	1	
611	995-555	SANDING BELTS 100X610 WA150 (10 PCS.)	1	
612	995-556	SANDING BELTS 100X610 WA180 (10 PCS.)	1	
613	995-557	SANDING BELTS 100X610 WA240 (10 PCS.)	1	
614	995-558	SANDING BELTS 100X610 AA40 (10 PCS.)	1	
615	995-559	SANDING BELTS 100X610 AA60 (10 PCS.)	1	
616	995-580	SANDING BELTS 100X610 AA80 (10 PCS.)	1	
617	995-561	SANDING BELTS 100X610 AA100 (10 PCS.)	1	
618	995-562	SANDING BELTS 100X610 AA120 (10 PCS.)	1	
619	995-563	SANDING BELTS 100X610 AA150 (10 PCS.)	1	
620	995-564	SANDING BELTS 100X610 AA180 (10 PCS.)	1	
621	995-565	SANDING BELTS 100X610 AA240 (10 PCS.)	1	
622	995-566	SANDING BELTS 100X610 CC40 (10 PCS.)	1	
623	995-567	SANDING BELTS 100X610 CC60 (10 PCS.)	1	
624	995-568	SANDING BELTS 100X610 CC80 (10 PCS.)	1	
625	995-569	SANDING BELTS 100X610 CC100 (10 PCS.)	1	
626	995-570	SANDING BELTS 100X610 CC120 (10 PCS.)	1	
627	995-571	SANDING BELTS 100X610 CC150 (10 PCS.)	1	
628	995-572	SANDING BELTS 100X610 CC180 (10 PCS.)	1	
629	995-573	SANDING BELTS 100X610 CC240 (10 PCS.)	1	

*: ALTERNATIVE PARTS