



SERVICE PARTS LIST

BULLETIN NO.
54-07-9005

SPECIFY CATALOG NO. AND SERIAL NO. WHEN ORDERING PARTS		REVISED BULLETIN	DATE
MX FUEL™ PORTABLE BATTERY EXTENSION			July 2024
CATALOG NO. MXF010	SERIAL NO. P08A	WIRING INSTRUCTION See Page 5	

SUB ASSEMBLY LISTING PAGE 2

QUICK RELEASE BACKPLATE PAGE 2

CONSOLE HOUSING ASSEMBLY PAGE 3

MOCK BATTERY ASSEMBLY PAGE 4

TORQUE SPECIFICATION CHART PAGE 4

WIRING PAGE 5

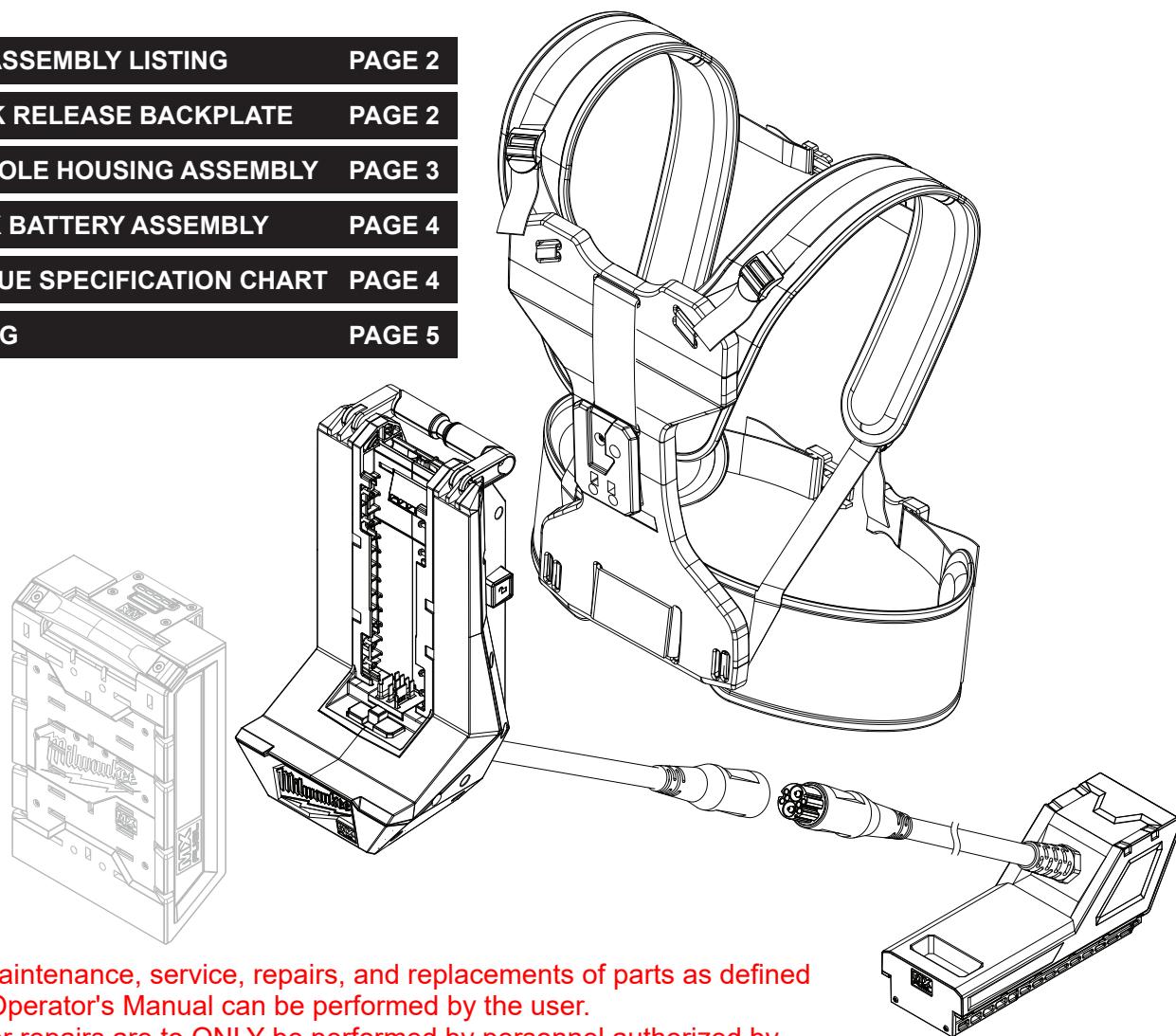

Only maintenance, service, repairs, and replacements of parts as defined in the Operator's Manual can be performed by the user.

All other repairs are to ONLY be performed by personnel authorized by MILWAUKEE TOOL. Do not attempt to install other parts; this COULD void your tool warranty.

For service, parts, or inquiries, contact us:

- Customer Service at 1.800.SAWDUST (1.800.729.3878)
- E-Service tool repair at: www.milwaukeetool.com/e-service
- Find a local authorized MILWAUKEE service location at Milwaukeetool.com
- Find a MILWAUKEE *factory* Service Center Location or MILWAUKEE *factory* Central Repair Center at Milwaukeetool.com. Send the following, posted paid and insured:
 - Your name, address, and phone number
 - Description of the issues
 - Copy of the proof of purchase
 - Tool, charger, and batteries involved with the issues

MILWAUKEE *factory* Central Repair Centers:

MILWAUKEE TOOL
Central Repair
1401 Sycamore Avenue
Greenwood, MS 38930

MILWAUKEE TOOL
Central Repair
2198 Southtech Drive
Greenwood, IN 46143

00 0

EXAMPLE:Component Parts (Small #) Are Included
When Ordering The Assembly (Large #).

FIG.	PART NO.	DESCRIPTION OF PART	NO. REQ.
1	-----	MX FUEL Console Housing, <i>See Page 3</i>	(1)
2	1008	MX FUEL Mock Battery, <i>See Page 4</i>	(1)
3	1000	MX FUEL Backpack Harness, <i>See Below</i>	(1)

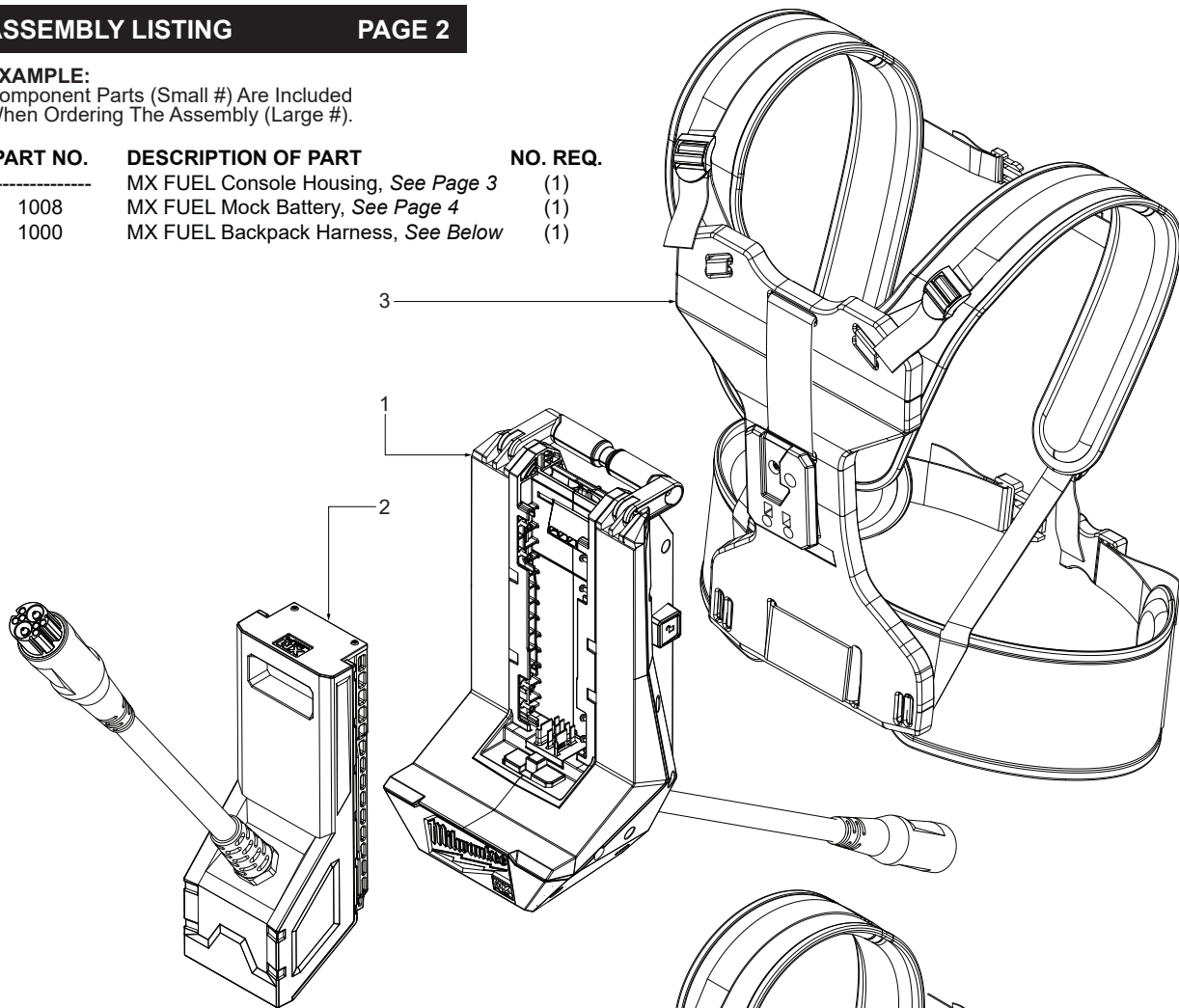

QUICK RELEASE BACKPLATE

PAGE 2

00 0

EXAMPLE:Component Parts (Small #) Are Included
When Ordering The Assembly (Large #).

FIG.	PART NO.	DESCRIPTION OF PART	NO. REQ.
1	06-82-0029	M5 x 16mm Pan Hd. ST T-25 Screw	(4)
2	-----	Backpack Attachment - Back Side	(1)
3	1000	Quick Release Backplate Assembly	(1)
4	-----	Backplate Shell	(1)
5	-----	Backplate Cover	(1)
6	05-88-1220	M4 x 10mm Pan Hd. ST T-20 Screw	(9)
7	45-56-5525	Backpack Harness	(1)
8	45-56-5535	Waist Belt	(1)
9	12-20-9953	Service Nameplate	(1)
10	14-46-9420	Backplate Service Assembly	(1)

00
0

EXAMPLE:
Component Parts (Small #) Are Included
When Ordering The Assembly (Large #).

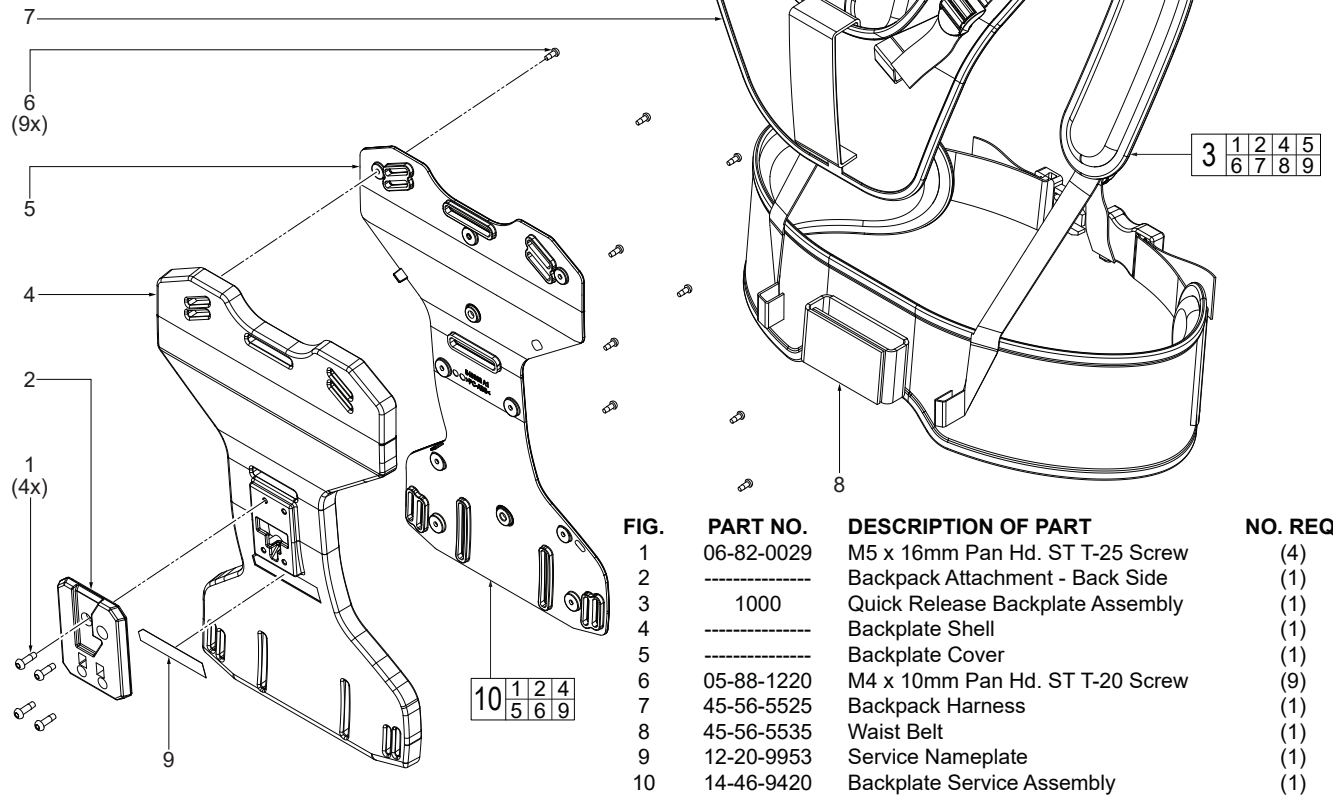
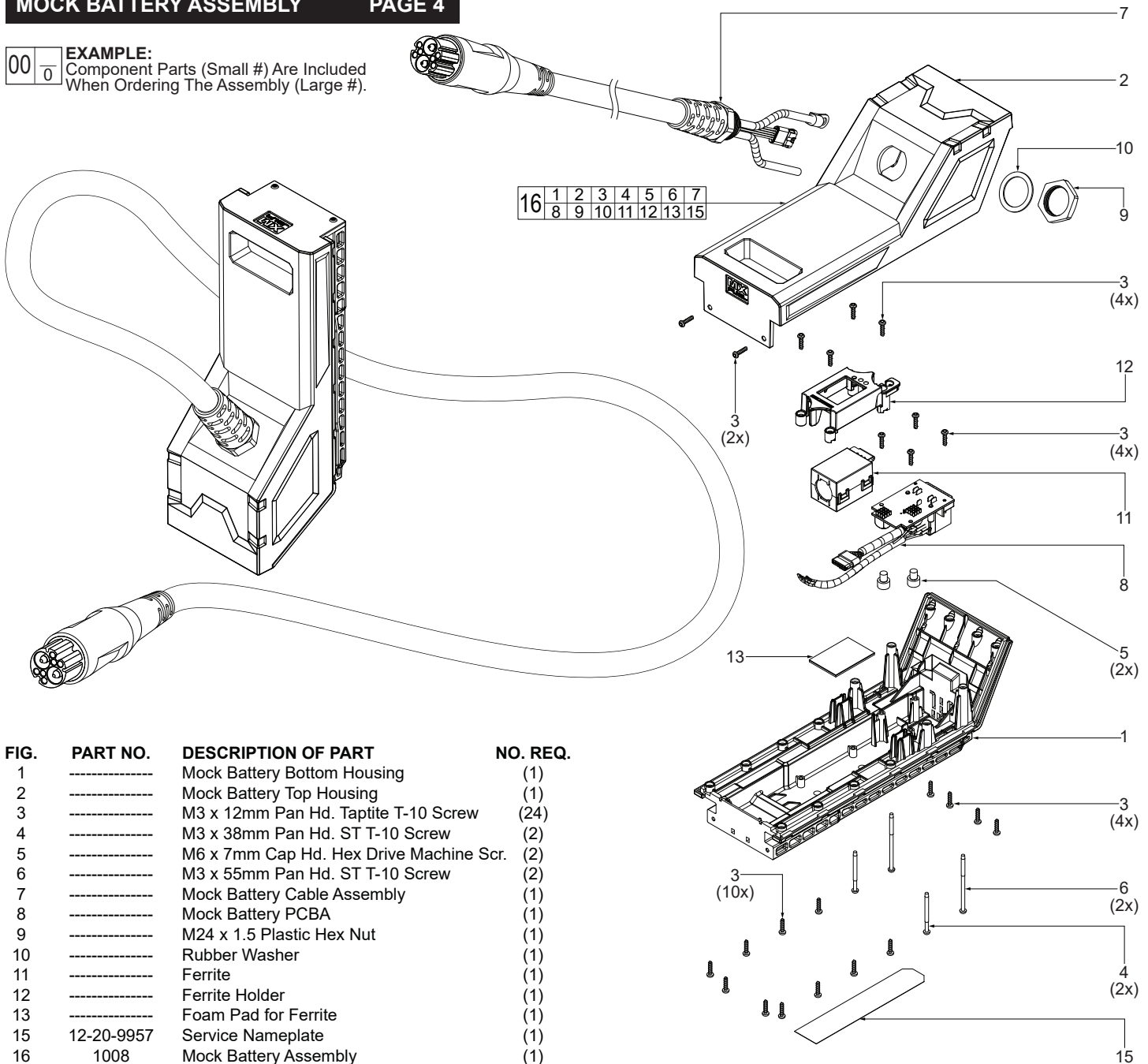
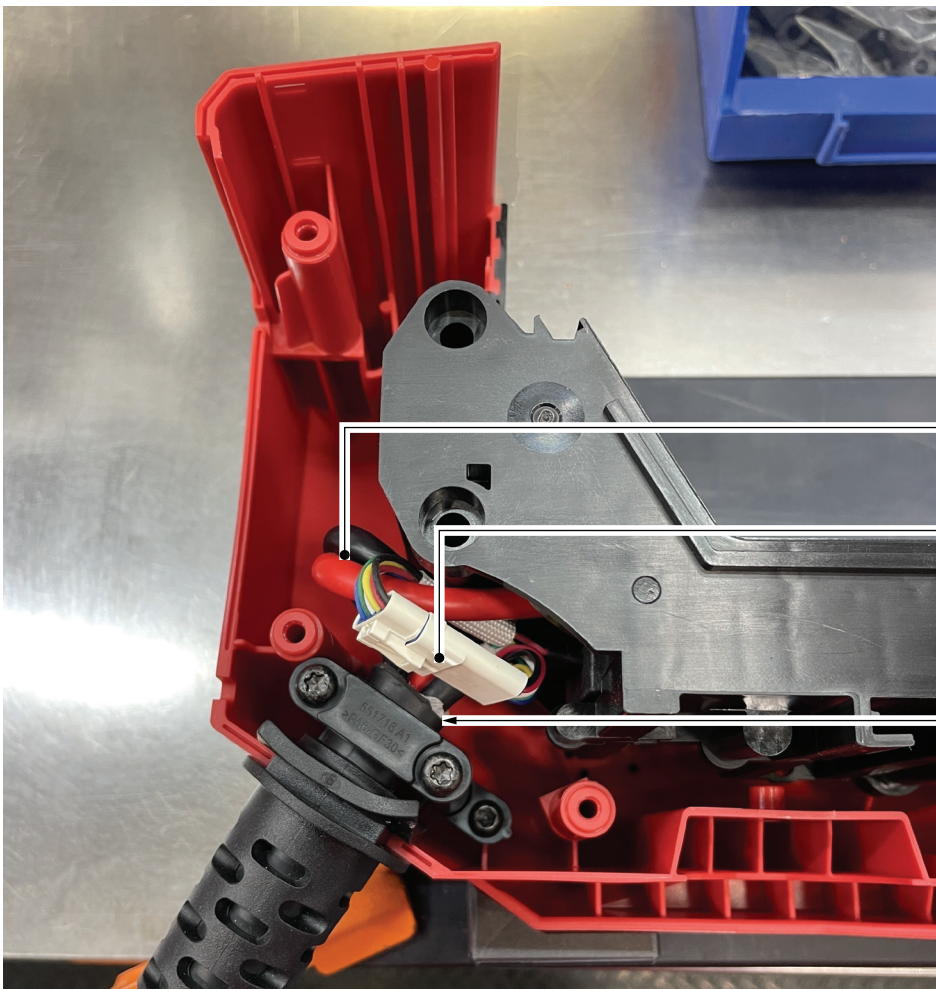

FIG.	PART NO.	DESCRIPTION OF PART	NO. REQ.
1	-----	Mock Battery Bottom Housing	(1)
2	-----	Mock Battery Top Housing	(1)
3	-----	M3 x 12mm Pan Hd. Taptite T-10 Screw	(24)
4	-----	M3 x 38mm Pan Hd. ST T-10 Screw	(2)
5	-----	M6 x 7mm Cap Hd. Hex Drive Machine Scr.	(2)
6	-----	M3 x 55mm Pan Hd. ST T-10 Screw	(2)
7	-----	Mock Battery Cable Assembly	(1)
8	-----	Mock Battery PCBA	(1)
9	-----	M24 x 1.5 Plastic Hex Nut	(1)
10	-----	Rubber Washer	(1)
11	-----	Ferrite	(1)
12	-----	Ferrite Holder	(1)
13	-----	Foam Pad for Ferrite	(1)
15	12-20-9957	Service Nameplate	(1)
16	1008	Mock Battery Assembly	(1)

SCREW TORQUE SPECIFICATIONS

FIG.	PART NO.	DESCRIPTION OF FASTENER	WHERE USED	SEAT TORQUE	
				(lb-in)	(kgf-cm)
PAGE 2	1	06-82-0029	M5 x 16mm Pan Hd. ST T-25 Screw	19.9-23.4	23-27
	6	05-88-1220	M4 x 10mm Pan Hd. ST T-20 Screw	8.6-10.4	10-12
PAGE 3	1-10	-----	M3 x 14mm Pan Hd. ST T-10 Screw	6.0-7.8	7-9
	1-16	-----	M5 x 16mm Pan Hd. ST T-25 Screw	13.0-16.4	15-19
	1-20	-----	M3 x 16mm Pan Hd. ST TP Screw	6.0-7.8	7-9
	1-24	05-88-0087	M5 x 115mm Pan Hd. PT T-20 Screw	19.9-23.4	23-27
	1-27	06-82-0152	M5 x 22mm Pan Hd. ST T-25 Screw	19.9-23.4	23-27
	1-28	06-82-0029	M5 x 16mm Pan Hd. ST T-25 Screw	19.9-23.4	23-24
	1-38	05-88-1220	M4 x 10mm Pan Hd. ST T-20 Screw	5.2-6.9	6-8
PAGE 4	3	-----	M3 x 12mm Pan Hd. Taptite T-10 Screw	6.0-7.8	7-9
	4	-----	M3 x 38mm Pan Hd. ST T-10 Screw	6.0-7.8	7-9
	5	-----	M6 x 7mm Cap Hd. Hex Dr. Mach. Scr.	23.4-28.6	27-33
	6	-----	M3 x 55mm Pan Hd. ST T-10 Screw	6.0-7.8	7-9
	9	-----	M24 x 1.5 Plastic Hex Nut	69.4-78.1	80-90



Be sure red and black wires are tucked down in the housing and away from screw bosses to prevent pinching.

It is important that the wire connectors are assembled properly. Make sure that connectors are seated firmly and squarely together.

Cord jacket to extend .25" minimum beyond cord clamp.