



## Operating Instructions and Parts Manual L-100 Series Hand Chain Hoists



For L100-200 serial no. 15070001 and higher  
For L100-300 serial no. 15070043 and higher  
For L100-1500 serial no. 15070088 and higher

*1-ton model shown*

**JET**  
427 New Sanford Road  
LaVergne, Tennessee 37086  
Ph.: 800-274-6848  
[www.jettools.com](http://www.jettools.com)

**Part No. M-106210**  
Revision D 08/2015  
Copyright © 2015 JET

# L-100 Chain Hoist Parts Breakdown

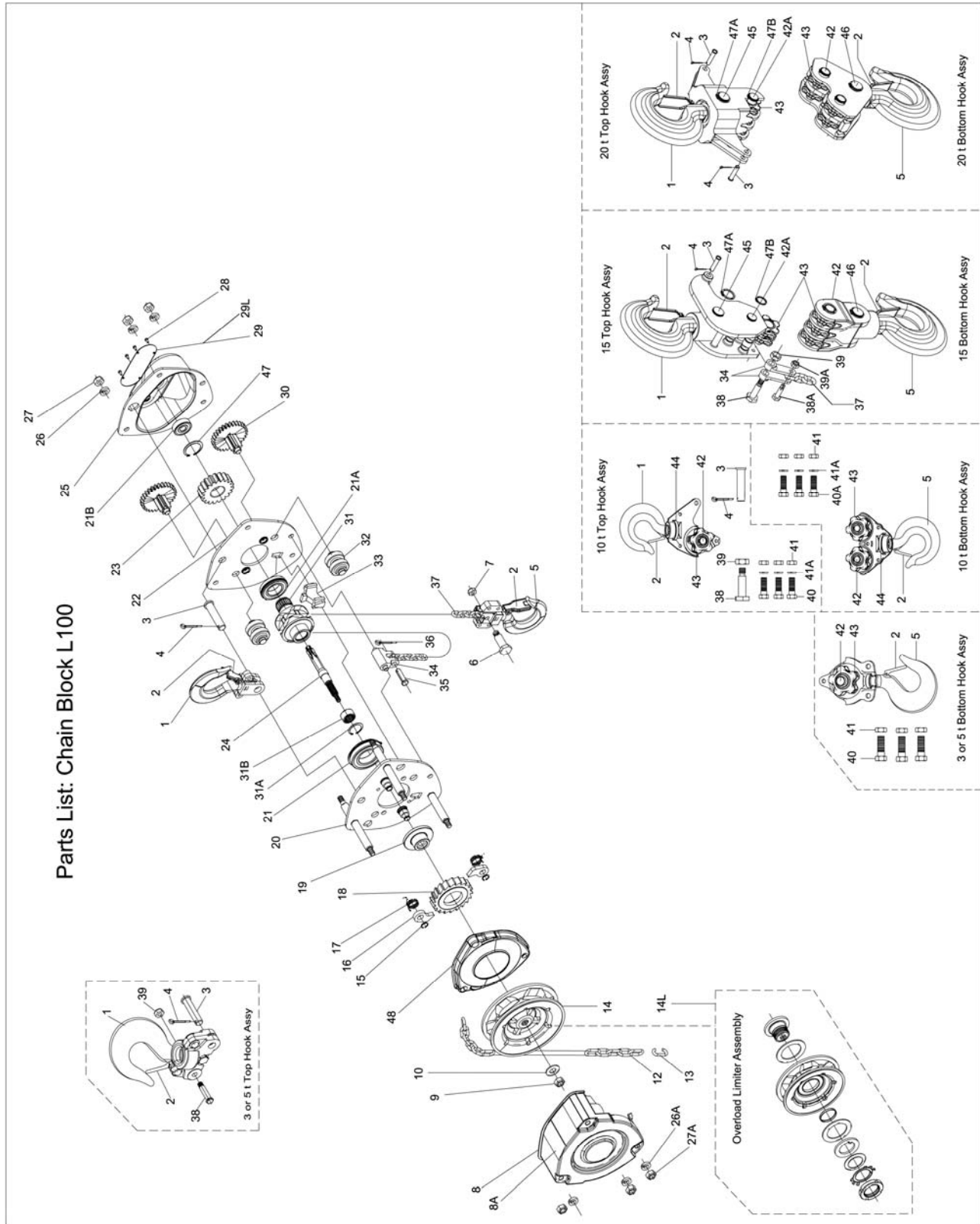

## Parts List: L100-25 Chain Hoist (0.25 Ton)

Parts listed under each assembly are parts that make up that assembly (sold as an assembly only).

Index No.	Part No.	Description	Size	Qty
1	L100-25-1	Top Hook Assembly		1
		Top Hook		1
		Safety Latch		1
		Double Spring		1
		Socket Head Cap Screw	M4x20	1
		Lock Nut	M4	1
		Top Hook Holder		1
		Rivet	4x14 mm	2
2	L100-25-2	Safety Latch Assembly		2
		Safety Latch		2
		Double Spring		2
		Socket Head Cap Screw	M4x20	2
		Lock Nut	M4	2
3	L100-25-3	Top Hook Shaft		1
4	L100-25-4	Split Pin	2.5x20 mm	1
5	L100-25-5	Bottom Hook Assembly		1
		Bottom Hook		1
		Safety Latch		1
		Double Spring		1
		Socket Head Cap Screw	M4x20	1
		Lock Nut	M4	1
		Rivet	5x20 mm	2
6	L100-25-6	Bottom Hook Shaft		1
7	F001752	Lock Nut (Black Oxide)	M5	1
8	L100-25-8G	Hand Wheel Cover Assembly		1
		Hand Wheel Cover		1
		Hand Chain Guide		2
8A	L100-25-8A	Warning Label		1
9	L100-25-9-1	Wheel Stopper	M6	1
10	L100-25-10-1	Wheel Washer		1
12	L100-25-12	Hand Chain – <i>specify length</i>	3x15 mm	1
13	L100-25-13	Hand Chain Connecting Link		1
14	L100-25-14-1	Hand Chain Wheel		1
14L	L100-25WO-14L	Overload Limiter Assembly ( <i>used on overload protection model</i> )		1
		Overload Limiter Knob		1
		Brake Disc		2
		Hand Chain Wheel		1
		Bushing in Hand Chain Wheel		1
		Disc Spring Plate		1
		Disc Spring		1
		Disc Spring Stopper		1
		Lock Nut		1
15	L100-25-15	Snap Ring	5 mm	2
16	L100-25-16	Pawl		2
17	L100-25-17	Pawl Spring		2
18	L100-25-18-1	Ratchet Disc Assembly		1
		Ratchet Disc		1
		Ratchet Bushing		1
19	L100-25-19-1	Disc Hub		1
20	L100-25-20-1	Wheel Side Plate Assembly		1
		Wheel Side Plate		1
		Pawl Pin		2
		Brake Cover		1
		Double Seal Ball Bearing	d25xD42x9 mm	1
21	L100-25-21	Double Seal Ball Bearing	d20xD37x9 mm	1
21A	L100-25-21A	Double Seal Ball Bearing	d25xD42x9 mm	1
21B	L100-25-21B	Double Seal Ball Bearing	d6xD15x5 mm	1

## Parts List: L100-25 Chain Hoist (0.25 Ton)

Index No.	Part No.	Description	Size	Qty
22	L100-25-22	Gear Side Plate Assembly		1
		Gear Side Plate		1
		Bushing		2
		Double Seal Ball Bearing	d25xD42x9 mm	1
23	L100-25-23	Load Gear		1
24	L100-25-24-1	Drive Shaft		1
25	L100-25-25G	Gear Case Assembly		1
		Gear Case		1
		Bushing		2
		Double Seal Ball Bearing	d10xD22x6 mm	1
26	F002114	Lock Washer (Black Oxide)	M8	3
26A	F002114	Lock Washer (Black Oxide)	M8	3
27	F001753	Lock Nut (Black Oxide)	M6	3
27A	F001753	Lock Nut (Black Oxide)	M6	3
28	L100-25-28	Rivet	2x4 mm	4
29	LM000013	Name Plate, L100-25		1
29	LM000014	Name Plate, L100-25 with overload		1
30	L100-25-30	Spur Gear Assembly		2
		Spur Gear		2
		Pinion Gear		2
31	L100-25-31	Load Sheave		1
31A	L100-25-31A	C-Clip	6.3x2 mm	1
31B	L100-25-31B	Needle Bearing HK1412	d12xD16x8 mm	1
32	L100-25-32	Guide Roller		2
33	L100-25-33	Stripper		1
34	L100-25-34	Chain Anchor Plate		1
35	L100-25-35	Chain Anchor Pin		1
36	L100-25-36	Split Pin	2x12 mm	1
37	L100-25-37	Load Chain – <i>specify length</i>	4x12 mm	1
47	L100-25-47	Snap Ring	18 mm	1
48	L100-25-48G	Dust Cover		1
	L100-WT	Warning Tag (not shown)		1

### Note:

When ordering replacement chain (Index #12, #37), specify length.