



Operating Instructions and Parts Manual L-100 Series Hand Chain Hoists



For L100-200 serial no. 15070001 and higher
For L100-300 serial no. 15070043 and higher
For L100-1500 serial no. 15070088 and higher

1-ton model shown

JET
427 New Sanford Road
LaVergne, Tennessee 37086
Ph.: 800-274-6848
www.jettools.com

Part No. M-106210
Revision D 08/2015
Copyright © 2015 JET

L-100 Chain Hoist Parts Breakdown

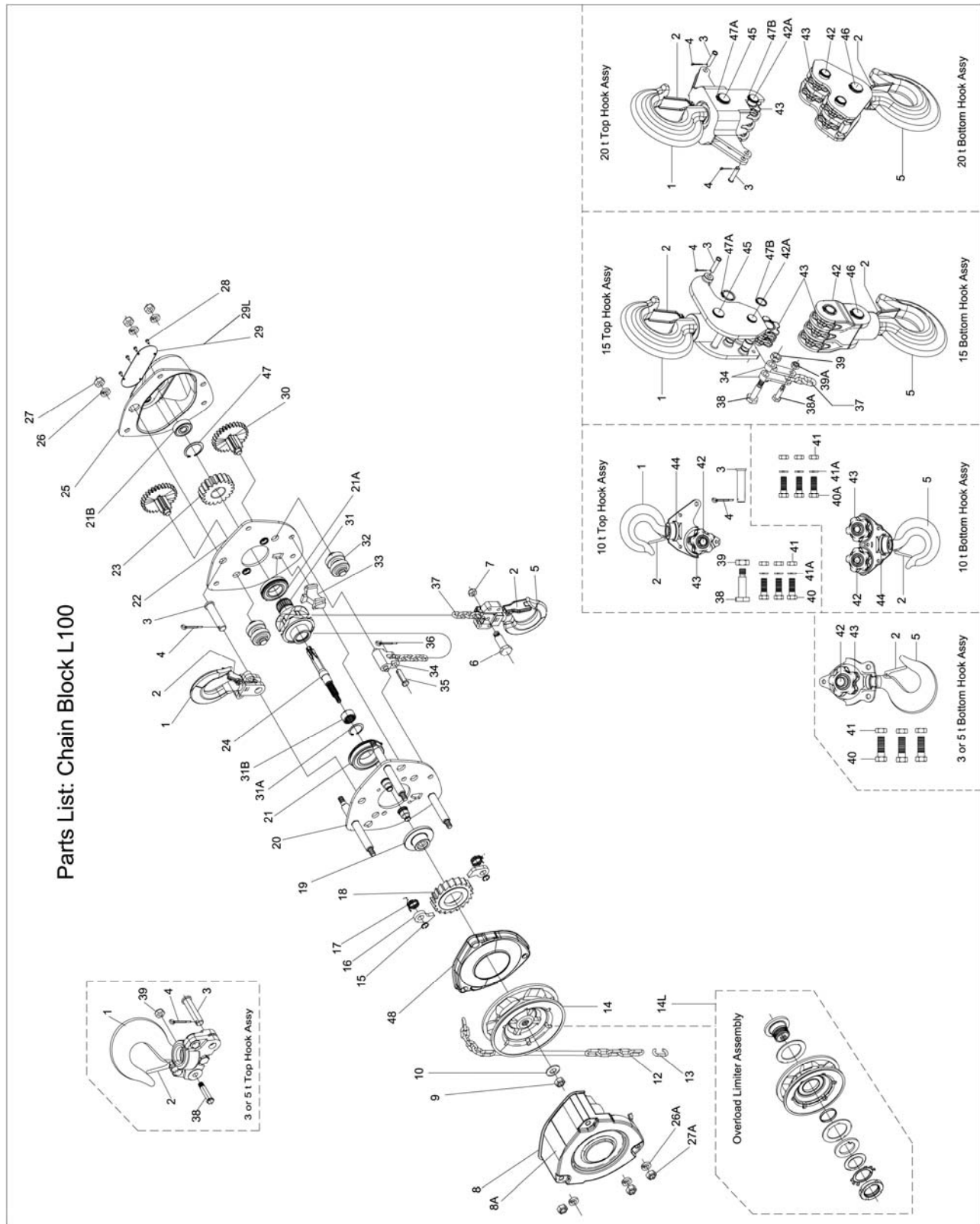

Parts List – L100-1000 Chain Hoist (10 Ton)

Parts listed under each assembly are parts that make up that assembly (sold as an assembly only).

Index No.	Part No.	Description	Size	Qty
1	L100-1000-1	Top Hook Assembly		1
		Top Hook		1
		Safety Latch		1
		Double Spring		1
		Socket Head Cap Screw	M5x30	1
		Lock Nut	M5	1
		Top Hook Holder		1
		Hook Collar Bushing		1
		Idle Shaft		1
		Idle Sheave		1
		Needle Bearing		1
		Socket Head Cap Screw	M12x40	2
		Lock Nut	M12	2
		Lock washer	M12	2
2	L100-1000-2	Safety Latch Assembly		2
		Safety Latch		2
		Double Spring		2
		Socket Head Cap Screw	M5x30	2
		Lock Nut	M5	2
3	L100-500-3	Top Hook Shaft		1
4	L100-500-4	Split Pin	2.5x22 mm	1
5	L100-1000-5	Bottom Hook Assembly		1
		Bottom Hook		1
		Safety Latch		1
		Double Spring		1
		Socket Head Cap Screw	M5x30	1
		Lock Nut	M5	1
		Idle Shaft		2
		Idle Sheave		2
		Needle Bearing		1
		Socket Head Cap Screw	M12x45	3
		Lock Nut	M12	3
		Lock Washer	M12	3
		Hook Collar Bushing		1
		Bottom Hook Holder		1
8	L100-500-8G	Hand Wheel Cover Assembly		1
		Hand Wheel Cover		1
		Hand Chain Guide		2
8A	L100-50-8A	Warning Label		1
9	L100-100-9-1	Wheel Stopper	M8	1
10	L100-100-10-1	Wheel Washer		1
12	L100-100-12	Hand Chain – <i>specify length</i>	5x25 mm	1
13	L100-100-13	Hand Chain Connecting Link		1
14	L100-500-14-1	Hand Chain Wheel		1
14L	L100-1000WO-14-1L	Overload Limiter Assembly (<i>used on overload protection model</i>)		1
		Overload Limiter Knob		1
		Brake Disc		2
		Hand Chain Wheel		1
		Bushing in Hand Chain Wheel		1
		Disc Spring Plate		1
		Disc Spring		1
		Disc Spring Stopper		1
		Lock Nut		1
15	L100-100-15	Snap Ring	10 mm	2
16	L100-100-16	Pawl		2
17	L100-100-17	Pawl Spring		2
18	L100-500-18-1	Ratchet Disc Assembly		1
		Ratchet Disc		1
		Ratchet Bushing		1

Parts List: L100-1000 Chain Hoist (10 Ton)

Index No.	Part No.	Description	Size	Qty
19	L100-500-19-1	Disc Hub		1
20	L100-500-20-1	Wheel Side Plate Assembly		1
		Wheel Side Plate		1
		Stay Bolt		3
		Pawl Pin		2
		Brake Cover		1
		Double Seal Ball Bearing	d35xD62x14 mm	1
21	L100-500-21	Double Seal Ball Bearing	d35xD62x14 mm	1
21A	L100-500-21	Double Seal Ball Bearing	d35xD62x14 mm	1
21B	L100-500-21B	Double Seal Ball Bearing	d12xD32x10 mm	1
22	L100-500-22	Gear Side Plate Assembly		1
		Gear Side Plate		1
		Bushing		2
		Double Seal Ball Bearing	d35xD62x14 mm	1
23	L100-500-23	Load Gear		1
24	L100-500-24-1	Drive Shaft		1
25	L100-500-25G	Gear Case Assembly		1
		Gear Case		1
		Bushing		2
		Double Seal Bearing	d12xD32x10 mm	1
26	F002118	Lock Washer	M12	3
26A	F002114	Lock Washer	M8	3
27	F001756	Lock Nut	M12	3
27A	F001754	Lock Nut	M8	3
28	L100-100-28	Rivet	3x6 mm	4
29	LM000027	Name Plate, L100-1000		1
29	LM000028	Name Plate, L100-1000 with overload		1
30	L100-500-30	Spur Gear Assembly		2
		Spur Gear		2
		Pinion Gear		2
31	L100-500-31	Load Sheave		1
31A	L100-500-31A	C-Clip	24 mm	1
31B	L100-500-31B	Needle Bearing	17x24x15 mm	1
32	L100-500-32	Guide Roller		2
33	L100-500-33	Stripper		1
34	L100-500-34	Chain Anchor Plate		1
35	L100-500-35	Chain Anchor Pin		1
36	L100-500-36	Split Pin	2x18 mm	1
37	L100-500-37	Load Chain – <i>specify length</i>	9x27 mm	1
38	L100-1000-38	Top Hook Pin		1
39	F001756	Lock Nut	M12	1
40	F005454	Socket Head Cap Screw	M12x40	2
40A	F005455	Socket Head Cap Screw	M12x45	3
41	F003084	Hex Nut	M12	5
41A	F002646	Flat Washer	M12	5
42	L100-500-42	Idle Shaft		1
43	L100-500-43	Idle Sheave		1
44	L100-1000-44	Hook Collar Assembly		2
		Steel Ball		52
		Set Screw	M12	2
47	L100-500-47	Snap Ring	32 mm	1
48	L100-500-48G	Dust Cover		1

Note: When ordering replacement chain (Index #12, #37), specify length.

Record your purchase and installation information here

Purchased from: _____ Date: _____

Serial Number: _____ Model Number: **L-100-** _____

Stock Number: _____

Location Installed: _____

Date Installed: _____ Date in Service: _____



427 New Sanford Road
LaVergne, Tennessee 37086
Phone: 800-274-6848
www.jettools.com