

# PARTS IDENTIFICATION

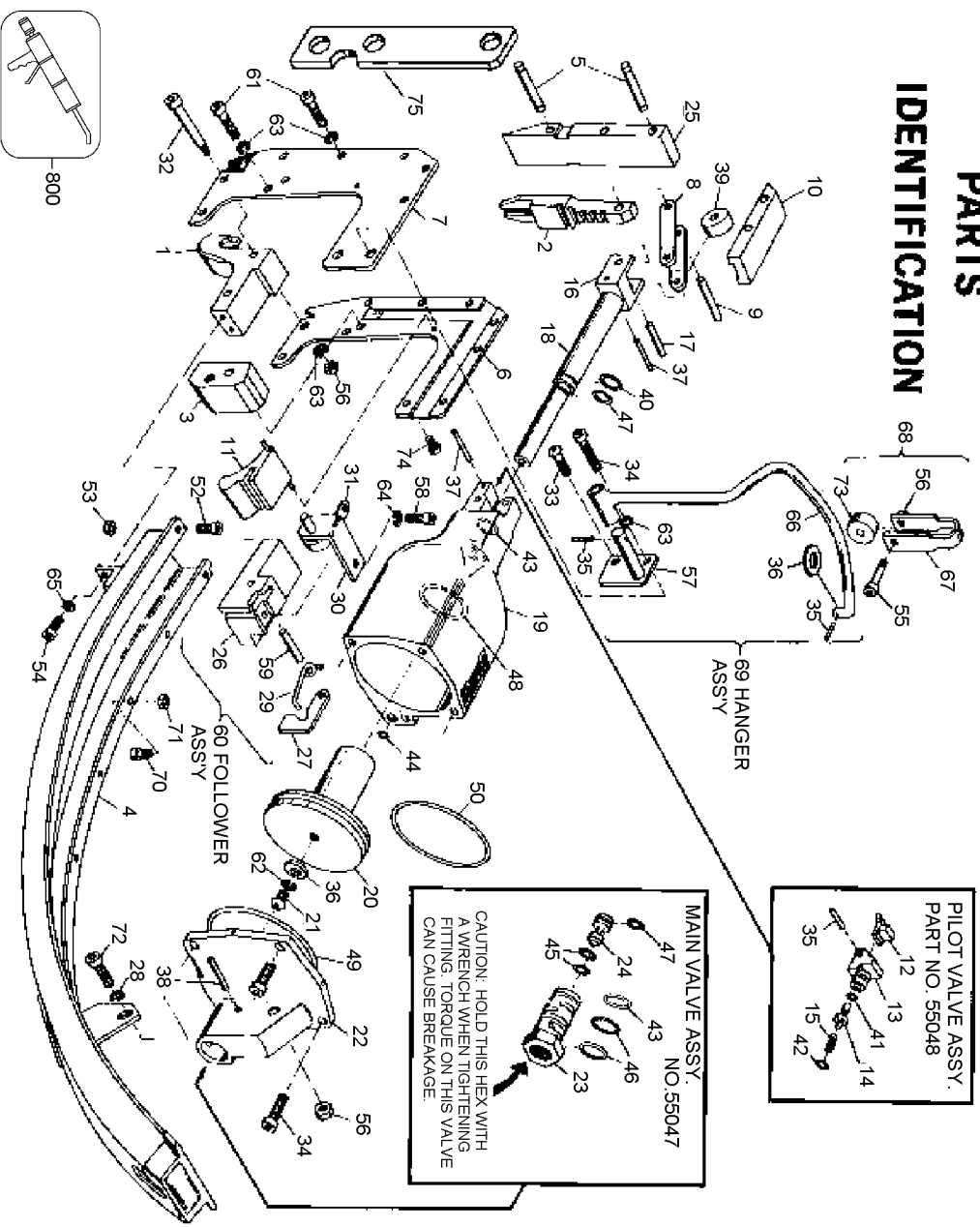

PILOT VALVE ASSY.  
PART NO. 55048

MAIN VALVE ASSY.  
NO. 55047

CAUTION: HOLD THIS HEX WITH A WRENCH WHEN TIGHTENING FITTING. TORQUE ON THIS VALVE CAN CAUSE BREAKAGE.



800

## Parts List for HR-66 Type 0

Item Number	Part Number	Description	Qty Required
1	HR-55171	ANVIL	1
3	HR-55005	BLADE GUIDE M55-66	1
4	HR-55027	MAGAZINE ASSEMBLY M5	1
5	HR-55002	PIN - SIDE PLATE	1
6	HR-55003	SIDE PLATE- R.H.	1
7	HR-55004	SIDE PLATE- L.H.	1
8	HR-55008	LINK	1
9	HR-55009	PIN- DOWEL 5/16 X 1	1
11	HR-55012	TRIGGER COMPLETE	1
12	HR-55013	VALVE LEVER CL-CC	1
13	HR-55014	PILOT VALVE BODY CL-	1
14	HR-55015	VALVE STEM CL-CC	1
15	HR-55016	SPRING CL-CC	1
16	HR-55017	YOKE - PISTON ROD	1
17	HR-55018	PISTON PIN - ROLLER	1
18	HR-55019	PISTON ROD W/ O-RING	1
19	HR-55020	HOUSING CL-CC-TM	1
20	HR-55021	PISTON CL-CC-AK-LN-T	1
21	HR-55022	PISTON SCREW	1
22	HR-55023	CAP-/O-RING FOR TM-A	1
23	000000-00	No Longer Available	1
23	HR-56170	VALVE BODY	1
24	000000-00	No Longer Available	1
24	HR-56177	VALVE PISTON	1
25	HR-55007	FRONT PLATE RETRO KI	1
26	HR-55031	FOLLOWER W/ MAGNET	1
27	HR-55032	FOLLOWER LATCH CL	1

## Parts List for HR-66 Type 0

Item Number	Part Number	Description	Qty Required
28	HR-55109	MAGAZINE SPACER CL-C	1
29	HR-55038	LATCH SPRING CL	1
30	HR-55039	FOLLOWER BRKT. ASSEM	1
31	HR-55040	NEGATOR SPRING CL	1
32	HR-55056	STUD-SHOULDER BOLT	2
33	HR-15000	BHCS 1/4-20 X 5/8	2
34	HR-15001	SHCS 1/4-20 X 3/4	5
35	HR-15002	PIN- ROLL 3/32 x 1/2	3
36	HR-15038	WASHER- FLAT 3/8 X 1	2
37	HR-15004	PIN- DOWEL 1/8 X 7/8	2
38	HR-15005	PIN- ROLL 5/32 X 1	1
39	HR-55103	ROLLER	1
40	HR-15054	O-RING	1
41	HR-15008	O-RING 1/8 X 1/4 X 1	1
42	HR-15009	O-RING 5/16 X 7/16 X	1
43	HR-15010	O-RING VITON 9/16 X	2
44	HR-15011	O-RING 1/4 X 3/8 X 1	1
45	HR-15012	O-RING 3/8 X 9/16 X	2
46	HR-15013	O-RING 5/8 X 3/4 X 1	2
47	HR-15014	O-RING 3/8 X 1/2 X 1	2
48	HR-15015	O-RING VITON 1 X 1 1	1
49	HR-15016	O-RING 2 7/8 X 3 X 1	1
50	HR-15017	O-RING 2 3/4 X 3 1/8	1
52	HR-15019	SHCS 8-32 X 1/4	1
53	HR-15020	NUT- THIN JAM FLEXLO	1
54	HR-15021	SHCS 10-32 X 1/2 W/N	2
55	HR-15022	SHCS 1/4-20 X 1	2

## Parts List for HR-66 Type 0

Item Number	Part Number	Description	Qty Required
56	HR-15023	NUT- FLEXLOC 1/4-20	4
57	HR-55053	HANGER SUPPORT	1
58	HR-15025	SHCS 8-32 X 5/8 W/NY	1
59	HR-15026	PIN- ROLL 1/8 X 3/4	1
60	HR-55051	FOLLOWER ASSY. CL 7/	1
61	HR-15028	SHCS 1/4-20 X 5/8	4
62	HR-15029	WASHER- LOCK 5/16 ID	1
63	HR-15031	WASHER- LOCK 1/4 ID	7
64	HR-15032	WASHER- LOCK #8	1
65	HR-15033	WASHER- LOCK #10	2
66	HR-55096	SUSPENSION HANGER CL	1
67	HR-55095	HANGER YOKE	1
68	HR-55094	HANGER YOKE ASSEMBLY	1
69	HR-55097	SUSPENSION HANGER AS	1
70	HR-15052	SHCS 5-40 X 3/8	4
71	HR-15053	NUT- NYLON 5-40	4
72	HR-15063	SHCS 1/4-20 X 1-1/4	1
73	HR-15037	ROLLER BEARING	1
74	HR-15061	BHCS 1/4-20 X 1/2	2
800	100653	LUBE (2CC)	1
800	100679	LUBE (1LB.CAN)	1