

Drill Screwdriver - 0 601 417 734 - GSR 6-6 KE

www.powertools-aftersaleservice.com



BOSCH

Item	Part Number	Description	Illustration	Price	Quantity	Price Group
2	2 604 222 301	Pole Shoe 110-115V	1	-,-	1	-
3	2 604 010 532	Armature 110-115V	1	-,-	1	43
4	2 607 200 148	Switch	1	-,-	1	-
5	2 604 460 109	Power supply cord	1	-,-	1	-
6	2 600 703 013	Grommet Ø7,6-Ø8,2x95 MM	1	-,-	1	13
7	2 601 035 001	Cable Clip	1	-,-	1	11
9	2 601 110 414	Sticker	1	-,-	1	-
13	1 900 905 018	Deep-Groove Ball Bearing 7x22x7	1	-,-	1	29
14	1 900 905 029	Deep-Groove Ball Bearing 8x22x7	1	-,-	2	26
18	2 603 410 023	Socket head cap screw M3x10 MM	1	-,-	5	11
19	2 910 211 019	Tapping Screw DIN 7971-ST3,9x16-F	1	-,-	2	10
20	2 601 110 209	Sticker	1	-,-	1	12
25	2 606 490 043	Coupling Half	1	-,-	1	41
26	2 601 250 001	Leaf Spring	1	-,-	1	11
27	1 903 230 003	Ball DIN 5401-2,5MM-III-ST	1	-,-	1	10
28	2 606 445 005	Drive Bushing	1	-,-	1	38
29	2 600 502 001	Protective Cap	1	-,-	1	15
30	2 600 114 029	Spherical Washer	1	-,-	1	31
31	2 600 550 018	Disc Spring	1	-,-	2	11
32	2 604 619 009	Compression Spring	1	-,-	1	14
33	1 903 230 006	Ball DIN 5401-3,5 MM-III-ST	1	-,-	2	10
34	2 600 501 031	Retaining snap ring	1	-,-	1	26
35	1 903 230 004	Ball DIN 5401-3 MM-III-ST	1	-,-	17	10
36	2 916 600 009	Retaining ring 16 DIN 9045	1	-,-	1	10
37	2 600 500 030	Cupped Washer	1	-,-	1	11
38	2 605 700 925	Bearing Flange	1	-,-	1	30
39	2 607 200 114	Change-Over Switch	1	-,-	1	29
40	2 605 132 017	Housing Cover BLUE	1	-,-	1	21
41	2 910 211 020	Tapping Screw DIN 7971-BZ3,9x19	1	-,-	1	10
42	2 600 101 020	Shim 0,5 MM	1	-,-	1	11
42	2 600 101 022	Shim 0,2 MM	1	-,-	1	11
42	2 600 101 023	Shim 0,3 MM	1	-,-	1	11
43	2 600 150 004	Shim	1	-,-	1	11

Item	Part Number	Description	Illustration	Price	Quantity	Price Group
44	2 601 328 041	Cover Disc	1	-,-	1	14
45	2 600 119 000	Spring retaining ring	1	-,-	1	11
46	2 600 409 013	Centering Sleeve	1	-,-	3	11
47	2 600 108 000	Felt Disc	1	-,-	1	11
48	2 600 300 049	Seal Bushing	1	-,-	1	13
49	2 605 806 339	Gear Housing	1	-,-	1	39
50	2 914 501 027	Screw and washer assembly DIN 84-BM 4x35-Z4-8.8	1	-,-	3	16
51	3 603 133 000	Grooved Nail	1	-,-	2	11
53	2 600 516 009	Capsule	1	-,-	1	31
56	2 600 103 015	Supporting Disc	1	-,-	2	19
57	1 903 230 009	Ball DIN 5401-5 G28	1	-,-	8	10
58	2 600 283 012	Seal ring	1	-,-	1	14
59	1 903 230 007	Ball DIN 5401-4 MM-III-ST	1	-,-	16	10
61	2 600 390 022	Threaded Sleeve	1	-,-	1	43
62	2 603 435 016	Tapping Screw 2,2x6,5	1	-,-	2	11
63	2 914 501 011	Screw and washer assembly DIN7985-M3x6-Z1-4.8	1	-,-	2	10
64	2 604 652 003	Spiral Spring	1	-,-	2	11
69	2 604 411 524	Cable	1	-,-	2	-
70	2 604 611 026	Compression Spring	1	-,-	2	11
71	2 600 914 010	Needle bearing Ø6 MM	1	-,-	2	14
72	2 600 100 607	Shim 0,3 MM	1	-,-	2	11
75	1 903 201 042	Needle Roller DIN 5402-A3x11,8-G2	1	-,-	1	11
77	2 600 914 016	Needle bearing Ø 12 MM	1	-,-	1	15
78	1 900 452 012	End Splice DIN 46 228-A1-6	1	-,-	2	10
79	2 910 211 021	Tapping Screw DIN 7971-ST3,9x22-F	1	-,-	2	10
80	2 604 411 523	Cable	1	-,-	1	11
81	2 604 411 530	Cable	1	-,-	1	11
82	2 601 110 230	Sticker YELLOW	1	-,-	1	11
199	1 601 110 265	Sticker	1	-,-	1	15
800	2 604 320 902	Carbon-Brush Set	1	-,-	1	21
801	2 603 124 900	Drive Shaft	1	-,-	1	37
802	2 606 311 903	Toothed Shaft Z=10/41	1	-,-	1	36
803	3 607 031 164	Assembly Of Service Parts	1	-,-	1	40
805	2 605 104 954	Motor Housing BLUE	1	-,-	1	31
888	1 601 106 032	Nameplate 26x52 MM	1	-,-	1	13

Product information Drill Screwdriver - 0 601 417 734 - GSR 6-6 KE

Product No	0 601 417 734
Description	251.348; Drill Screwdriver
DIN-Text	
ID_Text_Ext	0
Trading_Description	GSR 6-6 KE
Voltage_1	115 V
ID_Country_Product	USA

Illustration - Type E

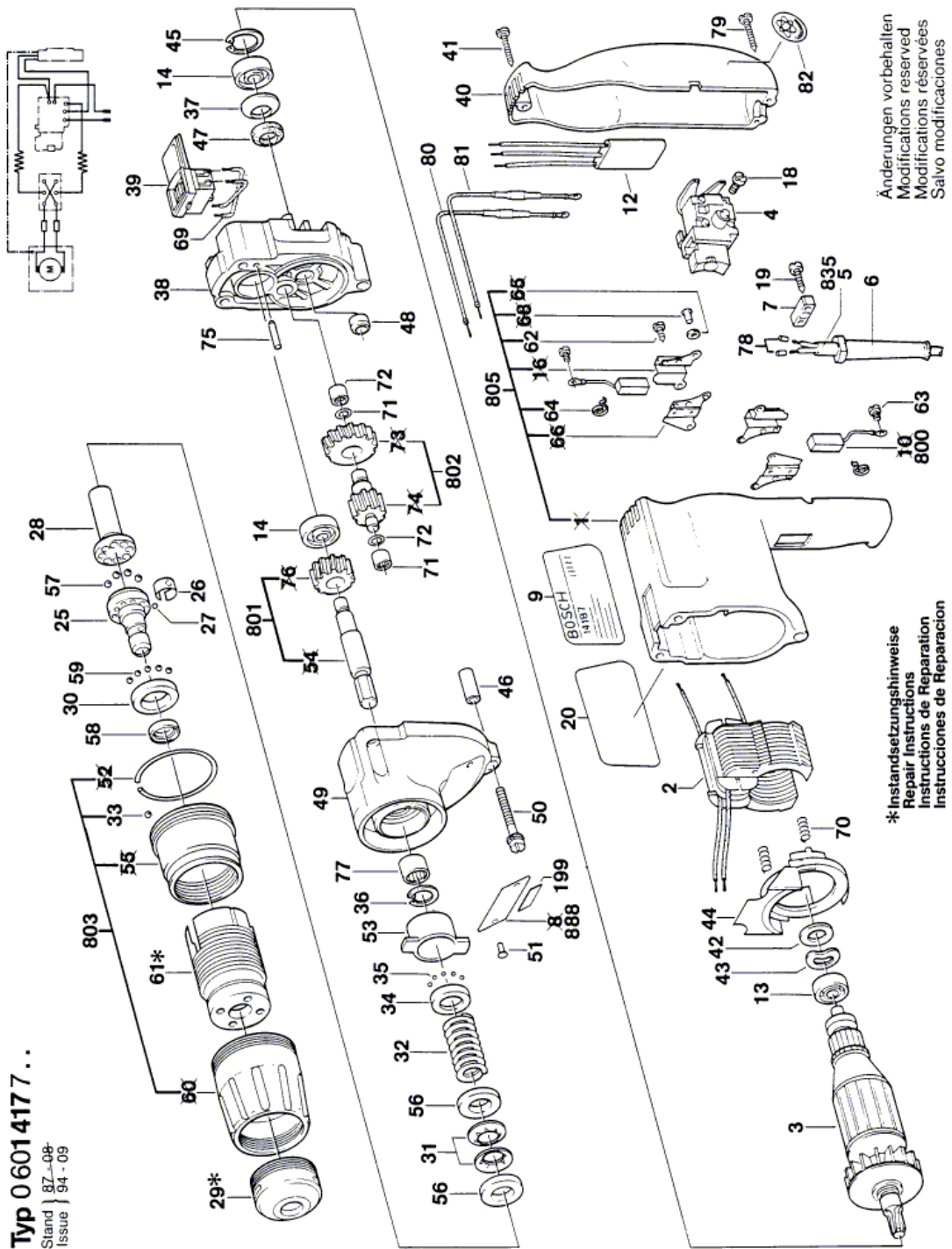

Information subject to change without further notice.