

Circular hand saw - 0 601 552 034 - GDC 42

www.powertools-aftersaleservice.com



BOSCH

Item	Part Number	Description	Illustration	Price	Quantity	Price Group
1	1 609 251 006	Motor Housing	1	-,-	1	-
2	1 609 242 002	Pole Shoe 115V	1	-,-	1	-
3	1 609 251 001	Handle Cover	1	-,-	1	-
4	1 609 240 002	Armature 115V	1	-,-	1	-
4/18	1 610 900 025	Deep-Groove Ball Bearing 7x22x7	N/A	-,-	1	22
5	1 609 255 000	Housing Cover	1	-,-	1	-
6	1 609 255 094	Pivoting Blade Guard	1	-,-	1	-
7	1 609 255 012	Protective Cover	1	-,-	1	-
8	1 609 280 010	Base Plate	1	-,-	1	-
9	1 609 281 000	Parallel-Guide	1	-,-	1	-
10	1 609 258 000	Intermediate Flange	1	-,-	1	-
11	1 609 272 003	On-Off Switch	1	-,-	1	28
13	1 609 213 000	Fastening Clamp	1	-,-	1	-
14	1 609 207 000	Grommet	1	-,-	1	-
15	1 604 460 022	Power supply cord USA/CDN 2,15m 2 x 082mm SJ 18/2	1	-,-	1	26
16	1 609 207 001	Grommet Ø9x90 MM	1	-,-	1	14
19	1 609 263 002	Cylindrical Gear Z=50	1	-,-	1	-
20	1 609 201 003	Intermediate Ring	1	-,-	1	-
21	1 900 905 163	Deep-Groove Ball Bearing 17x35x10	1	-,-	1	23
22	1 900 900 235	Deep-Groove Ball Bearing 627 Y DIN 625	1	-,-	1	29
23	1 609 257 000	Intermediate Flange	1	-,-	1	-
24	1 609 257 001	Conical Spring Washer	1	-,-	1	-
25	1 603 414 007	Hex Socket Head Cap Screw M6x14 MM	1	-,-	1	11
26	1 604 652 009	Spiral Spring	1	-,-	1	-
27	1 609 223 000	Clamping Piece	1	-,-	1	-
28	1 609 233 000	Wing Nut M6	1	-,-	1	-
29	1 602 386 002	Rubber Buffer	1	-,-	1	-
30	1 600 100 633	Plain Washer 0,3 MM THICK	1	-,-	2	11
31	1 609 201 082	Plain Washer Ø6,4xØ16x2 MM	1	-,-	2	13
32	1 609 234 001	Socket head cap screw	1	-,-	2	-
33	1 609 243 000	Carbon-Brush Set	1	-,-	1	28
35	1 601 110 016	Manufacturer's nameplate	1	-,-	1	-
36	1 609 210 001	Sleeve Terminal	1	-,-	1	-

Item	Part Number	Description	Illustration	Price	Quantity	Price Group
37	1 609 286 026	Circular Saw Blade Z=20	1	-,-	1	-
38	2 910 271 147	Pan head screw DIN 923-M5x5-5.8	1	-,-	1	-
39	2 910 611 018	Tapping Screw DIN 7981-ST3,9x13-C-H	1	-,-	2	11
40	2 910 501 134	Countersunk-Head Screw DIN 63-BM4x30-5.8	1	-,-	2	11
41	2 910 501 132	Countersunk-Head Screw AM 4x25 DIN 63-5.8	1	-,-	1	-
42	2 910 501 136	Countersunk-Head Screw	1	-,-	1	-
43	2 912 401 020	Tapping Screw DIN 7981-3,9x19-C-Z-ST	1	-,-	2	10
44	2 917 721 051	Round-Head Grooved Pin 2,6x3 DIN 1476-ST	1	-,-	1	-
45	2 916 011 014	Plain Washer DIN 125-A 6,4-ST	1	-,-	5	10
46	2 912 171 201	Stud BM 6x20 DIN 938-5.6	1	-,-	2	13
47	2 910 281 196	Round-Head Bolt M6x15 DIN 603	1	-,-	2	11
48	2 910 375 193	Hex Socket Head Cap Screw DIN 6912 M6x12-8.8	1	-,-	2	13
49	2 910 021 658	Socket head cap screw DIN 84-BM4x65-8.8	1	-,-	2	11
51	2 910 141 178	Hex Socket Head Cap Screw DIN 912-M5x60-8.8	1	-,-	3	13
52	2 910 141 170	Hex Socket Head Cap Screw DIN 912-M5x40-8.8	1	-,-	1	13
53	2 915 011 005	Hex Nut DIN 934 -M4-m-8	1	-,-	6	10
54	2 915 051 105	Hex Nut DIN 439-AM5-04	1	-,-	4	-
55	2 916 060 005	Spring Washer DIN 137-A 4-ST	1	-,-	10	10
57	1 907 950 006	Offset Screwdriver DIN 911-SW5 BLACK	1	-,-	1	15
58	1 609 213 001	Holding Spring	1	-,-	1	-
59	2 916 660 014	Spring retaining ring DIN 472 35x1,5 MM	1	-,-	1	13
60	2 910 281 215	Round-Head Bolt DIN 603 M6x55	1	-,-	1	11
61	2 910 281 205	Round-Head Bolt DIN 603 - M6x30	1	-,-	1	11
62	2 910 611 082	Tapping Screw B 3,9x32 DIN 7981	1	-,-	4	11
62	2 910 611 037	Tapping Screw B 4,8x32 DIN 7981	1	-,-	4	11
64	2 916 011 010	Plain Washer DIN 125-A4,3-ST	1	-,-	4	10
69	2 603 490 017	Torx Oval-Head Screw 3x10	1	-,-	2	10
888	1 601 106 032	Nameplate 26x52 MM	N/A	-,-	1	13

Illustration - Type E

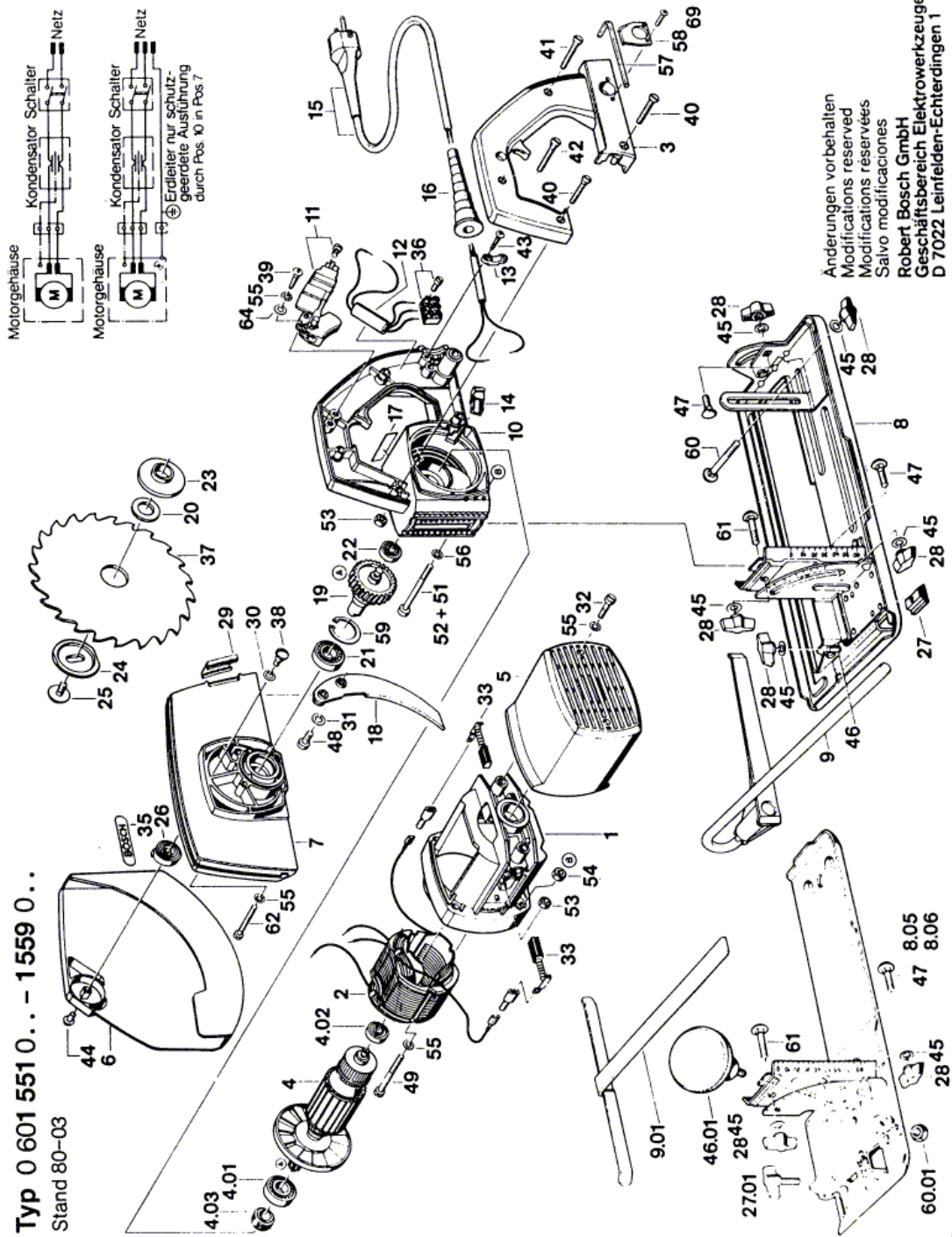

B6

Information subject to change without further notice.