



BOSCH

Rotary Hammer

GBH 38 | 0 611 227 143

Table of Content

Spare parts list.....	2
Illustration - Type.....	6

Spare parts list

Item	Part Number	Description
1	1 615 102 142	Motor Housing BLUE
2	1 604 220 343	Field 220-230V
4	1 617 200 048	Switch
4/10	2 910 011 088	Socket head cap screw DIN 84-AM3,5x12-5.8
5	1 614 460 075	Power supply cord CN 4,15m 2 x 1,0mm H07 RN-F
6	1 610 703 053	Grommet Ø9,7-Ø12x89 MM
7	1 601 302 018	Fastening Clamp
9	1 611 110 672	Manufacturer's nameplate
13	1 610 900 025	groove ball bearing 7x22x7
15	1 616 610 071	Fan
19	1 615 806 121	Guide Tube
20	1 618 597 071	Toolholder
21	1 610 508 017	Protective Cap
22	1 610 591 009	Protection Sleeve
23	1 610 520 001	Stop Sleeve
25	1 612 300 027	Stopping Device
26	1 610 290 025	Indexing Disk
27	1 610 222 008	Retaining snap ring
28	1 614 621 000	Compression Spring
29	1 614 616 008	Compression Spring
30	1 610 250 007	Ball Race
31	1 610 390 015	Spacer Tube
32	1 610 202 016	Cylinder Sleeve
34	1 610 102 622	Supporting Disc 1,5 MM THICK
35	1 615 806 089	Hammer Pipe
38	1 615 190 064	Covering hood BLUE
39	1 610 290 024	Clutch Ring
41	1 613 124 036	Striker Pin
46	1 611 015 036	Sealing Frame
47	1 610 591 012	Cover
51	1 616 333 023	Crown Gear Z=37
53	1 610 190 023	Stop Disc
54	1 610 101 014	Stop Disc
57	1 618 710 053	Striker

Spare parts list

Item	Part Number	Description
72	1 616 337 004	Eccentric Cog Wheel Z=35
75	1 615 132 059	Handle BLUE
80	1 617 233 024	Speed governor 230-240V
81	1 612 026 055	Switch-Pawl GRAY
94	1 610 119 007	Spring retaining ring
96	2 916 660 024	Spring retaining ring 55x2MM, DIN 472
97	2 916 190 284	Shim ring DIN 988-45x55
98	1 610 101 622	Friction Washer 0,5 MM THICK
99	1 610 190 030	Holding Plate
101	1 610 210 094	O-Ring 20,0x3,0 MM
102	1 610 210 095	O-Ring 55,0x2,0 MM
103	1 610 210 100	O-Ring 27,0x1,5 MM
104	1 610 210 093	O-Ring 17,0x8,0 MM
105	1 610 210 096	O-Ring 21,0x3,5 MM
107	1 610 210 116	O-Ring 14,0x2,0 MM
108	1 900 210 103	O-Ring 8,0x1,5 MM
109	1 610 283 028	Rotary shaft lip seal DIN 3760-BS, Ø40x55x7 MM
110	1 610 116 003	Spring retaining ring
111	1 610 210 081	O-Ring 10,0x1,0 MM
112	1 613 461 001	Threaded Ring M24x1,5MM, SW10
113	1 610 501 036	Bushing
116	1 610 116 004	Spring retaining ring
117	1 610 119 008	Spring retaining ring
118	1 610 913 009	Needle-Roller Assembly
119	1 610 913 011	Needle-Roller Assembly Ø10 MM
121	1 610 905 014	groove ball bearing
122	1 610 913 029	Needle-Roller Assembly
124	1 610 101 008	Thrust Bearing Disc 1,0 MM THICK
125	2 912 401 036	Tapping Screw DIN7981-ST4,8x25-C-Z
126	2 910 211 019	Tapping Screw DIN 7971-ST3,9x16-F
127	2 912 311 166	Oval-Head Screw DIN 7985-M5x30-8.8
128	2 910 211 037	Tapping Screw DIN 7971-BZ4,8x32
129	2 912 401 037	Tapping Screw DIN 7981-ST4,8x32C-Z
131	1 611 110 673	Manufacturer's nameplate

Spare parts list

Item	Part Number	Description		
132	2 914 551 117	Microencapsulated Screw	DIN 912-M 5x12-8.8	
136	2 910 211 236	Tapping Screw	DIN 7971-ST4,8x25-C	
139	1 610 005 002	Felt Disc	Ø39x15 MM	
139	1 617 000 291	Retaining Bracket	BLACK	
148	1 610 102 627	Shim	0,2 MM	THICK
148	1 610 102 633	Shim	0,3 MM	THICK
149	1 612 388 021	Adapting Piece		
151	2 600 210 028	O-Ring	21,0x2,0 MM	
152	1 610 508 030	Cover		
154	1 610 222 010	Retaining snap ring		
180	1 611 110 855	Sticker		
800	1 617 000 945	Clamp Handle	BLACK	
803	1 614 010 186	Armature	220-240V	
808	1 601 11A 3H3	Nameplate		
814	1 617 000 822	groove ball bearing		
824	1 617 000 271	Cylindrical Roller		
833	1 617 000 949	Control Fork		
840	1 617 000 811	Impact Mechanism Housing		
842	1 614 336 009	Brush Holder		
842/020	1 614 336 043	Brush Guide		
842/040	1 617 014 122	Carbon-Brush Set		
842/050	1 613 212 004	Rubber Buffer		
842/080	2 912 401 005	Tapping Screw	DIN7981-ST2,9x9,5C-Z	
843	1 615 808 078	Bearing cover	BLUE	
845	1 617 000 823	Gear Housing		
848	1 617 000 415	Clutch Sleeve		
856	1 617 000 999	Hammer Piston		
860	1 617 000 817	Spur Wheel Clutch		
897	1 617 000 272	Wear and Tear Part Set		
898	1 617 000 273	Wear and Tear Part Set		
899	1 617 000 293	Holding Plate		
84	1 602 025 07H	Auxiliary Handle		
85	1 618 040 056	Support clamp	Ø 70 MM	
86	1 613 490 001	T-Head Bolt	M8x80 MM	

Spare parts list

Item	Part Number	Description
87	1 611 316 008	Clamping Band Ø70 MM
750	2 605 438 314	Carrying Case
784	2 602 025 062	Auxiliary Handle Ø 70 MM, M8

Illustration - Type - E

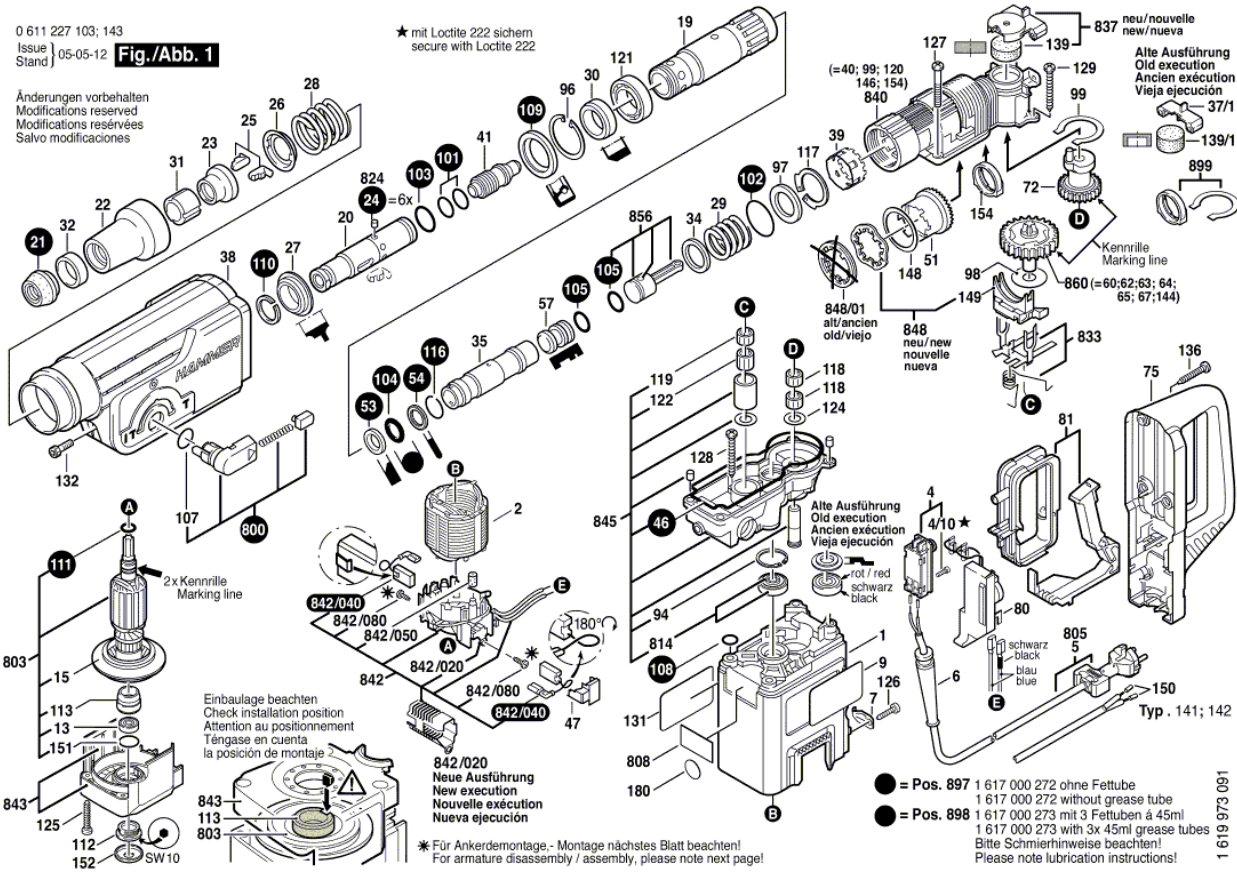
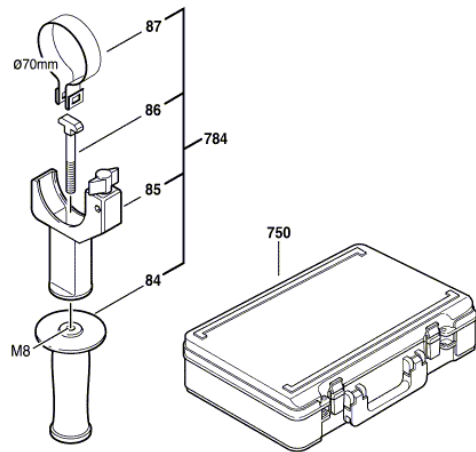
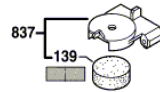

Illustration - Type - E

0 611 227 103; 143
 Issue | 05-05-12
 Stand | **Fig./Abb. 2**



Neue Ausführung
 New execution
 Nouvelle exécution
 Nueva ejecución



Alte Ausführung
 Old execution
 Ancien exécution
 Vieja ejecución

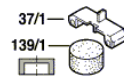

Änderungen vorbehalten
 Modifications reserved
 Modifications réservées
 Salvo modificaciones

Neue Ausführung
 New execution
 Nouvelle exécution
 Nueva ejecución

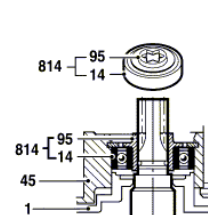

Alte Ausführung
 Old execution
 Ancien exécution
 Vieja ejecución

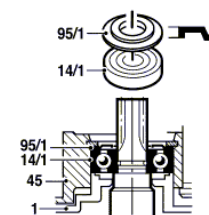

Beachten: Einbau Pos. 814 mit Hilfswerkzeug!
 Attention: Assembly pos. 814 using auxiliary tool!

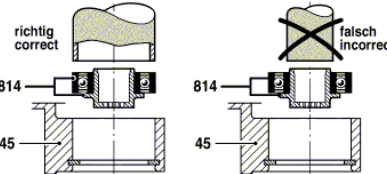

Vor Ankermontage- und Montage beide Bürstenhalter 5-7 mm nach außen ziehen.
 For armature disassembly and assembly pull the brush holder 5-7 mm outwards.

Nach der Ankermontage Bürstenhalter nach innen drücken und festschrauben.
 After armature assembly, press in the brush holder and tighten the screw.

Kohlebürsten mit Flachstecker einsetzen.
 Fit brushes and electrical contact.

Litzen beider Kohlebürsten um 180° drehen.
 Turn both the Brush wires 180° as shown.

Abstand herstellen (min. 1mm) zwischen Flachstecker und Kohlebürstenhalter.
 In order to fit pos. 47 there must be at least 1 mm distance between the brush holder and the electrical contact. Press pos. 47 firmly into position.

