

Percussion Drill - 0 601 181 734 - ELECTRONIC

www.powertools-aftersaleservice.com



BOSCH

Item	Part Number	Description	Illustration	Price	Quantity	Price Group
2	2 606 135 026	Drilling Spindle 1/2"	1	-,-	1	27
2	2 606 135 010	Drilling Spindle 1/2"	1	-,-	1	-
3	1 900 905 163	Deep-Groove Ball Bearing 17x35x10	1	-,-	1	23
5	2 600 101 616	Shim 0,5 MM	1	-,-	1	12
5	2 600 101 617	Shim 0,3 MM	1	-,-	1	11
6	2 600 917 003	Needle bearing Ø8x8 MM	1	-,-	1	14
7	2 916 660 014	Spring retaining ring DIN 472 35x1,5 MM	1	-,-	1	13
8	2 604 616 002	Compression Spring	1	-,-	1	11
9	2 600 300 016	Spacer Bushing	1	-,-	1	-
10	2 916 650 008	Spring retaining ring DIN 471 17x1 MM	1	-,-	1	11
11	2 600 101 671	Retaining Washer	1	-,-	1	11
12	2 602 300 027	Flat Key	1	-,-	2	15
14	2 606 317 036	Cylindrical Gear Z=48	1	-,-	1	-
15	2 606 317 037	Cylindrical Gear Z=36	1	-,-	1	30
16	2 600 190 052	Catch Disk	1	-,-	1	21
16	2 600 190 031	Locating Washer	1	-,-	1	22
20	2 600 000 012	Shim washer 0,2 MM	1	-,-	1	11
20	2 600 000 014	Shim washer 0,5 MM	1	-,-	1	11
21	1 903 230 010	Ball DIN 5401-5,5MM-III-ST	1	-,-	1	10
22	2 600 914 010	Needle bearing Ø6 MM	1	-,-	2	14
24	2 600 100 607	Shim 0,3 MM	1	-,-	2	11
27	2 600 100 682	Shim 0,5 MM	1	-,-	1	-
27	2 600 100 683	Shim 0,3 MM	1	-,-	1	-
27	2 600 100 684	Shim 0,2 MM	1	-,-	1	-
28	2 600 550 008	Disc Spring	1	-,-	3	11
29	2 600 114 001	Cover Disc	1	-,-	1	-
30	2 600 116 001	Locking Washer	1	-,-	2	-
31	2 603 070 012	Toothed rack	1	-,-	1	-
32	2 602 033 003	Fork Lever	1	-,-	1	12
33	2 914 501 011	Screw and washer assembly DIN7985-M3x6-Z1-4.8	1	-,-	1	10
35	2 602 026 034	Rotary Knob	1	-,-	1	17
36	2 916 080 910	Locking Washer DIN 6799-7-FSt	1	-,-	1	10
37	2 600 101 612	Shim 0,5 MM	1	-,-	1	11

Item	Part Number	Description	Illustration	Price	Quantity	Price Group
38	2 603 435 019	Headless Screw 74 MM	1	-,-	2	11
39	2 603 435 012	Tapping Screw 79 MM	1	-,-	2	11
43	2 600 190 029	Locating Washer	1	-,-	1	25
44	2 602 026 017	Rotary Knob	1	-,-	1	18
45	2 600 590 006	Ratchet Cap	1	-,-	2	11
47	2 917 780 105	Slotted Spring Pin 4x30 MM DIN 7346	1	-,-	1	10
48	2 600 108 077	Felt Washer	1	-,-	1	11
49	2 600 500 002	Cupped Washer	1	-,-	1	11
50	2 600 905 021	Deep-Groove Ball Bearing 9x24x7	1	-,-	1	21
51	2 604 010 631	Armature 110-115V	1	-,-	1	37
52	2 606 610 049	Fan	1	-,-	1	12
53	2 916 660 008	Spring retaining ring DIN 472-24x1,2 MM	1	-,-	1	11
54	2 600 400 008	Receptacle	1	-,-	1	11
55	2 605 108 014	Motor Housing BLUE	1	-,-	1	31
56	2 601 328 033	Cover Disc	1	-,-	1	13
57	2 603 490 017	Torx Oval-Head Screw 3x10	1	-,-	4	10
58	2 604 220 439	Field 110-115V	1	-,-	1	31
59	2 604 448 036	Connecting Cable	1	-,-	1	-
60	2 604 465 062	Suppressor Box	1	-,-	2	17
61	2 604 448 043	Connecting Cable L=193 MM WHITE	1	-,-	1	11
62	1 900 905 018	Deep-Groove Ball Bearing 7x22x7	1	-,-	1	29
65	2 601 015 047	Brush Plate	1	-,-	2	11
66	2 607 200 372	On-Off Switch	1	-,-	1	41
67	2 601 035 001	Cable Clip	1	-,-	1	11
68	2 910 211 019	Tapping Screw DIN 7971-ST3,9x16-F	1	-,-	2	10
69	2 607 329 103	Suppression Capacitor	1	-,-	1	-
70	2 605 133 000	Handle BLUE	1	-,-	1	29
72	2 600 703 011	Grommet Ø8,3-Ø9,4x95 MM	1	-,-	1	13
72	2 600 703 012	Grommet Ø6,5-Ø6,9x95 MM	1	-,-	1	13
72	2 600 703 013	Grommet Ø7,6-Ø8,2x95 MM	1	-,-	1	13
73	2 604 460 056	Power supply cord	1	-,-	1	-
74	2 604 448 003	Cable	1	-,-	1	12
78	2 601 110 093	Sticker	1	-,-	1	11
79	2 601 110 250	Sticker	1	-,-	1	-
80	2 601 110 076	Sticker DRILL/IMPACT DRILL	1	-,-	1	11
81	2 601 110 041	Sticker YELLOW	1	-,-	1	11
82	2 603 410 001	Socket head cap screw M3x6,5-4.8	1	-,-	2	11
83	2 603 435 015	Recessed-Head Screw DIN 7981-ST3,5x9,5-F	1	-,-	4	11
85	2 600 101 023	Shim 0,3 MM	1	-,-	1	11
85	2 600 101 022	Shim 0,2 MM	1	-,-	1	11
85	2 600 101 020	Shim 0,5 MM	1	-,-	1	11
87	2 600 150 004	Shim	1	-,-	1	11
90	2 912 401 020	Tapping Screw DIN 7981-3,9x19-C-Z-ST	1	-,-	4	10
94	1 600 210 024	O-Ring 12,0x1,0 MM	1	-,-	1	11
97	2 601 022 000	Damping Plate	1	-,-	1	11
98	2 910 021 132	Socket head cap screw DIN 84-AM4x25-8.8	1	-,-	4	10
99	2 916 690 003	Spring Lock Washer DIN 128-A4-FST	1	-,-	4	10
651	2 602 025 031	Auxiliary Handle BLACK	1	-,-	1	20
652	2 915 191 006	Wing Nut M6 DIN 315-G-GTW-40	1	-,-	1	11
653	2 911 011 220	Hex Screw DIN 931-M6x75-8.8	1	-,-	1	-
654	2 601 098 001	Conical Spring Washer	1	-,-	1	-
655	2 607 010 026	Depth-Gauge	1	-,-	1	-
656	1 608 571 069	Chuck Ø1,5-13 MM, 1/2"	1	-,-	1	32

Item	Part Number	Description	Illustration	Price	Quantity	Price Group
656	2 607 950 007	Chuck Wrench SG2	1	-,-	1	18
800	2 605 806 973	Gear Housing	1	-,-	1	-
810/04	2 604 321 905	Carbon-Brush Set	N/A	-,-	1	23
888	1 601 106 032	Nameplate 26x52 MM	1	-,-	1	13

Product information Percussion Drill - 0 601 181 734 - ELECTRONIC

Product No	0 601 181 734
Description	251.666; Percussion Drill
DIN-Text	
ID_Text_Ext	0
Trading_Description	ELECTRONIC
Voltage_1	115 V
ID_Country_Product	USA

Illustration - Type E

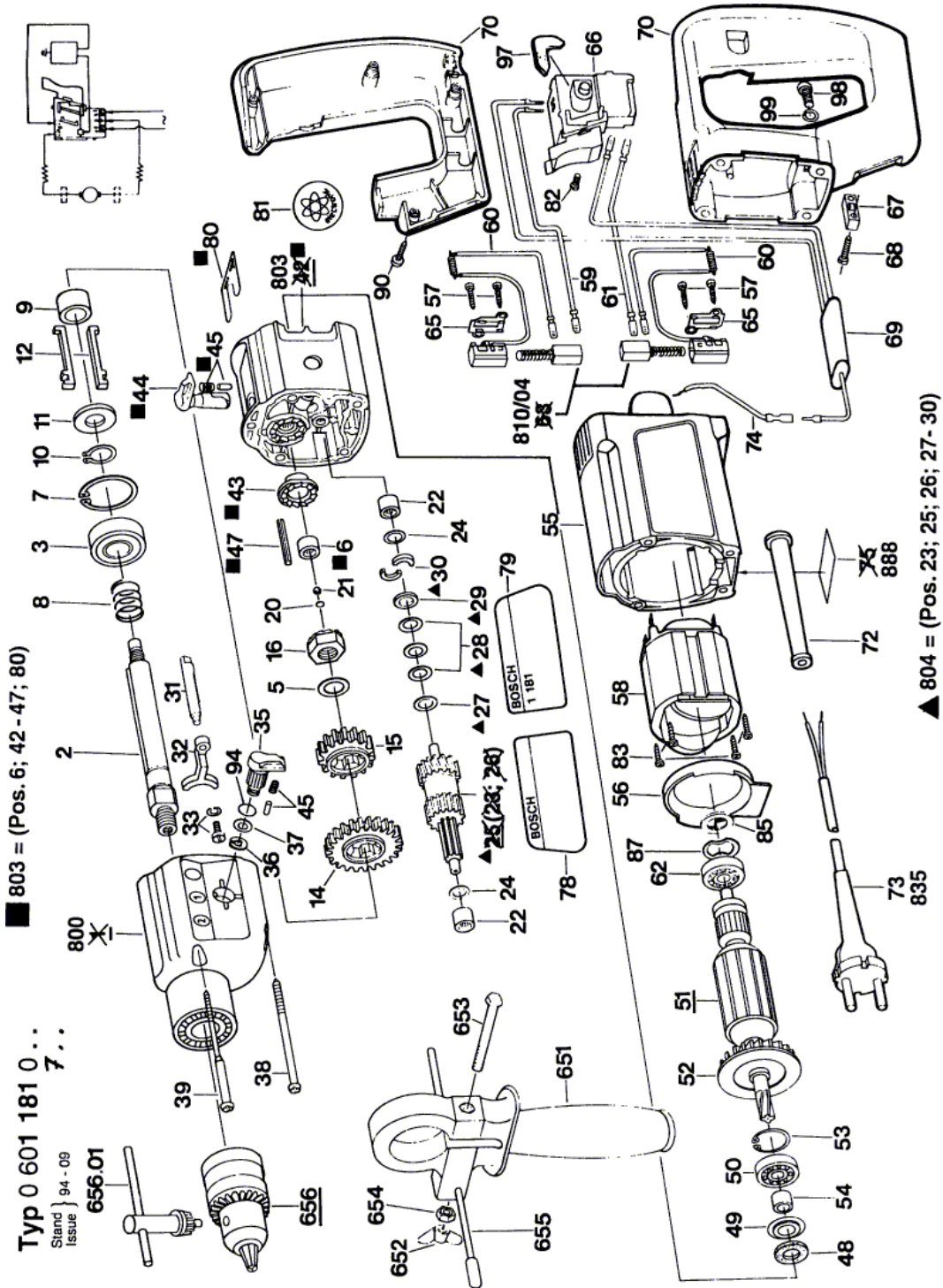

Information subject to change without further notice.