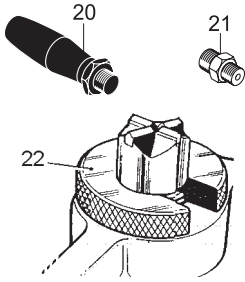

Item	Part No	Description	Qty
1	120.512	Scaler body B23	1
1	120.513	Scaler body B14A	1
2	143.528	Piston B14A	1
		Piston B23	3
3	615 250545 0	Cross bit, round shank B14A	1
		Cross bit, round shank B23	3
4	321.574	Throttle lever	1
5	395.521	Valve body assembly (4-6-13)	1
6	399.745	Valve stem set (15-18)	1
7	400.529	Cylinder B14A	1
		Cylinder B23	3
8	570.552	Handle tube	1
9	570.553	Grip	1
10	577.522	Buffer ring B14A	1
		Buffer ring B23	3
11	595.553	Brush seal B14A	1
		Brush seal B23	3
12	607.521	Locknut	1

Item	Part No	Description	Qty
13	637.116	Roll pin	1
14	650.31	Sealing washer B14A	1
		Sealing washer B23	3
15	658.239	'O' ring	1
16	671.538	Cap B23	1
17	671.539	Threaded adapter B14A	1
		Threaded adapter B23	3
18	681.578	Valve spring	1
19	681.600	Compression spring B14A	1
		Compression spring B23	3
		Nameplate	1

	6158727980	Warning label
	6159948780	Safety instructions
	6159943820	Operator's manual

Accessories included

Item	Part No	Description	Qty
20	615 576513 0	Side handle	1
21	615 720511 0	Nipple	1
22	615 746529 0	Washer	1

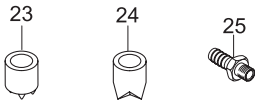
Optional accessories

Item	Part No	Description	Qty
23	615 250546 0	Pointed bit, round shank	1
24	615 250547 0	Beryllium-copper cross bit, round shank	1
25	615 705006 0	1/4" air hose nipple for 3/8" ID hose	1

CHANGING THE CUTTER

Clamp the body of the scaler in a soft-jawed chuck with the cutter pointing upwards. Position the washer (22) beneath the cutter (see drawing). Select a 4mm punch, insert it into the hole in the cutter and tap it lightly with a mallet to remove the cutter from the piston.

To fit the new cutter, position it in the piston and tap it lightly with a mallet on the cutting edge.

