

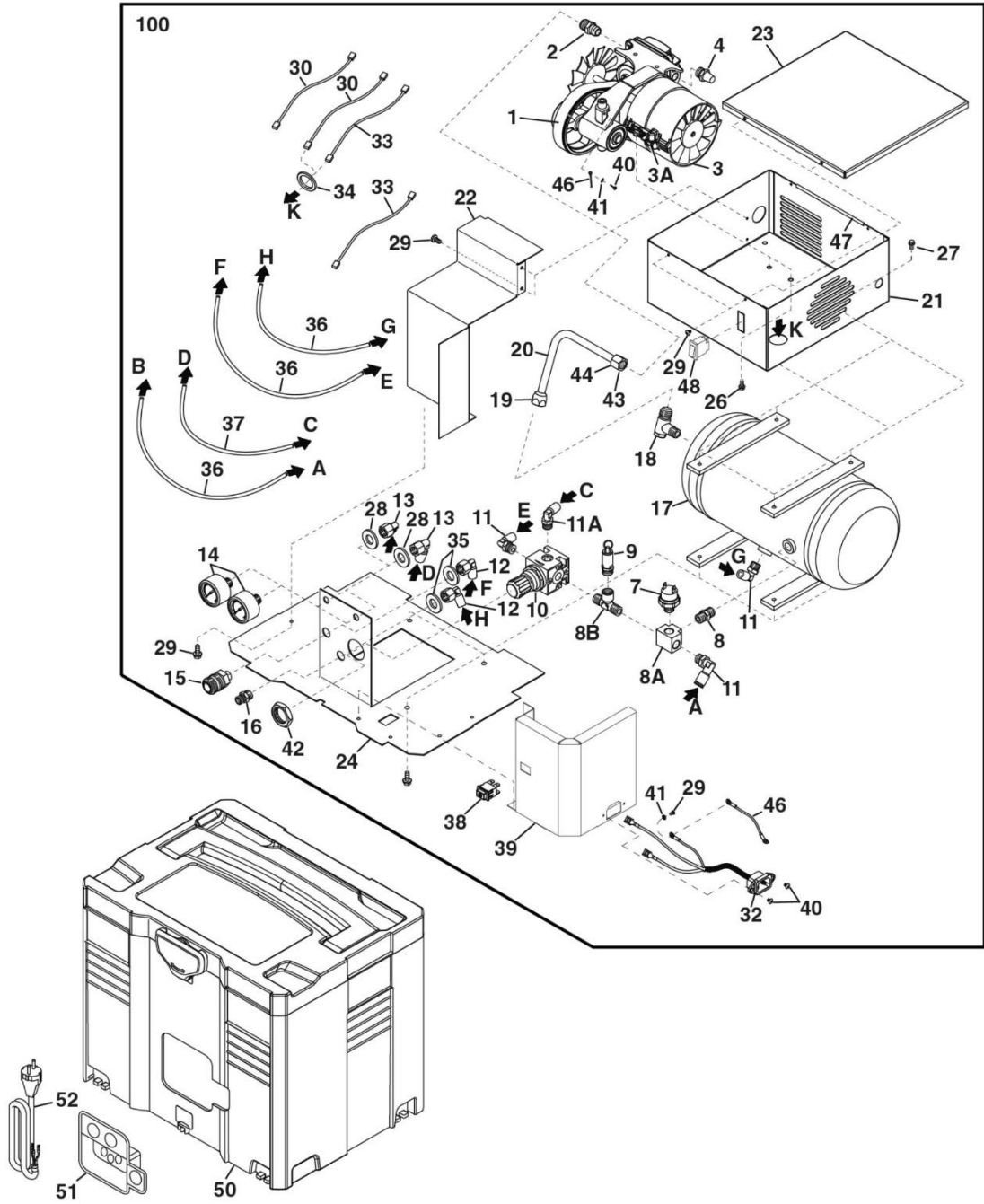

ROLAIR

SCHMATIC FOR MODEL
AIRSTAK

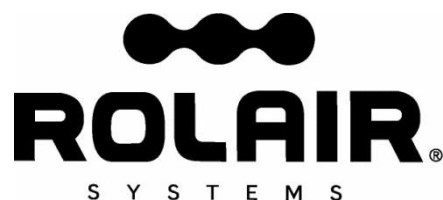



PARTS LIST FOR MODEL AIRSTAK

Sch.#	Description	Part #	Qty.	Sch.#	Description	Part #	Qty.
1	Complete Motor/Pump Assembly	AS1129704956	1	25	Screw (Vite M6x12)	NA	6
				26	Screw (Vite M6x16)	NA	1
2	Fitting	AS1129704816	1	27	Screw (Vite M6x10)	NA	4
3	Fan Cover (two-piece)	AS1129701816	2	28	Washer (10mm)	NA	2
3A	Screw (Vite ST4x16)	NA	2	29	Screw (Vite M4X6)	NA	9
4	Intake Filter	AS1129703279	1	30	Cable	AS1127320929	2
7	Pressure Switch	AS1129703664	1	32	Cable Assembly	AS1129704934	1
8	Fitting	AS1129701183	1	33	Wire Lead (30cm)	AS1129702265	2
8A	Fitting	AS1129702294	1	34	Grommett	AS1129703298	1
8B	Tee	AS1129704068	1	35	Washer (12mm)	NA	2
9	Safety Relief Valve	AS1129702591	1	36	Unloader Line Kit*	AS1127230001	3
10	Regulator	AS1127100079	1	37	Unloader Line Kit*	AS1127230001	1
11	Fitting	AS1127080424	3	38	On/Off Switch	AS1129704883	1
11A	Fitting	AS1129702612	1	39	Support Plate	AS1129700539	1
12	Fitting	AS1129703287	2	40	Screw (Vite M4x8 Taptite)	NA	3
13	Fitting	AS1127080024	2	41	Washer	NA	2
14	Gauge	AS1127110003	2	42	Nut	NA	1
15	Quick Disconnect	AS1129700276	1	43	Ferrule	AS1129700633	1
16	Drain Valve	AS1127130009	1	44	Nut (M14x1)	NA	1
17	Air Tank	AS1129704833	1	46	Wire Lead (35cm)	AS1129704935	1
18	Check Valve	AS1129701528	1	47	Rubber Strip	AS1129704831	4
19	Nut (Dado G3/8")	NA		48	Manual Reset Button	AS1127410047	1
20	Discharge Tube	AS1129704822	1	50	Outer Box	AS1125160799	1
21	Metal Box	AS1129704938	1	51	Panel	AS1127150114	1
22	Support Plate	AS1129704824	1	52	Power Cable	AS1129703660	1
23	Cover	AS1129704825	1	100	Complete Compressor Module	AS1129102745	1
24	Base Plate	AS1129704826	1				

*Kit includes all four unloader lines cut to length.

