



SERVICE PARTS LIST

BUL. 54-26-1400

IMPACT WRENCH-5/8" HEX. RECESS ANVIL

REVISED BUL. DATE
Sept. '97

Catalog No. 9060

Starting Serial No. 463-1001

WIRING INSTR. 58-01-0525

Both Model and Serial No. must be furnished to obtain correct parts.

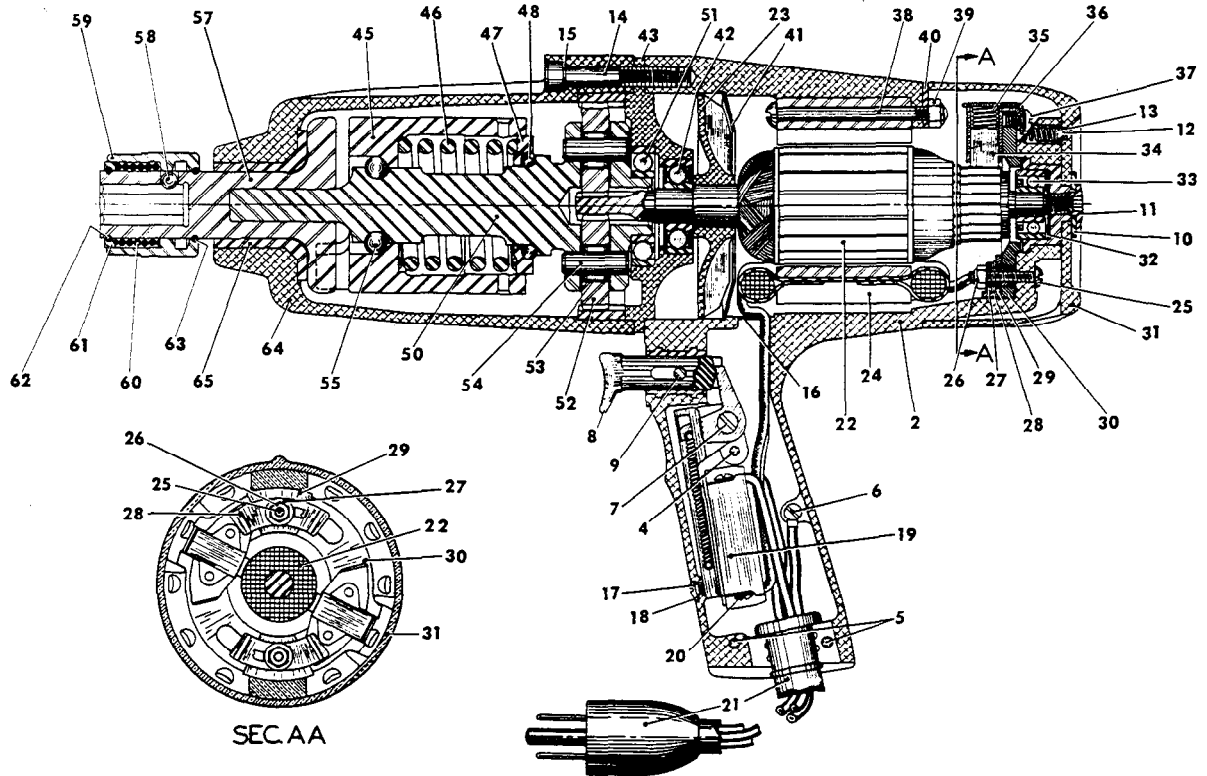

FIG.	PART NO.	DESCRIPTION OF PART	NO. REQ.	FIG.	PART NO.	DESCRIPTION OF PART	NO. REQ.
1	28-50-4050	Motor Housing Assy. (Fig. Nos. 2 thru 16)	(1)	35	23-52-0175	Brush Spring	(2)
2	28-50-4045	Motor Housing (Incl. Fig. Nos. 3 thru 7)	(1)	36	22-44-0120	Brush Retainer	(2)
3	28-20-0110	Handle Plate (Not Shown)	(1)	37	06-81-8510	5-40x1/4 Rd. Hd. Sem Screw	(2)
4	06-81-6300	8-32x7/8 Fil. Hd. Screw	(1)	38	06-81-4576	8-32x2-1/4 Rd. Hd. Screw (Incl. Fig. No. 39)	(2)
5	06-81-6150	8-32x1/2 Fil. Hd. Screw	(2)	39	06-55-0810	Nut	(2)
6	06-81-8625	6-32x1/4 Ground Screw	(1)	40	42-28-0225	Reverse Stop	(1)
7	06-81-0910	8-32x1/2 Fil. Hd. Screw	(1)	41	42-14-0170	Baffle	(1)
8	45-72-0070	Trigger	(1)	42	02-04-1230	Ball Bearing	(1)
9	44-60-0305	Trigger Stop Pin	(1)	43	28-28-0430	Diaphragm	(1)
10	45-88-0467	Washer	(1)	44	43-81-0080	Hammer Assy. (Incl. Nos. 45 thru 55)	(1)
11	45-04-0210	Cap Retaining Screw	(1)	45	43-81-0075	Hammer	(1)
12	44-70-0155	Reverse Lock Plunger	(2)	46	40-50-7580	Hammer Spring	(1)
13	40-50-5050	Reverse Lock Plunger Spring	(2)	47	42-24-0195	Thrust Bearing Race	(1)
14	06-75-3250	1/4-20x1-1/2 Socket Hd. Screw	(3)	48	02-80-6005	Thrust Bearing Ball	(20)
15	06-97-4000	1/4" Split Ring Washer	(3)	49	36-10-0815	Planet Gear Frame Assy. (Fig. Nos. 50 thru 54)	(1)
16	45-12-0065	Dust Shield	(1)	50	36-10-0812	Planet Gear Frame	(1)
17	06-81-3250	4-36x5/16 Oval Hd. Screw	(1)	★51	02-08-0750	Thrust Bearing	(1)
18	06-97-0405	Washer	(1)	52	32-62-0065	Planet Gear (Incl. Fig. No. 53)	(2)
19	23-66-0585	Switch	(1)	53	02-50-2010	Planet Gear Needle Bearing	(2)
20	06-81-8510	5-40x1/4 Rd. Hd. Sem Screw	(4)	54	45-58-0195	Planet Gear Shaft	(2)
21	22-64-0425	Cord Set	(1)	55	02-02-2005	Cam Ball	(2)
22	16-42-1365	Armature (Incl. Fig. No. 23)	(1)	56	42-06-0095	Quick Change Anvil Assy. (Fig. Nos. 57 thru 63)	(1)
23	22-84-0075	Fan	(1)	57	42-06-0090	Quick Change Anvil	(1)
24	18-42-1205	Field	(1)	58	02-02-2005	Retaining Ball	(1)
25	06-81-4554	6-32x7/8 Rd. Hd. Screw (Incl. Fig. No. 26)	(2)	59	45-22-0160	Retaining Sleeve	(1)
26	06-55-0610	Nut	(2)	60	40-50-0825	Retaining Sleeve Spring	(1)
27	23-16-0335	Insulating Bushing	(2)	61	44-90-0250	Thrust Ring	(1)
28	22-58-0065	Stationary Contact	(2)	62	44-90-0260	Thrust Ring Lock	(1)
29	45-36-0475	Plate Spacer	(2)	63	44-90-0260	Retaining Sleeve Stop	(1)
30	22-22-0310	Brush Holder Plate	(1)	64	28-14-1295	Hammer Case Assy. (Incl. Fig. No. 65)	(1)
31	42-52-0145	Reverse Cap with Nameplate	(1)	65	42-40-0475	Hammer Case Bushing	(1)
32	40-50-7690	Rear Armature Bearing Spring	(1)	66	12-98-0130	Blank Nameplate (Not Shown)	(1)
33	02-04-5013	Ball Bearing	(1)	67	23-16-0695	Brush Insulator (Not Shown)	(2)
34	22-16-0265	Brush	(2)				

MILWAUKEE ELECTRIC TOOL CORP.

13135 West Lisbon Road • Brookfield, Wisconsin 53005
Dwg. 1