

PORTER-CABLE PORTABLE TAPPER

7520

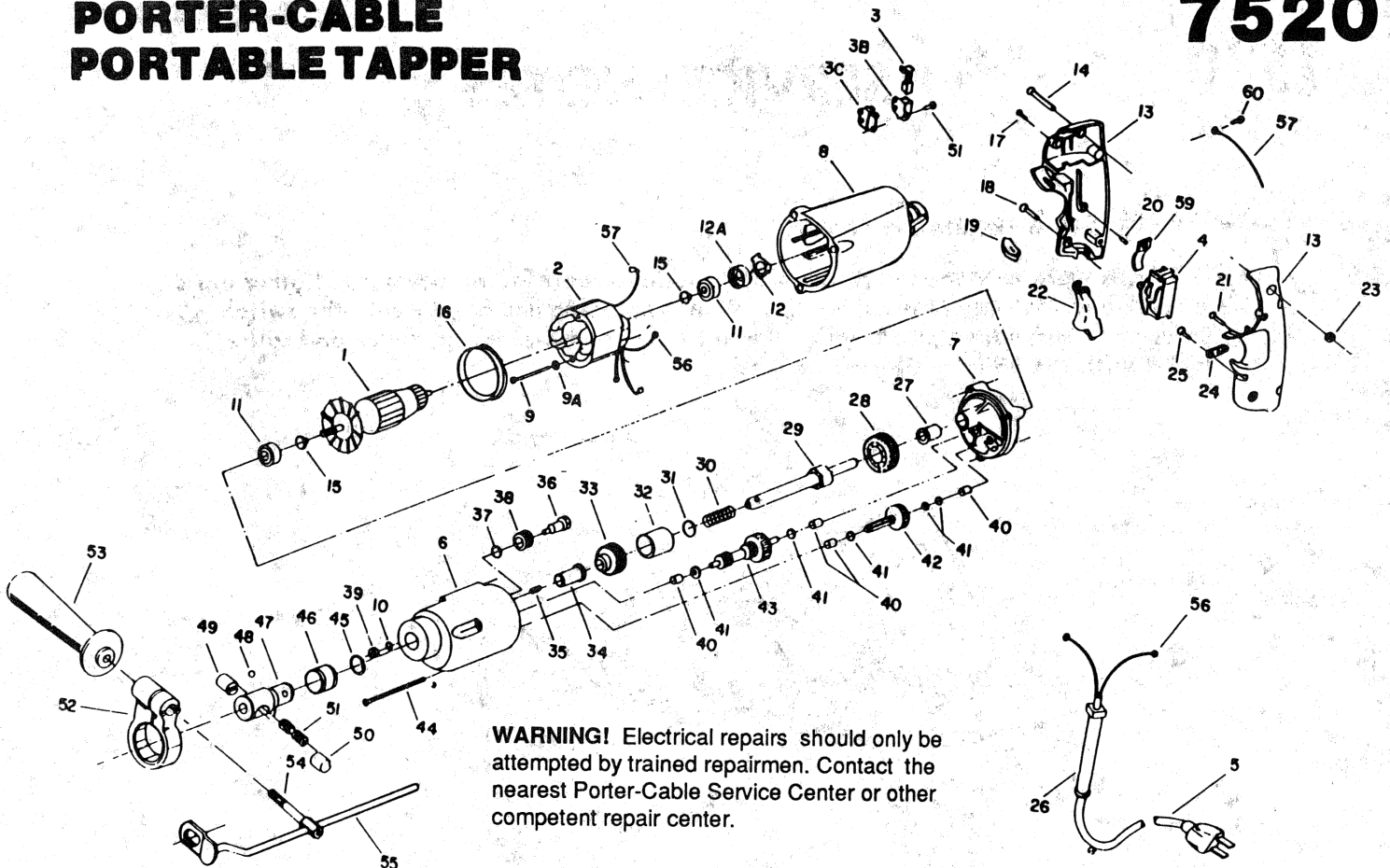

WARNING! Electrical repairs should only be attempted by trained repairmen. Contact the nearest Porter-Cable Service Center or other competent repair center.

Ref. No.	Part No.	Description
1	872641	Armature, T4
	865734	Armature, T1, T2, T3
2 n	872646	Field, T4
	865736	Field, T1, T2, T3
3	869734	Brush T2, T3
	865941	Brush & Holder Assy T1
3B	869691	Brush Holder T2, T3, T4
3C	811490	Brush Insulator T2, T3, T4
4	847546**	Switch
5	865619	Cord
6	860543	Gear Housing Assy, Incl: Ref. 34, 40
7	860544	Int. Plate Assy, Incl: Ref. 27, 40
8	697543**	Motor Housing, T3, T4
	868219	Motor Housing T2, Incl: Ref. 12A
	865245	Motor Housing T1
9	699085**	Screw, Late T3, T4
	860902	Screw, Except Late T3, T4
9A	802214	Washer, Late T3, T4
10	863428	Washer
11	855284	Armature Bearing
12	842610	Loading Spring (Early)
12A	694432	Bearing Mount (Current)
13	691682	Handle Set T2, T3, T4 Incl: Ref. 14,17,18, 19,21,22,23,59
	868557**	Handle Set T1, Incl: Ref. 14,17,18, 19,20,21,22,23,59
14	865643	Screw
15	847564	Snap Ring (Service Only)
16	811350	Baffle
17	866340	Screw
18	841644	Screw
19	866614	Insert
20	810425	Plug
21	859384	Screw
22	811546	Actuator T2, T3, T4
	868583**	Actuator T1
23	828841	Nut
24	861434	Cord Clamp
25	859227	Screw
26	810882	Strain Reliever
27	810954	Spindle Bearing (Int Plt)
28	859646	Gear

Ref. No.	Part No.	Description
29	859924	Spindle Shaft Assy
30	860433	Spring
31	860432	Washer
32	860411	Spacer
33	859970	Gear
34	810953	Spindle Bearing (Gear Hsg)
35	860947	Spring
36	860413	Shoulder Bolt
37	860476	Washer
38	860414	Idler Gear
39	804469	Nut
40	860412	Needle Bearing
41	845787	Washer
42	860410	Gear Assy
43	860415	Gear Assy
44	699106**	Screw, Late T3, T4
	865683	Screw, Except Late T3, T4
45	859896	Retaining Ring
46	860495	Lock Ring
47	860497	Chuck Body
48	854321	Steel Ball
49	860492	Chuck Jaw (R.H. Thread)
50	860493	Chuck Jaw (L.H. Thread)
51	860491	Chuck Screw
52	859641	Stop Clamp
53	810702	Auxiliary Handle
54	859642	Clamp Screw Assy.
55	859781	Depth Rod
56	849314	Terminal
57 n	698571	Lead Assy T2, T3, T4
	865774	Lead Assy T1
58	864136	Brush Holder Screw T2, T3, T4
	860756	Brush Holder Screw T1
59	869671	Switch Clamp T2, T3, T4
	847555	Switch Clamp T1
60	864137	Screw
*	811292	Fan
*	59842	Lubricant Tube (5 1/2 oz) (156 gm)
		Gear Housing Cap (1.75 oz) (49.5 gm)

**See Service Notes
*Not Shown

PARTS LIST NO. 872185 - 199

Copyright © 1991 PORTER-CABLE Corporation

PORTER-CABLE
PROFESSIONAL POWER TOOLS

Switch #847546 & Handle Set #868557

Type 1 units were produced with the switch actuator ball facing down. All other units were produced with the ball facing up. When replacing the handle set, the switch actuator ball must face upward (as pictured below) and the new actuator and roller included with the handle set must be used.

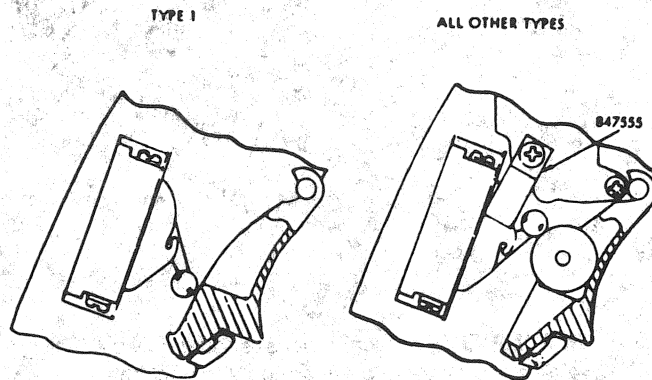
**SWITCH #847546 & HANDLE SET #868557**

Type 1 units were produced with the switch actuator ball facing down. All other units were produced with the ball facing up. When replacing the handle set, the switch actuator ball must face upward (as pictured below) and the new actuator and roller included with the handle set must be used.

MOTOR HOUSING/SCREWS T3

Early motor housings had threaded inserts molded in for gear housing screws and field screws. Current motor housings do not have inserts and require self-tapping screws.

Service replacement housings will be the current type and will include the necessary self-tapping screws.