



# Rockwell

MANUFACTURING COMPANY

The Rockwell Building • Pittsburgh, Pa.

## ROCKWELL

## MODEL 744 — POWER UNIT

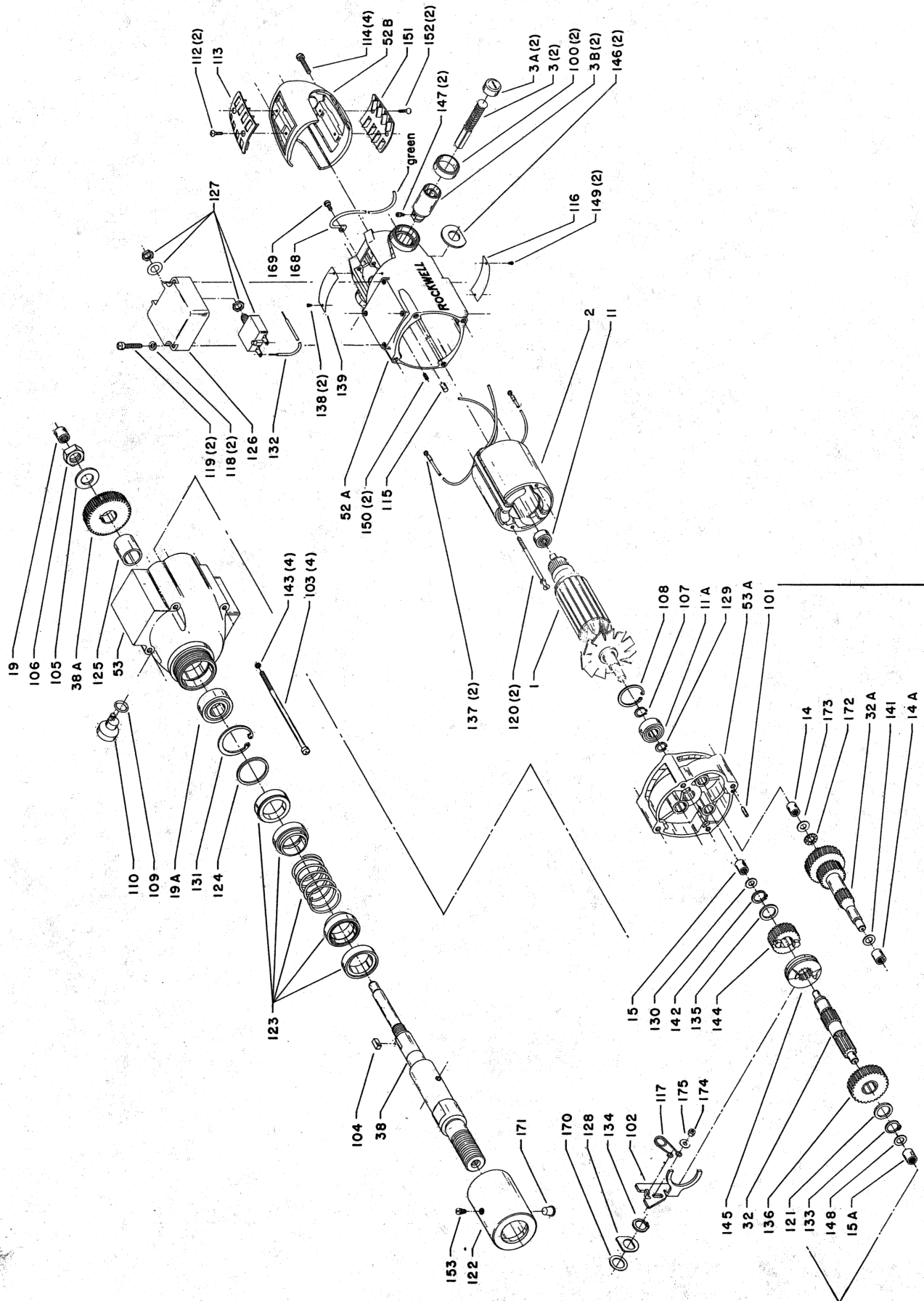

Ref. No.	Part No.	Description	Ref. No.	Part No.	Description
** 1	54031	Armature - 115V	120	58444	Field Screw
** 1	859177	Armature - 220V	121	54097	Lo Speed Gear Washer
** 2	54025	Field - 115V	122	51453	Water Swivel Jacket
** 2	859178	Field - 220V	123	57132	Rotary Seal
3	53274	Brush	124	57086	Rotary Seal Thrust Washer
3A	51403	Brush Cap	125	57085	Spindle Outer Bearing Spacer
11	55205	Armature Commutator End Bearing	126	57145	Circuit Breaker Cover
11A	55228	Armature Fan End Bearing	127	49374	Circuit Breaker (115V Only)
19A	55593	Water Swivel Shaft Outer Bearing	127	57346	Circuit Breaker (220V Only)
32	53245	2nd Idler	128	53242	Speed Shift Slide Stop
32A	54214	1st Idler Assembly, includes:	129	53455	Armature Fan End Bearing Inner Race Ring
*	41002	Key			
*	53240	Drive Gear	130	51584	2nd Idler Inner Thrust Washer
*	53974	Shaft	131	51563	Spindle Outer Bearing Ring
38	51454	Water Swivel Shaft	132	57175	Circuit Breaker Lead
38A	53945	Spindle Gear	133	54096	Lo Speed Gear Ring
52A	54261	Motor Housing Assembly, includes:	134	54096	Speed Shift Knob Ring
3B	51276	Brush Holder	135	54097	Hi Speed Gear Washer
100	51676	Brush Cap Shield	136	54223	Lo Speed Gear
150	439XA	Brush Holder Screw	137	2014X	Field Terminal
52B	50773	Motor Housing Cover	138	1188X	Model Specification Plate Screw
53	54228	Gear Housing & Bearing Assembly, includes:	139	54421	Model Specification Plate (Model 744 Only)
14A	50848	1st Idler Outer Bearing	139	859251	Model Specification Plate (Model 744VD Only)
15A	859355	2nd Idler Outer Bearing			
*	55484	Heli-Coil Insert (4)	141	54212	1st Idler Outer Thrust Washer
53A	54232	Intermediate Housing Assy., includes:	142	54096	Hi Speed Gear Ring
14	859356	1st Idler Inner Bearing	143	57531	Gear Housing Lock Washer
15	51564	2nd Idler Inner Bearing	144	54224	Hi Speed Gear
19	569X	Water Swivel Shaft Inner Bearing	145	53250	Gear Selector
101	47169	Intermediate Housing Locating Pin	146	53518	Brush Holder Washer
102	53241	Speed Shift Slide	147	51296	Brush Lead Screw
103	57059	Gear Housing Screw	148	54212	2nd Idler Outer Thrust Washer
104	860059	Spindle Key	149	1188X	Speed Specification Plate Screw
105	54211	Spindle Gear Washer	151	57093	Air Intake Plate
106	50658	Spindle Gear Nut	152	52511	Air Intake Plate Screw
107	53246	Armature Fan End Bearing Spacer Ring	153	791X	Rotary Seal Jacket Pipe Plug
108	1960X	Armature Fan End Bearing Outer Race Ring	168	858944	Ground Wire Assembly
109	39766	Speed Shift Knob "O" Ring	169	2571X	Ground Wire Screw
110	54225	Speed Shift Knob	170	859731	Speed Shift Knob Outer Washer
112	52511	Air Intake Plate Screw	171	859685	Cap Plug
113	57093	Air Intake Plate	172	859706	1st Idler Thrust Bearing
114	51281	Motor Housing Cover Screw	173	859707	1st Idler Thrust Race
115	42597	Armature Commutator End Bearing Plug	174	28841	Speed Shift Knob Nut
116	54535	Speed Specification Plate	175	703X	Speed Shift Knob Inner Washer
117	53238	Speed Shift Slide Spring	*	52665	Armature Fan (Service Only)
118	194XS	Circuit Breaker Cover Lock Washer			
119	26020	Circuit Breaker Cover Screw			
				LUBRICANTS	
				860668	Gear Lubricant

\* Not shown.

\*\* When ordering a Field and/or Armature, please give the Number(s) stamped on the lamination stacking and/or armature wedges, all information shown on the Model and Speed Specification Plates on the Power Unit, and the Part Number(s) and complete Description(s) as listed above.

When ordering other parts, please give all information shown on the Model and Speed Specification Plates on the Power Unit, and the Part Number(s) and complete Description(s) as listed above.

Parts and specifications subject to change without notice.