



SERVICE PARTS LIST

BULLETIN NO.
55-42-6170

SPECIFY CATALOG NO. AND SERIAL NO. WHEN ORDERING PARTS		REVISED BULLETIN	DATE
DRYWALL SCREWDRIVER			Aug. 2012
CATALOG NO. 6742-59	STARTING SERIAL NO. D72A	WIRING INSTRUCTION See Pages 2 & 3	

EXAMPLE:
Component Parts (Small #) Are Included
When Ordering The Assembly (Large #).

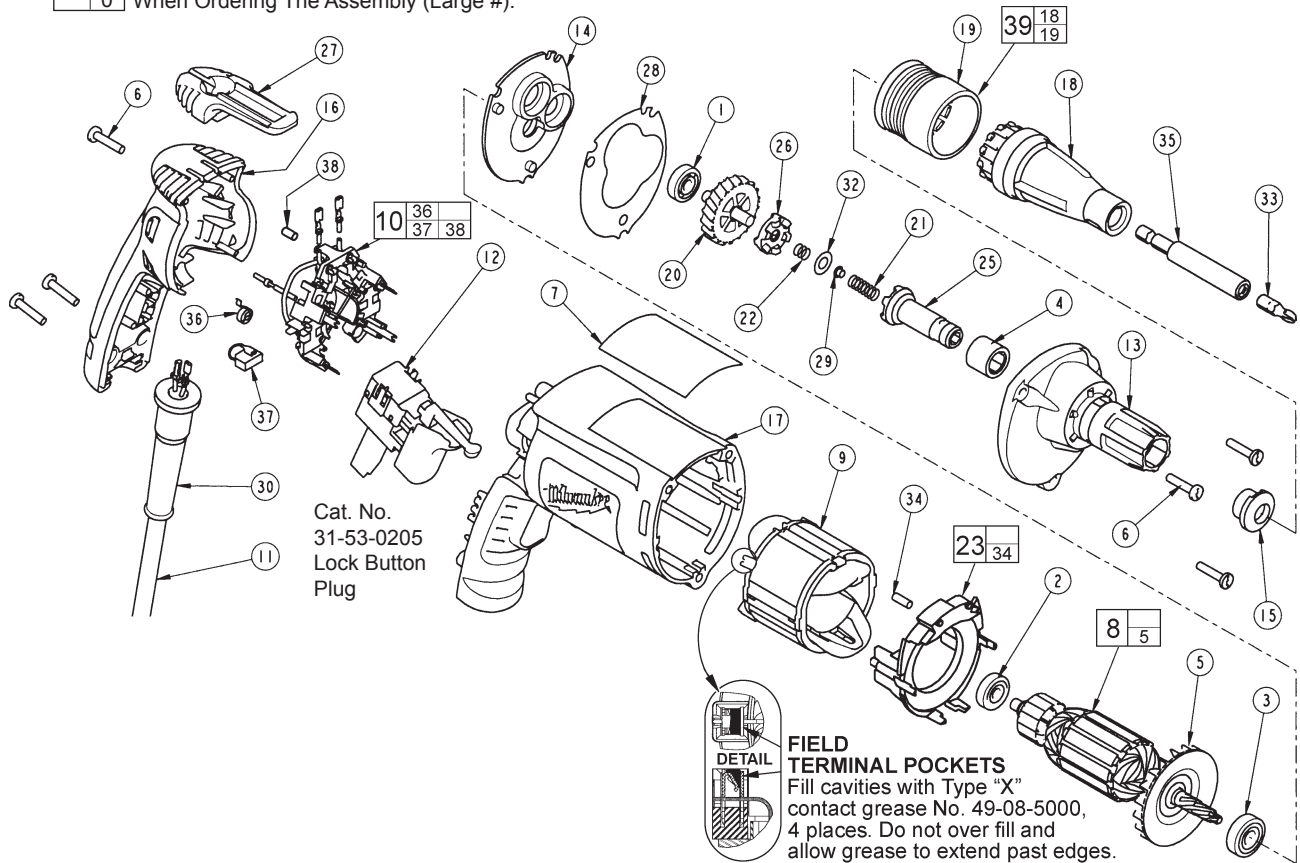

Cat. No.
31-53-0205
Lock Button
Plug

FIELD TERMINAL POCKETS
Fill cavities with Type "X" contact grease No. 49-08-5000, 4 places. Do not over fill and allow grease to extend past edges.

FIG.	PART NO.	DESCRIPTION OF PART	NO. REQ.
1	02-04-0640	Ball Bearing	(1)
2	02-04-0645	Ball Bearing	(1)
3	02-04-0852	Ball Bearing	(1)
4	02-50-3245	Needle Bearing	(1)
5	22-84-0840	Fan	(1)
6	06-82-7275	7-18 x 3/4" Slotted Plastite Torx T-20	(6)
7	12-99-2665	Service Nameplate	(1)
8	16-14-2201	Armature	(1)
9	18-04-2200	Field	(1)
10	22-18-1220	Brush Card Assembly	(1)
11	22-64-1215	Cord Assembly	(1)
12a	23-66-2615	230V Defond Switch (See page 2)	(1)
12b	23-66-2135	230V Marquardt Switch (See page 3)	(1)
13	28-14-2375	Gearcase	(1)
14	28-28-2315	Diaphragm	(1)
15	30-37-0046	Drywall Nose Guide	(1)
16	31-15-2010	Handle Halve	(1)
17	31-50-4010	Motor Housing	(1)
18	31-51-0095	Drywall Locator	(1)
19	31-58-0515	Snap Sleeve	(1)
20	32-10-0521	Clutch Gear Assembly	(1)
21	40-50-0095	Separator Spring	(1)
22	40-50-8515	Bias Spring	(1)
23	42-14-0460	Baffle Assembly	(1)
25	42-66-0715	Clutch Chuck Assembly	(1)
26	42-70-0310	Drive Clutch	(1)
27	42-70-5280	Belt Clip	(1)
28	43-44-0985	Gasket	(1)
29	44-60-0505	Thrust Pin	(1)
30	44-76-0210	Cord Protector	(1)
32	45-88-0555	Clutch Thrust Washer	(1)
33	-----	#2 Phillips Insert Bit	(1)
34	45-30-0030	Slug	(2)

FIG.	PART NO.	DESCRIPTION OF PART	NO. REQ.
35	48-32-3065	Magnetic Bit Holder	(1)
36	23-52-1610	Brush Spring	(2)
37	22-18-1310	Brush Assembly	(2)
38	45-30-0035	Slug	(1)
39	49-26-1036	Drywall Locator Assembly	(1)

LUBRICATION (Type "Y" Grease, No. 49-08-5270)

- Fill the 3 enlarged clutch pockets of the clutch gear assembly (20) with .5 gm. (.02 oz.) grease.
- Apply the same amount of grease in the bias spring (22).
- Apply in total .5 gm. (.02 oz.) grease to the clutch thrust washer (32), thrust pin (29) and separator spring (21).
- Place 7.7 gm. (.27 oz.) of grease at the armature pin location in the gearcase (13) and fill to slightly above the next higher gearcase level.
- Apply a light film of grease to the lead chamfer of the clutch chuck (25) prior to assembly.

Before assembly, lightly coat all press fit areas with lightweight spindle oil.

FIG. NOTES:

- 4 Needle bearing to have it's seal toward the front of the tool. Needle bearing to be pressed .133/.143 under flush.

WIRING INSTRUCTIONS

TITLE SINGLE REDUCTION PISTOL GRIP TOOLS - DEFOND SWITCH

BULLETIN

MILWAUKEE ELECTRIC TOOL CORP. 13135 WEST LISBON RD. BROOKFIELD, WIS.

DATE

Route white field wire #5 from brush card between the post and the top of the rear bearing bore first and then around bearing bore as shown.

Route blue brush wire #8 and white brush wire #9 through wire traps and over rear bearing bore as shown.

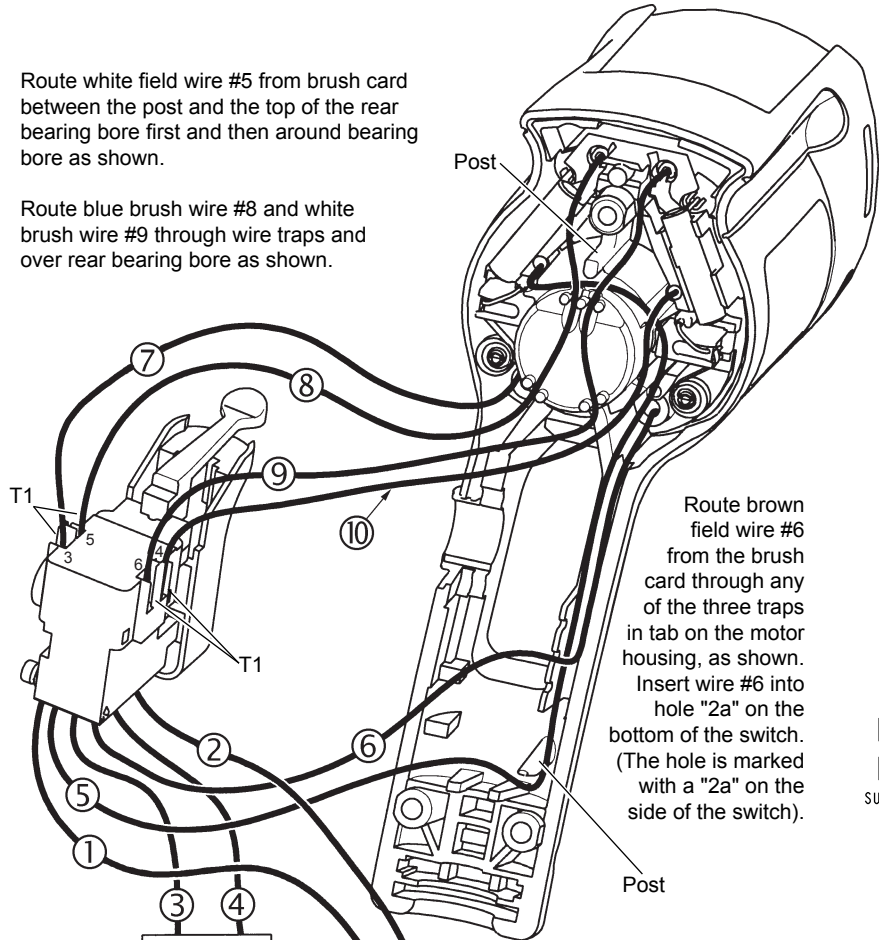

Route brown field wire #6 from the brush card through any of the three traps in tab on the motor housing, as shown. Insert wire #6 into hole "2a" on the bottom of the switch. (The hole is marked with a "2a" on the side of the switch).

Insert black suppressor wires #3 and #4 into holes marked "1a" and "2b" on the bottom of the switch. Wires can go in either hole.

Fixed cord shown

Route white field wire #5 from the brush card around the post in the motor housing and into either hole "1a" and "2b" on the bottom of the switch.

Insert brown wire #1, from the cord or blade housing assembly, into the hole marked "2" on the bottom of the switch.

Insert blue wire #2, from the cord or blade housing assembly, into the hole marked "1" on the bottom of the switch.

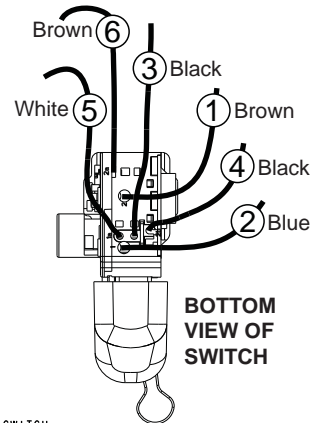

BOTTOM VIEW OF SWITCH

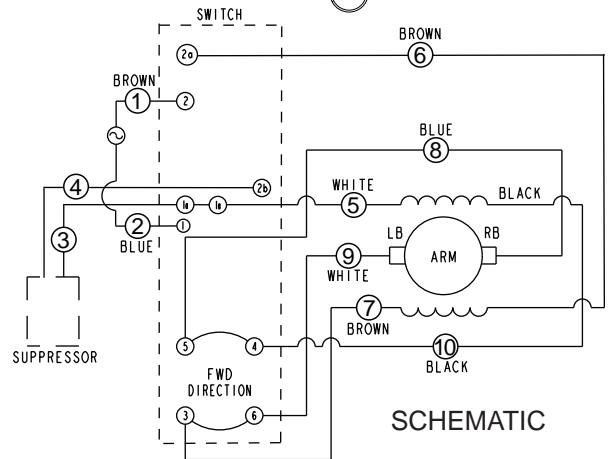

SCHEMATIC

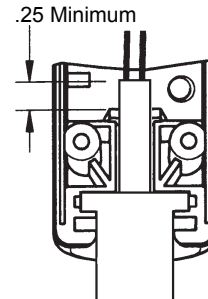

Fixed Cord Installation

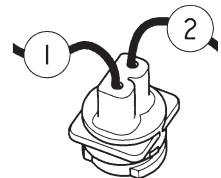

For double insulated tools with 2-wire quik-lok cords, orientate the blade housing assembly as shown and place blue wire #2 first into the bottom of the handle portion of the motor housing.

WIRING SPECIFICATIONS

Wire No.	Wire Color	Origin or Gauge	Length	Terminals, Connectors and 1 or 2 End Wire Preparation
1	Brown	*	----	* Component of cord set or blade housing assembly.
2	Blue	*	----	* Component of cord set or blade housing assembly.
3	Black	**	----	** Component of suppressor assembly.
4	Black	**	----	** Component of suppressor assembly.
5	White	***	----	*** Component of the brush card assembly.
6	Brown	***	----	*** Component of the brush card assembly.
7	Brown	***	----	*** Component of the brush card assembly.
8	Blue	***	----	*** Component of the brush card assembly.
9	White	***	----	*** Component of the brush card assembly.
10	Black	***	----	*** Component of the brush card assembly.

BULK LEAD WIRE - BULLETIN NO. 58-01-0003

TERMINAL DESCRIPTION

Code	Part No.	Qty.
T1	23-74-1060	

WIRING INSTRUCTIONS

TITLE **SINGLE REDUCTION PISTOL GRIP TOOLS - MARQUARDT SWITCH**

BULLETIN

MILWAUKEE ELECTRIC TOOL CORP. 13135 WEST LISBON RD. BROOKFIELD, WIS.

DATE

Route white field wire #5 from brush card between the post and the top of the rear bearing bore first and then around bearing bore as shown.

Route blue brush wire #8 and white brush wire #9 through wire traps and over rear bearing bore as shown.

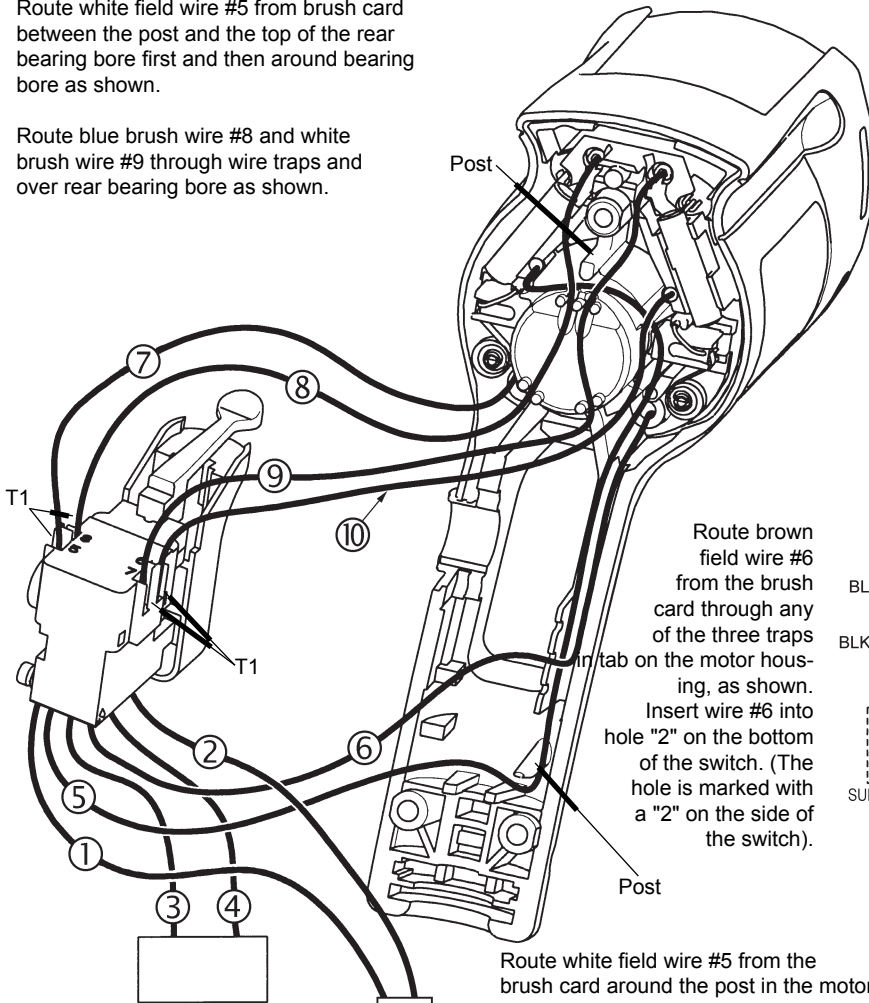

Route brown field wire #6 from the brush card through any of the three traps in a tab on the motor housing, as shown. Insert wire #6 into hole "2" on the bottom of the switch. (The hole is marked with a "2" on the side of the switch).

Route white field wire #5 from the brush card around the post in the motor housing and into either hole "1" and "2A" on the bottom of the switch.

Insert brown wire #1, from the cord or blade housing assembly, into the hole marked "2" on the bottom of the switch.

Insert blue wire #2, from the cord or blade housing assembly, into the hole marked "1" on the bottom of the switch.

Insert black suppressor wires #3 and #4 into holes marked "1" and "2A" on the bottom of the switch. Wires can go in either hole.

Fixed cord shown

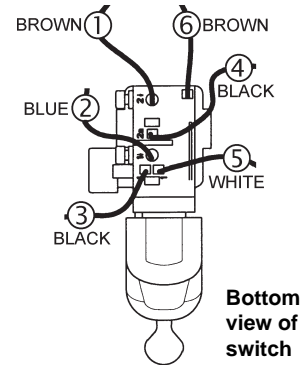

Bottom view of switch

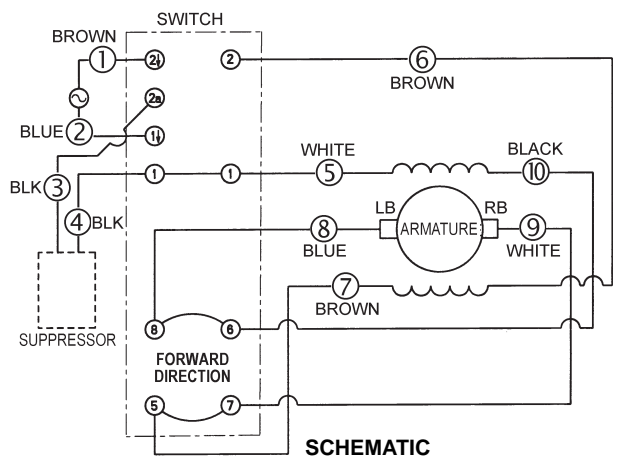

SCHEMATIC

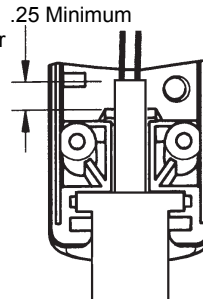

Fixed Cord Installation

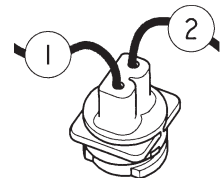

For double insulated tools with 2-wire quik-lok cords, orientate the blade housing assembly as shown and place blue wire #2 first into the bottom of the handle portion of the motor housing.

WIRING SPECIFICATIONS

Wire No.	Wire Color	Origin or Gauge	Length	Terminals, Connectors and 1 or 2 End Wire Preparation
1	Brown	*	----	* Component of cord set or blade housing assembly.
2	Blue	*	----	* Component of cord set or blade housing assembly.
3	Black	**	----	** Component of suppressor assembly.
4	Black	**	----	** Component of suppressor assembly.
5	White	***	----	*** Component of the brush card assembly.
6	Brown	***	----	*** Component of the brush card assembly.
7	Brown	***	----	*** Component of the brush card assembly.
8	Blue	***	----	*** Component of the brush card assembly.
9	White	***	----	*** Component of the brush card assembly.
10	Black	***	----	*** Component of the brush card assembly.

BULK LEAD WIRE - BULLETIN NO. 58-01-0003

TERMINAL DESCRIPTION

Code	Part No.	Qty.
T1	23-74-1060	