

PORTER-CABLE DISC SANDER/POLISHER

WARNING: Electrical repairs should only be attempted by trained repairmen. Contact the nearest Porter-Cable Service Center or other competent repair center.

660
661
662

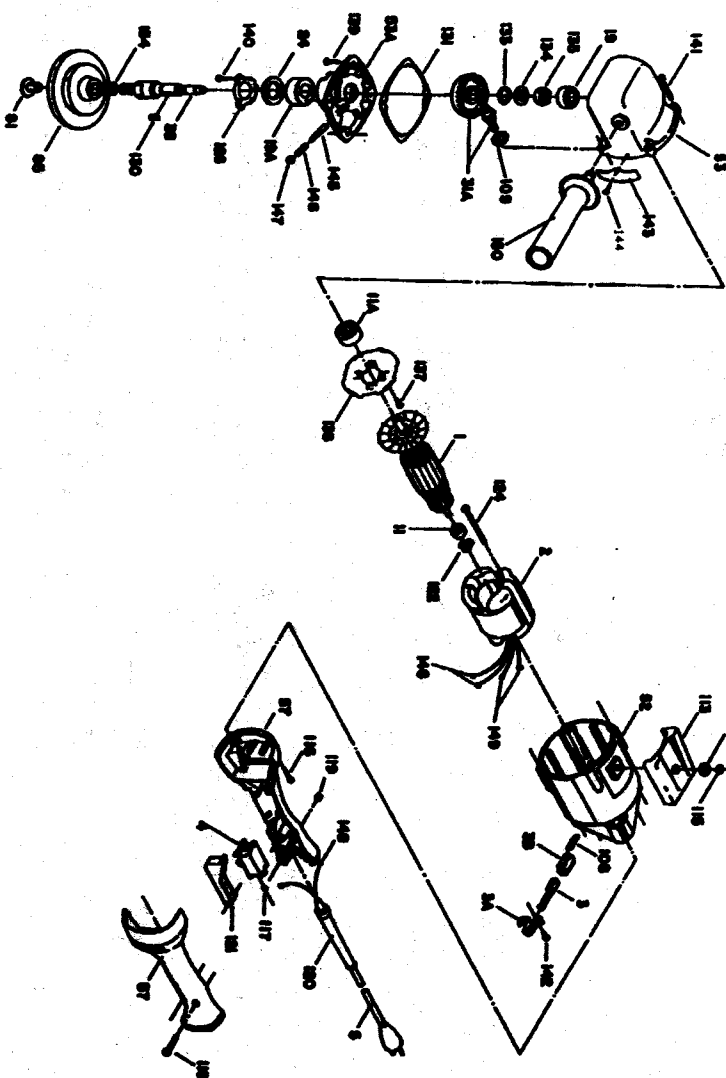

Parts List for 662 Type 2

| Item Number | Part Number | Description | Qty Required |
|-------------|-------------|----------------------|--------------|
| 1 | 868499 | ARMATURE 115V | 1 |
| 1 | 000000-00 | No Longer Available | 1 |
| 2 | 868500 | FIELD 115V | 1 |
| 3 | 874289 | BRUSH & RETAINER ASY | 2 |
| 3 | 874289 | BRUSH & RETAINER ASY | 1 |
| 3 | 865323 | BRUSH HOLDER | 2 |
| 4 | 000000-00 | No Longer Available | 1 |
| 5 | A10193 | CORDSET | 1 |
| 5 | 876246 | CORD | 1 |
| 11 | 330003-85 | BEARING | 3 |
| 11 | 878064SV | BEARING | 3 |
| 19 | 804218SV | BEARING | 3 |
| 19 | 838028SV | BEARING | 3 |
| 24 | 000000-00 | No Longer Available | 1 |
| 31 | 000000-00 | No Longer Available | 1 |
| 31 | 000000-00 | No Longer Available | 1 |
| 38 | 868085 | SPINDLE | 1 |
| 52 | 000000-00 | No Longer Available | 1 |
| 53 | 865952 | GEAR HOUSING | 1 |
| 53 | 000000-00 | No Longer Available | 1 |
| 57 | 000000-00 | No Longer Available | 1 |
| 81 | 55747 | ARBOR RETAINING NUT | 1 |
| 81 | 000000-00 | No Longer Available | 10 |
| 85 | 55741 | ABR BACK UP KIT 7IN | 1 |
| 85 | 869538 | BACK-UP PAD 661 | 1 |
| 108 | 865321 | BRUSH INSULATOR | 2 |
| 109 | 869285 | SPACER | 10 |

Parts List for 662 Type 2

| Item Number | Part Number | Description | Qty Required |
|-------------|-------------|---------------------|--------------|
| 113 | 810431 | TOOL REST | 1 |
| 114 | 000000-00 | No Longer Available | 1 |
| 115 | 000000-00 | No Longer Available | 1 |
| 116 | 900826 | SCREW | 10 |
| 117 | 000000-00 | No Longer Available | 10 |
| 118 | 900826 | SCREW | 10 |
| 119 | 862641 | NUT | 10 |
| 120 | 901266 | STRAIN RELIEVER | 1 |
| 121 | 000000-00 | No Longer Available | 1 |
| 122 | 842610 | SPRING-PRELOAD | 10 |
| 122 | 694432 | BEARING MOUNT | 3 |
| 124 | 868884 | SCREW | 10 |
| 128 | 000000-00 | No Longer Available | 3 |
| 130 | 000000-00 | No Longer Available | 1 |
| 131 | 000000-00 | No Longer Available | 10 |
| 131 | 000000-00 | No Longer Available | 10 |
| 133 | 000000-00 | No Longer Available | 1 |
| 134 | 000000-00 | No Longer Available | 1 |
| 135 | 000000-00 | No Longer Available | 1 |
| 137 | 882187 | SCREW | 10 |
| 138 | 853640 | BRG. RETAINER | 3 |
| 139 | 696276 | SCREW | 10 |
| 140 | 883485 | SCREW | 10 |
| 141 | 864721 | SCREW | 10 |
| 142 | 802764 | SCREW | 10 |
| 142 | 882703 | SCREW | 10 |
| 143 | 858727 | COVER | 1 |

Parts List for 662 Type 2

| Item Number | Part Number | Description | Qty Required |
|-------------|-------------|---------------------|--------------|
| 144 | 5140069-51 | SCREW | 10 |
| 145 | 000000-00 | No Longer Available | 10 |
| 146 | 000000-00 | No Longer Available | 10 |
| 147 | 000000-00 | No Longer Available | 1 |
| 148 | 862450 | TERMINAL | 1 |
| 149 | 849314 | TERM | 1 |
| 149 | 000000-00 | No Longer Available | 1 |
| 150 | 695146 | HANDLE | 1 |
| 153 | 801530 | WASHER | 10 |
| 154 | 825571 | SPACER | 10 |
| 155 | 825571 | SPACER | 10 |
| 800 | 000000-00 | No Longer Available | 1 |
| 800 | 879751 | LUBRICANT 4 LBS | 1 |