



# SERVICE PARTS LIST

**BUL. 54-42-2011**

## SCREWDRIVER

REVISED BUL. 697-2      DATE Feb. '68

**MODEL NO. 615B**

Starting Serial No. **97-1225**

WIRING INSTR.

Both Model and Serial No. must be furnished to obtain correct parts.

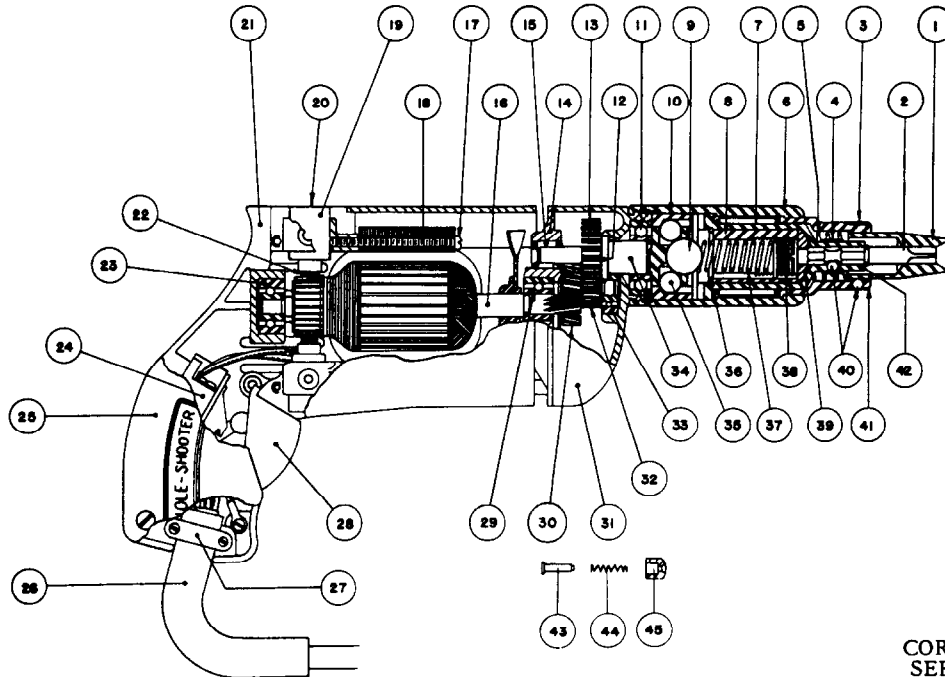

**CORRECTS & SUPERCEDES SERVICE BULLETIN 697-2 DATED 2-15-56**

### ILLUSTRATED PARTS

FIG.	PART NO.	NAME OF PART	FIG.	PART NO.	NAME OF PART
1	Specify Size	Finder Sleeves	24	8909K-209	Switch
2	Specify Size	Hexagonal Bits	25	3B1-1	Handle Cover
3	6A22-1	Finder Retaining Spring	26	8B-28	Cord Protector Tube
4	6A21-1	Bit Retaining Spring	27	8B1-3	Cord Clamp
5	6A22-2	Finder Spring	28	3B1-2	Switch Trigger
6	6A-20	Sleeve	29	WC87037	Armature Ball Bearing (Pinion End)
7	B-1616	Clutch Assembly Needle Bearing	30	6A-14	Intermediate Gear
8	6A21-2A	Threaded Insert	31	3A-3C	Gear Case
9	9/16" Dia.	Master Ball	32	1A-13	Intermediate Pinion Shaft
10	6A8-1	Clutch Collar	33	ND36	Pinion Shaft Ball Bearing
11	773L00	Spindle Ball Bearing	34	6A-8A	Spindle
12	XSO-219	Spindle Snap Ring	35	5/16" Dia.	Driving Balls
13	1A-111	Spindle Gear	36	XRO-432	Retaining Ring
14	3A-2C	Diaphragm	37	6A21-4	Torque Limiting Spring (Heavy-Red)
15	M-471	Spindle Needle Bearing	37a	6A21-5&7	Torque Limiting Spring (Med.-Plain & Lt.-Blue)
16	7B-600	Armature Assembly	38	6A21-3	Adjusting Screw
17	#6-32x1-3/4"	Fil. Hd. Field Screws (2)	39	6A21-6	Bit Backing Washer
18	8B-704	Field Assembly	40	5/32" Dia.	Bit and Finder Retaining Balls each
19	7B-320	Brush Holder Assembly	41	6A-22	Finder Guide
20	3A-40	Brush Retaining Cap (2)	42	6A-21A	Chuck
21	3B-1A	Motor Housing	43	3B15-1	Trigger Lock Shaft
22	8B-370	Carbon Brush Assemblies (2)	44	3A15-4	Trigger Lock Spring
23	WC87037	Ball Bearing	45	3A15-2	Trigger Lock Button

### MISCELLANEOUS PARTS NOT SHOWN

SIZE OR PART NO.	DESCRIPTION OF PART	SIZE OR PART NO.	DESCRIPTION OF PART
M-361	Int. Pinion Needle Ball Brg.(1)	#6-32x1/4" (Brass)	Rd. Hd. (1)
3P-1	Attachment Plug	#8-32x1-3/8" Fil. Hd.	Gear Case Screws (2)
18G-8SR1	Cord 3-Wire	#8-32x7/8" Fil. Hd.	Gear Case Screws (2)
#6-32x5/16" Fil. Hd.	Sem. Switch Mounting Screw (1)	#4x1/4" Drive-In	Name Plate Screws (2)
#8-32x3/4" Fil. Hd.	Handle Cover Screws (3)	614B	Name Plate (1)
#10-32x1/4" Hd'less	Slotted Brush Holder Screws (2)	#201	Woodruff Key (1)
#8-32x1/2" Fil. Hd.	Cord Clamp Screws (2)	#207	Woodruff Key (1)
		3PA-1	Attachment Plug Adaptor