

SERVICE PARTS LIST

BULLETIN NO.
55-40-0321

SPECIFY CATALOG NO. AND SERIAL NO. WHEN ORDERING PARTS		REVISED BULLETIN	DATE
VARIABLE SPEED DOUBLE INSULATED SAWZALL			Nov.'88
CATALOG NO. 6512-4	STARTING SERIAL NO. 600-3100	WIRING INSTRUCTION	
		58-03-1005	

EXAMPLE:



Component Parts (Small #) Are Included When Ordering The Assembly (Large #).

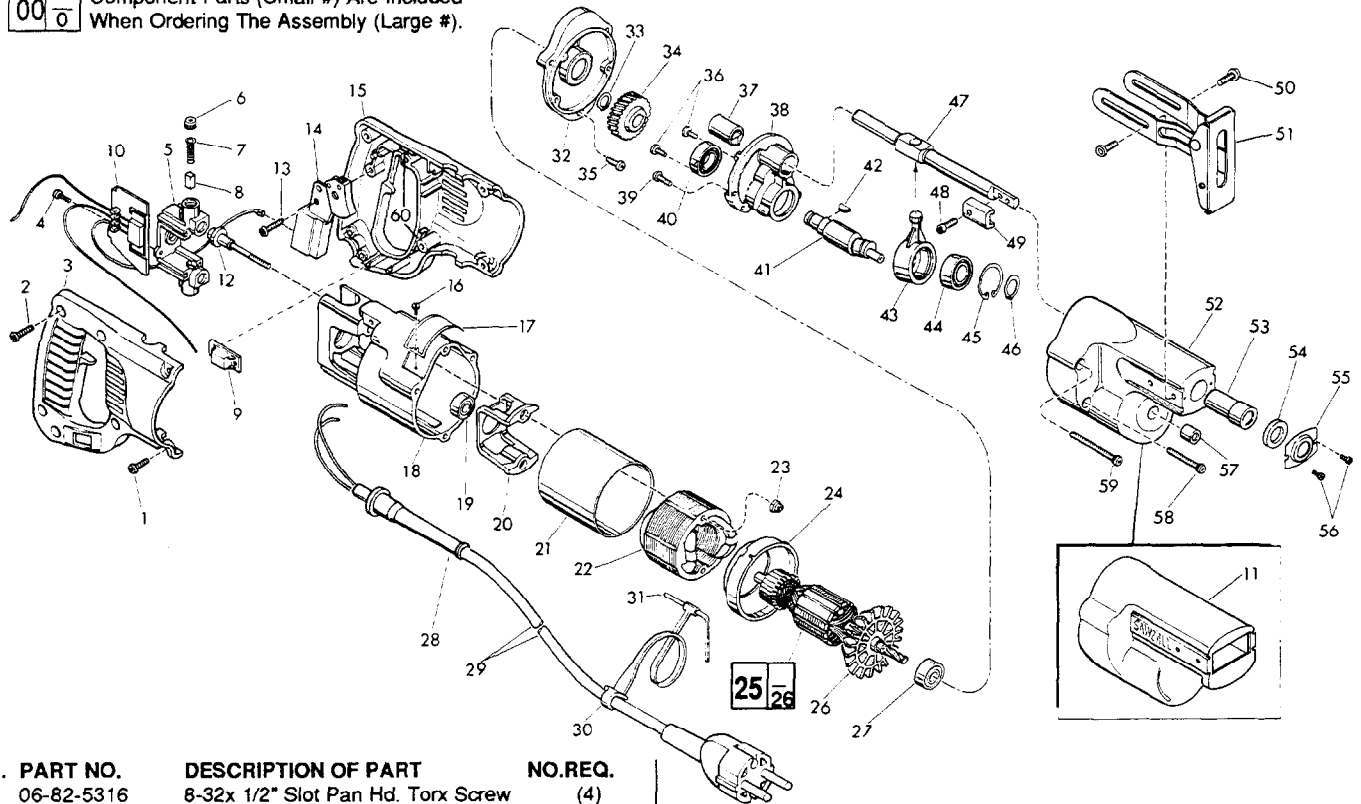

FIG. PART NO.	DESCRIPTION OF PART	NO.REQ.	
1	06-82-5316	8-32x 1/2" Slot Pan Hd. Torx Screw	(4)
2	06-82-7260	7-18 x 5/8" Pan Hd. Plastite Torx Screw	(5)
3	31-44-1466	Right Handle Half	(1)
4	06-95-0075	6-32 x 3/8" Truss Hd. Taptite Screw	(2)
5	22-22-1330	Brush Holder Assembly	(1)
6	23-44-0190	Brush Retaining Cap	(2)
7	23-52-0160	Brush Spring	(2)
8	22-16-0275	Carbon Brush	(2)
9	31-53-0120	Plug	(1)
10	14-20-0300	Remote Switch Assembly	(1)
11	45-12-0305	Gear Case Insulator	(1)
12	06-81-1058	8-32 x 2.19 Field Bolt	(2)
13	06-82-7260	7-18 x 5/8" Pan Hd. Plastite Torx Screw	(1)
14	23-66-1835	On- Off Switch	(1)
15	14-34-0420	Handle Assembly	(1)
16	06-85-0200	Nameplate Screw	(2)
17	12-99-0065	Nameplate Blank	(1)
18	28-50-6201	Motor Housing	(1)
19	02-04-0845	Ball Bearing	(1)
20	31-55-0030	Coil Shield	(1)
21	23-16-0456	Field Insulator	(1)
22	18-34-0220	220 V. Field	(1)
23	06-57-2975	8-32 Flexlock Hex Nut	(2)
24	31-05-0050	Baffle	(1)
25	16-34-0425	220 V. Armature	(1)
26	22-84-0530	Fan Assembly	(1)
27	02-04-0911	Ball Bearing	(1)
28	44-76-0210	Cord Protector	(1)
29	22-64-4480	Cord Set	(1)
30	48-66-4080	Key Holder	(1)
31	49-96-0070	5/32" Socket Wrench	(1)
32	28-28-0345	Diaphragm	(1)
33	34-60-0920	External Retaining Ring	(1)
34	32-40-1920	Intermediate Gear	(1)
35	06-82-0015	8-32 x 3/8" Fil. Hd. Taptite Torx Screw	(1)
36	06-95-0075	6-32 x 3/8" Truss Hd. Taptite Screw	(2)
37	42-24-0250	Rear Spindle Bearing	(1)
38	28-72-1002	Bearing Plate	(1)
39	06-82-0020	8-32 x 1/2" Fil. Hd. Taptite Torx Screw	(2)
40	02-04-1510	Ball Bearing	(1)

FIG. PART NO.	DESCRIPTION OF PART	NO.REQ.	
41	36-92-0675	Wobble Shaft	(1)
42	06-42-1200	Woodruff Key	(1)
43	30-72-0060	Wobble Plate	(1)
44	02-04-1510	Ball Bearing	(1)
45	34-80-2355	Internal Retaining Ring	(1)
46	34-60-1200	Retaining Ring	(1)
47	38-50-5410	Reciprocating Spindle	(1)
48	06-75-2400	10-32 x 1/2" Pan Hd. Taptite Sems	(1)
49	42-68-0073	Blade Clamp	(1)
50	06-95-6270	10-24 x 1/2" Pan Hd. Taptite Sems	(4)
51	45-16-0495	Pivot Shoe Assembly	(1)
52	28-14-1780	Gear Case	(1)
53	42-24-0320	Spindle Bearing	(1)
54	45-06-0300	Felt Seal	(1)
55	44-86-0370	Seal Retainer	(1)
56	06-95-0050	4-40 x 3/16" Pan Hd. Taptite Screw	(2)
57	02-50-1640	Needle Bearing	(1)
58	06-82-5525	8-32 x 1-3/8" Fil. Hd. Taptite Torx Screw	(2)
59	06-82-5530	8-32 x 1-7/8" Fil. Hd. Taptite Torx Screw	(2)
60	14-46-1001	Foam Slug Kit - 10 Slugs	(2)

FIG. NOTES
 39 Apply type 242 blue locrite
 33,45,46 Burr side out
 37 V-notch press in from diaphragm side
 53 Press .02/.03 below surface

FIG. LUBRICATION
 34,38 1/2 oz. type "A" grease, No. 49-08-0800.
 52 2-1/2 oz. type "B" grease, No. 49-08-0600.

MILWAUKEE ELECTRIC TOOL CORPORATION
 13135 W. LISBON RD., BROOKFIELD, WI 53005