



# SERVICE PARTS LIST

**BUL. 54-40-4203**

## TWO SPEED SAWZALL

REVISED BUL. 6284-4 DATE SEPT. '68

**Catalog No. 6510**

Starting Serial No. **284-73587**

WIRING INSTR. **58-01-0230**

Both Model and Serial No. must be furnished to obtain correct parts.

230V MOTOR 16-46-1150 Armature 18-46-1120 Field

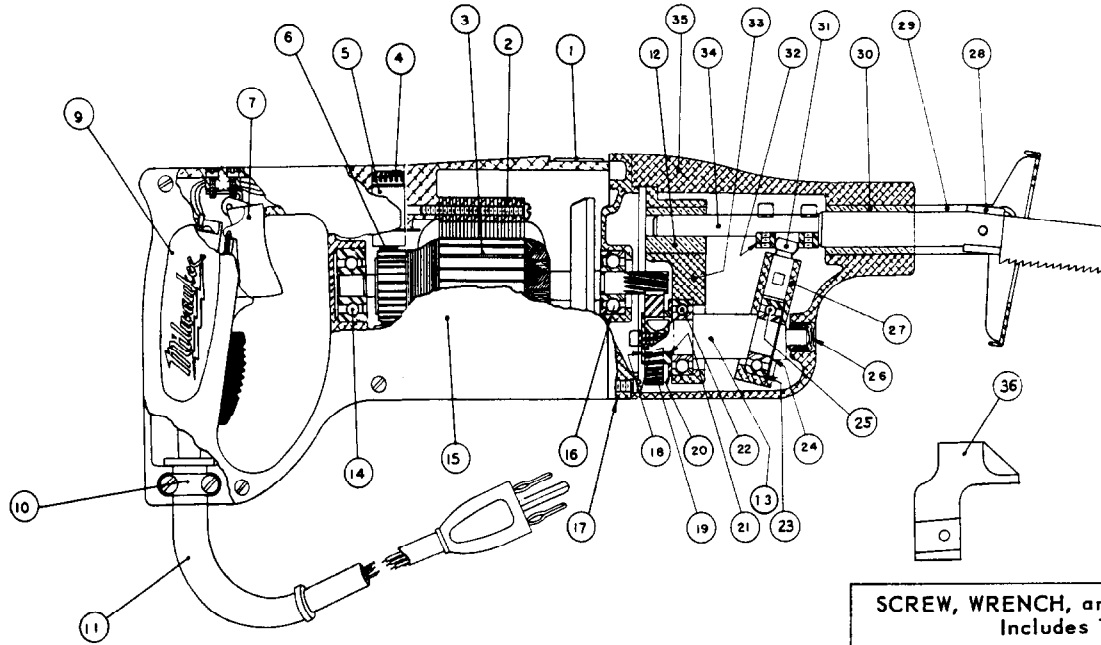

**SCREW, WRENCH, and CLAMP KIT(49-22-5080)**  
Includes The Following

(10, Blade Clamp Scrs.....06-75-2400  
(2) Blade Clamps .....42-68-0073  
(2) Socket Wrenches..... 49-96-0070

**ILLUSTRATED PARTS**

FIG.	PART NO.	DESCRIPTION OF PART	NO.REQ.	FIG.	PART NO.	DESCRIPTION OF PART	NO.REQ.
1	12-98-3000	Name Plate		20	44-86-0090	Bearing Retainer	
2	18-42-1120	Field Assembly		21	45-36-0121	Gear Spacer	
3	16-42-1170	Armature Assembly		22	02-04-1510	Ball Bearing	
4	23-44-0060	Brush Retaining Screw	(2)	23	34-80-2300	Retaining Ring	
5	22-22-0080	Brush Holder Assembly	(2)	24	34-60-1200	Retaining Ring	
6	22-18-0100	Carbon Brush Assemblies	(2)	25	02-04-1510	Ball Bearing	
★ 7	23-66-0480	Switch		26	02-50-1640	Needle Bearing	
9	28-20-3602	Handle Cover		27	28-72-9001	Wobble Plate	
10	28-17-0400	Cord Clamp Strap		28	42-68-0071	Blade Clamp (Old Style)	
11	22-64-0380	Cord Set			42-68-0073	Blade Clamp (New Style)	
12	42-24-0101	Spindle Bearing		29	45-16-0055	Pivot Shoe Assembly	
13	36-92-0601	Wobble Shaft		30	42-24-0091	Spindle Bearing	
14	02-04-0970	Ball Bearing		31	45-58-0050	Ball End Stud	
15	28-50-4485	Motor Housing (Includes item 9 & screws)		32	42-28-0050	Reciprocating Spindle Block	
16	02-04-0940	Ball Bearing		33	28-72-1001	Bearing Plate	
17	28-28-0341	Diaphragm		34	38-50-2002	Reciprocating Spindle	
18	45-88-0180	Gear Retaining Washer		35	28-14-0571	Gear Case	
19	32-40-1101	Intermediate Gear		36	48-03-2000	Off-Set Blade Adaptor (Includes 28-02-0051, scrs., & 42-68-0073	

**MISCELLANEOUS PARTS NOT SHOWN**

PART NO.	DESCRIPTION OF PART	NO.REQ.	PART NO.	DESCRIPTION OF PART	NO. REQ
23-86-0110	Brush Holder Insul. Washer (Fiber)	(2)	06-81-9525	10-24x1/2 Truss Hd. Shoe Bracket Scrs. (Sems)	(4)
06-81-8400	4-40x1/4 Rd.Hd. Name Plate Scrs. (Sems)	(2)	06-81-2500	6-32x3/8 Flat Hd. Bearing Retainer Screws	(2)
06-83-2645	1/4-20x3/8 Socket Hd. Hd'less Set Scr.(Self Locking)	(2)	06-81-0900	8-32-7/16 Fil. Hd. Brg. Retainer Plate Screw	(2)
06-83-2650	1/4-20 x 3/8 Brush Holder Set Screw	(2)	06-81-6500	8-32x1-3/8 Fil. Hd. Gear Case Scrs. (Sems)	(2)
06-81-8625	6-32x1/4 R. Hd. Ground Wire Scr. (Brass)(Sem)	(2)	06-81-6650	8-32x1-3/4 Fil. Hd. Gear Case Scrs. (Sems)	(2)
06-75-2400	10-32x1/2 Socket Head Screws	(6)	06-81-6600	8-32 x 1-3/4 Fil. Hd. Field Screws (Sems)	(2)
23-86-0050	Rubberized Retaining Washer	(2)	06-81-3700	8-32 x 7/8 Oval Hd. Handle Cover Screws	(2)
49-96-0070	Socket Screw Wrench		06-81-6150	8-32x1/2 Fil.Hd. Cord Clamp Strap Scrs.(Sems)	(2)
06-81-3750	8-32 x 1 Oval Hd. Handle Cover Screws	(2)	42-70-0050	Spring Clip	
★ 06-81-5800	6-32 X5/16 Fil. Hd. Switch Mtg. Sems	(2)	★ 06-81-8650	6-32X1/4 Rd. Hd. Sems Spring Clip Screw	
06-81-3750	8-32 x 1 Oval Hd. Handle Cover Screws	(2)	06-97-3200	Lock Washer	(2)
06-97-3400	Lock Washer	(3)	06-42-1200	#212 Woodruff Key	
★ 42-14-0090	Wire Baffle		23-16-0340	Switch Insulator	
★ 48-03-0010	Plug Adaptor		★ 06-81-6150	6-32X1/2 Fil. Hd. Scr,	