



# SERVICE PARTS LIST

**BUL.54-40-4004**

## SAWZALL

REVISED BUL 673-5      DATE May '68

**Catalog No. 6500**

Starting Serial No. **73-103592**

WIRING INSTR. **58-01-0170**

Both Model and Serial No. must be furnished to obtain correct parts.

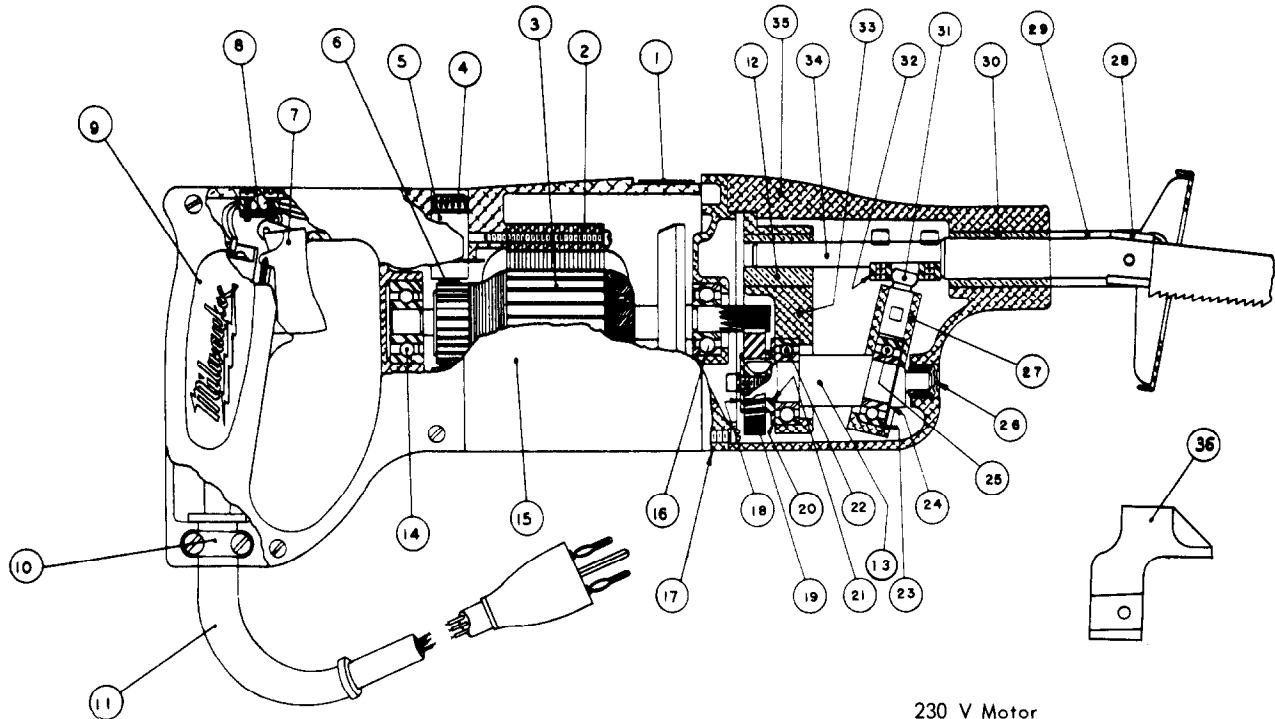

230 V Motor  
16-46-1150 Armature  
18-46-1050 Field

### ILLUSTRATED PARTS

FIG.	PART NO.	DESCRIPTION OF PART	NO.REQ.	FIG.	PART NO.	DESCRIPTION OF PART
1	12-98-3000	Name Plate		19	32-40-1101	Intermediate Gear
2	18-42-1040	Field Assembly		20	44-86-0090	Bearing Retainer
3	16-42-1170	Armature Assembly		21	45-36-0121	Gear Spacer
4	23-44-0060	Brush Retaining Screw	(2)	22	02-04-1510	Ball Bearing
5	22-22-0080	Brush Holder Assembly	(2)	23	34-80-2300	Retaining Ring
6	22-18-0100	Carbon Brush Assemblies	(2)	24	34-60-1200	Retaining Ring
7	23-66-0230	Switch		25	02-04-1510	Ball Bearing
8	42-14-0090	Switch Spacer		26	02-50-1640	Needle Bearing
9	28-20-3151	Handle Cover		27	28-72-9001	Wobble Plate
10	28-17-0400	Cord Clamp Strap		28	42-68-0073	Blade Clamp
11	22-64-0170	Cord Set		29	45-16-0055	Pivot Shoe Assembly
12	42-24-0101	Spindle Bearing		30	42-24-0091	Spindle Bearing
13	36-92-0601	Wobble Shaft		31	45-58-0050	Ball End Stud
14	02-04-0970	Ball Bearing		32	42-28-0050	Reciprocating Spindle Block
15	28-50-4483	Motor Housing (Includes item 9 & screws)		33	28-72-1001	Bearing Plate
16	02-04-0940	Ball Bearing		34	38-50-2002	Reciprocating Spindle
17	28-28-0341	Diaphragm		35	28-14-0571	Gear Case
18	45-88-0180	Gear Retaining Washer		36	48-03-2000	Off-set Blade Adaptor (Includes 28-02-005 1, scs., & 42-68-0073)

### MISCELLANEOUS PARTS NOT SHOWN

PART NO.	DESCRIPTION OF PART	NO.REQ.	PART NO.	DESCRIPTION OF PART	NO.REQ.
23-86-0110	Brush Holder Insulating Washer (Fiber)	(2)	06-81-9525	10-24x1/2" Truss Hd. Shoe Bracket Scrs.(Sems)	(4)
06-81-5800	6-32x5/16" Fil.Hd.Sem Switch Mtg.Scrs. (2)	(2)	06-81-2500	6-32x3/8" Flat Hd.Bearing Retainer Screws	(2)
06-81-8400	4-40x1/4" Rd.Hd.Name Plate Scrs.(Sems)(2)	(2)	06-81-0900	8-32x7/16" Brg.Retainer Plate Screw	(2)
06-83-2645	1/4"-20x3/8" Soc.Hd.Hd'less Set Screw Self Locking		06-81-6500	8-32x1-3/8" Fil.Hd.Gear Case Scrs.(Sems)	(2)
06-83-2650	1/4"-20x3/8" Brush Holder Set Screw (2)	(2)	06-81-6650	8-32x1-3/4" Fil.Hd.Gear Case Scrs.(Sems)	(2)
06-81-8625	6-32x1/4" Rd.Hd.Ground Wire Sc.(Brass)(Sem)	(2)	06-81-6600	8-32x1-3/4" Fil.Hd. Field Screws (Sems)	(2)
06-75-2400	10-32x1/2" Socket Head Screws (6)	(6)	06-81-3700	8-32x7/8" Oval Hd Handle Cover Screws	(2)
49-96-0070	Socket Screw Wrench		06-81-6150	8-32x1/2" Fil.Hd.Cord Clamp Strap Scrs.(Sems)	(2)
42-70-0050	Spring Clip		23-86-0050	Rubberized Retaining Washer	
06-81-3750	8-32x1 Oval Hd. Handle Cover Screw (2)	(2)	06-97-3200	Lock Washer	(2)
06-42-1200	No. 212 Woodruff Key		06-97-3400	Lock Washer	(3)
*06-97-1800	Lock Washer	(4)	*06-81-8650	6-32x1/4" Rd.Hd. Spring Clip Sem	
*06-81-6150	8-32x1/2" Fil.Hd. Sem		*48-03-0010	Plug Adaptor	