

Ref #	Part #	Description	Context Note	Foot Note
1	60564	SHAFT, Axle		NOTE 1 - Axle Shaft for Model 580.328210 (2.0 KW unit) is 15-13/16" long.
2	22268	PIN, Cotter		
3	60565	BRACKET, Axle Shaft Supporting		
4	60713	SPACER - 1" Long		NOTE 2 - Generator Model Number 580.328210 (2.0 KW) requires only one (1) Spacer, to be installed as shown in Figure 1.
5	39714	WHEEL, Plastic - 7" Diameter		
6	22304	WASHER, Flat - 1/2"		NOTE 3 - Generator Model Number 580.328210 (2.0 KW) requires three (3) 1/2" Flat Washers (Figure 1, Item 6).
7	22287	CAPSCREW, Hex Head - 1/4"-20 x 3/4"		
8	22097	WASHER, Lock - 1/4"		
9	22127	NUT, Hex - 1/4"-20		
10	22259	NUT, Hex - 5/16"-18		
11	22625G	SPACER - 2" long		NOTE 4 - SPRINGS (Part Number 23594) are supplied with the Generator unit. For mounting of Springs to Generator Model Number 580.328210 (2.0 KW), see Figure 1. Before Ordering call Generac for quantity required.
12	23594	SPRING		
13	22459	CAPSCREW, Hex Head - 5/16"-18 x 2-3/4"		

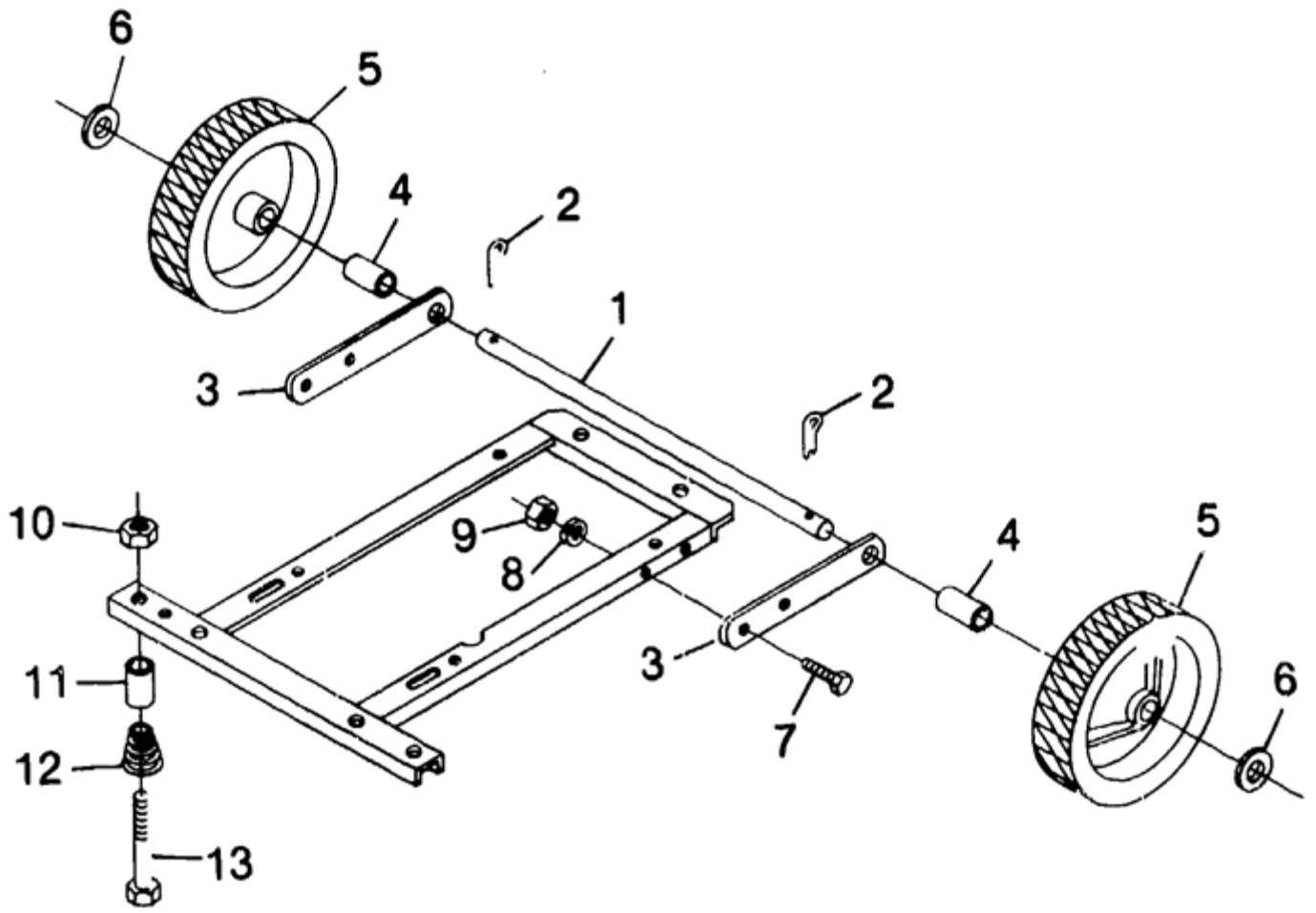

Ref #	Part #	Description	Context Note	Foot Note
1	60564A	SHAFT, Axle		NOTE 1 - Axle Shaft for Model 580.328220 (3.5 KW unit) is 14-1/8" long.
2	22268	PIN, Cotter		
3	60565	BRACKET, Axle Shaft Supporting		
4	60713	SPACER - 1" Long		NOTE 2 - Generator Model Number 580.328220 (3.5 KW) requires two (2) spacers, to be installed as shown in Figure 2.
5	39714	WHEEL, Plastic - 7" Diameter		
6	22304	WASHER, Flat - 1/2"		NOTE 3 - Generator Model Number 580.328220 (3.5 KW) requires two (2) 1/2" Flat Washers (Figure 2, Item 6).
7	22287	CAPSCREW, Hex Head - 1/4"-20 x 3/4"		
8	22097	WASHER, Lock - 1/4"		
9	22127	NUT, Hex - 1/4"-20		
10	22259	NUT, Hex - 5/16"-18		
11	22625G	SPACER - 2" long		NOTE 4 - SPRINGS (Part Number 23594) are supplied with the Generator unit. For mounting springs to Generator Model Number 580.328220 (3.5 KW), see Figure 2. Before Ordering call Generac for quantity required.
12	23594	SPRING		
13	22459	CAPSCREW, Hex Head - 5/16"-18 x 2-3/4"		