

# PORTER-CABLE HAMMER-DRILL

**WARNING!** Electrical repairs should only be attempted by trained repairmen. Contact the nearest Porter-Cable Service Center or other competent repair center.

# 614

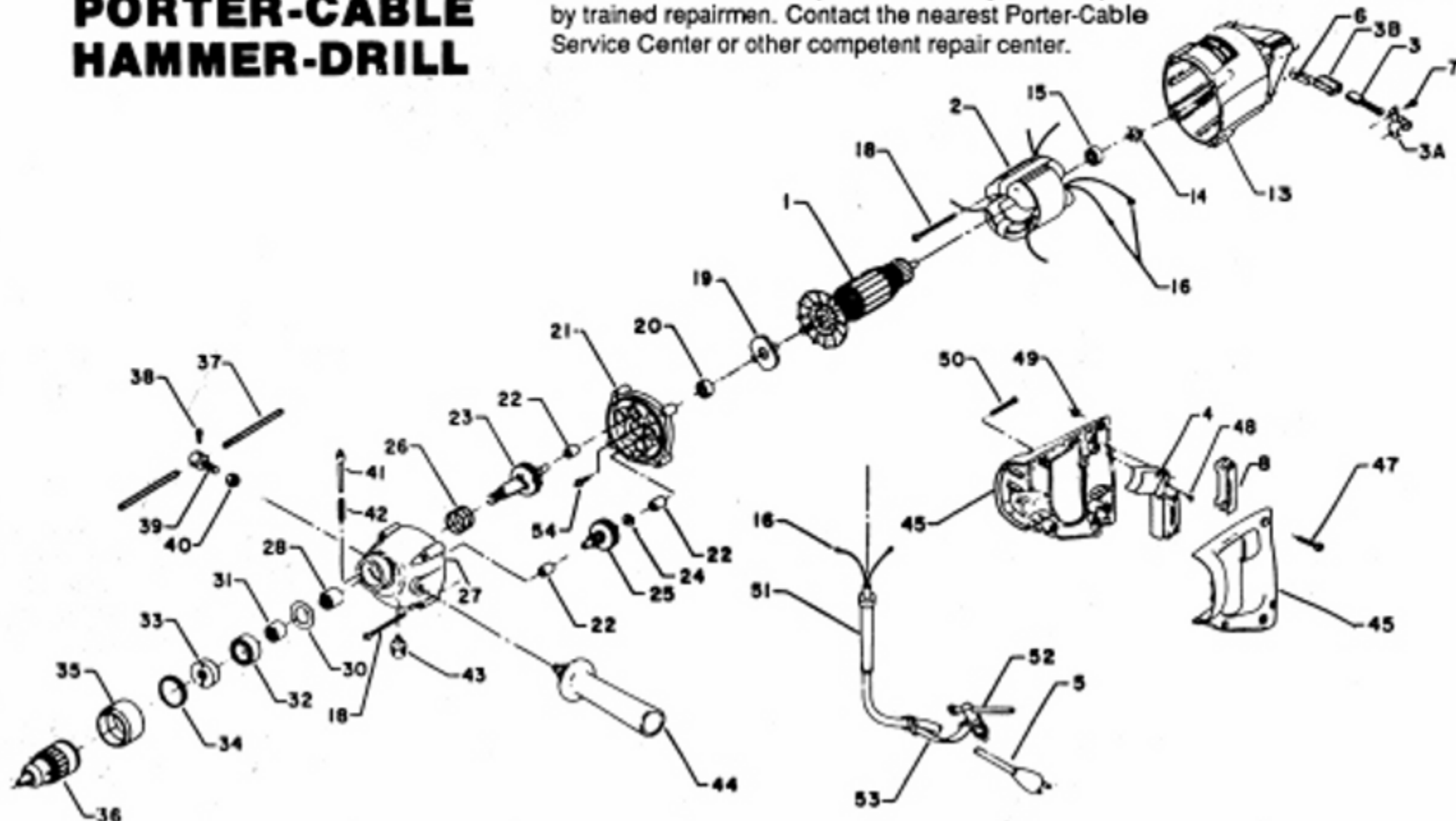

Ref. No.	Part No.	Description
1	865656	Armature
2	865655	Field
3 n	874289	Brush/Spring/Retainer, T2
	865326	Brush and Spring, T1
3A	865210	Brush Holder Retainer, T1
3B	865323	Brush Holder
4	864459	Switch
5	865619	Cord
6	865321	Brush Insulator
7 n	693104	Screw, T2
	802783	Screw, T1
8	864462	Insulator
13 n	875290	Motor Housing Pkg., Incl: Ref. 3, 7, 14
14 n	694432	Bearing Mount, T2
	842610	Loading Washer, T1
15	855284	Commutator Bearing
16	849314	Terminal
18	864722	Screw
19	854837	Retaining Plate
20	855220	Fan End Bearing
21	852222	Intermediate Plate
		Incl: Ref. 22
22	838073	Needle Bearing
23	864711	Spindle Gear Assy.
24	858793	Washer
25	864563	Idler Gear Assy.
26	864669	Spring
27	864559	Gear Hsg. Assy. Incl: Ref. 22, 28
28	864638	Needle Bearing
30	864643	Thrust Race
31	864666**	Needle Bearing (Early)
32	696178**	Driven Cam
33	864567	Drive Cam
34	864582**	Oil Seal

Ref. No.	Part No.	Description
35	864853	Dust Deflector
36	865362	Chuck
37	859770	Depth Gage
38	842092	Screw
39	863565	Depth Stop
40	858837	Jam Nut
41	864867**	Selector Shaft
42	864860**	Spring
43	811239**	Knob
44	810820	Aux. Handle
45 n	695782	Handle Set, T2, Incl: Ref. 47, 48, 50
	865650	Handle Set, T1, Incl: Ref. 47, 48, 49, 50
47 n	688401	Screw, T2
	802589	Screw, T1
48 n	866784	Screw, T2
	859227	Screw, T1
49	862641	Nut, T1
50	864719	Screw
51	843464	Strain Reliever
52	824546	Chuck Key
53	856510	Key Holder
54	846515	Screw
*	811221	Armature Fan
*	59842	Lubricant (5 1/2 oz.)
*	863106	Lubricant (4 lbs.)

\*Not Shown

PARTS LIST NO. 875262 - 199

Copyright © 1991 PORTER-CABLE Corporation

**PORTER-CABLE**  
PROFESSIONAL POWER TOOLS

# 614

## SERVICE NOTES

### SELECTOR SHAFT ASSEMBLY

Place the spring (Ref. 42) through the front of the gear housing and into the selector shaft bore followed by the selector shaft. Pull the shaft down and place a sleeve or piece of pipe (Approx. 1 7/16" dia.) into the front of the gear housing to hold the shaft in this position. Press the knob onto the shaft so that the end of the shaft is flush with the knob.

### OIL SEAL

It is recommended that Ref. 34 oil seal be replaced if the drive and/or driven cams are dismantled. Removal of seal: Use a very thin bladed screwdriver or other similar tool, and pry the seal out of the bore. Assembly: After the spindle and spring are in place, install the driven cam, then the drive cam. A flat is ground at the rear of the spindle shaft so the shaft may be held by a vise. Thread the drive cam onto the spindle with a spanner wrench and tighten. Place the seal in the bore with the feather edge facing outward. Using appropriate size sleeve, tap the oil seal in place against the step in the bore. Complete assembly of the rest of the unit.

### DRIVEN CAM/NEEDLE BEARING

Early units used driven cam 864566 with cam bearing 864666. Current units use driven cam 696178. No bearing is required with this cam.

The new cam (696178) is interchangeable with the old cam (864566) and bearing (864666).