



# SERVICE PARTS LIST

**BUL. 54-38-3109**

## 9" DISC SANDER

**Catalog No. 6060**

Starting Serial No. **48-106488**

REVISED BUL 54-38-3108 DATE Dec. '72

WIRING INSTR. 58-01-0310

Both Model and Serial No. must be furnished to obtain correct parts.

5000 R.P.M.

Cat. No. 6080 Tool only less backing discs and hub assembly.  
Cat. No. 6100 Welders Kit See catalog for list of accessories.

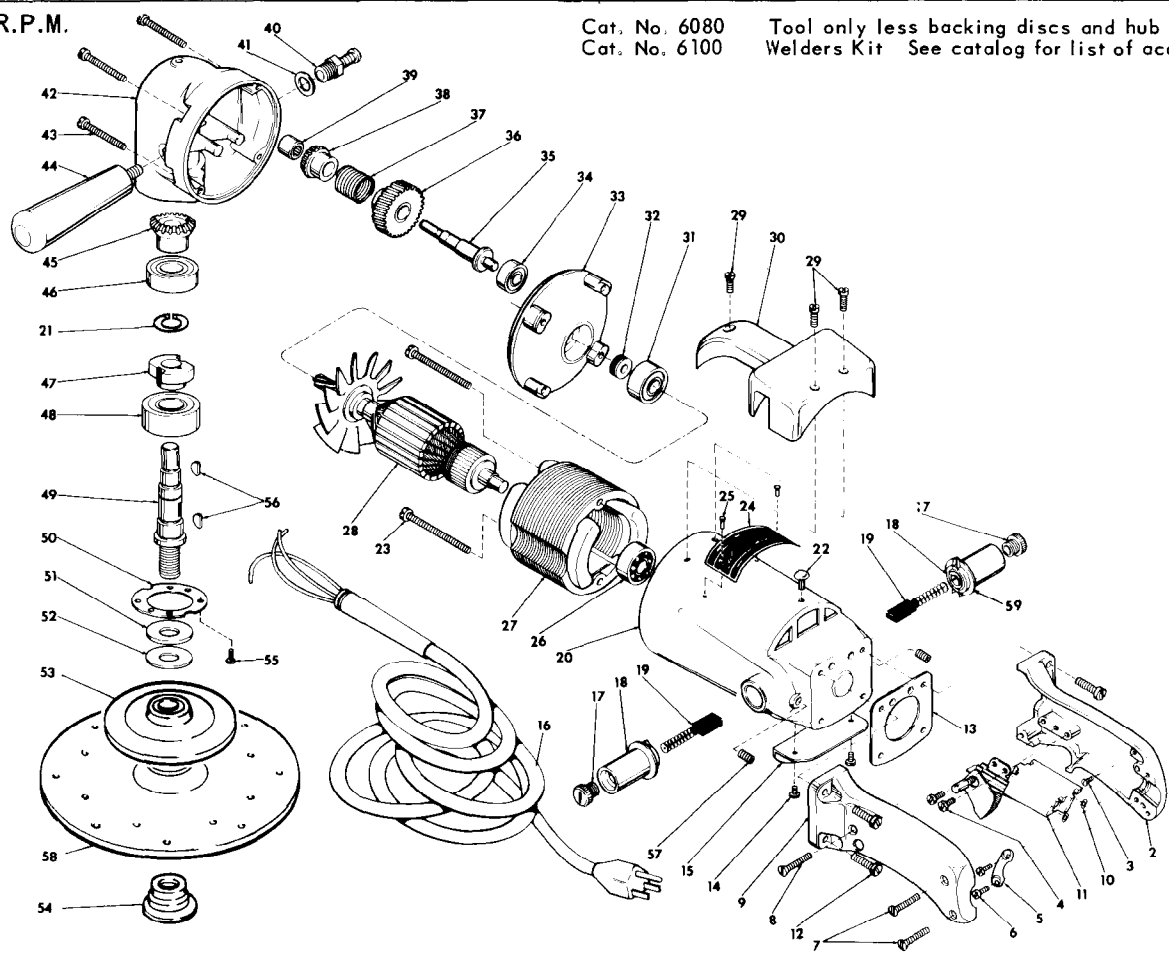

FIG.	PART NO.	DESCRIPTION OF PART	NO. REQ.	FIG.	PART NO.	DESCRIPTION OF PART	NO. REQ.
★ 1	28-44-1042	Switch Handle Assembly (includes Fig. Nos. 2, 7, 8 and 9)		30	31-70-0100	Tool Rest	
2	—	Handle (Switch Mount Side)		31	02-04-1340	Ball Bearing	
3	06-81-8625	6-32x1/4 Ground Screw		32	45-28-0080	Grease Slinger	
4	06-81-5400	8-32x5/16 Binder Sem	(2)	33	28-28-0381	Diaphragm	
5	28-17-0200	Clamp Strap		34	02-04-0910	Ball Bearing	
6	06-81-6150	8-32x1/2 Fil.Hd. Sem	(2)	35	36-66-3301	Intermediate Shaft	
7	06-81-3700	8-32x7/8 Oval Hd. Screw	(2)	36	32-40-1481	Intermediate Gear	
8	06-81-3750	8-32x1 Oval Hd. Screw	(2)	37	40-50-3200	Clutch Spring	
9	—	Handle (Switch Cover Side)		38	32-50-1261	Miter Gear (Sold with fig.45 as a set)	
10	06-97-1800	Lockwasher	(4)	39	02-50-2130	Needle Bearing	
11	23-66-0250	Switch		40	44-20-0060	Spindle Lock Assembly	
12	06-81-7620	12-28x3/4 Fil.Hd. Sem	(4)	41	45-88-5320	Flat Washer	
13	43-86-0050	Handle Insulator		42	28-14-0610	Gear Case	
14	06-81-8650	6-32x1/4 Rd.Hd. Sem	(2)	43	06-81-7300	10-24x1-3/4 Fil.Hd. Sem	(4)
15	44-66-0100	Cover Plate		44	43-62-0141	Side Handle	
16	22-64-0090	Cord Set		45	32-50-1241	Miter Gear (Refer to fig.38)	
17	23-44-0035	Brush Retaining Screw	(2)	46	02-04-1710	Ball Bearing	
★ 18	22-22-0106	Brush Holder Ass'y.	(2)	47	42-74-0065	Spindle Lock Cog	
19	22-18-0125	Carbon Brush Assembly	(2)	48	02-04-2060	Ball Bearing	
★ 20	28-50-4564	Motor Housing		49	38-50-1751	Spindle	
21	34-60-1290	Retaining Ring		50	45-88-0220	Retaining Washer	
22	06-77-1400	14x5/16 Driv-In Screw		51	45-88-0141	Thrust Washer	
23	06-81-9225	10-24x2-3/4 Round Sem	(2)	52	45-88-0160	Rubber Washer	
24	12-99-0034	Nameplate		★ 53	49-36-3500	Rubber Pad	
★ 25	06-85-0200	6x1/4 Rd. Hd. T Type Z Screw	(2)	★ 54	49-40-0350	Disc Nut	
26	02-04-1070	Ball Bearing		55	06-81-6050	8-32x5/16 Fil.Hd. Sem	(6)
27	18-82-1180	115 Volt Field		56	06-42-1600	Woodruff Key	(2)
28	16-82-1711	115 Volt Armature		57	06-83-2725	1/4-28x3/8 Hdls. Set Screw	(2)
29	06-81-6950	10-24x1/2 Fil.Hd. Sem	(3)	★ 58	48-80-6050	9 inch Phenolic Plate	
				59	23-86-0060	Washer	(2)