



SERVICE PARTS LIST

BULLETIN NO.
54-24-0176

| | | | |
|--|--------------------------------------|---|------------------|
| SPECIFY CATALOG NO. AND SERIAL NO. WHEN ORDERING PARTS | | REVISED BULLETIN 54-24-0175 | DATE Mar. '95 |
| 1/2" REV. MAGNUM HAMMER-DRILL | | | |
| CATALOG NO. 5374-1 | STARTING SERIAL NO. 715-64332 | WIRING INSTRUCTION 58-01-1600 | |

EXAMPLE:



Component Parts
(Small #) Are Included
When Ordering The
Assembly (Large #).

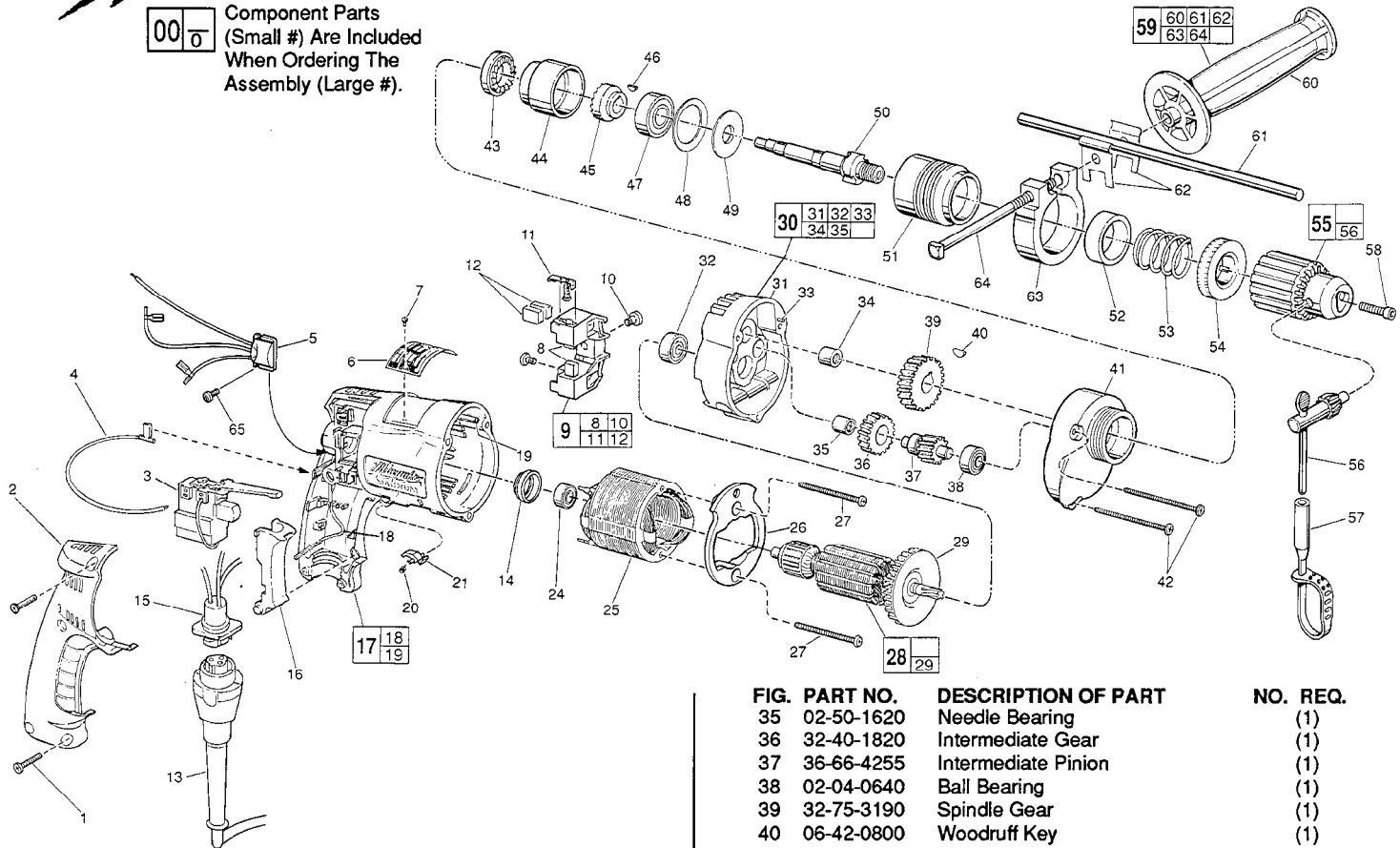

| FIG. | PART NO. | DESCRIPTION OF PART | NO. REQ. |
|------|----------|---|----------|
| | 1 | 06-82-7266 7-18 x 11/16" Plastite Screw T-20 | (5) |
| ★ | 2 | 31-15-0402 Handle Cover | (1) |
| | 3 | 23-66-1665 Trigger Speed Control Reversing Switch | (1) |
| | 4 | 23-94-6245 2-1/4" Lead Assembly | (1) |
| ★ | 5 | 14-20-0765 Remote Electronic Assembly | (1) |
| | 6 | 12-99-0225 Nameplate Blank | (1) |
| ★ | 7 | 06-72-1720 Nameplate Rivet | (2) |
| | 8 | 22-16-0300 Carbon Brush | (2) |
| | 9 | 22-22-0356 Brush Holder Assembly | (1) |
| | 10 | 31-75-0040 Brush Holder Screw | (2) |
| | 11 | 22-20-0355 Brush Spring Assembly | (2) |
| | 12 | 22-16-0300 Carbon Brush (Spares) | (2) |
| | 13 | 48-76-4008 8 Foot Quik-Lok Cord Set | (1) |
| | 14 | 22-72-0100 Bearing Cup | (1) |
| | 15 | 22-56-0630 Pin Housing Assembly | (1) |
| | 16 | 45-72-0080 Trigger | (1) |
| | 17 | 14-38-0540 Motor Housing Assembly | (1) |
| | 18 | 23-94-9960 Ground Wire Assembly | (1) |
| | 19 | 44-60-1290 Grounding Pin | (1) |
| | 20 | 40-50-0085 Lock Button Spring | (1) |
| ★ | 21 | 42-42-0460 Lock Button | (1) |
| | 24 | 02-04-0645 Ball Bearing | (1) |
| | 25 | 18-11-0075 120 Volt Field | (1) |
| ★ | 26 | 42-14-0390 Baffle | (1) |
| ★ | 27 | 06-82-7398 7 - 18 x 2-1/16" Pan Hd. Screw T-20 | (2) |
| ★ | 28 | 16-10-0800 120 Volt Armature | (1) |
| ★ | 29 | 22-84-0880 Fan Assembly | (1) |
| | 30 | 14-13-0465 Diaphragm Assembly | (1) |
| | 31 | Diaphragm | (1) |
| | 32 | 02-04-0847 Ball Bearing | (1) |
| | 33 | 06-65-0825 1/8 x 1/2" Groove Pin | (1) |
| | 34 | 02-50-2020 Needle Bearing | (1) |

| FIG. | PART NO. | DESCRIPTION OF PART | NO. REQ. |
|------|----------|---|----------|
| | 35 | 02-50-1620 Needle Bearing | (1) |
| | 36 | 32-40-1820 Intermediate Gear | (1) |
| | 37 | 36-66-4255 Intermediate Pinion | (1) |
| | 38 | 02-04-0640 Ball Bearing | (1) |
| | 39 | 32-75-3190 Spindle Gear | (1) |
| | 40 | 06-42-0800 Woodruff Key | (1) |
| | 41 | 28-14-1795 Gear Case | (1) |
| | 42 | 06-82-7411 7-18 x 2-3/16" Pan Hd. Plastite T-20 | (3) |
| | 43 | 44-84-0165 Fixed Ratchet | (1) |
| | 44 | 42-52-0250 Bearing Housing | (1) |
| | 45 | 44-84-0160 Rotating Ratchet | (1) |
| | 46 | 06-42-1200 Woodruff Key | (1) |
| | 47 | 02-04-1536 Ball Bearing | (1) |
| | 48 | 45-88-7350 Bearing Retainer Washer | (1) |
| | 49 | 45-88-7365 Spring Support Washer | (1) |
| | 50 | 38-50-5575 Spindle | (1) |
| | 51 | 45-22-0405 Sleeve (Left Hand Thread) | (1) |
| | 52 | 45-88-7375 Felt Washer | (1) |
| | 53 | 40-50-4950 Spring | (1) |
| | 54 | 42-76-0200 Locking Collar | (1) |
| | 55 | 48-66-1365 1/2" Reversing Chuck | (1) |
| | 56 | 48-66-3280 Chuck Key | (1) |
| | 57 | 48-66-4040 Key Holder | (1) |
| ★ | 58 | 06-75-3155 1/4-20 x 1" Socket Hd. Screw L.H. Thread | (1) |
| | 59 | 14-34-0250 Side Handle Assembly | (1) |
| | 60 | 43-62-0865 Side Handle | (1) |
| | 61 | 44-94-0161 Depth Rod | (1) |
| | 62 | 42-68-0390 Depth Gauge Clamp | (2) |
| | 63 | 25-82-0140 Clamping Collar | (1) |
| | 64 | 42-32-0161 5/16-18 x 3-1/2" Square Hd. Bolt | (1) |
| | 65 | 06-82-7212 4-20 x 1/4" Pan Hd. Plastite T-10 | (1) |
| | | 10-98-5986 Warning Label | (1) |

FIG. LUBRICATION
41 1-1/2 Oz. Type "E" Grease, No. 49-08-4122.
43,45 Apply Thin Coat "U" Grease, No. 49-08-0150,
To Ratchet Teeth.

MILWAUKEE ELECTRIC TOOL CORPORATION
13135 W. LISBON RD., BROOKFIELD, WI 53005