



SERVICE PARTS LIST

BUL. 54-24-1200

ELECTRIC DEMOLITION HAMMER

REVISED BUL. DATE
Feb. '76

Catalog No. 5330

Starting Serial No. **477-1001**

WIRING INSTRUCTIONS
58-01-0730

Specify Catalog and Serial No. when ordering parts

Some tools were field modified as follows:

Fig. 50 Changed to 06-75-4150 5/16-18x1-3/4 Skt. Hd. Screw (6) Required
 Fig. 51 (6) Required
 Fig. 52 (6) Required
 Fig. 72 Modified

FIG.	PART NO.	DESCRIPTION OF PART	NO. REQ.	FIG.	PART NO.	DESCRIPTION OF PART	NO. REQ.
1	28-44-1215	Handle Assembly (includes fig.nos.2 and 69)	(1)	50	06-75-4250	5/16-18x4-3/4 Skt. Hd. Cap Screw	(3)
2	06-81-6200	8-32x5/8 Fil. Hd. Sem	(4)	51	06-97-4110	5/16 Lock Washer	(3)
3	43-62-0230	Pipe Handle	(1)	52	45-88-0610	5/16 Flat Washer	(3)
4	43-62-0242	Handle Grip	(1)	53	06-42-2200	Woodruff Key	(1)
5	06-75-3200	1/4-20x1-1/4 Skt. Hd. Cap Screw	(4)	54	36-17-0020	Crank Shaft	(1)
6	06-97-4050	1/4 Lock Washer	(4)	55	12-99-0010	Nameplate	(1)
7	45-88-5170	1/4 Flat Washer	(4)	56	06-85-0200	6x1/4 Round Hd. Type Z Screw	(2)
8	28-20-0180	Motor Cover	(1)	57	43-44-0450	Crank Case Cover Gasket	(1)
9	45-36-0740	Fiber Spacer	(1)	58	28-20-0200	Crank Case Cover	(1)
10	16-82-1830	Armature (includes fig.no.12)	(1)	59	45-88-5170	1/4 Flat Washer	(4)
11	42-14-0190	Baffle	(1)	60	06-97-4050	1/4 Lock Washer	(4)
12	34-60-0990	External Retaining Ring	(1)	61	06-75-3050	1/4-20x3/4 Skt. Hd. Cap Screw	(4)
13	06-75-3050	1/4-20x3/4 Skt. Hd. Cap Screw	(4)	62	06-81-8625	6-32x1/4 Ground Screw	(1)
14	06-97-4050	1/4 Lock Washer	(4)	63	45-88-0580	Wave Washer	(1)
15	23-48-0100	Insulating Sleeve	(1)	64	02-04-1070	Ball Bearing	(1)
16	06-57-3005	10-32 Self Lock Hex Nut	(2)	65	44-52-0100	Switch Mount Pad	(1)
17	18-82-1220	Field	(1)	66	23-66-0505	Switch	(1)
18	23-16-0670	Field Insulator	(1)	67	06-65-1575	5/32x7/8 Roll Pin	(2)
19	31-55-0090	Coil Shield	(1)	68	44-52-0090	Switch Mount Pad	(1)
20	45-30-0110	Ball Bearing Retaining Slug	(1)	69	-	Handle (Refer to Fig. 1)	(1)
21	02-04-1345	Ball Bearing	(1)	70	06-97-4050	1/4 Lock Washer	(4)
22	28-50-4135	Motor Housing Assy. (Incl. Fig. 48)	(1)	71	06-75-3200	1/4-20x1-1/4 Skt. Hd. Cap Screw	(4)
23	22-22-0330	Brush Holder Assembly	(2)	72	30-37-0020	Striker Guide	(1)
24	22-18-0145	Carbon Brush Assembly	(2)	73	34-40-2255	O-Ring	(1)
25	43-44-0435	Brush Cap Gasket	(2)	*74	-	Striker (see note)	(1)
26	23-44-0140	Brush Retaining Screw	(2)	*75	-	Bit Guide (see note)	(1)
27	22-64-0080	Cord Set	(1)	76	44-20-0080	Bit Lock	(1)
28	31-86-0150	Insulating Bushing	(2)	77	30-61-0010	Nose	(1)
29	06-81-1140	10-32x3 Field Screw	(2)	78	45-88-0575	Wave Washer	(1)
30	02-80-6020	Thrust Bearing	(1)	79	44-10-0100	Bit Lock Lever	(1)
31	02-50-3215	Needle Bearing	(1)	80	06-65-1582	3/16x11/16 Roll Pin	(1)
32	45-88-7150	Thrust Bearing Washer	(2)	81	44-60-0480	Detent Pin	(1)
33	32-60-2030	Idler Gear	(1)	82	40-50-5610	Belleville Spring	(8)
34	36-66-2820	Idler Shaft	(1)	83	06-83-3610	1/2-13x1/2 Half Dog Point Set Screw	(1)
35	02-04-1345	Ball Bearing	(1)	84	45-88-0610	5/16 Flat Washer	(4)
36	45-88-0590	Wave Washer	(1)	85	06-97-4110	5/16 Lock Washer	(4)
37	28-20-0190	Gear Case Cover	(1)	86	06-75-3975	5/16-18x1 Skt. Hd. Cap Screw	(4)
38	45-88-5170	1/4 Flat Washer	(6)	87	28-25-0120	Barrel	(1)
39	06-97-4050	1/4 Lock Washer	(6)	88	02-50-3235	Needle Bearing	(1)
40	06-75-3200	1/4-20x1-1/4 Skt. Hd. Cap Screw	(6)	89	44-94-0220	Connecting Rod	(1)
41	06-81-2575	8-32x1/2 Flat Skt. Hd. Cap Screw	(3)	90	44-60-0460	Piston Pin	(1)
42	06-57-4995	1/2-20 Self Locking Hex Nut	(1)	91	34-60-0810	External Retaining Ring	(1)
43	45-88-5360	Flat Washer	(1)	92	14-68-0100	Ram Assy. (Includes Fig. Nos. 93, 94 & 95) Must be ordered complete	(1)
44	32-60-2040	Gear	(1)	93	-	Ram Body	(1)
45	45-36-0750	Spacer	(1)	94	-	Piston	(1)
46	44-86-0200	Bearing Retainer	(1)	95	-	Ram Cap	(1)
47	02-04-1720	Ball Bearing	(1)	96	45-06-0255	Back-up Ring	(1)
48	-	Crank Sleeve (see item 22)	(1)	97	43-44-0480	Gasket	(1)
49	02-50-6430	Needle Bearing	(1)				

***NOTE:**

Parts revised now have mating tapers. Initial replacement must be made as a pair. Order as follows:

45-56-2515 Tapered Striker
 30-37-0015 Tapered Bit Guide

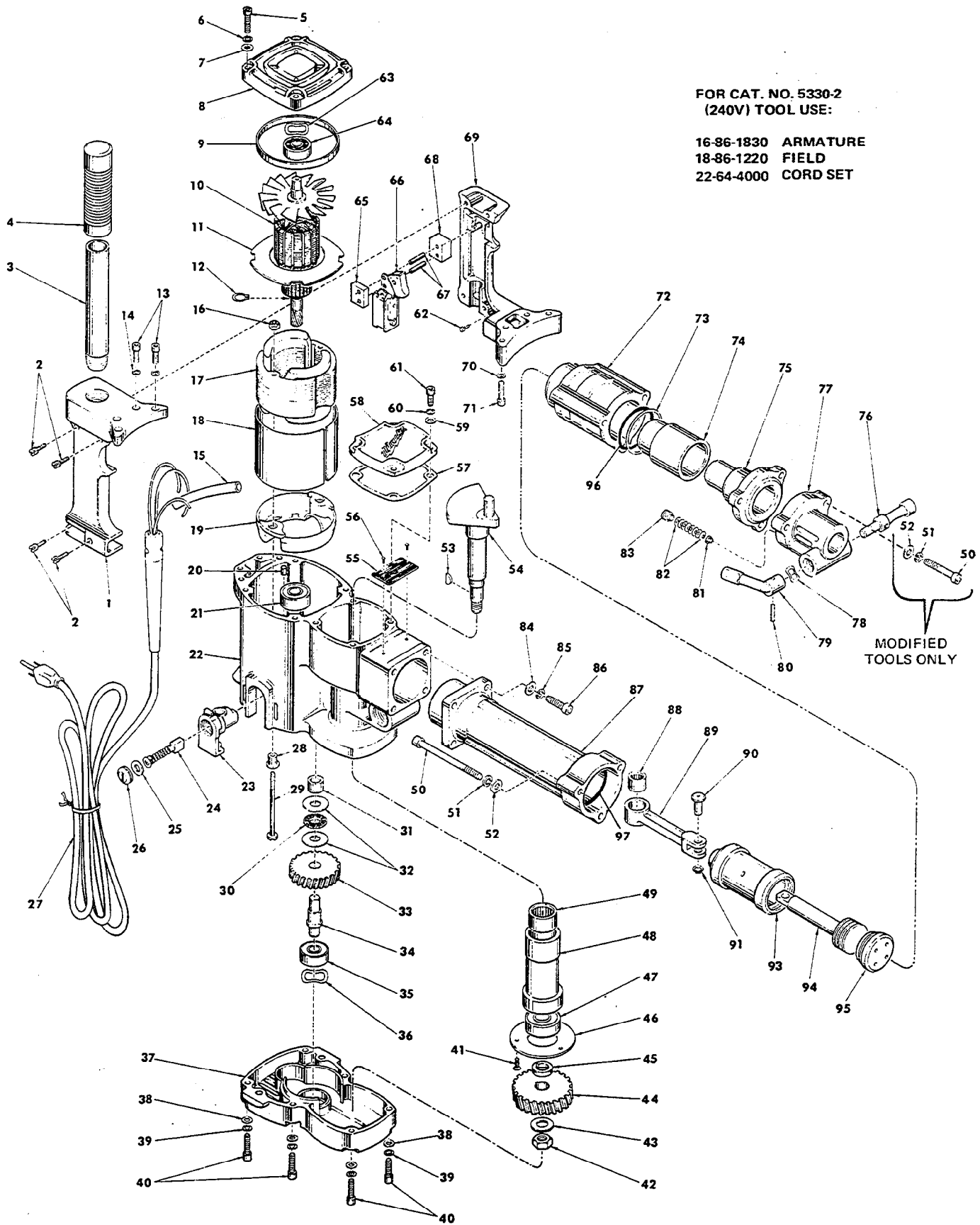

FOR CAT. NO. 5330-2
(240V) TOOL USE:

- 16-86-1830 ARMATURE
- 18-86-1220 FIELD
- 22-64-4000 CORD SET

MODIFIED
TOOLS ONLY