



SERVICE PARTS LIST

BULLETIN NO.
55-22-1240

SPECIFY CATALOG NO. AND SERIAL NO. WHEN ORDERING PARTS		REVISED BULLETIN	DATE
3/4 H.P. BENCH GRINDER W/LIGHTED EYESHIELDS			May '91
CATALOG NO. 5051-2	SERIAL NUMBER W-4-91	WIRING INSTRUCTION	
		58-01-0026	

EXAMPLE:
Component Parts (Small #) Are Included
When Ordering The Assembly (Large #).

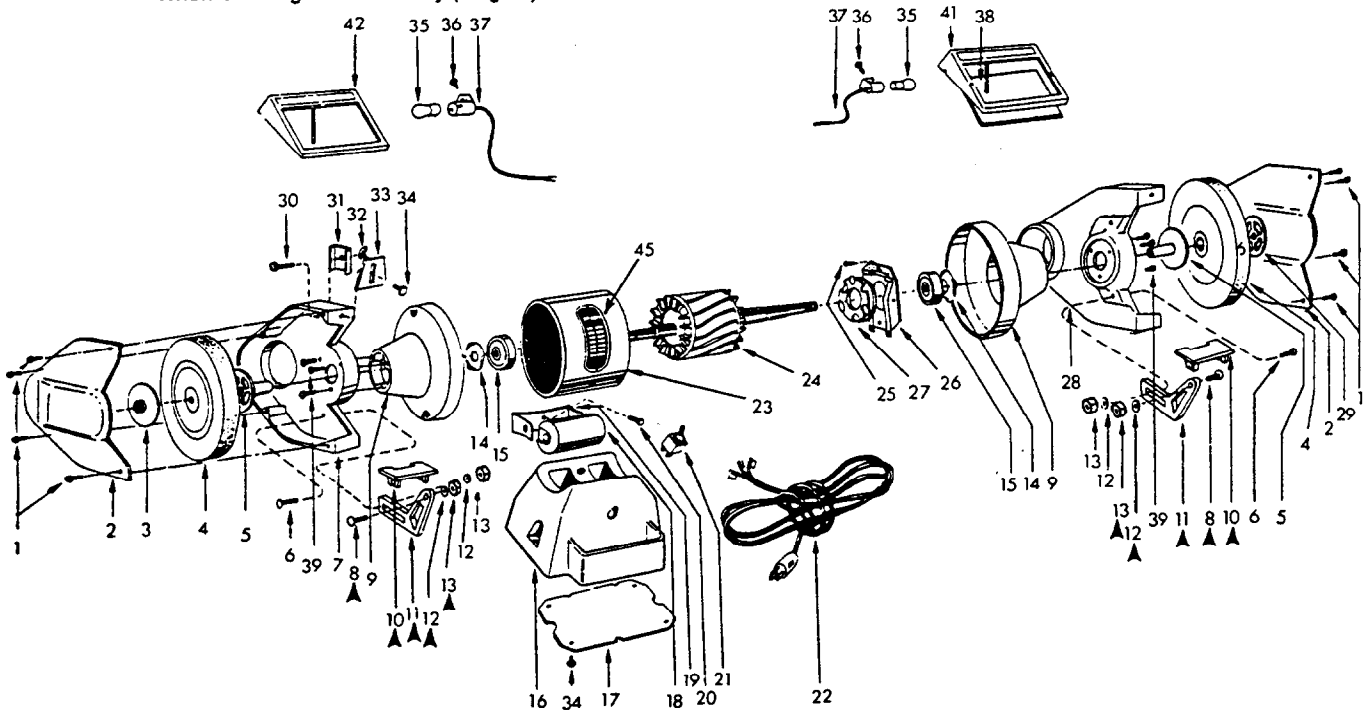

▲ = Included In Tool Rest Kit , 14-46-1096

FIG.	PART NO.	DESCRIPTION OF PART	NO. REQ.
1	06-95-0325	Self Tapping Screw #10-24x3/8	(8)
2	42-92-0700	Guard Cover	(2)
3	06-55-3510	Left Hand Hex Nut 3/4 x 10	(1)
4	43-34-0630	Wheel Flange	(2)
5	43-34-0640	Wheel Flange	(2)
6	06-75-0535	Cap Screw 3/8-16 x 1-1/4	(2)
7	43-54-0620	Left Guard	(1)
8	06-10-1300	Carriage Bolt 3/8-16 x 1-1/2	(2)
9	42-25-2550	Endbell	(2)
10	44-85-0200	Tool Rest	(2)
11	42-09-0020	Tool Rest Arm	(2)
12	45-88-8090	Washer 3/8 Flat	(4)
13	06-55-2500	Hex Nut 3/8-16	(4)
14	45-88-8115	Bearing Felt Washer	(2)
15	02-04-2035	Bearing	(2)
16	42-20-0640	Base	(1)
17	44-66-5680	Base Plate	(1)
18	22-33-0400	Capacitor	(1)
19	22-40-0130	Capacitor Bracket	(1)
20	06-81-2661	Machine Screw Flat Hd. #10-24x3/8	(1)
21	23-66-1560	Toggle Switch	(1)
22	22-64-4155	Cord Set	(1)
23	23-58-0780	Stator	(1)
24	23-40-0620	Rotor (Incl. Fig. 27)	(1)
25	06-95-0110	Self Tapping Screw #6-32 x 5/16	(2)
26	23-66-1620	Stationary Switch	(1)
27	23-66-1580	Rotary Switch	(1)
28	43-54-0630	Right Guard	(1)
29	06-55-3520	Right Hand Hex Nut 3/4-x 10	(1)

FIG.	PART NO.	DESCRIPTION OF PART	NO. REQ.
30	06-75-0150	Cap Screw 1/4-20 x 1	(2)
31	42-70-5060	Eyeshield Clip	(2)
32	06-59-2000	Wing Nut 1/4-20	(2)
33	45-12-0390	Spark Shield	(2)
34	06-75-0296	Self Tapping Screw 5/16-18 x 1/2	(6)
35	22-23-0010	Automotive Bulb	(2)
36	06-75-0022	Cap Screw #10-24 x 5/16	(2)
37	23-33-0430	Light Socket	(2)
38	49-62-0115	Replacement Plexiglass Lens	(2)
39	06-75-0105	Cap Screw 1/4-20 x 3/4	(6)
40	06-75-0300	Cap Screw 5/16-18 x 3/4	(4)
41	43-40-0260	Right Eyeshield Frame (Incl. Fig. 38)	(1)
42	43-40-0270	Left Eyeshield Frame (Incl. Fig. 38)	(1)
43		Grinding Wheel 8x1x3/4) See Catalog	(1)
44		Grinding Wheel 8x1x3/4) See Catalog	(1)
45	12-99-0460	Nameplate Blank	(1)
46	06-59-1000	Wing Nut 3/8-16	(2)

PARTS NOT SHOWN

14-46-1096	Tool Rest Kit	(1)
06-08-0050	Thru Bolt #10-24x6-3/4"	(4)
	(Used to Secure Endbells to Stator)	
06-55-1050	Hex Nut #10-24	(4)
	(Used On The End Of Each	
	06-08-0050 Thru Bolt)	
22-90-0180	Grommet (For Cord Set)	(1)

MILWAUKEE ELECTRIC TOOL CORPORATION
13135 W. LISBON RD., BROOKFIELD, WI 53005