



SERVICE PARTS LIST

BULLETIN NO.
54-04-1215

SPECIFY CATALOG NO. AND SERIAL NO. WHEN ORDERING PARTS		REVISED BULLETIN	DATE
M12™ TOP-OFF™ Power Supply and Charger			June 2024
CATALOG NO.	48-59-1211	SERIAL NO.	P13A
WIRING INSTRUCTION			

EXAMPLE:
00 0 Component Parts (Small #)
Are Included When Ordering
The Assembly (Large #).

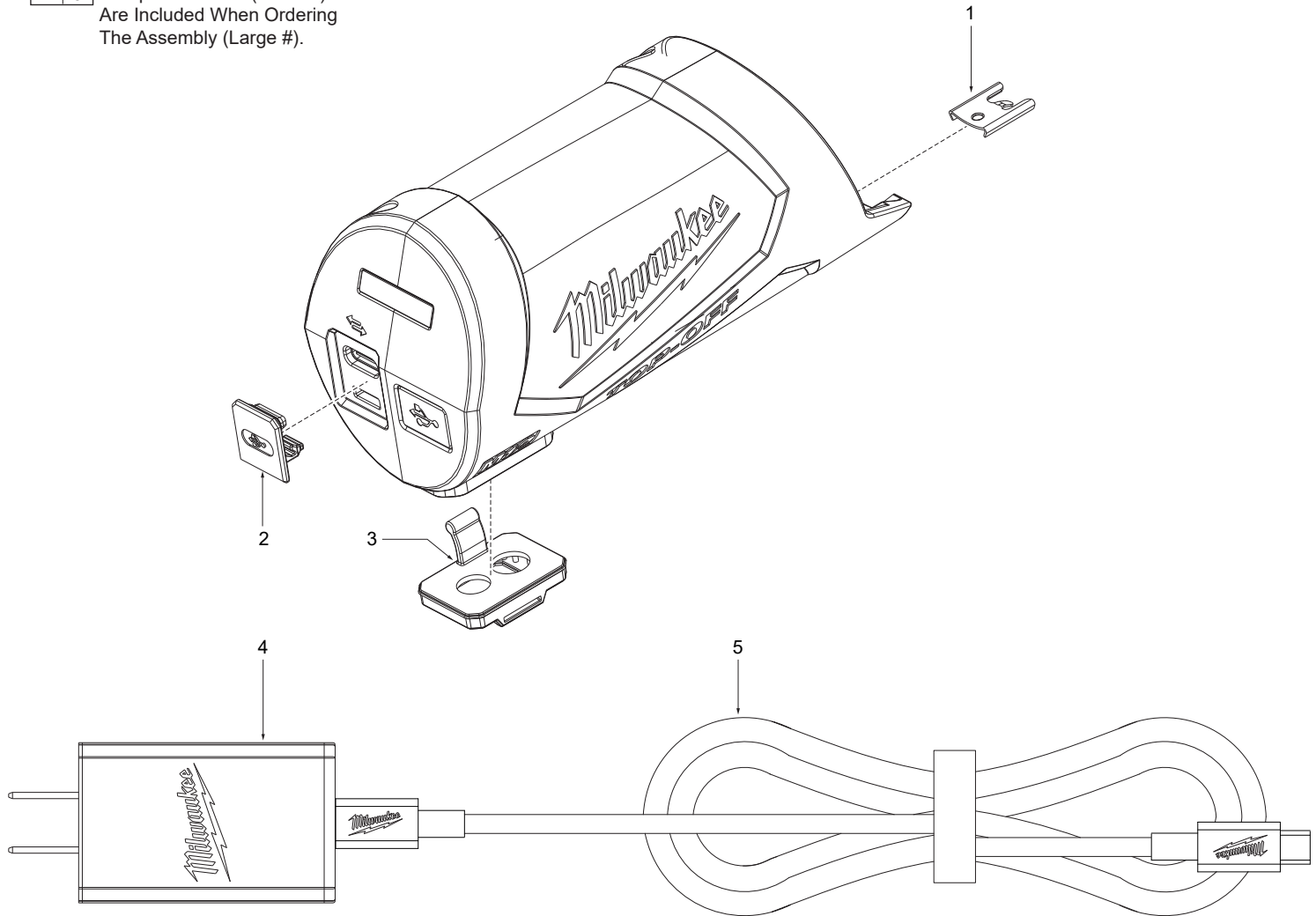

FIG.	PART NO.	DESCRIPTION OF PART	NO. REQ.
1	42-70-0058	Housing Clip	(1)
2	31-15-2126	USB-C Port Cover	(1)
3	31-15-2127	Heated Garment Port Cover	(1)
4	44-66-1211	USB-C Wall Plug (Optional)	(1)
5	42-44-1211	2-ft. USB-C to USB-C Cable (Optional)	(1)
6	12-20-0904	Service Nameplate (Not Shown)	(1)
7	10-22-0301	Warning Label (Not Shown)	(1)

FIG. NOTES
6,7 A clean, dry surface is essential for proper performance for any adhesive system. The area intended for application of any adhesive label or nameplate must be prepared by cleaning with isopropyl alcohol. The solvent is to be applied with a clean, lint free applicator and the surface allowed to dry before applying the label or nameplate.