



SERVICE PARTS LIST

BULLETIN NO.
54-49-8404

SPECIFY CATALOG NO. AND SERIAL NO. WHEN ORDERING PARTS		REVISED BULLETIN	DATE
PACKOUT™ Coolers			Sept. 2022
CATALOG NO.	SERIAL NUMBER	WIRING INSTRUCTION	

48-22-8460 PACKOUT™ Compact Cooler
48-22-8462 PACKOUT™ 40QT XL Cooler

Page 1
Page 2

00 0

EXAMPLE:
Component Parts (Small #) Are Included
When Ordering The Assembly (Large #).

Note: Tray, Dividers and Gasket
illustrated outside of PACKOUT, is to
be assembled on the inside.

48-22-8460 PACKOUT™ Compact Cooler

FIG.	PART NO.	DESCRIPTION OF PART	NO. REQ.
1	44-20-8422	Latch Assembly	(1)
5	31-01-8460	Tray	(1)
6	43-44-8460	Gasket	(1)

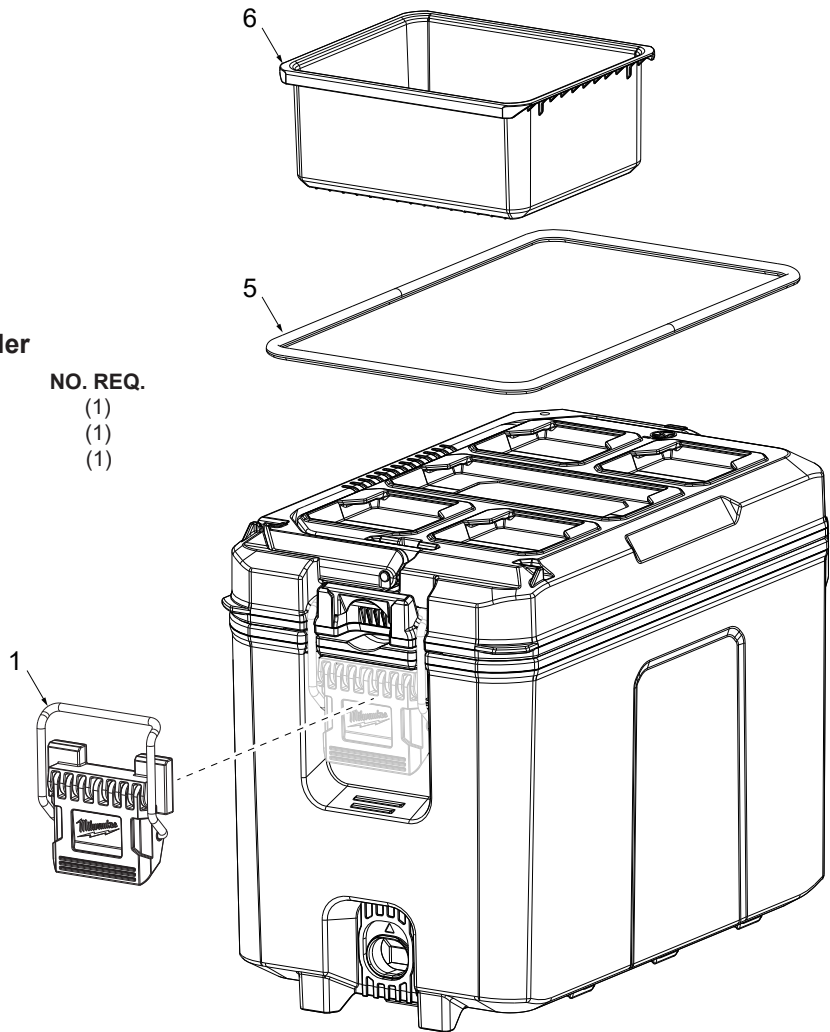

Latch Removal and Installation

Note:

Procedure for removal and installation of the 44-20-8422 Latch (1).

Removal:

1. Undo latch from PACKOUT lid.
2. Insert a flathead screwdriver in-between latch assembly and PACKOUT base to pry over the tabs. (Fig.1)
3. Pull metal latch down to remove.

Installation:

1. Insert Latch Assembly into channel.
2. Attach the metal latch to the lid. (Fig.2)
3. Close latch to secure Latch Assembly in place inside the channel.

Fig.1



Fig. 2

