



# SERVICE PARTS LIST

BULLETIN NO.

SPECIFY CATALOG NO. AND SERIAL NO. WHEN ORDERING PARTS		REVISED BULLETIN	DATE
<b>BAND SAW TABLE with 28-10-0340 Bracket*</b>		WIRING INSTRUCTION	
CATALOG NO. <b>48-08-0260</b>	STARTING SERIAL NO.		

**EXAMPLE:**  
 00 0 Component Parts (Small #) Are Included  
 When Ordering The Assembly (Large #).

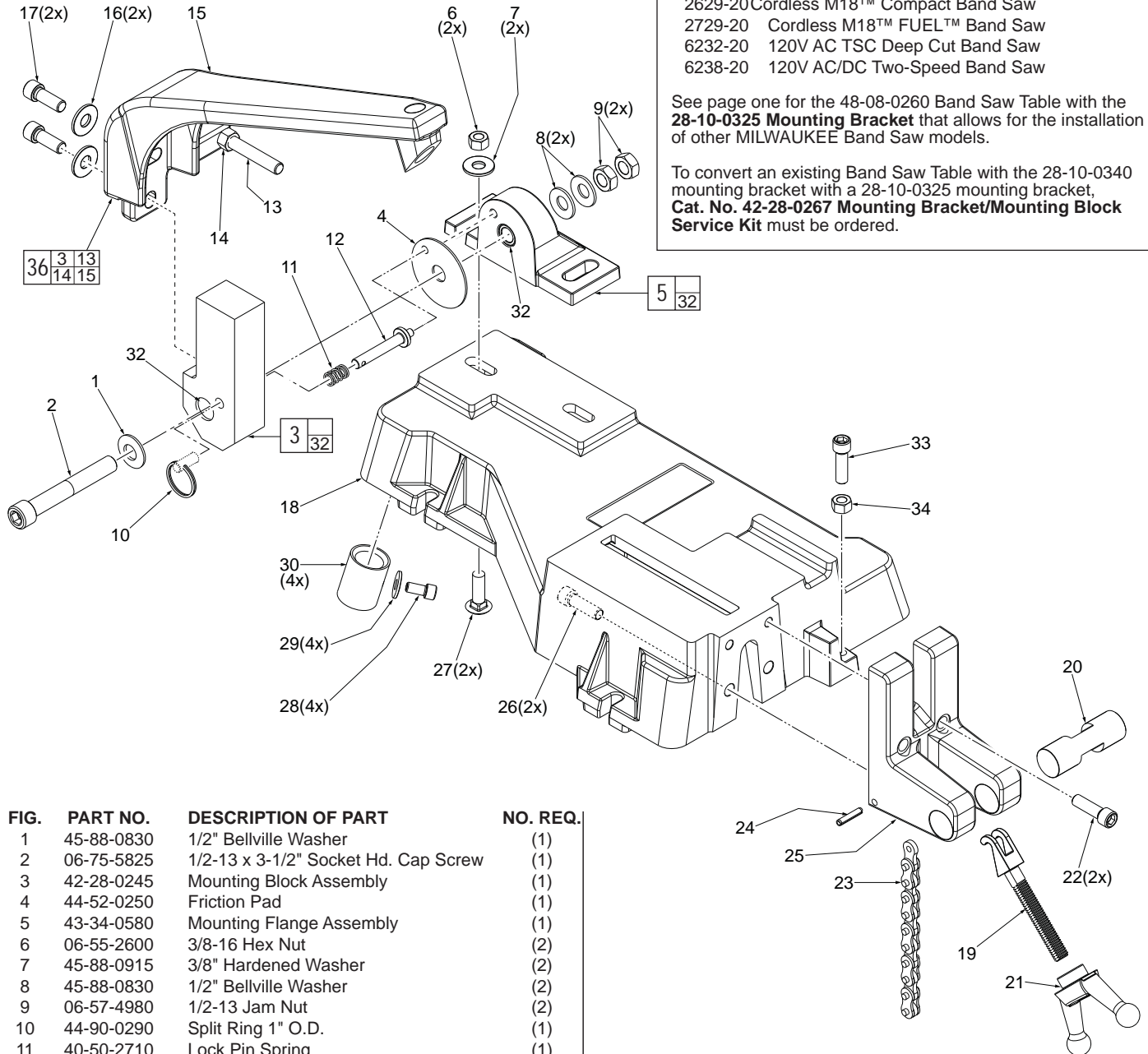

FIG.	PART NO.	DESCRIPTION OF PART	NO. REQ.
1	45-88-0830	1/2" Bellville Washer	(1)
2	06-75-5825	1/2-13 x 3-1/2" Socket Hd. Cap Screw	(1)
3	42-28-0245	Mounting Block Assembly	(1)
4	44-52-0250	Friction Pad	(1)
5	43-34-0580	Mounting Flange Assembly	(1)
6	06-55-2600	3/8-16 Hex Nut	(2)
7	45-88-0915	3/8" Hardened Washer	(2)
8	45-88-0830	1/2" Bellville Washer	(2)
9	06-57-4980	1/2-13 Jam Nut	(2)
10	44-90-0290	Split Ring 1" O.D.	(1)
11	40-50-2710	Lock Pin Spring	(1)
12	44-60-0840	Locking Pin	(1)
13	06-75-0180	3/8-16 x 3-1/2" Full Thread Skt. Hd. Cap Sc	(1)
14	06-55-2600	3/8-16 Hex Nut	(1)
15	28-10-0340	Bandsaw Mounting Bracket	(1)
16	45-88-0915	3/8" Hardened Washer	(2)
17	06-75-4675	3/8-16 x 1" Socket Hd. Cap Screw	(2)
18	42-20-0620	Base	(1)
19	43-74-0110	Chain Hook	(1)
20	44-60-0850	Swivel Pin	(1)
21	44-40-0610	Crank Nut	(1)
22	06-75-4696	3/8-16 x 1-1/4" Socket Hd. Cap Screw	(2)
23	42-60-0130	Chain 5/8" Pitch x 21" Long	(1)
24	06-65-1585	3/16 x 1" Roll Pin	(1)
25	42-68-0540	Mounting Vise	(1)
26	06-75-4696	3/8-16 x 1-1/4" Socket Hd. Cap Screw	(2)
27	06-10-1205	3/8-16 x 1-1/2" Carriage Bolt	(2)

FIG.	PART NO.	DESCRIPTION OF PART	NO. REQ.
28	06-75-3925	5/16-18 x 5/8" Socket Hd. Cap Screw	(4)
29	45-88-1020	5/16" Flat Washer	(4)
30	42-90-0180	3/4" N.P.T. Galv. Coupling	(4)
32	42-40-0820	Bushing	(2)
33	06-75-4696	3/8-16 x 1-1/4" Socket Hd. Cap Screw	(1)
34	06-55-2600	3/8-16 Hex Nut	(1)
36	42-28-0265	Mounting Bracket/Mounting Block Svc. Kit	(1)
	49-96-0120	5/16" Allen Wrench (Not Shown)	(1)