



# SERVICE PARTS LIST

**BUL.54-14-2102**

**3/4" DRILL**

REVISED BUL 6300-3      DATE April '68

**Catalog No. 4270-1**

Starting Serial No. **300-1321**

WIRING INSTR. **58-01-0370**

*Both Model and Serial No. must be furnished to obtain correct parts.*

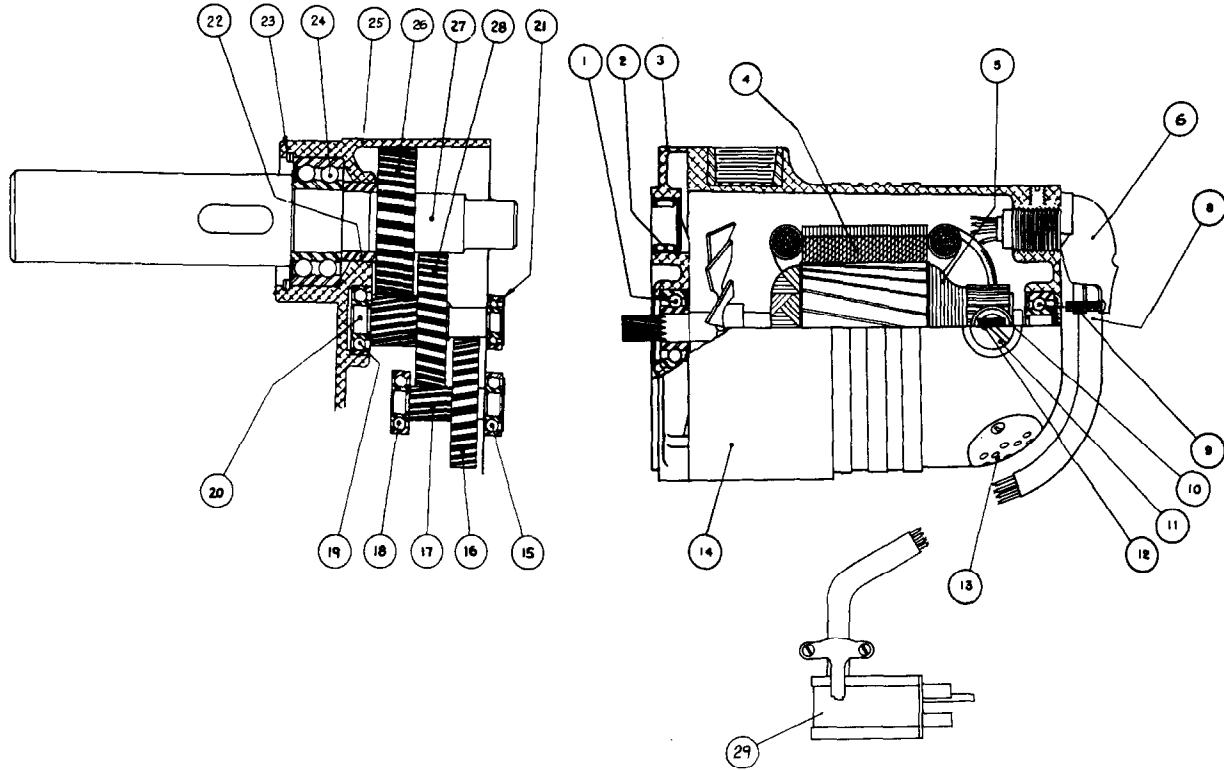

230V Motor  
16-86-1211 Armature  
18-86-1060 Field

**ILLUSTRATED PARTS**

FIG.	PART NO.	DESCRIPTION OF PART
1	02-04-1140	Ball Bearing (Pinion End)
2	02-50-4820	Needle Bearing
3	28-28-0301	Diaphragm
4	18-82-1070	Field Assembly
5	16-82-1231	Armature Assembly
6	22-56-0060	Right Angle Connector
8	22-64-0530	Cord Set (Incl. Item 29)
9	02-04-1070	Ball Bearing
10	22-22-0015	Brush Holder Assembly (2)
11	23-44-0030	Brush Retaining Screw (2)
12	22-18-0055	Carbon Brush Assembly (2)
13	44-66-0180	Air Intake Cover Plate
14	28-50-4121	Motor Housing

FIG.	PART NO.	DESCRIPTION OF PART
15	02-04-0910	Ball Bearing
16	32-42-1201	Intermediate Gear
17	36-66-1251	Intermediate Pinion Shaft
18	02-04-0910	Ball Bearing
19	02-04-1210	Ball Bearing
20	36-66-1301	Inter. Pinion Shaft
21	02-04-0820	Ball Bearing
22	45-36-0080	Spindle Spacer
23	34-80-3800	Ball Bearing Retaining Ring
24	02-20-2520	Ball Bearing
25	28-14-0091	Gear Case
26	32-75-1261	Spindle Gear
27	38-50-4201	No. 2 Morse Taper Spindle
28	32-44-1141	2nd Intermediate Gear
29	22-56-0210	Cinch Plug

**MISCELLANEOUS PARTS NOT SHOWN**

PART NO.	DESCRIPTION OF PART
12-98-0900	Name Plate
48-86-0060	Drift Pin
06-81-8400	4-40x1/4 Rd.Hd. Sem Name Plate Scrs. s (2)
06-81-1975	1/4-20x2-1/4 Fil. Hd. Gear Case Screws (2)
06-83-2650	1/4-20x3/8 Hd <sup>l</sup> less Brush Holder Set Scrs.(2)
★ 06-83-2650	1/4-20x3/8 Hd <sup>l</sup> less Set Screws
★ 06-97-3400	Lock Washers (2)
★ 06-97-3800	Lock Washers (4)
★ 49-96-0080	Socket Wrench
★ 06-81-8650	6-32x1/4 Rd.Hd. Sem Air Intake Plate Scrs. (2)

PART NO.	DESCRIPTION OF PART
06-81-2100	1/4-20x3-1/4 Fil. Hd. Gear Case Screws (2)
06-42-1200	No. 212 Woodruff Key
06-42-2000	No. 3 Woodruff Key
06-42-2400	No. 61 Woodruff Key
44-66-0050	Body Cover Plate (4)
06-81-1150	10-24x3-1/8 Lg. Fil. Hd. Sems Field Scs. (2)
★ 06-81-3100	5/16-18x1 Skt. Hd. Scr.
★ 06-81-5000	1/4-20x3/8 Truss Hd. Scrs. (4)