

# Exploded View - Model J-7020M/J-7040M Miter Cut-off Saw Base

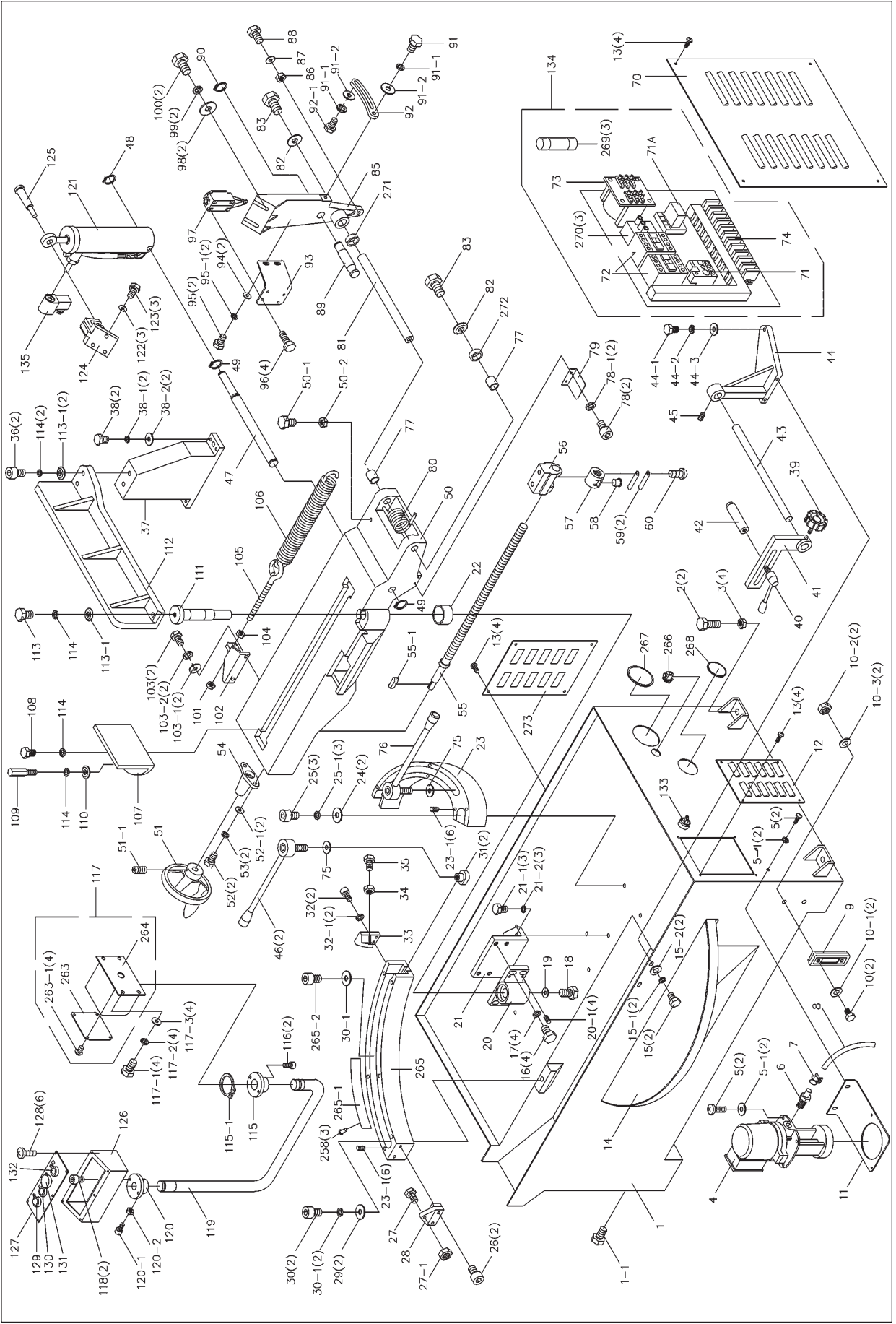

# Parts List - Model J-7020M/J-7040M Miter Cut-off Saw Base

| ITEM NO. | PART NO.   | DESCRIPTION                  | QTY | ITEM NO. | PART NO.   | DESCRIPTION               | QTY |
|----------|------------|------------------------------|-----|----------|------------|---------------------------|-----|
| 1        | J-5507591  | Base, Machine                | 1   | 40       | 5712441    | Handle, Lock              | 1   |
| 1-1      | 5512197    | Plug, Drain (3/8in, PT)      |     | 41       | 5712421    | Work Stop Bracket         | 1   |
| 2        | 5507592    | Screw, Cap, 12 x 70          | 4   | 42       | 5712451    | Stop, Work                | 1   |
| 3        | 5507593    | Nut, Hex, M12                | 4   | 43       | 5712431    | Rod, Work Stop            | 1   |
| 4        |            | Pump, Coolant                | 1   | 44       | J-5507628  | Support                   | 1   |
|          | J-5712281  | 115/220V, 1 Phase            |     | 44-1     | TS-1482061 | Screw, Cap, (M6 x 30)     | 1   |
|          | J-5712921A | 220/440V, 3 Phase            |     | 44-2     | 5516257    | Washer, Lock, M6          | 1   |
| *        | 5512101    | Filter Screen w/Screw        | 1   | 44-3     | 5516253    | Washer, M6                | 1   |
| 5        | 5507595    | Screw, Slotted, M6 x 16      | 4   | 45       | 5507629    | Screw, Set                | 1   |
| 5-1      | 5507607    | Flat Washer, M12             | 4   | 46       | 5507630    | Handle, Adjustable        | 2   |
| 6        | 5507596    | Fitting, Hose                | 1   | 47       | 5507631    | Pin, Cylinder             | 1   |
| 7        | 5507597    | Clamp, Hose                  | 1   | 48       | 5507632    | C-Ring, S-20              | 1   |
| 8        | 5712331    | Hose 5/16                    | 1   | 49       | 5507633    | C-Ring, S-25              | 2   |
| 9        | 5507599    | Gauge, Coolant               | 1   | 50       | J-5507634  | Bed                       | 1   |
| 10       | 5507600    | Bolt, Hex, M10 x 30          | 2   | 50-1     | TS-1491041 | Bolt, Hex, M10 x 30       | 1   |
| 10-1     | 5507599-1  | Washer, Cotton, M10          | 2   | 50-2     | 5507619    | Nut, Hex, M10             | 1   |
| 10-2     | TS-1540071 | Nut Hex M10                  | 2   | 51       | 5712471    | Hand Wheel Assembly       | 1   |
| 10-3     | 5507613    | Flat Washer, M10             | 2   | 51-1     | TS-0051011 | Screw, Set, 5/16" x 1/2"  | 1   |
| 11       | 5712351    | Bracket, Pump, Coolant       | 1   | 52       | 5507636    | Bolt, Hex, M8 x 30        | 2   |
| 12       | 5507602    | Cover, Panel                 | 1   | 52-1     | 5507668    | Flat Washer, M8           | 2   |
| 13       | 5507603    | Screw, Pan Head, 1/4" x 3/8' | 12  | 53       | 5507637    | Washer, Lock, M8          | 2   |
| 14       | J-5507604  | Tray, Drip                   | 1   | 54       | 5712481    | Lead Screw Bracket        | 1   |
| 15       | 5507605    | Bolt, Hex, M8 x 16           | 2   | 55       | 5712511    | Vice Lead Screw           | 1   |
| 15-1     | 5507637    | Washer, Lock, M8             | 2   | 55-1     |            | Key, 5 x 5 x 20mm         | 1   |
| 15-2     | 5507668    | Flat Washer, M8              | 2   | 56       | 5712521    | Lead Screw Bracket        | 1   |
| 16       | 5507606    | Bolt, Hex, M12 x 30          | 4   | 57       | 5712531    | Nut, Acme                 | 1   |
| 17       | 5507607    | Washer, Flat, M12            | 4   | 58       | 5712541    | Acme Nut Button           | 1   |
| 18       | 5512701    | Bolt, Hex M8 x 16            | 1   | 59       | 5712551    | Acme Nut Retainer         | 2   |
| 19       | 5507608    | Washer, Flat                 | 1   | 60       | 5712561    | Screw Pn Hd PhlpsM5 x 8   | 1   |
| 20       | 5507609    | Bracket, Turning Slide       | 1   | 70       | 5507646    | Panel, Electrical, Access | 1   |
| 20-1     | 5516251    | Screw, Set, M8 x 10          | 4   | 71       |            | Overload                  | 1   |
| 21       | 5507610    | Bracket, Center Fixed        | 1   |          | 5507542    | 115V, 1-Phase             |     |
| 21-1     | TS-1492031 | Bolt, Hex, M12 x 35          | 3   |          | 5713031    | 220V, 1-Phase             |     |
| 21-2     | 5516256    | Washer, Lock, M12            | 3   |          | 5512660    | 220V, 3-Phase             |     |
| 22       | 5507611    | Bearing, Thrust              | 1   |          | 5712661    | 440V, 3-Phase             |     |
| 23       | J-5507612  | Slide, Turning, Right        | 1   | 71A      | 5508409    | Relay, 115/220V, NC       | 1   |
| 23-1     | 5516251    | Screw, Set, M8 x10           | 12  | 72       |            | Motor Contactor           | 2   |
| 24       | 5507613    | Washer, Flat, M10            | 2   |          | 5713041    | 115/220V, 1 Phase         |     |
| 25       | 5507614    | Screw, Cap, M10 x 40         | 3   |          | 5713001    | 220/440V, 3 Phase         |     |
| 25-1     | 5516255    | Washer, Lock, M10            | 3   | 73       | 5713051    | Transformer, 1PH/3PH      | 1   |
| 26       | 5507615    | Screw, Cap, M6 x 20          | 2   | 74       | 5713061    | Strip, Terminal           | 1   |
| 27       | 5512702    | Bolt, Hex                    | 1   | 75       | 5507651    | Washer, Flat, M16         | 2   |
| 27-1     | 5507619    | Nut, Hex, M10                | 1   | 76       | 5512708    | Handle                    | 1   |
| 28       | 5507616    | Bracket                      | 1   | 77       | 5712571    | Bearing, Needle           | 2   |
| 29       | 5507613    | Washer, Flat, M10            | 2   | 78       | 5507653    | Screw, Cap, M6 x 12       | 2   |
| 30       | 5507614    | Screw, Cap, M10 x 40         | 2   | 78-1     | 5516257    | Washer, Lock, M6          | 2   |
| 30-1     | 5516255    | Washer, Lock, M10            | 3   | 79       | 5507654    | Plate, Guide              | 1   |
| 31       | 5512705    | Nut, Sliding                 | 2   | 80       | 5507655    | Spring, Torsion           | 1   |
| 32       | 5507618    | Screw, Cap, M6 x30           | 2   | 81       | 5712591    | Shaft, Pivot              | 1   |
| 32-1     | 5516257    | Washer, Lock, M6             | 2   | 82       | 5507607    | Washer, Flat, M12         | 2   |
| 33       | 5512706    | Bracket                      | 1   | 83       | 5507658    | Fitting, Brass            | 2   |
| 34       | 5507619    | Nut, Hex, M10                | 1   | 85       | 5507660    | Bracket, Pivot            | 1   |
| 35       | 5507620    | Bolt, Hex, M10 x 25          | 1   | 86       | 5507661    | Nut, Hex, M12             | 1   |
| 36       | 5507621    | Screw, Set, M8 x 16          | 2   | 87       | 5507607    | Washer, Flat, M12         | 1   |
| 37       | 5512707    | Bracket, Mounting            | 1   | 88       | 5507662    | Bolt, Hex, M12 x 40       | 1   |
| 38       | TS-149105  | Bolt, Hex, M10 x 35          | 2   | 89       | 5507663    | Shaft, Torsion Spring     | 1   |
| 38-1     | 5516255    | Washer, Lock, M10            | 2   | 90       | 5507664    | C-Ring, S-22              | 1   |
| 38-2     | 5507613    | Flat Washer, M10             | 2   | 91       | 5507665    | Bolt, Cap, M8 x 25        | 1   |
| 39       | 5713111    | Knob, Lock                   | 1   | 91-1     | 5507637    | Washer, Lock, M8          | 2   |
|          |            |                              |     | 91-2     | 5507668    | Flat Washer, M8           | 2   |

\* Not shown in exploded view.

# Parts List - Model J-7020M/J-7040M Miter Cut-off Saw Base

| ITEM NO. | PART NO.   | DESCRIPTION                | QTY | ITEM NO. | PART NO.  | DESCRIPTION                      | QTY |
|----------|------------|----------------------------|-----|----------|-----------|----------------------------------|-----|
| 92       | 5507666    | Plate, Motor Tilt          | 1   | 263-1    |           | Screw, Pan Head,<br>3/16" x 1/4" | 4   |
| 92-1     | TS-1490041 | Bolt, Hex, M8 x 25         | 1   | 264      |           | Base, Box                        | 1   |
| 93       | 5507667    | Plate, Limit Switch        | 1   | 265      | J-5521930 | Sliding, Turn, Left              | 1   |
| 94       | 5507668    | Washer, Flat, M8           | 2   | 265-1    |           | Scale, Angle                     | 1   |
| 95       | 5507669    | Bolt, Hex, M8 x 10         | 2   | 265-2    |           | Screw, Cap, M10 x 25             | 1   |
| 95-1     | 5507637    | Washer, Lock, M8           | 2   | 266      |           | Strain Relief                    | 1   |
| 96       | TS-1482011 | Bolt, Hex, M6 x 10         | 4   | 267      |           | Ring, Rubber                     | 1   |
| 97       | 5712741    | Switch, Limit              | 1   | 268      |           | Ring, Rubber                     | 1   |
| 98       | 5507671    | Plate                      | 2   | 269      | 5519503   | Fuse, 1A                         | 3   |
| 99       | 5507607    | Washer, Flat, M12          | 2   | 270      | 5519502   | Bracket, Fuse                    | 3   |
| 100      | 5512711    | Screw, Cap, M12 x 50       | 2   | 271      |           | Bushing, 9mm                     | 1   |
| 101      | 5711091    | Nut, Hex, 1/2              | 1   | 272      |           | Bushing, 3mm                     | 1   |
| 102      | 5507674    | Bracket, Spring            | 1   | 273      | 5516856   | Panel, Access                    | 1   |
| 103      | 5512712    | Screw, Cap, M8 x 30        | 2   | *        | 5512787   | Kit, Piston/Seal                 | 1   |
| 103-1    | 5507668    | Flat Washer, M8            | 2   | *        | 5713371A  | E-M Valve & Coil                 | 1   |
| 103-2    | 5507637    | Washer, Lock, M8           | 2   |          |           |                                  |     |
| 104      | 5711091    | Nut, Hex, 1/2              | 1   |          |           |                                  |     |
| 105      | 5507675    | C-Bolt, Adjustable         | 1   |          |           |                                  |     |
| 106      | 5507676    | Spring                     | 1   |          |           |                                  |     |
| 107      | 5507677    | Vise, Left Jaw             | 1   |          |           |                                  |     |
| 108      | 5512713    | Bolt, Hex, M12 x 35        | 1   |          |           |                                  |     |
| 109      | 5512714    | Screw, Clamping            | 1   |          |           |                                  |     |
| 110      | 5507678    | Washer, Lock, M12          | 1   |          |           |                                  |     |
| 111      | 5507679    | Pin, Pivot                 | 1   |          |           |                                  |     |
| 112      | 5507680    | Vise, Fixed Jaw            | 1   |          |           |                                  |     |
| 113      | 5512715    | Bolt, Hex, M12 x 40        | 1   |          |           |                                  |     |
| 113-1    | 5507607    | Flat Washer, M12           | 3   |          |           |                                  |     |
| 114      | 5507678    | Washer, Lock, M12          | 5   |          |           |                                  |     |
| 115      | 5713231    | Swivel Bushing             | 1   |          |           |                                  |     |
| 115-1    |            | C-Ring, S-32               | 1   |          |           |                                  |     |
| 116      | 5507682    | Screw, Cap                 | 2   |          |           |                                  |     |
| 117      | 5507683    | Box, Stationary            | 1   |          |           |                                  |     |
| 117-1    | TS-1490021 | Bolt, Hex, M8 x 16         | 4   |          |           |                                  |     |
| 117-2    | 5507637    | Washer, Lock, M8           | 4   |          |           |                                  |     |
| 117-3    | 5507668    | Flat Washer, M8            | 4   |          |           |                                  |     |
| 118      | 5713271    | Screw, Cap, 1/4 x 3/4      | 2   |          |           |                                  |     |
| 119      | J-5713261  | Column, Control            | 1   |          |           |                                  |     |
| 120      | 5713281    | Swivel                     | 1   |          |           |                                  |     |
| 120-1    | TS-0050021 | Screw, Cap, 1/4" x 5/8"    | 1   |          |           |                                  |     |
| 120-2    | 5519510    | Nut, Hex, 1/4"             | 1   |          |           |                                  |     |
| 121      | 5507686    | Cylinder, Hydraulic        | 1   |          |           |                                  |     |
| 122      | 5507687    | Washer, Lock, M10          | 3   |          |           |                                  |     |
| 123      | 5512718    | Bolt, Hex, M10 x 30        | 3   |          |           |                                  |     |
| 124      | J-5507688  | Plate, Hydraulic Mtg.      | 1   |          |           |                                  |     |
| 125      | 5507689    | Pin, Cotter                | 1   |          |           |                                  |     |
| 126      | J-5713291  | Box, Control               | 1   |          |           |                                  |     |
| 127      | 5713311    | Panel, Control             | 1   |          |           |                                  |     |
| 128      | 5713321    | Screw, Slotted, 3/16 x 1/4 | 6   |          |           |                                  |     |
| 129      | 5713331    | Lamp, Electric Pwr on      | 1   |          |           |                                  |     |
| 130      | 5713341    | Switch, Start              | 1   |          |           |                                  |     |
| 131      | 5713351    | Switch, Stop               | 1   |          |           |                                  |     |
| 132      | 5713361    | Switch, Down               | 1   |          |           |                                  |     |
| 133      | 5516855    | Switch, Pump, Coolant      | 1   |          |           |                                  |     |
| 134      |            | Panel, Elect., Complete    | 1   |          |           |                                  |     |
|          | 5514613    | 3-Phase                    |     |          |           |                                  |     |
|          | 5514616    | 1-Phase                    |     |          |           |                                  |     |
| 135      | 5713371    | E-M Valve Complete         | 1   |          |           |                                  |     |
| 263      |            | Cover, Box                 | 1   |          |           |                                  |     |

\* Not shown in exploded view.



# Parts List - Model J-7020M/J-7040M Miter Cut-off Saw Head

| ITEM NO. | PART NO.   | DESCRIPTION            | QTY | ITEM NO. | PART NO.   | DESCRIPTION               | QTY |
|----------|------------|------------------------|-----|----------|------------|---------------------------|-----|
| 145      | 5713381    | Screw, 1/4 x 3/8       | 2   |          | 5519683M   | Model 7040, 2HP, 3P       |     |
| 146      | J-5507697  | Cover, Blade Wheel     | 1   | 177-2    | TS-1490081 | Bolt, Hex, M8 x 45        | 4   |
| 146-1    | 5518109    | Label, JET Logo        | 1   | 177-3    | 5507637    | Washer, Lock, M8          | 4   |
| 146-2    | 5519511    | Label, Blade Size      | 1   | 177-4    | 5507668    | Washer, M8                | 8   |
| 146-3    | 5519513    | Label, Glasses         | 1   | 177-5    | 5516239    | Nut, Hex, M8              | 4   |
| 146-4    | 5519512    | Label, Warning         | 1   | 178      | 5713741    | Bolt, 1/2 x 3/4           | 1   |
| 147      | 5713411    | Guard, Wire Brush      | 1   | 180      | 5513733    | Key, 7 x 7 x 40           | 1   |
| 147-1    | 5519514    | Label, Saw             | 1   | 181      | 5713761    | Washer, 1/2" I.D.         | 1   |
| 148      | 5713421    | Handle                 | 2   | 182      | 5713771    | Washer, 5/16              | 2   |
| 149      | 5713431    | Washer, 1/2"           | 1   | 183      | 5713671    | Screw, Slotted, 1/4 x 3/8 | 6   |
| 150      | J-5713831  | Wheel, Drive           | 1   | 184      | 5713781    | Screw, Cap, M16 x 30      | 3   |
| 150-1    |            | Bushing, 4mm           | 1   | 185      | 5713791    | Bolt, 1/2 x 3/4           | 1   |
| 151      |            | Blade, Bi-Metal        | 1   | 186      | 5713811    | Washer, 1/2"              | 1   |
|          | 5674011    | 4/6 Vari Tooth         |     | 187      | BB-6205Z   | Bearing 6205Z             | 2   |
|          | 5674021    | 6/10 Vari Tooth        |     | 188      | J-5713441  | Wheel, Idler              | 1   |
| 152      | 5713461    | Hose                   | 1   | 189      | J-5713841  | Guard, Blade              | 1   |
| 152-1    | 5519515    | Clamp, Hose            | 1   | 189-1    | TS-1490021 | Bolt, Hex, M8 x16         | 1   |
| 153      | 5713471    | Bolt, 3/8 x 1-1/4      | 4   | 189-2    | 5507637    | Washer, Lock, M8          | 1   |
| 154      | 5713481    | Washer, Spring, 3/8    | 4   | 189-3    | 5507668    | Washer, M8                | 1   |
| 155      | 5713491    | Bolt, 1/2 x 1-1/4      | 4   | 190      | 5713851    | Left Blade Guide Brkt.    | 1   |
| 156      | 5713511    | Bolt, 5/16 x 1/2       | 2   | 190A     | 5713851A   | Right Blade Guide Brkt.   | 1   |
| 157      | 5713521    | Screw, 1/4 x 5/8       | 4   | 190-1    |            | Screw, Cap, 1/2" x 3/8"   | 4   |
| 157-1    | 5713661    | Washer, 1/4            | 4   | 190-2    | 5628371    | Washer, Lock, 1/2"        | 4   |
| 158      | J-5507709  | Box, Blade Wheel       | 1   | 190-3    | 5507607    | Washer, 1/2"              | 4   |
| 158-1    |            | Label, ID              | 1   | 190-4    | 5519684    | Tube, Copper              | 2   |
| 158-2    | 5519672    | Label, Tension         | 1   | 190-5    | TS-0270051 | Screw, Set, 5/16" x 1/2"  | 6   |
| 158-3    | 5519696    | Stopper, Arm           | 1   | 191      | 5717138    | Assy., Eccentric Shaft    | 2   |
| 158-4    | 5711091    | Nut, Hex, 1/2"         | 1   | 191A     | 5717142    | Assy., Center Shaft       | 2   |
| 159      | 5713541    | Seat, Support Bracket  | 1   | 192      | 5713871    | Guide, Blade, Tun. Carb.  | 4   |
| 159-1    | TS-0070051 | Bolt, Hex, 1/2" x 2"   | 1   | 192-1    | 5713661    | Washer, 1/4"              | 8   |
| 159-2    | 5711091    | Nut, Hex, 1/2"         | 1   | 192-2    | 5713651    | Washer, Lock, 1/4"        | 4   |
| 160      | J-5507711  | Gearbox Assembly       | 1   | 192-3    | 5519508    | Screw, Cap, 1/4" x 1"     | 4   |
| 160-1    | 5519675    | Key, 7 x 7 x 40        | 1   | 193      | 5713881    | Block, Elevating          | 2   |
| 161      | 5513734    | Key, 7 x 7 x 65        | 1   | 194      | 5713891    | Block, Active             | 2   |
| 162      | J-5507713  | Cover, Speed Change    | 1   | 195      | 5713911    | Screw, Cap, 1/4 x 5/16    | 2   |
| 162-1    | 5510677    | Label, Speed Chart     | 1   | 196      | 5632831    | Bearing, 608ZZ            | 4   |
| 162-2    | 5519676    | Knob                   | 1   | 197      | 5713931    | Washer, Spring, 5/16      | 4   |
| 162-3    | 5714041    | Washer, 3/8"           | 1   | 198      | 5713941    | Screw, Cap, 5/16 x1-3/4   | 4   |
| 163      | 5713581    | Pulley, Gearbox        | 1   | 199      | 5713951    | Washer, Lock, Black, 5/16 | 4   |
| 164      | 5713591    | Belt                   | 1   | 200      | J-5713961  | Guide Support             | 2   |
| 165      | 5713611    | Pulley, Motor          | 1   | 200-1    | 5518423    | Label, Blade Orientation  | 2   |
| 166      | J-5507717  | Plate, Speed Change    | 1   | 201      | 5713971    | Scale, Angle              | 1   |
| 166-1    |            | Bolt, Hex, M8 x16      | 2   | 202      | 5713981    | Screw, Flat, M5 x 0.8     | 4   |
| 166-2    | 5507637    | Washer, Lock, M8       | 2   | 203      | 5713991    | Guide Support Mount       | 1   |
| 166-3    | 5507668    | Flat Washer, M8        | 1   | 204      | J-5714011  | Left Bracket support      | 1   |
| 167      | 5507718    | Plate, Motor Mount     | 1   | 204-1    | 5712561    | Screw, Pan Head, M5 x 8   | 4   |
| 168      | 5713771    | Washer, 5/16           | 2   | 204-2    | 5519694    | Clamp, Rubber             | 4   |
| 169      | 5713661    | Washer, 1/4            | 1   | 205      | 5714021    | Screw, 1/2 x 1            | 4   |
| 170      | 5713651    | Washer Lock 1/4        | 2   | 205-1    | 5507607    | Washer, 1/2"              | 2   |
| 171      | 5713661    | Washer, 1/4            | 2   | 206      | 5714031    | Knob                      | 2   |
| 172      | 5714291    | Valve, Relief          | 1   | 207      | 5714041    | Washer, 3/8               | 2   |
| 173      | 5628371    | Washer, Spring, 1/2    | 4   | 208      | 5714051    | Block, Locking            | 2   |
| 174      | 5713691    | Washer, Black, 5/16    | 4   | 209      | 5714061    | Screw, 5/16 x 1/2         | 4   |
| 175      | 5713711    | Screw, Cap, 3/8 x 1    | 2   | 210      | J-5714071  | Right Bracket support     | 1   |
| 176      | 5713721    | Screw, Cap, 5/16 x 5/8 | 4   | 211      | 5714161    | Bolt, 1/4 x 1/2           | 1   |
| 177      |            | Motor                  | 1   | 212      | 5713651    | Washer, Spring, 1/4       | 1   |
|          | J-5713731M | Model 7020, 1HP, 1P    |     | 213      | 5714111    | Brush, Wire               | 1   |
|          | J-5713732M | Model 7040, 2HP, 3P    |     | 214      | 5714121    | Seat, Steel Brush         | 1   |
| 177-1    |            | Label, Motor           | 1   | 215      | 5713771    | Washer, 5/16              | 2   |
|          | 5519682M   | Model 7020, 1HP, 1P    |     | 216      | 5714141    | Clamp, Hose               | 2   |

## Parts List - Model J-7020M/J-7040M Miter Cut-off Saw Head

| ITEM NO. | PART NO.   | DESCRIPTION                 | QTY | ITEM NO. | PART NO. | DESCRIPTION      | QTY |
|----------|------------|-----------------------------|-----|----------|----------|------------------|-----|
| 217      | 5713651    | Washer, Spring, 1/4         | 4   | 261-1    | 5714041  | Washer, 3/8"     | 1   |
| 218      | 5714161    | Bolt, 1/4 x 1/2             | 4   | 261-2    | 5713081  | Nut, Hex, 3/8"   | 1   |
| 219      | 5628371    | Washer, Spring, 1/2         | 4   | 262      | 5714311  | Connection, Head | 1   |
| 220      | 5714181    | Gib                         | 2   |          |          |                  |     |
| 221      | 5714191    | Screw, Cap, 1/2 x 3/4       | 1   |          |          |                  |     |
| 222      | 5714211    | Screw, Cap, M8 x 20         | 4   |          |          |                  |     |
| 222-1    | 5507668    | Washer, M8                  | 4   |          |          |                  |     |
| 224      | 5714221    | Knob                        | 4   |          |          |                  |     |
| 225      | 5714231    | Nozzle, Flexible            | 1   |          |          |                  |     |
| 225-1    | 5507607    | Clamp, Hose                 | 4   |          |          |                  |     |
| 226      | 5714241    | Shaft, Blade Wheel          | 1   |          |          |                  |     |
| 226-1    | 5519691    | Scale, Tension              | 1   |          |          |                  |     |
| 226-2    | 5519690    | Screw, Pan Head,<br>M6 x 12 | 2   |          |          |                  |     |
| 227      | 5714251    | Threaded Nut                | 1   |          |          |                  |     |
| 228      | 5714261    | Screw, Set, 5/16 x 1/2      | 1   |          |          |                  |     |
| 229      | 5714271    | Bracket, Slide              | 1   |          |          |                  |     |
| 230      | 5714281    | Washer                      | 1   |          |          |                  |     |
| 231      | 5507788    | Shaft, Support              | 1   |          |          |                  |     |
| 231-1    |            | C-Ring, S-19                | 1   |          |          |                  |     |
| 232      | J-5507785  | Bracket, Motor Mount        | 1   |          |          |                  |     |
| 232-1    | TS-1492021 | Bolt, Hex, M12 x 30         | 2   |          |          |                  |     |
| 233      | 5507790    | Bearing (51104NJK)          | 1   |          |          |                  |     |
| 234      | 5507791    | Washer                      | 1   |          |          |                  |     |
| 235      | 5508005    | Nut, Hex                    | 1   |          |          |                  |     |
| 238      | 5714331    | Handle, Blade Cover         | 1   |          |          |                  |     |
| 239      | 5711091    | Nut, Hex, 1/2               | 1   |          |          |                  |     |
| 240      | 5714351    | Washer, 3/4                 | 1   |          |          |                  |     |
| 241      | 5714361    | Washer, Special Spring      | 13  |          |          |                  |     |
| 242      | 5714371    | Wheel, Hand                 | 1   |          |          |                  |     |
| 243      | J-5714381  | Bracket, Slide              | 1   |          |          |                  |     |
| 244      | 5714391    | Shaft, Tension              | 1   |          |          |                  |     |
| 244-1    | 5519692    | Nut, Hex                    | 1   |          |          |                  |     |
| 244-2    | 5519693    | Screw, Set, M6 x8           | 1   |          |          |                  |     |
| 245      | 5714411    | Key, Square, 5MM            | 1   |          |          |                  |     |
| 246      | 5714421    | Bolt, 3/8 x 2-1/2           | 3   |          |          |                  |     |
| 246-1    | 5713481    | Washer, Lock, M10           | 3   |          |          |                  |     |
| 247      | J-5714431  | Seat, Oil Pressure          | 1   |          |          |                  |     |
| 247-1    | TS-1490021 | Bolt, Hex, M8 x 16          | 2   |          |          |                  |     |
| 247-2    | 5507637    | Washer, Lock, M8            | 2   |          |          |                  |     |
| 247-3    | 5507668    | Washer, M8                  | 2   |          |          |                  |     |
| 248      | J-5714441  | Plate, Cover                | 1   |          |          |                  |     |
| 249      | 5714451    | Screw, Slotted, 5/16x5/8    | 2   |          |          |                  |     |
| 250      | 5714461    | Panel, Control              | 1   |          |          |                  |     |
| 251      | 5714471    | Screw, Slotted, 1/4x3/8     | 2   |          |          |                  |     |
| 252      | 5713941    | Screw, Cap, 5/16x1-3/4      | 4   |          |          |                  |     |
| 253      | 5712881    | Washer, Lock, 1/2           | 4   |          |          |                  |     |
| 254      | 5517141    | Bushing, Eccentric          | 2   |          |          |                  |     |
| 255      | 5517140    | Bushing, Center             | 2   |          |          |                  |     |
| 256      | 5713861    | Bearing, Ball, 6201ZZ       | 8   |          |          |                  |     |
| 257      | 5713761    | Washer, 1/2                 | 4   |          |          |                  |     |
| 258      | 5519492    | Rivet, 2mm                  | 9   |          |          |                  |     |
| 259      | TS-1525031 | Screw, Set, M10 x 16        | 2   |          |          |                  |     |
| 260      | 5519679    | Bracket                     | 1   |          |          |                  |     |
| 260-1    | 5713381    | Bolt, Hex, 1/4" x 3/8"      | 2   |          |          |                  |     |
| 260-2    | 5713651    | Washer, Lock, 1/4"          | 2   |          |          |                  |     |
| 260-3    | 5713661    | Washer, 1/4"                | 2   |          |          |                  |     |
| 261      | 5519678    | Rod                         | 1   |          |          |                  |     |