

Nibbler - 0 607 561 102 - 400 WATT-SERIE

www.powertools-aftersaleservice.com



BOSCH

Item	Part Number	Description	Illustration	Price	Quantity	Price Group
1	3 605 108 059	Motor Housing BLUE		1	-,-	1 32
2	3 604 090 046	Stator 400W		1	-,-	1 45
3	3 604 220 044	Rotor		1	-,-	1 46
5	3 605 700 076	Bearing Flange		1	-,-	1 34
7	3 600 905 039	groove ball bearing 9x24x7 MM		1	-,-	2 24
8	1 900 905 028	groove ball bearing 7x17x5		1	-,-	1 34
10	1 900 210 124	O-Ring 25x2 MM		1	-,-	1 14
11	1 900 210 118	O-Ring 20x2 MM		1	-,-	1 15
12	3 600 421 001	Reduction Sleeve		1	-,-	1 21
21	3 600 210 022	O-Ring 39,0x2,0 MM		1	-,-	1 15
22	3 600 100 022	Stop Disc		1	-,-	1 12
23	2 600 210 019	O-Ring 33,0x2,0 MM		1	-,-	1 11
24	3 600 327 001	Guide Sleeve		1	-,-	1 25
28	3 605 700 077	Intermediate Flange		1	-,-	1 38
31	3 600 200 009	Intermediate Ring		1	-,-	1 23
35	2 916 690 003	Spring Lock Washer DIN 128-A4-FST		1	-,-	7 10
36	2 910 021 134	Socket head cap screw DIN 84-BM4x30-8.8		1	-,-	3 11
37	2 910 021 138	Socket head cap screw DIN 84-BM4x40-8.8		1	-,-	4 13
55	2 910 211 021	Tapping Screw DIN 7971-ST3,9x22-F		1	-,-	2 10
56	2 910 211 022	Tapping Screw DIN 7971-BZ3,9x25		1	-,-	4 10
58	3 605 500 032	Connection cover		1	-,-	1 21
59	3 603 462 011	Fitting		1	-,-	1 26
60	3 600 002 004	Filter screen		1	-,-	1 14
61	3 600 210 023	O-Ring 6,0x2,0 MM		1	-,-	1 13
62	2 604 611 025	Compression Spring		1	-,-	1 14
63	3 604 710 054	Straight Pin		1	-,-	1 14
64	3 600 210 024	O-Ring 5,94x3,53 MM		1	-,-	1 12
65	3 600 210 025	O-Ring 2,7x1,5 MM		1	-,-	1 12
66	1 903 230 004	Ball DIN 5401-3 MM-III-ST		1	-,-	1 10
69	3 604 610 024	Compression Spring		1	-,-	1 11
70	3 603 450 006	Hex Screw		1	-,-	1 17
71	1 900 210 112	O-Ring 15x2 MM		1	-,-	2 13
76	3 604 682 002	Leaf Spring		1	-,-	1 19

Item	Part Number	Description	Illustration	Price	Quantity	Price Group
77	3 602 033 001	Toggle Switch	1	-,-	1	15
95	1 601 11A 3HF	Nameplate	1	-,-	1	13
96	1 601 110 481	Manufacturer's nameplate SHADOW SIDE	1	-,-	2	12
99	3 601 119 236	Reference Plate	1	-,-	1	15
101	2 605 500 042	Gear Cover	1	-,-	1	38
102	2 605 806 312	Gear Housing	1	-,-	1	38
103	2 606 122 001	Eccentric Shaft	1	-,-	1	46
104	1 900 900 274	groove ball bearing 20x42x12	1	-,-	1	32
105	2 606 334 040	Ring Gear Z=66	1	-,-	1	32
106	3 606 316 057	Cylindrical Gear Z=30	1	-,-	2	20
107	2 603 105 021	Bearing bolt	1	-,-	2	13
108	2 602 001 001	Connecting Rod	1	-,-	1	39
109	2 600 224 009	Retaining ring	1	-,-	2	11
110	2 600 913 035	Needle-Roller Cage	1	-,-	1	23
111	2 603 100 003	Bearing bolt	1	-,-	1	13
112	2 603 104 001	Power piston	1	-,-	1	39
113	2 600 422 005	Bushing	1	-,-	1	28
114	3 603 340 017	Union Nut	1	-,-	1	33
115	2 603 455 006	Hollow Bolt	1	-,-	1	14
116	3 608 639 030	Lower Die Ring	1	-,-	1	30
117	3 608 639 029	Lower Die	1	-,-	1	-
118	3 608 639 026	Nibbling Punch	1	-,-	1	33
119	2 603 414 003	Hex Socket Head Cap Screw	1	-,-	1	17
120	2 600 914 011	Needle bearing	1	-,-	1	29
121	2 916 650 011	Spring retaining ring DIN 471 20x1,2	1	-,-	1	11
122	2 600 550 017	Disc Spring	1	-,-	1	18
123	1 903 201 020	Needle Roller DIN 5402-A2,5x7,8-G2	1	-,-	20	12
124	1 600 100 611	Shim 1,2 MM THICK	1	-,-	2	11
125	2 916 080 908	Locking Washer 5 DIN 6799	1	-,-	2	10
126	3 600 102 019	Shim ring 30X42X0,3	1	-,-	1	11
652	3 603 386 068	Hose fitting	1	-,-	1	29
653	1 907 950 003	Offset Screwdriver DIN 911 SW2,5	1	-,-	1	13
700	2 608 639 013	Nibbling Punch	1	-,-	1	-
701	2 608 639 014	Lower Die	1	-,-	1	-
702	2 608 639 015	Lower Die Ring	1	-,-	1	-
750	3 607 000 073	Silencer	1	-,-	1	28
810	3 607 030 494	Piston Assembly Group	1	-,-	1	26
815	3 607 030 030	Rotor Lamella 5 PIECE	1	-,-	1	31

Illustration - Type E

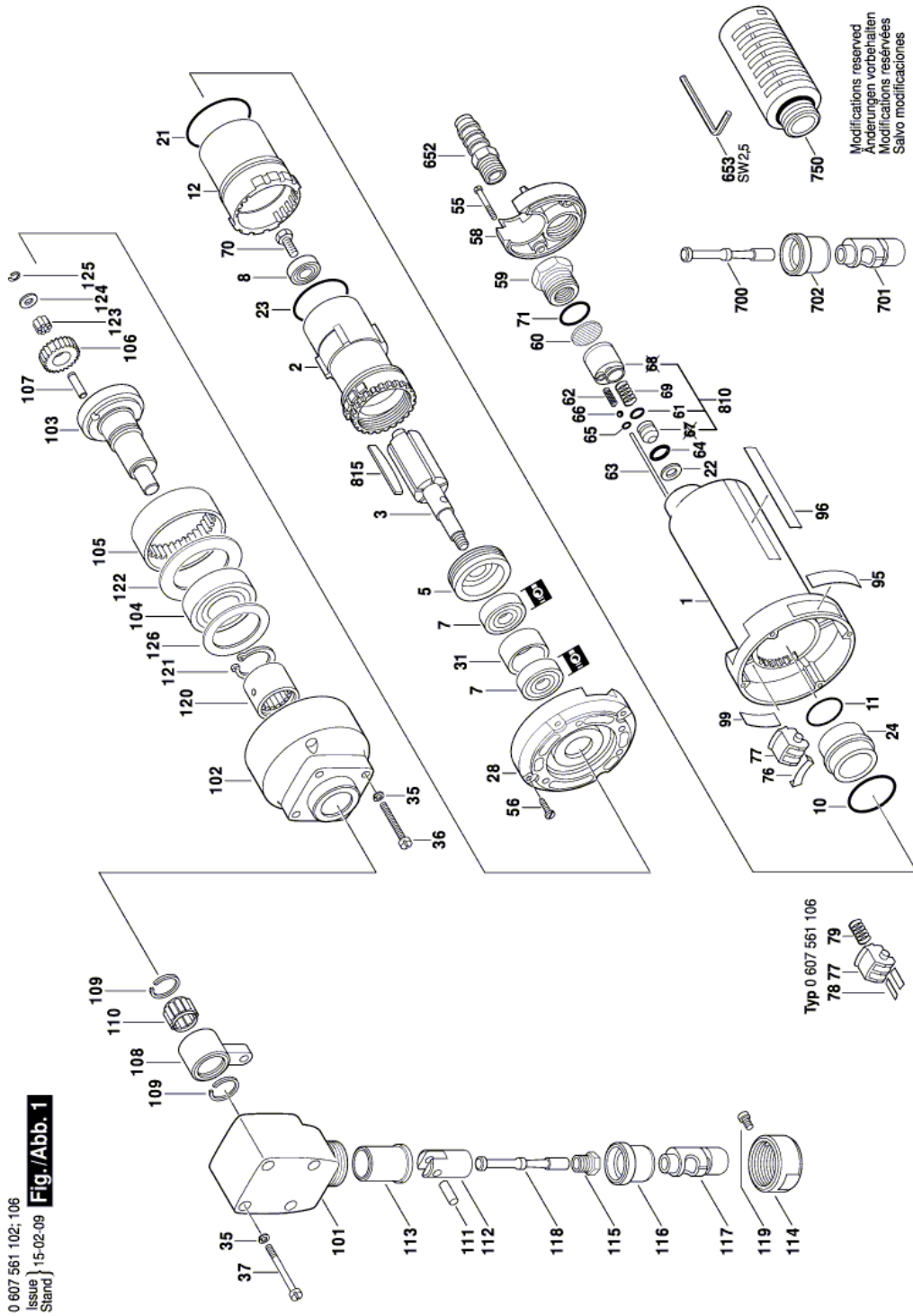

Information subject to change without further notice.