



# SERVICE PARTS LIST

**BUL. 54-16-1002**

## DIAMOND CORE DRILL

REVISED BUL 6198-4      DATE Feb. '68

**Catalog No. 3780**

Starting Serial No. **198-1726**

WIRING INSTR. **58-01-0490**

Both Model and Serial No. must be furnished to obtain correct parts.

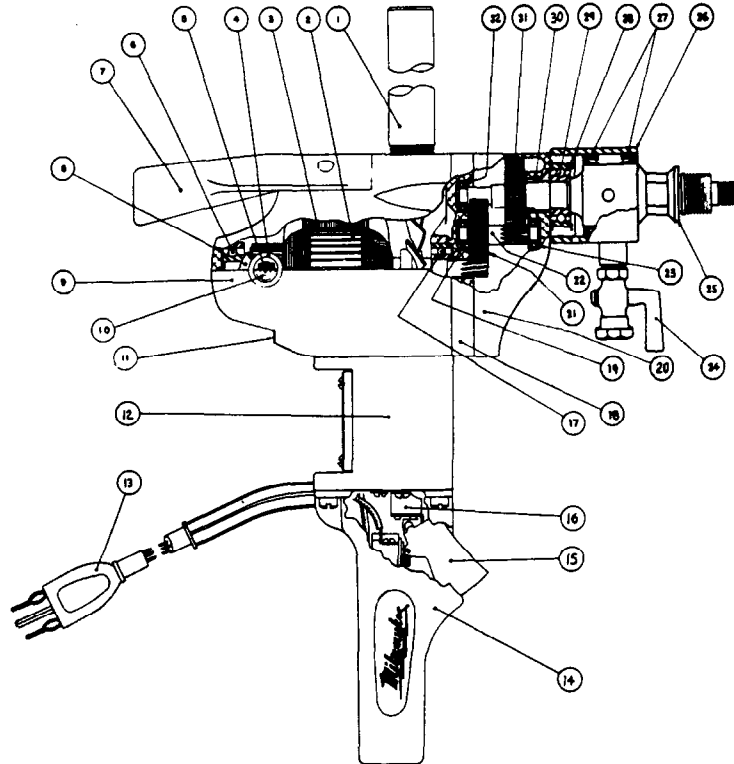

### ILLUSTRATED PARTS

FIG.	PART NO.	DESCRIPTION OF PART	FIG.	PART NO.	DESCRIPTION OF PART
1	43-62-0230	Pipe Handle	17	02-04-1070	Ball Bearing
2	16-62-1000	Armature Assembly	18	28-28-0621	Diaphragm
3	18-62-1000	Field Assembly	19	04-04-0820	Ball Bearing
4	22-22-0120	Brush Holder Assembly (2)	20	28-14-0921	Gear Case
5	22-18-0170	Carbon Brush Assembly (2)	21	32-40-1261	Intermediate Gear
6	02-04-0970	Ball Bearing	22	36-66-2301	Intermediate Shaft
7	28-44-7041	Spade Handle	23	02-04-0820	Ball Bearing
8	23-86-0130	Washer (2)	24	45-80-0060	Valve
9	28-50-4645	Body	25	38-50-3301	Spindle
10	23-44-0065	Brush Retaining Screw (2)	26	43-76-0080	Swivel Housing
11	44-66-0140	Air Intake Cover Plate	27	45-06-0060	Water Seal
12	22-04-0121	Ammeter Assembly	28	34-80-2500	Retaining Ring
13	22-64-0170	Cord Set (3 wire - 3 Prong Plug)	29	02-04-1560	Ball Bearing
14	28-44-9121	Switch Handle	30	45-36-0180	Gear Spacer
15	23-66-0190	Switch	31	32-75-1781	Spindle Gear
16	42-36-0180	Switch Bracket	32	02-04-0820	Ball Bearing

### MISCELLANEOUS PARTS NOT SHOWN

PART NO.	DESCRIPTION OF PART	PART NO.	DESCRIPTION OF PART
12-98-3725	Name Plate	06-81-8650	6-32x1/4Rd.Hd.Sems Comm. Cover Plate Scr. (2)
06-42-2000	Spindle Woodruff Key	06-81-8200	4-36x3/16 Rd.Hd. Name Plate Scs. Sems (2)
06-81-7100	10-24x1-3/16 Fil.Hd.Sems Gear Case Scs. (2)	06-83-2670	1/4-20x1/2 Hd'less Brush Holder Set Screws (2)
06-81-7200	10-24x1-7/16 Fil.Hd.Sems Gear Case Sc.(Top)(2)	06-81-8650	6-32x1/4 Rd.Hd.Sems Switch Bracket Scs. (2)
06-81-6700	8-32x1-7/8 Fil.Hd.Sem Field Screws (2)	06-81-5800	6-32x5/16 Fil.Hd.Sems Switch Mounting Scs. (2)
06-81-7500	12-24x5/8 Fil.Hd.Sems Switch Handle Scs. (2)	*45-30-0060	Ball Bearing Retaining Plug (2)
06-81-7500	12-24x5/8 Fil.Hd.Sems Spade Handle Scs. (2)	06-81-8625	6-32x1/4 Rd.Hd.Brass Ground Screws Sem (
06-42-1200	Intermediate Shaft Woodruff Key	49-18-0050	Water Hose
06-81-1675	12-24x3 1/2 Fil. Hd. Switch Handle Scs. (2)	*45-88-5570	Flat Washer
06-97-3600	#12 Split Ring Lock Washer (2)	*45-88-5580	Flat Washer
*06-97-1800	Lock Washer (2)	*45-88-5590	Flat Washer
*48-03-0010	Plug Adaptor	*45-88-5600	Shim Washer
*45-36-0188	Gear Spacer	*06-65-0625	3/16x1/2 Groove Pin