



# SERVICE PARTS LIST

**BUL. 54-16-1000**

## DIAMOND CORE DRILL

REVISED BUL. 6198-1 DATE Feb. '68

**Catalog No. 3780**

Starting Serial No. **198-1001**

WIRING INSTR.

Both Model and Serial No. must be furnished to obtain correct parts.

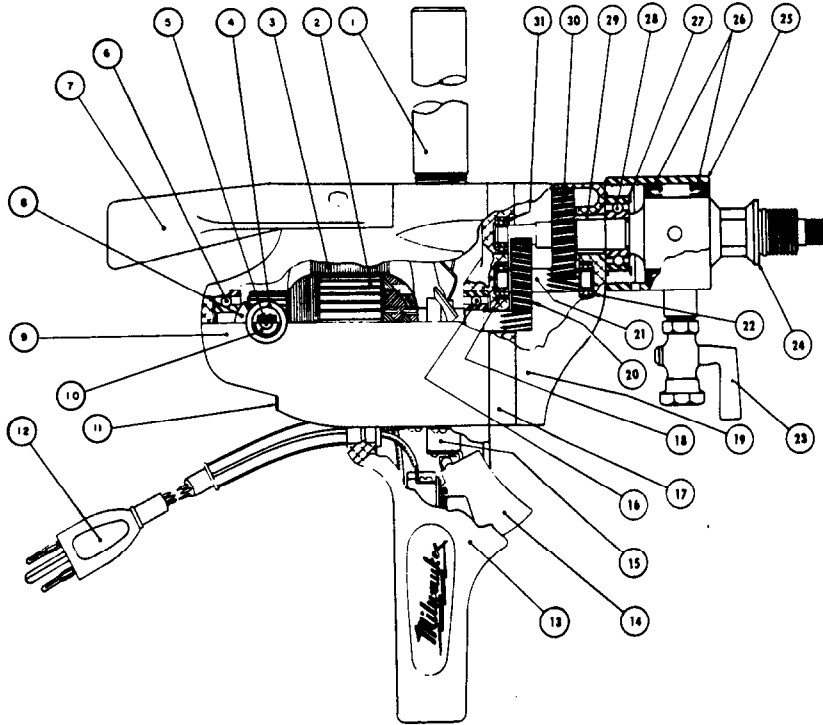

**CORRECTS AND SUPERCEDES SERVICE BULLETIN 6198-1 DATED 5/15/59**

FIG.	PART NO.	DESCRIPTION OF PART
1	43-62-0230	Pipe Handle
2	16-62-1000	Armature Assembly
3	18-62-1000	Field Assembly
4	22-22-0090	Brush Holder Assembly
5	22-18-0097	Carbon Brush Assembly
6	02-04-0960	Ball Bearing
7	28-44-7041	Spade Handle
8	23-86-0125	Washer
9	28-50-4641	Body
10	23-44-0065	Brush Retaining Screw
11	44-66-0140	Air Intake Cover Plate
12	22-64-0170	Cord Set (3 wire - 3 Prong Plug)
13	28-44-9121	Switch Handle
14	23-66-0190	Switch
15	42-36-0180	Switch Bracket
16	02-04-1070	Ball Bearing

ILLUSTRATED PARTS		DESCRIPTION OF PART
17	28-28-0621	Diaphragm
18	02-04-0820	Ball Bearing
19	28-14-0921	Gear Case
(2)	20	32-40-1261 Intermediate Gear
(2)	21	36-66-2301 Intermediate Shaft
22	02-04-0820	Ball Bearing
23	45-80-0060	Valve
(2)	24	38-50-3301 Spindle
25	43-76-0080	Swivel Housing
(2)	26	45-06-0060 Water Seal
27	34-80-2500	Retaining Ring
28	02-04-1560	Ball Bearing
29	45-36-0180	Gear Spacer
30	32-75-1781	Spindle Gear
31	02-04-0820	Ball Bearing

MISCELLANEOUS PARTS NOT SHOWN		PART NO.	DESCRIPTION OF PART
23-16-0050	Switch Cover Insulator	06-81-8650	6-32x1/4 Rd.Hd.Sems Comm. Cover Plate Scr. (2)
12-98-4100	Name Plate	06-81-8200	4-36x3/16 Rd.Hd. Name Plate Scs. Sems (2)
06-42-2000	Spindle Woodruff Key	06-83-2670	1/4-20x1/2 Hd'less Brush Holder Set Screws (2)
06-81-7100	10-24x1-3/16 Fil.Hd. Sems Gear Case Scs. (2)	06-81-8650	6-32x1/4 Rd.Hd.Sems Switch Bracket Scs. (2)
06-81-7200	10-24x1-7/16 Fil.Hd. Sems Gear Case Sc. (Top) (2)	06-81-5800	6-32x5/16 Fil.Hd.Sems Switch Mounting Scs. (2)
06-81-6700	8-32x1-7/8 Fil.Hd.Sem Field Screws (2)	06-65-1200	3/16x3/4 Driv-Lok Pin D Dowel Pin
06-81-7500	12-24x5/8 Fil.Hd.Sems Switch Handle Scs. (4)	45-30-0060	Ball Bearing Retaining Plug
06-81-7500	12-24x5/8 Fil.Hd.Sems Spade Handle Scs. (2)	06-81-8625	6-32x1/4 Rd.Hd. Brass Ground Screw Sem (1)
06-42-1200	Intermediate Shaft Woodruff Key	49-18-0050	Water Hose

Numbers in brackets indicate number required.