

. - F 012 332 000 - 3320

Item	Part Number	Description	Illustration	Price	Quantity	Price Group
2	2 610 039 159	Support Column	1	-,-	1	-
5	2 610 039 160	Toothed rack	1	-,-	1	-
6	2 610 039 172	Screw	1	-,-	2	-
7	2 610 004 579	Collar	1	-,-	1	-
8	2 610 958 827	Clamp	1	-,-	1	-
9	2 610 958 828	Hex Socket Head Cap Screw	1	-,-	1	-
10	2 610 958 829	Crank	1	-,-	1	-
11	2 610 004 834	Support	1	-,-	1	-
12	2 610 039 173	Pin	1	-,-	1	-
13	2 610 039 174	Gear Shaft	1	-,-	1	-
14	2 610 039 175	Helical Gear	1	-,-	1	-
15	2 610 039 176	Table	1	-,-	1	-
16	2 610 039 177	Screw	1	-,-	1	-
17	2 610 958 973	Knob	1	-,-	3	-
18	2 610 958 830	Rod	1	-,-	3	-
22	2 610 958 831	Adjustment Knob	1	-,-	3	-
23	2 610 958 832	laser rod	1	-,-	2	-
36	2 610 039 178	Motor	1	-,-	1	-
37	2 610 039 179	Pulley	1	-,-	1	-
38	2 610 958 833	V-Belt	1	-,-	1	-
39	2 610 004 831	Protection	1	-,-	1	-
48	2 610 039 180	Contact Spring	1	-,-	1	-
49	2 610 039 181	Battery Box	1	-,-	1	-
52	2 610 039 182	Battery Cover	1	-,-	1	-
53	2 610 958 834	Switch	1	-,-	1	-
57	2 610 039 183	Nut	1	-,-	2	-
58	2 610 039 184	Pulley	1	-,-	1	-
64	2 610 958 835	Switch	1	-,-	1	-
66	2 610 004 832	Cover	1	-,-	1	-
68	2 610 004 833	Switch Cover	1	-,-	1	-
74	2 610 958 836	Key Holder	1	-,-	1	-
80	2 610 039 185	Pressure Spindle	1	-,-	1	-
81	2 610 958 837	Chuck	1	-,-	1	-

Item	Part Number	Description	Illustration	Price	Quantity	Price Group
82	2 610 958 838	Chuck Wrench	1	-,-	1	16
83	1 907 950 005	Offset Screwdriver DIN 911, SW4	1	-,-	1	14
84	1 907 950 004	Offset Screwdriver DIN 911, SW3	1	-,-	1	16
85	2 610 958 839	Cord	1	-,-	1	-
822	2 610 009 641	Spring set	1	-,-	1	-

Illustration - Type E

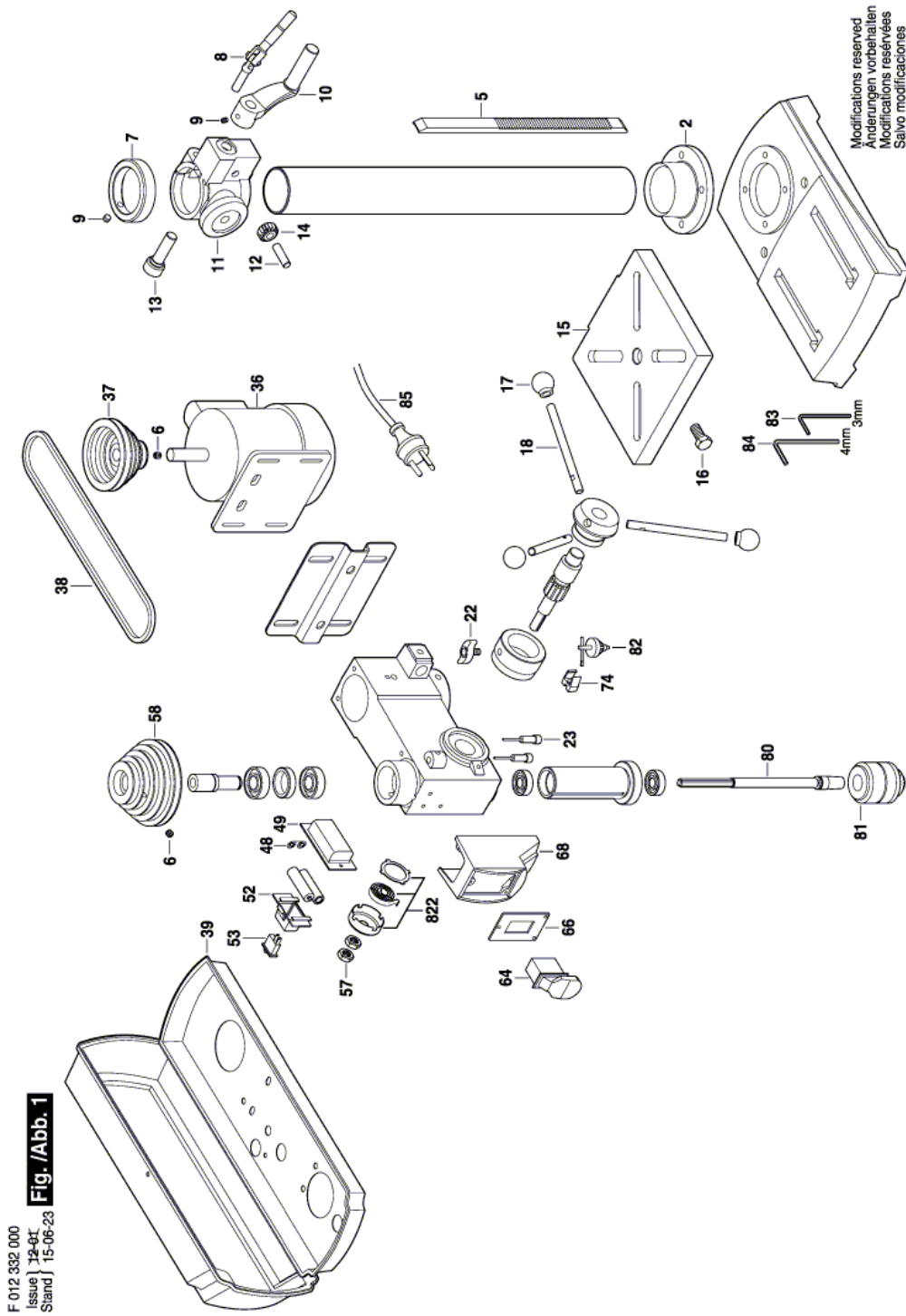

Information subject to change without further notice.