

JLH Series Lever Hoists (JLH-80/100/160/250/320/630/900)

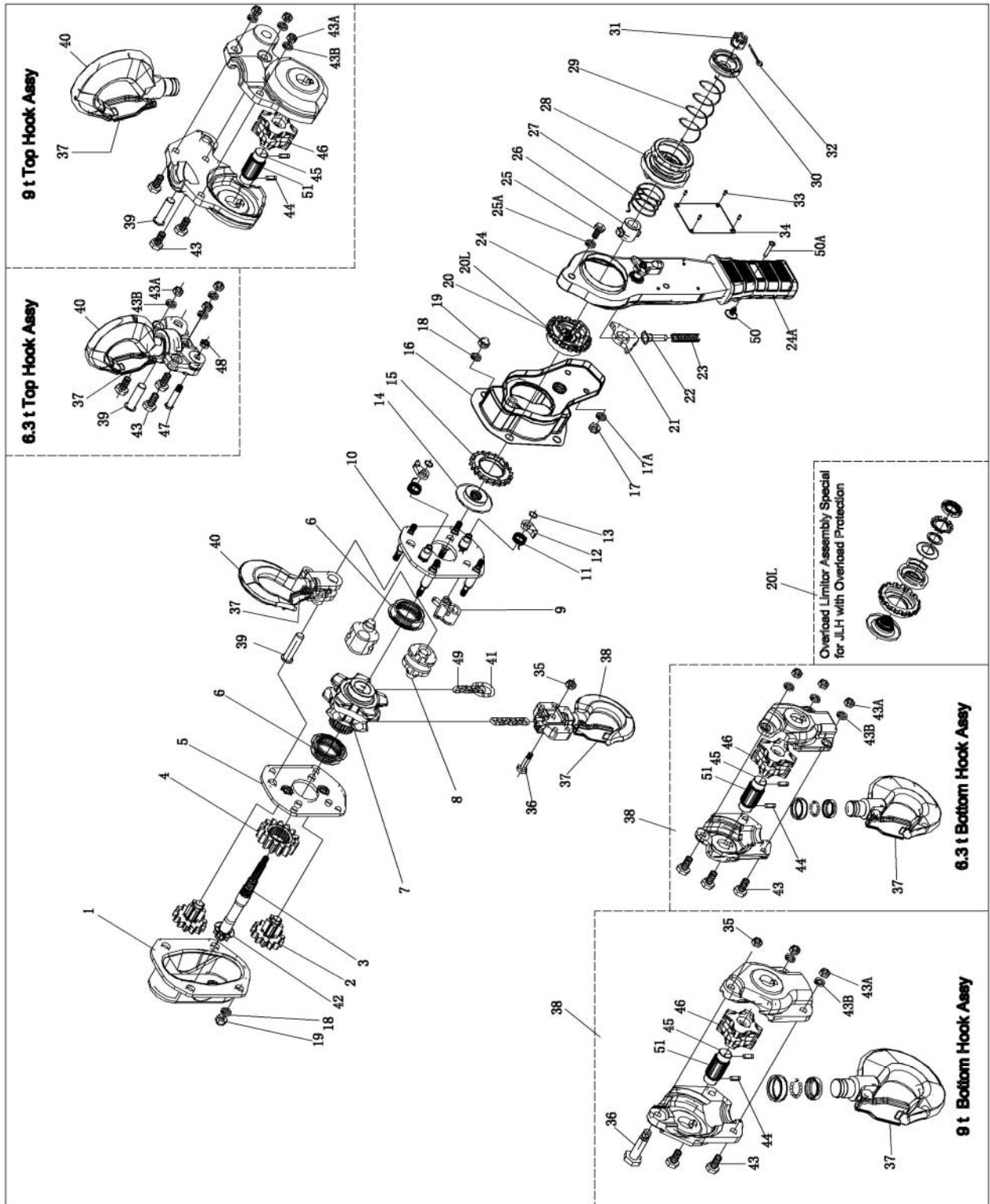

Parts List: JLH-100 (1 Ton)

Parts listed under each assembly are parts that make up that assembly.

Index No.	Part No.	Description	Size	Qty
1	JLH80-1	Gear Case Assembly (0.8, 1 Ton)		1
		Gear Case		1
		Bushing		3
		Cover Plate		1
2	JLH80-2	Spur Gear Assembly (0.8, 1 Ton)		2
		Spur Gear		2
		Pinion Gear		2
3	JLH80-3	Driving Shaft (0.8, 1 Ton)		1
	JLH80-3-1	Driving Shaft (0.8, 1 Ton) <i>(models from 02-01-2009 and forward)</i>		1
4	JLH80-4	Load Gear (0.8, 1 Ton)		1
5	JLH80-5	Gear Side Plate Assembly (0.8, 1 Ton)		1
		Gear Side Plate		1
		Bushing		2
6	JLH80-6	Caged Roller Bearings (0.8, 1 Ton)	Ø35xØ25x10mm	2
7	JLH80-7	Load Sheave (0.8, 1 Ton)		1
8	JLH80-8	Guide Roller (0.8, 1 Ton)		2
9	JLH80-9	Stripper (0.8, 1 Ton)		1
10	JLH80-10	Lever Side Plate Assembly (0.8, 1 Ton)		1
		Lever Side Plate		1
		Stay Bolt		4
		Pawl Pin		2
11	JLH80-11	Pawl Spring (0.8, 1 Ton)		2
12	JLH160-12	Pawl (0.8, 1, 1.6 Ton)		2
13	JLH160-13	Snap Ring (0.8, 1, 1.6, 2.5 Ton)	Ø 9mm	2
14	JLH160-14	Disc Hub (0.8, 1, 1.6, 2.5 Ton)		1
15	JLH160-15	Ratchet Disc (0.8, 1, 1.6, 2.5 Ton)		1
16	JLH80-16	Brake Cover Assembly (0.8, 1 Ton)		1
		Brake Cover		1
		Handle Case		1
		Bushing		1
		Thread Housing		1
17	JLH160-17	Hex Nut (0.8, 1, 1.6, 2.5 Ton)	M6	2
17A	JLH160-17A	Lock Washer (0.8, 1, 1.6, 2.5 Ton)	6mm	2
18	JLH80-18	Lock Washer (0.8 to 9 Ton)	8mm	8
19	JLH80-19	Acorn Nut (0.8 to 9 Ton)	M8	8
20	JLH160-20	Change Over Gear (0.8, 1, 1.6, 2.5 Ton)		1
	JLH160-20-1	Change Over Gear (0.8, 1, 1.6, 2.5 Ton) <i>(models from 02-01-2009 and forward)</i>		1
20L	JLH100-20L	Overload Limiter Assembly (For JLH-100WO-10 only)		1
	JLH100-20L-1	Overload Limiter Assembly (For JLH-100WO-10 only) <i>(models from 02-01-2009 and forward)</i>		1
		Overload Limiting Plate		1
		Change Over Gear		1
		Pressure Plate		1
		Dish Spring		1
		Adjusting Nut	M22x1.25-7H	1
21	JLH160-21	Change Over Pawl (0.8, 1, 1.6, 2.5 Ton)		1
22	JLH160-22	Spring Shaft (0.8, 1, 1.6, 2.5 Ton)		1
23	JLH160-23	Spring (0.8, 1, 1.6, 2.5 Ton)		1
24	JLH80-24	Lever Handle Assembly (0.8, 1 Ton)		1
		Lever Handle		1
		Selector Lever		1
		Change Over Shaft		1
		Bolt		2
		Spring Seat		1
		Bushing		1

24A	JLH80-24A	Rubber Grip (0.8, 1 Ton)	1
25	JLH160-25	Hex Cap Screw (0.8, 1, 1.6 Ton) M6 x 12	1
25A	JLH160-25A	Lock Washer (0.8, 1, 1.6 Ton) 6mm	1
26	JLH160-26	Cam (0.8, 1, 1.6, 2.5 Ton)	1
	JLH160-26-1	Cam (0.8, 1, 1.6, 2.5 Ton) (models from 05-01-2008 to 01-31-2009)	1
	JLH160-26-2	Cam (0.8, 1, 1.6, 2.5 Ton) (models from 02-01-2009 and forward)	1
27	JLH160-27	Twisting Spring I (0.8, 1, 1.6, 2.5 Ton)	1
28	JLH160-28	Hand Wheel (0.8, 1, 1.6, 2.5 Ton)	1
	JLH160-28-1	Hand Wheel (0.8, 1, 1.6, 2.5 Ton) (models from 02-01-2009 and forward)	1
29	JLH160-29	Twisting Spring II (0.8, 1, 1.6, 2.5 Ton)	1
30	JLH160-30	Twisting Spring Housing (0.8, 1, 1.6, 2.5 Ton)	1
31	JLH160-31	Castle Nut (0.8, 1, 1.6, 2.5 Ton) M8	1
32	JLH80-32	Split Pin (0.8 to 9 Ton) 2 x 18mm	1
33	JLH80-33	Rivet (0.8 to 9 Ton) 3 x 6mm	4
34	JLH100-34	Name Plate	1
35	JLH160-35	Lock Nut (0.8, 1, 1.6, 2.5 Ton) M6	1
36	JLH80-36	Bottom Hook Shaft (0.8, 1 Ton)	1
37	JLH100-37	Safety Latch Kit (1 Ton)	2
		Safety Latch	2
		Double Spring	2
		Socket Cap Screw M4 x 23	2
		Lock Nut M4	2
38	JLH100-38	Bottom Hook Holder Assembly (incls. 35 & 36)	1
	JLH100-38-1	Bottom Hook Holder Assembly (incls. 35 & 36) with Thrust Bearing (models from 09-15-2009 and forward)	1
		Bottom Hook	1
		Safety Latch	1
		Double Spring	1
		Socket Cap Screw M4 x 23	1
		Lock Nut M4	1
		Bottom Hook Holder	1
		Rivet 6 x 24mm	4
39	JLH80-39	Top Hook Shaft (0.8, 1 Ton)	1
40	JLH100-40	Top Hook Holder Assembly	1
		Top Hook	1
		Safety Latch	1
		Double Spring	1
		Socket Cap Screw M4 x 23	1
		Lock Nut M4	1
		Top Hook Holder	1
		Rivet 6 x 24mm	2
41	JLH80-41	Chain Stop (0.8, 1 Ton)	1
42	JLH80-42	Drive Shaft Washer (0.8, 1 Ton)	1
49	JLH80-49	Load Chain (0.8, 1 Ton) – specify length Ø5.6 x 15.7mm	1
50	JLH160-50	Rubber Grip Fastening (0.8, 1, 1.6, 2.5 Ton)	1
50A	JLH160-50A	Fastening Screw (0.8, 1, 1.6, 2.5 Ton)	1

Note: Top and bottom hooks are sold as an assembly only.
When ordering replacement chain (#49), specify length.