



SERVICE PARTS LIST

BULLETIN NO.
55-06-2736

SPECIFY CATALOG NO. AND SERIAL NO. WHEN ORDERING PARTS		REVISED BULLETIN 55-06-2735	DATE Oct. 2017
CORDLESS 18 VOLT LED WORKLIGHT			
CATALOG NO. 2735-059	STARTING SERIAL NO.	D46B	
WIRING INSTRUCTION			

EXAMPLE:
Component Parts (Small #) Are Included
When Ordering The Assembly (Large #).

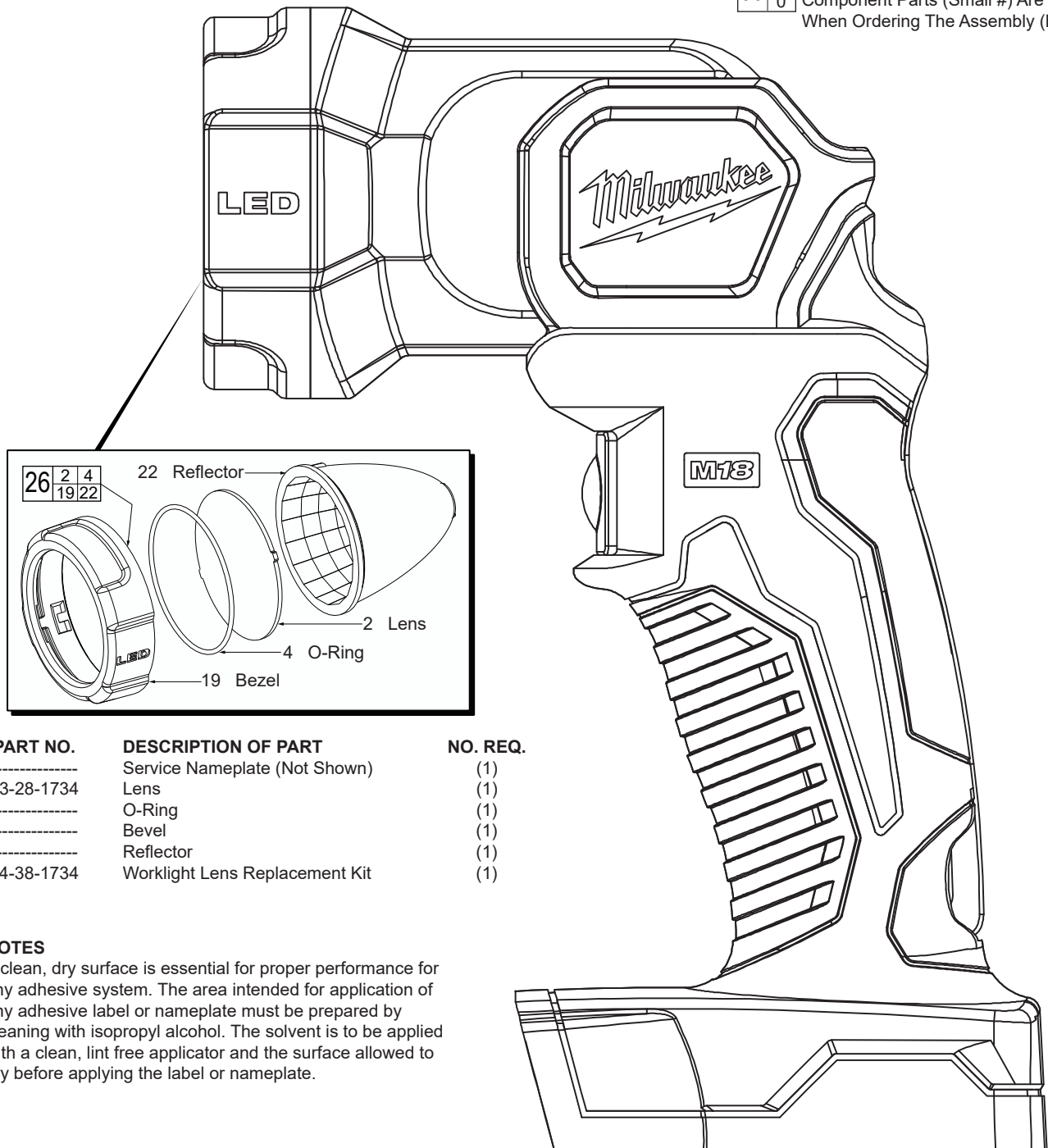

FIG.	PART NO.	DESCRIPTION OF PART	NO. REQ.
1	-----	Service Nameplate (Not Shown)	(1)
2	23-28-1734	Lens	(1)
4	-----	O-Ring	(1)
19	-----	Bezel	(1)
22	-----	Reflector	(1)
26	14-38-1734	Worklight Lens Replacement Kit	(1)

FIG. NOTES

- 1 A clean, dry surface is essential for proper performance for any adhesive system. The area intended for application of any adhesive label or nameplate must be prepared by cleaning with isopropyl alcohol. The solvent is to be applied with a clean, lint free applicator and the surface allowed to dry before applying the label or nameplate.