

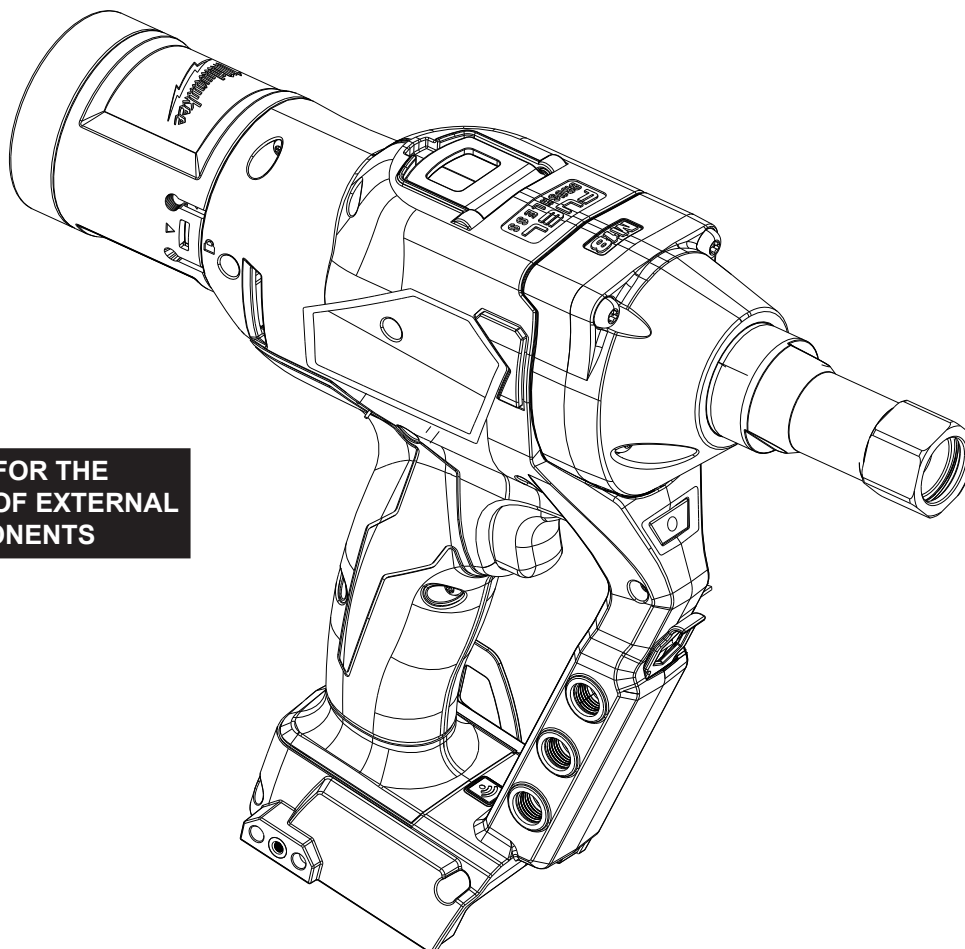

SERVICE PARTS LIST

BULLETIN NO.
54-00-2661

SPECIFY CATALOG NO. AND SERIAL NO. WHEN ORDERING PARTS				REVISED BULLETIN	DATE
M18™ FUEL™ 1/4" LOCKBOLT TOOL w/ ONE-KEY™					Jan. 2022
CATALOG NO.	2661-20	STARTING SERIAL NO.	M20A	WIRING INSTRUCTION	



SEE PAGE TWO FOR THE
REPLACEMENT OF EXTERNAL
SERVICE COMPONENTS

**Due to the complexities of One-Key™ electronics
contact the following for service related questions and issues:**

e-Service at: www.milwaukeetool.com/e-service

or

questions, please call 1.800.SAWDUST (1.800.729.3878)

or

Visit www.milwaukeetool.com or

Return it to a MILWAUKEE *factory* Service Center location, freight prepaid and insured.

A copy of the proof of purchase should be included with the return product.

If you have questions please contact Milwaukee Product Service at:

Product Technical Support via phone at: 262.783.8642

or

Via email at: METProductSupport@milwaukeetool.com

Disassembly is not recommended and could void the warranty.



SERVICE PARTS LIST

BULLETIN NO.
54-00-2661

SPECIFY CATALOG NO. AND SERIAL NO. WHEN ORDERING PARTS			REVISED BULLETIN	DATE
M18™ FUEL™ 1/4" LOCKBOLT TOOL w/ ONE-KEY™				Jan. 2022
CATALOG NO.	2661-20	STARTING SERIAL NO.	WIRING INSTRUCTION	
		M20A		

EXAMPLE:
Component Parts (Small #) Are Included
When Ordering The Assembly (Large #).

00
0

