



SERVICE PARTS LIST

BULLETIN NO.
54-07-2315

SPECIFY CATALOG NO. AND SERIAL NO. WHEN ORDERING PARTS				REVISED BULLETIN	DATE
M12™ M-SPECTOR FLEX™ INSPECTION CAMERA					Jan. 2016
CATALOG NO.	2315-20	SERIAL NUMBER	H22A	WIRING INSTRUCTION	

EXAMPLE:

00	0
----	---

 Component Parts (Small #)
 Are Included When Ordering
 The Assembly (Large #).

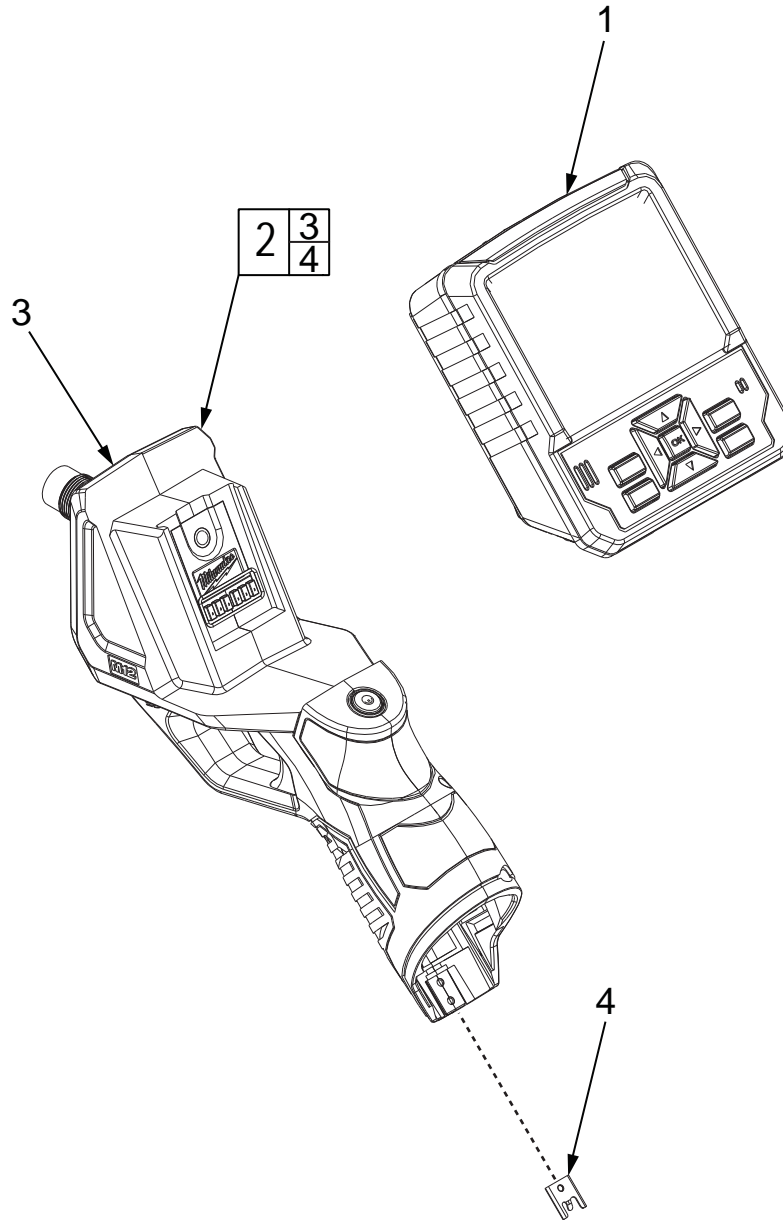

FIG.	PART NO.	DESCRIPTION OF PART	NO. REQ.
1	14-38-0025	LCD Assembly	(1)
2	14-38-0030	Console Assembly	(1)
3	-----	Console	(1)
4	42-70-0058	Housing Clip	(1)
5	12-20-2315	Service Nameplate (Not Shown)	(1)
6	48-53-0150	3' Accessory Cable (Not Shown)	(1)
7	48-53-0151	9' Accessory Cable (Not Shown)	(1)

FIG. NOTES
 5 A clean, dry surface is essential for proper performance for any adhesive system. The area intended for application of any adhesive label or nameplate must be prepared by cleaning with isopropyl alcohol. The solvent is to be applied with a clean, lint free applicator and the surface allowed to dry before applying the label or nameplate.