



SERVICE PARTS LIST

BULLETIN NO.
54-07-2155

SPECIFY CATALOG NO. AND SERIAL NO. WHEN ORDERING PARTS				REVISED BULLETIN	DATE
102 x 77 SPOT INFRARED IMAGER					June 2017
CATALOG NO.	2257-20	STARTING SERIAL NO.	J02A	WIRING INSTRUCTION	

EXAMPLE:

00	0
----	---

 Component Parts (Small #)
 Are Included When Ordering
 The Assembly (Large #).

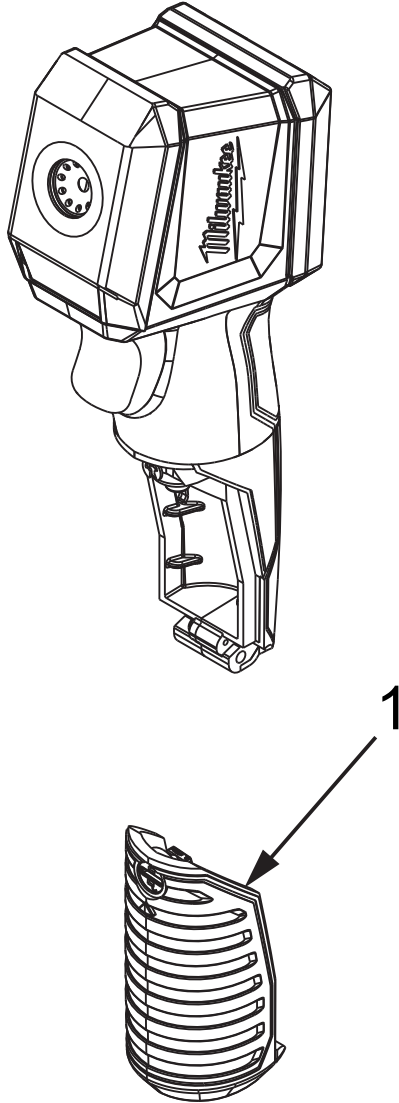

FIG.	PART NO.	DESCRIPTION OF PART	NO. REQ.
1	31-21-2257	Battery Door Assembly	(1)
2	12-25-0214	Service Nameplate (Not Shown)	(1)

FIG. NOTES

2 A clean, dry surface is essential for proper performance for any adhesive system. The area intended for application of any adhesive label or nameplate must be prepared by cleaning with isopropyl alcohol. The solvent is to be applied with a clean, lint free applicator and the surface allowed to dry before applying the label or nameplate.