



# SERVICE PARTS LIST

**BUL. 54-12-5011**

## 1" ELECTRIC DRILL

REVISED BUL. 6129-2      DATE Feb. '68

**Catalog No. 2200-1**

Starting Serial No. **129-1305**

WIRING INSTR. **58-01-0560**

Both Model and Serial No. must be furnished to obtain correct parts.

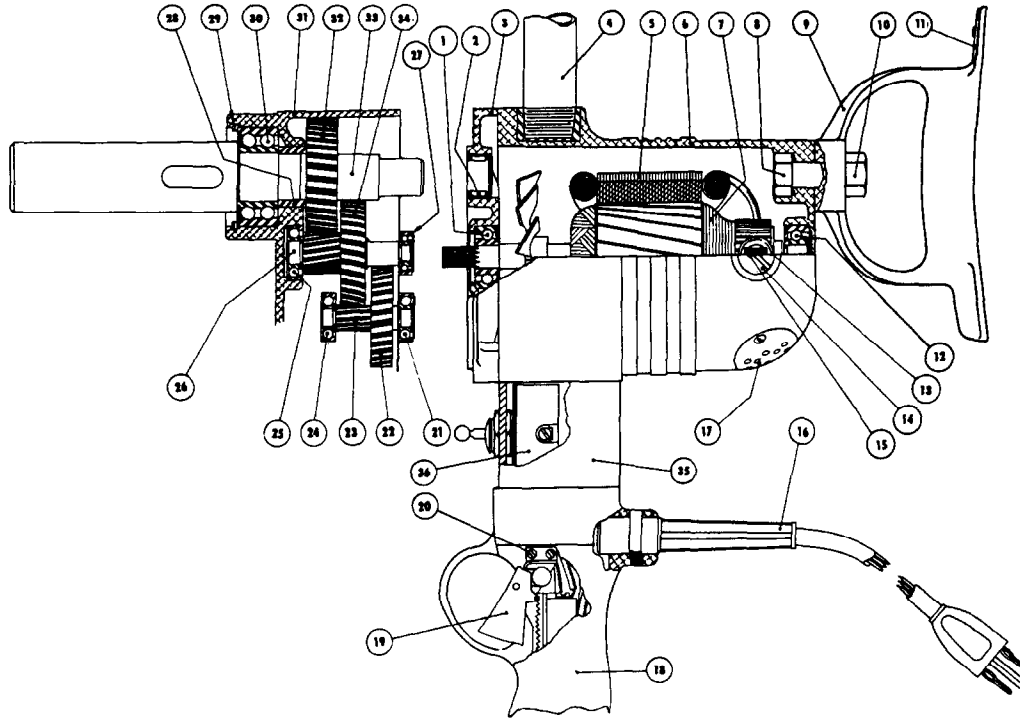

### ILLUSTRATED PARTS

FIG.	PART NO.	DESCRIPTION OF PART	FIG.	PART NO.	DESCRIPTION OF PART
1	02-04-1140	Ball Bearing (Pinion End)	19	23-66-0190	Switch
2	02-50-4820	Needle Bearing	20	42-36-0230	Switch Bracket
3	28-28-0301	Diaphragm	21	02-04-0910	Ball Bearing
4	43-62-0120	Pipe Handle	22	32-42-1201	1st Intermediate Gear
★ 5	18-82-1070	Field Assembly	23	36-66-1251	1st Intermediate Pinion Shaft
6	28-50-4161	Motor Housing	24	02-04-0910	Ball Bearing
★ 7	16-82-1231	Armature Assembly	25	02-04-1210	Ball Bearing
8	06-75-0850	1/2-13x1-1/2 Spade Handle Bolt (Hex.Hd.)	26	36-66-1301	2nd Inter. Pinion Shaft
★ 9	14-34-0100	Spade Handle Assembly	27	02-04-0820	Ball Bearing
10	06-55-2850	1/2-13 Spade Handle Jam Nut	28	45-36-0080	Spindle Spacer
11	42-70-0110	Spade Handle Key Clip	29	34-80-3800	Spindle Ball Brg. Retaining Ring
12	02-04-1070	Ball Bearing (Comm. End)	30	02-20-2520	Ball Bearing
13	22-22-0015	Brush Holder Assembly (2)	31	28-14-0441	Gear Case
14	23-44-0030	Brush Retaining Screw Assembly (2)	32	32-75-1261	Spindle Gear
15	22-18-0055	Carbon Brush Assemblies	33	38-50-1551	No. 3 Morse Taper Spindle
16	22-64-0080	Cord (3-wire)	34	32-44-1141	2nd Intermediate Gear
17	44-66-0180	Air Intake Cover Plate	35	28-50-7121	Reverse Switch Housing
18	28-44-9241	Switch Handle	36	23-66-0340	Reverse Switch

### MISCELLANEOUS PARTS NOT SHOWN

PART NO.	DESCRIPTION OF PART	PART NO.	DESCRIPTION OF PART
12-98-0900	Name Plate	06-81-2150	1/4-20x3-3/4 Fil.Hd. Switch Handle Screws (4)
48-86-0070	Drift Pin	48-03-0010	Attachment Plug Adaptor
06-81-8650	6-32x1/4 Rd.Hd.SpadeHandle Key Clip Scs. (2)	★06-81-8650	6-32x1/4 Rd.Hd.Sem Air Intake Plate Scrs. (2)
06-81-8650	6-32x1/4 Rd.Hd.Switch Mounting Screws Sems(2)	06-81-8625	6-32x1/4 Rd. Hd. Brass Ground Wire Screws
06-81-3450	6-32x5/16 Oval Hd. Switch Bracket Scs. (2)	★06-97-3400	Kantlink Lock Washers (2)
★06-81-8400	4-40x1/4 Rd.Hd.Sem Name Plate Scrs. (2)	06-97-3800	Kantlink Lock Washers (2)
★06-83-2650	1/4-20x3/8 Hd'less Brush Holder Set Scrs. (2)	06-42-2000	Woodruff Key
06-81-7900	1/4-20x1-1/2 Fil.Hd. Gear Case Screws (2)	06-42-1200	Woodruff Key
06-81-1975	1/4-20x2-1/4 Fil.Hd. Gear Case Screws (2)	06-42-2400	Woodruff Key
★06-81-1150	10-24x3-1/8 Fil.Hd. Field Screws (2)	45-30-0070	Ball Bearing Retaining Slug
★06-97-1800	Switch Lock Washers (10)	★45-04-0100	Cord Retaining Screw (2)
★23-16-0200	Insulator		