



SERVICE PARTS LIST

BUL. 54-12-4012

7/8" ELECTRIC DRILL

REVISED BUL 668-3 DATE FEB. '68

MODEL NO. **K-783**

Starting Serial No. **68-1232**

WIRING INSTR.

Both Model and Serial No. must be furnished to obtain correct parts.

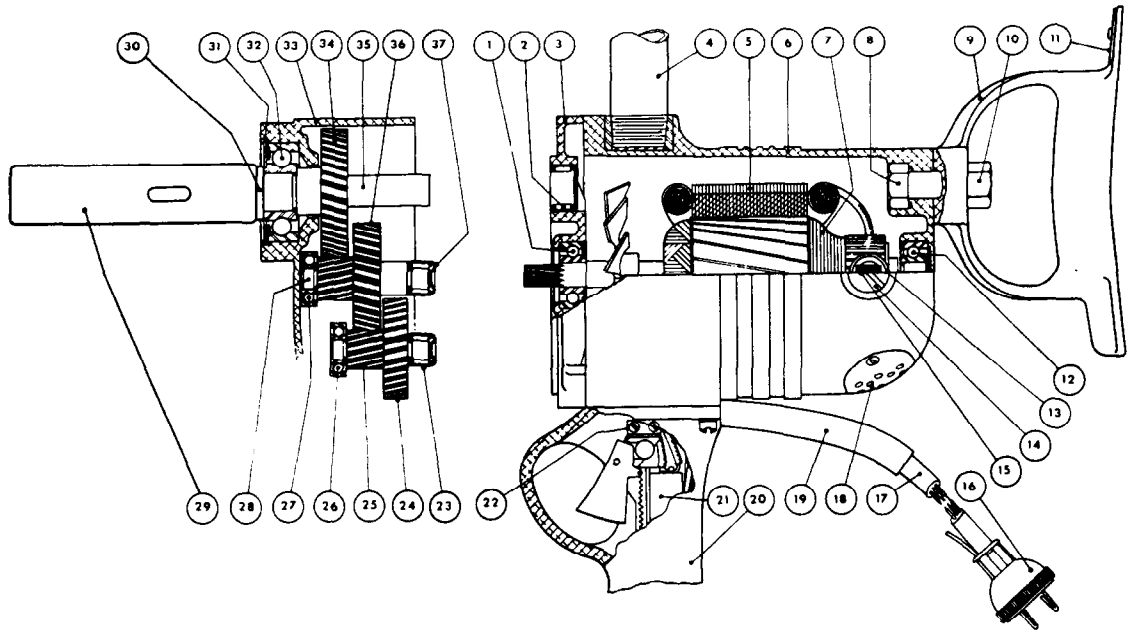

ILLUSTRATED PARTS

FIG.	PART NO.	NAME OF PART	FIG.	PART NO.	NAME OF PART
1	WC8011	Armature Ball Brg. (Pinion End).....	20	88D1-1A	Switch Handle
2	MH-1081	Spindle Needle Bearing	21	CH8636K1	Switch
3	3D-2	Diaphragm	22	88D-23	Switch Bracket.....
4	88D-43	Pipe Handle	23	MH681	1st Inter. Shaft Needle Bearing.....
5	56V-700	Field Assembly	24	89D-14	1st Inter. Gear
6	23D-1	Motor Housing	25	3D-131	1st Inter. Pinion Shaft
7	3D-600A	Armature Assembly	26	ND7039	1st Inter. Shaft Ball Bearing
8	1/2"-13x1-1/2"	Spade Handle Bolt (Hex Hd.)	27	ND7039	2nd Inter. Shaft Ball Bearing.....
9	88D1-3A	Spade Handle	28	3D-132	2nd Inter. Pinion Shaft
10	1/2"-13	Spade Handle Jam Nut	29	#2	Morse Taper Socket.....
11	88D1-6	Spade Handle Key Clip	30	88D-16	Chuck Washer.....
12	WC8500	Armature Ball Brg. (Comm. End).....	31	RR-185	Spindle Ball Brg. Retg. Ring
13	88D-320	Brush Holder Assembly	32	ND8603	Spindle Ball Bearing
14	88D-400	Brush Retaining Screw Assembly	33	3D-3	Gear Case
15	88D-370	Carbon Brush Assemblies (2)	34	78K-11A	Spindle Gear
16	3P-1	Attachment Plug (3-Prong)	35	3D-8A	Spindle
17	S#16-3	Cord (3-wire) per foot	36	78K-11	2nd Intermediate Gear
18	23D-41	Air Intake Cover Plate	37	MH681	2nd Intermediate Shaft Needle Brg....
19	88D-48	Cord Protector Tube			

MISCELLANEOUS PARTS NOT SHOWN

SIZE OR PART NO.	DESCRIPTION OF PART	SIZE OR PART NO.	DESCRIPTION OF PART
K-783	Name Plate	1/4"-20x1/2" Hdless.	Brush Holder Set Screws (2)
#2	Drift (1)	6-32x1/4" Rd. Hd.	Brass Ground Wire Screws (1)
#4x5/16" Driv-In	Spade Handle Key Clip Screw(2).....	#8	Kantlink Lock Washers (2).....
6-32x1/4" Rd. Hd.	Switch Mounting Screws (2).....	#14	Kantlink Lock Washers (10).....
6-32x1/4" Fil. Hd.	Switch Bracket Screws (2).....	#2	Woodruff Key (1)
#4x5/16" Driv-In	Name Plate Screws (2).....	#3	Woodruff Key (1)
#6x1/4" P.K.	Air Intake Plate Screws (2)	1/2" Cap.	Chuck (5/8-16 Thread)
1/4"-20x1/4" Fil.Hd.	Gear Case Screws (2)	5/8" Cap.	Chuck (5/8-16 Thread)
1/4"-20x1-3/4" Fil.Hd.	Gear Case Screws (2).....	3/4" Cap.	Chuck (5/8-16 Thread)
8-32x2-1/2" Rd. Hd.	Field Screws	1/2" & 5/8"	Chuck Key
1/4-20x3/4" Fil. Hd.	Switch Handle Screws (4).....	3/4"	Chuck Key
3PA-1	Attachment Plug Adaptor (1).....	#61	Woodruff Key (1)

Numbers in brackets indicate number required.

Parts are individually priced.

Prices are subject to change without notice.