

JLH Series Lever Hoists (JLH-25/50)

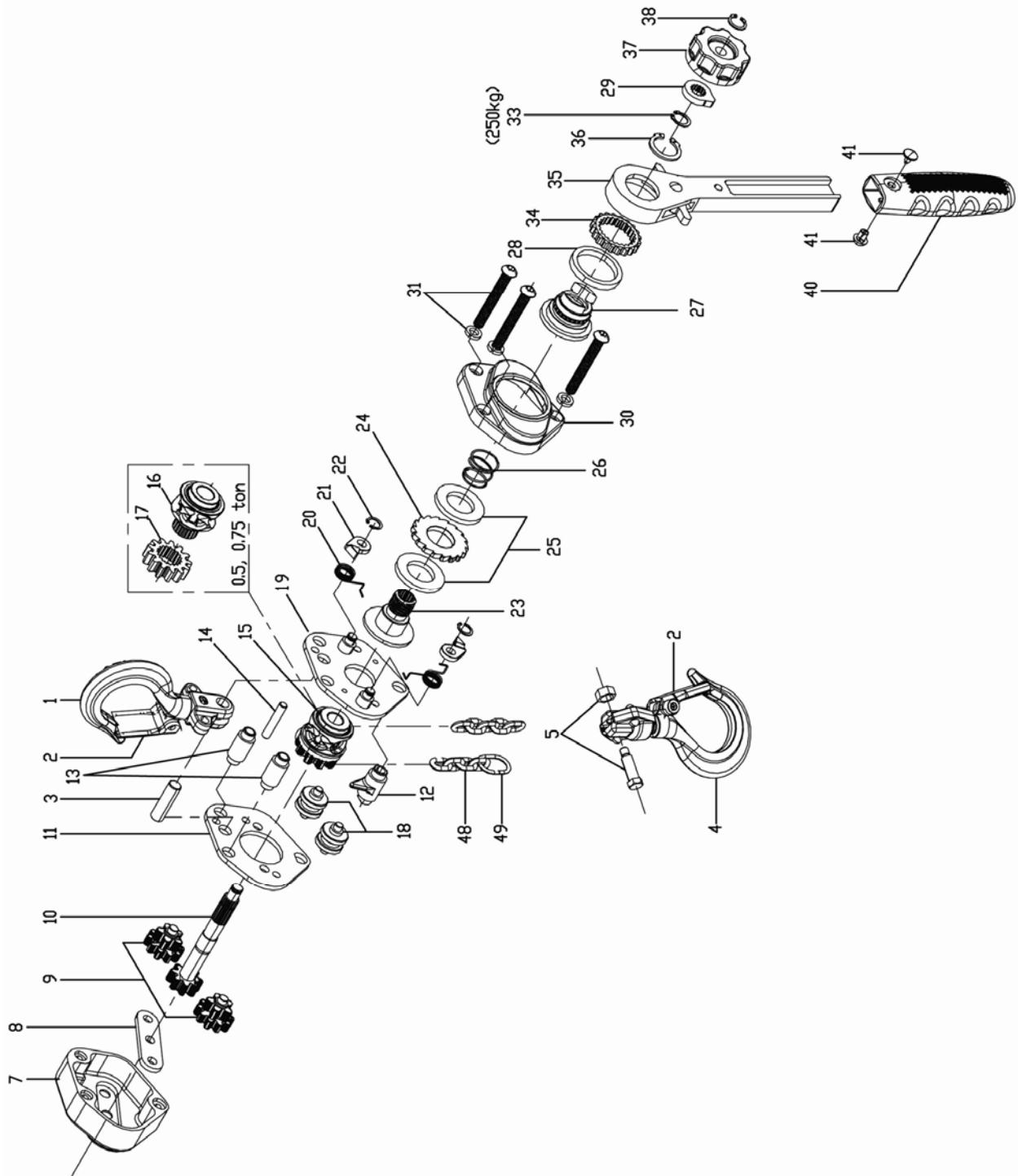

| Index No. | Part No. | Description | Size | Qty |
|-----------|----------|-------------------------------------|----------|-----|
| 36 | JLH25-36 | Snap Ring | 22mm | 1 |
| 37 | JLH25-37 | Handwheel | | 1 |
| 38 | JLH25-38 | Snap Ring | 7mm | 1 |
| 40 | JLH25-40 | Rubber Grip | | 1 |
| 41 | JLH25-41 | Bolt and Locking Nut (0.25,0.5 ton) | M3.5 | 1 |
| 48 | JLH25-48 | Load Chain – <i>specify length</i> | 3.2x9 mm | 1 |
| 49 | JLH25-49 | End Chain Ring | | 1 |

Note: All parts mentioned as assembly are sold as an assembly only.
When ordering replacement chain (#48), specify length.

Parts List: JLH-50 (0.5 Ton)

Parts listed under each assembly are parts that make up that assembly.

| Index No. | Part No. | Description | Size | Qty |
|-----------|----------|----------------------------|------|-----|
| 1 | JLH50-1 | Top Hook Assembly | | 1 |
| | | Top Hook | | 1 |
| | | Safety Latch Kit | | 1 |
| | | Top Hook Holder | | 1 |
| 2 | JLH50-2 | Safety Latch Kit | | 1 |
| | | Safety Latch | | 2 |
| | | Double Spring | | 2 |
| | | Socket Cap Screw | | 2 |
| | | Lock Nut | | 2 |
| 3 | JLH50-3 | Top Hook Shaft | | 1 |
| 4 | JLH50-4 | Bottom Hook Assembly | | 1 |
| | | Bottom Hook | | 1 |
| | | Bottom Hook Holder | | 1 |
| | | Safety Latch Kit | | 1 |
| 5 | JLH50-5 | Chain Pin & Lock Nut | | 1 |
| 7 | JLH50-7 | Gear Cover Set | | 1 |
| 8 | JLH50-8 | Reinforced Plate | | 1 |
| 9 | JLH50-9 | Load Gear | | 2 |
| 10 | JLH50-10 | Pinion Shaft | | 1 |
| 11 | JLH50-11 | Gear Side Plate | | 1 |
| 12 | JLH50-12 | Chain Stripper | | 1 |
| 13 | JLH50-13 | Stay Bolt | | 2 |
| 14 | JLH50-14 | Pin | | 1 |
| 16 | JLH50-16 | Load Sprocket | | 1 |
| 17 | JLH50-17 | Load Gear | | 1 |
| 18 | JLH50-18 | Chain Guide | | 2 |
| 19 | JLH50-19 | Lever Side Plate Assembly | | 1 |
| | | Lever Side Plate | | 1 |
| | | Pawl Pin | | 2 |
| 20 | JLH25-50 | Pawl Spring (0.25,0.5 ton) | | 2 |
| 21 | JLH25-21 | Pawl (0.25,0.5 ton) | | 2 |

| Index No. | Part No. | Description | Size | Qty |
|-----------|----------|------------------------------------|-------------|-----|
| 22 | JLH25-22 | Snap Ring (0.25,0.5 ton) | 6mm | 2 |
| 23 | JLH50-23 | Brake Seat | | 1 |
| 24 | JLH50-24 | Ratchet Disc | | 1 |
| 25 | JLH50-25 | Friction Disc | | 2 |
| 26 | JLH50-26 | Twisting Spring | | 1 |
| 27 | JLH50-27 | Brake Plate | | 1 |
| 28 | JLH50-28 | Bushing | | 1 |
| 29 | JLH50-29 | Stop Knob | | 1 |
| 30 | JLH50-30 | Brake Cover | | 1 |
| 31 | JLH50-31 | Socket Head Screw & Spring Washer | M6x45 & 6mm | 3 |
| 34 | JLH50-34 | Change Over Gear | | 1 |
| 35 | JLH50-35 | Lever Handle Assembly | | 1 |
| | | Lever Handle | | 1 |
| | | Selector Lever | | 1 |
| | | Change Over Pawl | | 1 |
| | | Snap Ring | 6mm | 1 |
| | | Roller | Ø5mm | 1 |
| | | Change Over Spring | | 1 |
| 36 | JLH50-36 | Snap Ring | 25mm | 1 |
| 37 | JLH50-37 | Handwheel | | 1 |
| 38 | JLH50-38 | Snap Ring | 7mm | 1 |
| 40 | JLH50-40 | Rubber Grip | | 1 |
| 41 | JLH25-41 | Bolt & Locking Nut (0.25, 0.5 ton) | M3.5 | 1 |
| 48 | JLH50-48 | Load Chain – <i>specify length</i> | 4.3x12mm | 1 |
| 49 | JLH50-49 | End Chain Ring | | 1 |

Note: All parts mentioned as assembly are sold as an assembly only.
When ordering replacement chain (#48), specify length.