



SERVICE PARTS LIST

BUL. 54-10-0543

1/2" ELECTRIC DRILL

REVISED BUL.
54-10-0542

DATE
Dec. '73

Catalog No. 1620-1

Starting
Serial No. **343-4041**

WIRING INSTRUCTIONS
58-01-0530

Specify Catalog and Serial No. when ordering parts

900 R.P.M.

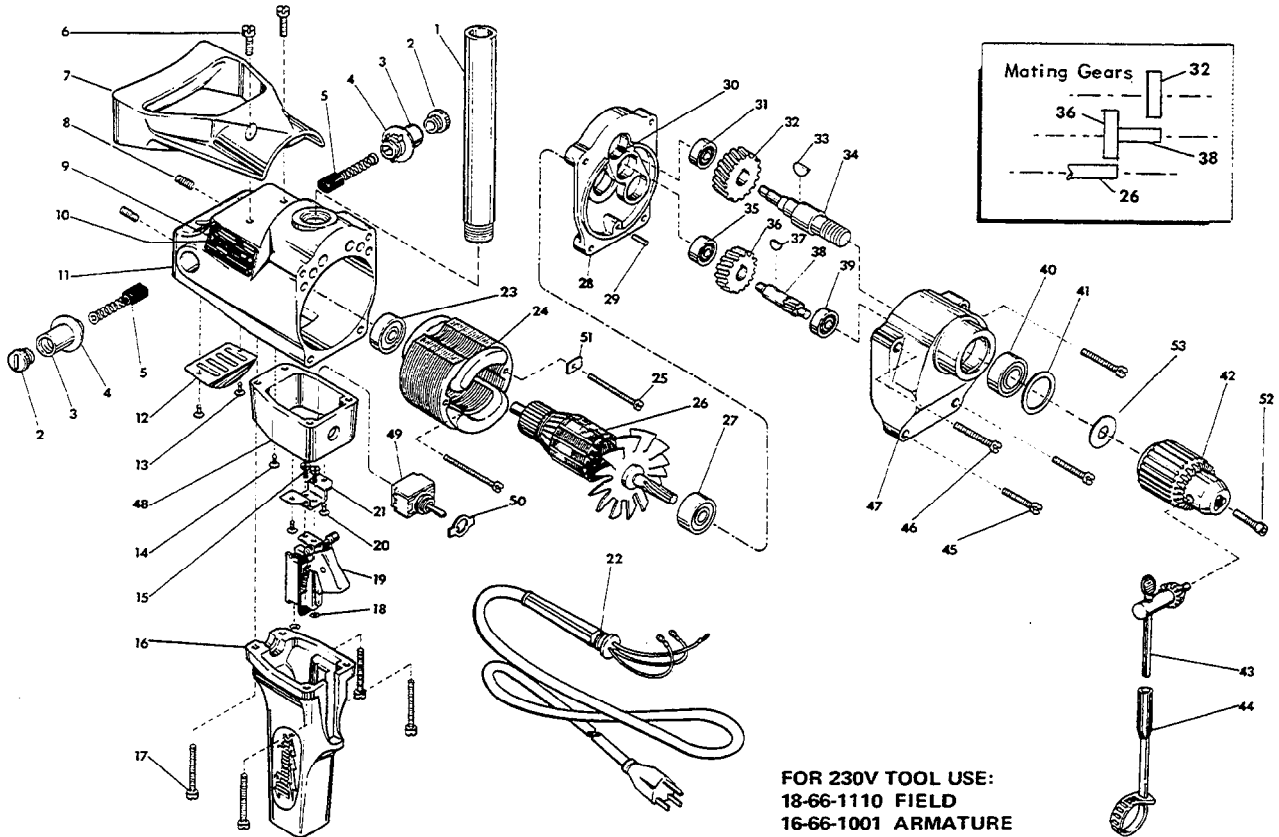

FOR 230V TOOL USE:
18-66-1110 FIELD
16-66-1001 ARMATURE

FIG.	PART NO.	DESCRIPTION OF PART	NO. REQ.	FIG.	PART NO.	DESCRIPTION OF PART	NO. REQ.
1	43-62-0230	Pipe Handle		28	28-28-0621	Diaphragm (Includes Fig. 29 & 30)	
2	23-44-0065	Brush Retaining Screw	(2)	29	06-65-0625	3/16x1/2 Groove Pin	
3	22-22-0120	Brush Holder	(2)	30	45-30-0060	Brg. Retaining Slug	(2)
4	23-86-0130	Washer	(2)	31	02-04-0820	Ball Bearing	
5	22-18-0170	Carbon Brush	(2)	32	32-75-2101	Spindle Gear	
6	06-81-7500	12-24x5/8 Fil. Hd. Sem	(2)	33	06-42-2000	Woodruff Key	
7	28-44-7041	Spade Handle		★ 34	38-50-2661	Spindle	
8	06-83-2670	1/4-20x1/2 Knrg. Set Screw	(2)	35	02-04-0820	Ball Bearing	
★ 9	06-85-0200	6x1/4 Rd. Hd. Type Z Screw	(2)	36	32-40-1261	Intermediate Gear	
★ 10	12-99-0010	Nameplate		37	06-42-1200	Woodruff Key	
11	28-50-4646	Motor Housing		38	36-66-3101	Intermediate Shaft	
12	44-66-0140	Cover Plate		39	02-04-0820	Ball Bearing	
13	06-81-8650	6-32x1/4 Rd. Hd. Sem	(2)	40	02-04-1650	Ball Bearing	
14	06-81-8625	6-32x1/4 Ground Screw		41	34-80-2500	Retaining Ring	
15	06-81-5800	6-32x5/16 Fil. Hd. Sem	(2)	42	48-66-1380	1/2" Reversing Chuck	
16	28-44-9121	Switch Handle		43	48-66-3280	Chuck Key	
17	06-81-7590	12-24x1-3/4 Fil. Hd. Sem	(4)	44	48-66-4040	Key Holder	
18	06-97-1800	Lock Washer	(4)	45	06-81-7450	10-32x1-3/16 Fil. Hd. Sem	(2)
19	23-66-0190	Switch		46	06-81-7460	10-32x1-7/16 Fil. Hd. Sem	(2)
20	06-81-8650	6-32x1/4 Rd. Hd. Sem	(2)	47	28-14-0721	Gear Case	
21	42-36-0180	Switch Bracket		48	28-50-7081	Reversing Switch Housing	
22	22-64-0170	Cord Set		49	23-66-0198	Switch	
23	02-04-0970	Ball Bearing		50	22-75-0055	Switch Dial	
24	18-62-1110	115 Volt Field		51	42-68-0090	Clamp	
25	06-81-6700	8-32x1-7/8 Fil. Hd. Sem	(2)	52	06-75-3150	1/4-20x1 Skt. Cap Screw	
26	16-62-1140	115 Volt Armature		★ 53	45-88-0365	Chuck Spacer Washer	
27	02-04-1070	Ball Bearing		★ 54	12-98-7081	Caution Plate (Not Shown)	

MILWAUKEE ELECTRIC TOOL CORP.

13135 West Lisbon Road • Brookfield, Wisconsin 53005