

## Jig Saw - 0 601 587 684 - 1587 AVS

www.powertools-aftersaleservice.com



**BOSCH**

Item	Part Number	Description	Illustration	Price	Quantity	Price Group
4	1 619 P00 429	Bolt		1	-,-	2 10
5	2 600 108 077	Felt Washer		1	-,-	1 11
6	2 600 500 002	Cupped Washer		1	-,-	1 11
7	1 610 905 005	groove ball bearing 9x24x7		1	-,-	1 26
8	1 619 P00 428	Spring retaining ring		1	-,-	1 10
9	2 600 400 008	Receptacle		1	-,-	1 11
12	2 600 101 616	Shim 0,5 MM		1	-,-	1 14
13	2 600 913 036	Needle-Roller Cage		1	-,-	2 11
14	2 603 201 037	Needle Roller 1,5x5,8 MM		1	-,-	20 11
15	1 619 P02 581	Eccentric Cog Wheel		1	-,-	1 29
16	2 600 102 653	Shim 1,0 MM		1	-,-	1 11
17	2 600 100 515	Shim 0,3 MM		1	-,-	1 11
17	2 600 100 516	Shim 0,5 MM		1	-,-	1 12
18	2 601 923 004	Fork Lever		1	-,-	1 14
19	2 916 080 907	Locking Washer 4 DIN 6799		1	-,-	1 10
20	2 600 102 652	Shim 0,5 MM		1	-,-	2 11
21	2 600 100 625	Shim 0,1 MM		1	-,-	1 13
21	2 600 100 626	Shim 0,2 MM		1	-,-	1 11
21	2 600 100 627	Shim 0,3 MM		1	-,-	2 11
21	2 600 100 628	Shim 0,5 MM		1	-,-	2 11
22	2 601 098 003	Counterweight		1	-,-	1 21
23	2 600 309 009	Spacer Sleeve		1	-,-	1 11
25	2 600 100 575	Shim 0,2 MM		1	-,-	2 12
25	2 600 100 576	Shim 0,3 MM		1	-,-	2 12
25	2 600 100 577	Shim 0,5 MM		1	-,-	2 11
26	1 619 P00 443	Locking Washer		1	-,-	1 12
29	2 600 100 568	Shim 0,5 MM		1	-,-	2 11
29	2 600 100 569	Shim 1,0 MM		1	-,-	1 11
29	2 600 100 607	Shim 0,3 MM		1	-,-	1 11
32	2 602 305 042	Air Eliminator		1	-,-	1 11
34	2 600 590 006	Ratchet Cap		1	-,-	2 11
36	1 619 P00 444	Locking Washer		1	-,-	1 10
37	2 602 026 037	Rotary Knob BLACK		1	-,-	1 14

Item	Part Number	Description	Illustration	Price	Quantity	Price Group
38	2 600 116 006	Spring retaining ring	1	-,-	1	11
39	2 601 015 050	Seal	1	-,-	1	12
41	2 603 410 048	Thread-forming tap. Screw M4x8	1	-,-	2	11
42	2 604 613 000	Compression Spring	1	-,-	2	11
43	2 601 322 010	Guide Bracket	1	-,-	1	16
44	2 600 780 177	Lifting Rod	1	-,-	1	27
46	2 602 317 053	Sliding Piece	1	-,-	1	19
47	2 603 421 040	Countersunk-Head Screw DIN 7962-M3,5x8-10.9	1	-,-	2	11
48	2 600 112 031	Supporting Disc 0,5 MM	1	-,-	1	11
49	2 600 290 017	Seal Ring 0,5 MM	1	-,-	1	11
50	2 600 101 612	Shim 0,5 MM	1	-,-	1	11
53	2 603 490 011	Clamp Screw	1	-,-	1	19
58	2 917 530 101	Straight Pin DIN 6325-4M6x24	1	-,-	1	14
60	1 619 P00 106	Screw	1	-,-	6	10
62	2 915 011 007	Hex Nut DIN 934-M6-8-A	1	-,-	2	10
63	2 608 000 073	Base Plate	1	-,-	1	30
64	2 601 030 019	Profile Beading	1	-,-	1	13
65	2 910 141 197	Hex Socket Head Cap Screw DIN 912-M6x16-8.8	1	-,-	1	10
68	1 619 P01 380	Screw 4x14	1	-,-	4	10
69	2 914 551 176	Microencapsulated Screw DIN 7985-M4x12MM	1	-,-	2	10
81	2 910 771 118	Countersunk-Head Screw DIN 963-M4x8-5.8	1	-,-	6	-
85	2 604 610 040	Compression Spring	1	-,-	1	11
102	2 610 909 245	Field 115V	1	-,-	1	32
103	2 610 909 242	Armature With Fan 115V	1	-,-	1	39
104	2 607 200 246	Switch	1	-,-	1	38
105/1	1 900 452 012	End Splice DIN 46 228-A1-6	1	-,-	2	10
106	2 600 703 028	Grommet Ø7,6-Ø8,2x95 MM	1	-,-	1	11
107	2 601 035 001	Cable Clip	1	-,-	1	11
109	2 610 994 119	Sticker	1	-,-	1	-
113	1 900 905 018	Ball Bearing 7x22x7	1	-,-	1	28
116	1 600 A00 3G4	Brush Holder	1	-,-	2	13
118	2 603 410 001	Socket head cap screw M3x6,5-4.8	1	-,-	2	11
119	2 610 315 386	Screw ST3,9x19	1	-,-	2	11
120	2 610 906 855	Warning Label	1	-,-	1	-
125	2 910 601 321	Tapping Screw DIN 7982-ST3,9x22C-H	1	-,-	1	11
127	2 602 025 060	Strap-Shaped Handle	1	-,-	1	24
128	2 603 410 054	Thread-forming tap. Screw M 5x16	1	-,-	2	12
130	1 619 P07 366	Screw and washer assembly	1	-,-	2	-
131	1 907 950 006	Offset Screwdriver DIN 911-SW5 BLACK	1	-,-	1	16
132	2 603 320 001	Square Nut M4	1	-,-	2	11
137	2 604 448 034	Connecting Cable L=88 MM WHITE	1	-,-	2	11
144	1 614 431 010	Cable L=233 MM WHITE	1	-,-	2	15
150	2 600 101 027	Shim washer 0,3 MM	1	-,-	1	11
151	2 600 150 004	Shim	1	-,-	1	12
152	2 603 435 015	Recessed-Head Screw DIN 7981-ST3,5x9,5-F	1	-,-	4	11
153	2 603 231 032	Plug BLUE	1	-,-	1	11
154	2 601 328 045	Cover Disc	1	-,-	1	12
155	1 619 P00 220	Torx Oval-Head Screw 3x10	1	-,-	4	10
156	2 604 652 009	Spiral Spring	1	-,-	2	11
157	2 600 508 038	Housing Cover BLUE	1	-,-	1	21
160	2 608 040 070	Rotary Handle	1	-,-	1	15
161	2 610 907 133	Label	1	-,-	1	13

Item	Part Number	Description	Illustration	Price	Quantity	Price Group
162	2 606 491 011	Ratchet	1	-,-	1	13
163	2 600 423 006	Carrier Bracket	1	-,-	1	11
164	1 619 P06 265	O-Ring	1	-,-	1	10
165	2 606 491 014	Coupling Half	1	-,-	1	18
166	2 604 617 004	Compression Spring	1	-,-	1	12
167	1 619 P00 446	Shim	1	-,-	2	10
168	2 600 421 001	Guide Sleeve	1	-,-	1	11
171	2 600 301 046	Sintered-Metal Bushing	1	-,-	1	15
172	2 600 301 045	Bushing	1	-,-	1	14
780	2 610 996 230	Base	1	-,-	1	15
780/2	2 910 001 116	Socket head cap screw DIN 84-M4x6-4.8	1	-,-	1	10
801	2 605 808 917	Gear Housing	1	-,-	1	41
802	1 619 P00 775	Motor Housing	1	-,-	1	29
805	3 604 460 555	Power supply cord USA/CDN 2,15m 2 x 0,82mm SJ 18/2	1	-,-	1	24
808	1 619 P00 643	Nameplate	1	-,-	1	-
810	2 604 320 910	Carbon-Brush Set	1	-,-	1	22
813	2 607 001 130	Needle-Roller Cage	1	-,-	1	18
824	2 601 072 901	Eccentric Disc	1	-,-	1	20
826	2 602 025 901	Strap-Shaped Handle	1	-,-	1	24
830	2 600 917 900	Needle bearing	1	-,-	1	21
835	2 602 026 036	Rotary Knob BLACK	1	-,-	1	16
840	1 619 P00 776	Coupling Half	1	-,-	1	42
845	2 602 329 011	Clamping Saddle	1	-,-	1	17
851	2 601 015 901	Sealing Plate	1	-,-	1	13
854	1 619 P00 777	Roller Lever	1	-,-	1	27
855	1 619 P01 375	Roller Set	N/A	-,-	1	23
861	2 605 500 900	Fan Cover	1	-,-	1	14
880	1 619 P00 782	Work Board	1	-,-	1	17
891	1 619 P01 393	Latch	N/A	-,-	1	10

Illustration - Type E

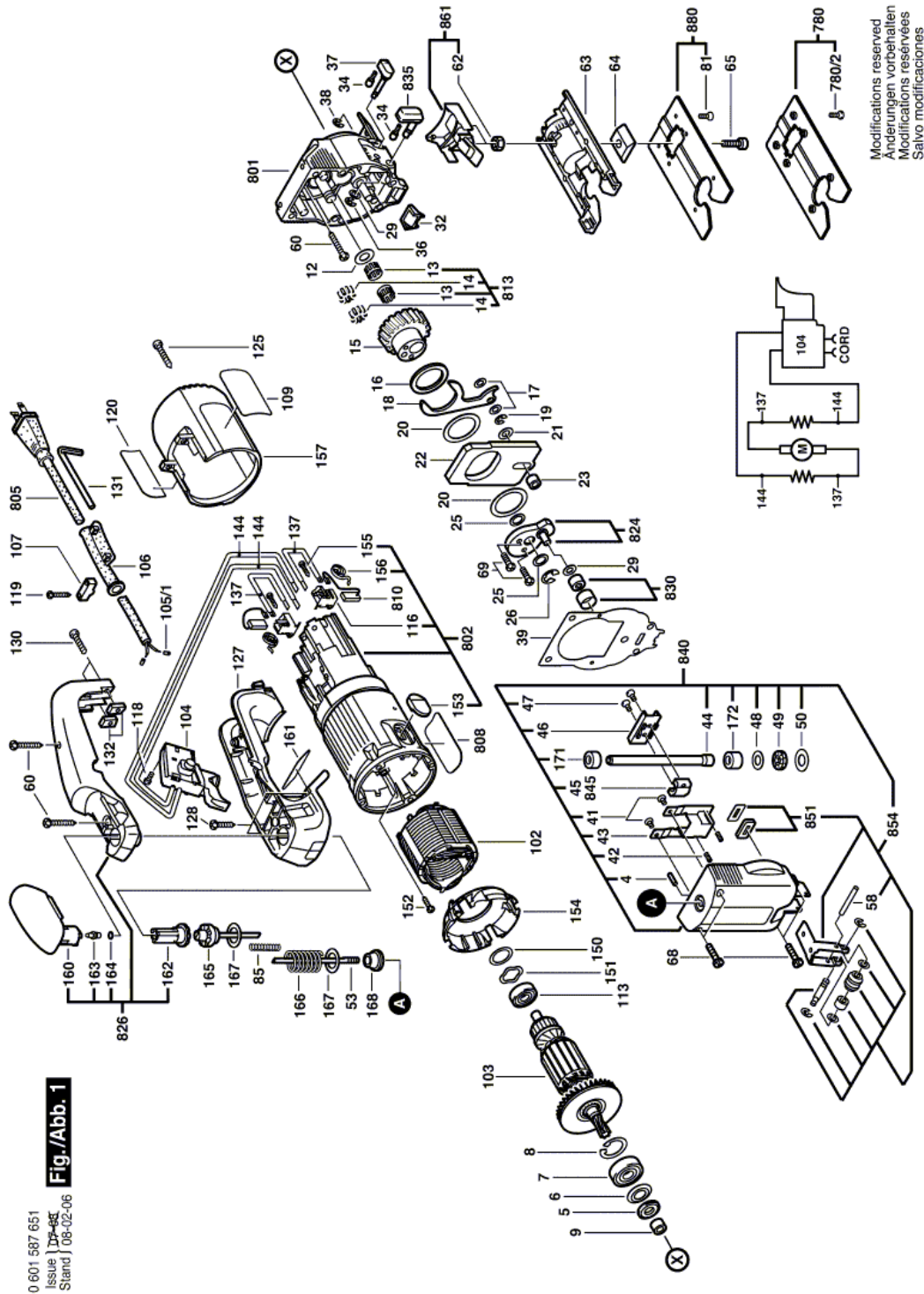

0 601 587 651  
Issue | DP-684  
Stand | 06-02-06  
**Fig./Abb. 1**

Modifications reserved  
Änderungen vorbehalten  
Modificaciones reservées  
Salvo modificaciones

Information subject to change without further notice.