

## Shears - 0 601 508 034 - 1508

www.powertools-aftersaleservice.com



**BOSCH**

Item	Part Number	Description	Illustration	Price	Quantity	Price Group
	1 3 605 108 088	Motor Housing BLUE	1	-,-	1	34
	2 1 604 220 124	Field 115-120V	1	-,-	1	43
	3 1 604 011 238	Armature 115-120V	1	-,-	1	57
3/50	1 606 610 133	Fan	1	-,-	1	-
	4 1 607 200 065	Switch	1	-,-	1	33
	5 3 604 461 001	Power supply cord USA/CDN 2,15m 2 x 082mm SJ 18/2	1	-,-	1	28
	6 3 600 703 011	Grommet Ø9,2-Ø12x120 MM	1	-,-	1	13
	7 1 601 302 014	Fastening Clamp	1	-,-	1	11
	9 3 601 110 005	Manufacturer's nameplate	1	-,-	1	-
	12 1 611 331 007	Tab Washer	1	-,-	2	11
	13 1 604 430 002	Elec. Cable W/Connection 1x1,5 MM/2	1	-,-	2	-
	14 1 901 091 110	Strip Terminal	1	-,-	1	11
	15 1 602 381 006	Insulating Plate 20x20x50 MM	1	-,-	1	11
	17 2 910 211 022	Tapping Screw DIN 7971-BZ3,9x25	1	-,-	5	10
	18 2 910 211 007	Tapping Screw DIN 7971-BZ2,9x16	1	-,-	1	11
	19 1 900 452 003	End Splice DIN 46 228-A2,5-7	1	-,-	4	11
	21 1 900 452 003	End Splice DIN 46 228-A2,5-7	1	-,-	2	11
	25 2 910 215 093	Tapping Screw DIN 7971-3,9x38	1	-,-	2	10
	26 1 610 313 003	Guide Bushing	1	-,-	1	18
	28 1 600 206 014	Rubber Ring 10 MM WIDE	1	-,-	1	11
	29 1 600 502 009	Air-Deflector Ring	1	-,-	1	13
	30 2 916 660 017	Spring retaining ring DIN 472 38X1,5MM	1	-,-	1	16
	31 1 604 652 006	Spiral Spring	1	-,-	2	11
	32 1 600 290 008	Rotary shaft lip seal WHITE	1	-,-	1	13
	35 1 601 030 022	Tab Washer	1	-,-	2	11
	36 1 600 502 006	Rubber Bushing	1	-,-	1	11
	39 3 606 312 000	Pinion Z=7	1	-,-	1	46
	40 1 600 150 007	Spring Washer Ø27,5x38,4 MM	1	-,-	1	11
	42 1 605 133 029	Handle BLACK	1	-,-	1	36
	43 1 605 820 224	Intermediate Bearing	1	-,-	1	51
	52 3 600 905 101	groove ball bearing	1	-,-	1	25
	53 1 900 900 407	groove ball bearing 10x26x8	1	-,-	1	33
	54 2 910 021 118	Socket head cap screw DIN 84-AM4x8-8.8	1	-,-	4	10

Item	Part Number	Description	Illustration	Price	Quantity	Price Group
	55 3 605 700 090	Intermediate Flange	1	-,-	1	23
	58 2 915 011 005	Hex Nut DIN 934 -M4-m-8	1	-,-	2	10
	60 1 603 435 018	Tapping Screw B4,8x27 MM	1	-,-	8	11
	61 3 600 502 001	Plug	1	-,-	4	12
	66 2 910 021 116	Socket head cap screw DIN 84-AM4x6-8.8	1	-,-	2	11
	69 2 910 211 011	Tapping Screw DIN 7971-BZ3,5x13	1	-,-	2	10
	71 1 603 435 015	Tapping Screw B4,8x115 MM	1	-,-	2	12
	72 1 613 435 009	Tapping Screw ST-4,8x57,5-TORX,T20	1	-,-	2	11
	75 1 601 110 058	Reference Plate DOUBLE INSULATION	1	-,-	1	11
	77 1 601 015 017	Sealing Plate	1	-,-	1	13
	78 1 600 910 013	Needle bearing	1	-,-	1	18
	79 1 600 100 631	Shim 0,5 MM THICK	1	-,-	1	11
	80 2 910 021 174	Socket head cap screw DIN 84-BM5x50-8.8	1	-,-	2	10
	83 2 916 690 004	Spring Lock Washer DIN 128-A5-FST	1	-,-	2	11
	84 1 603 435 008	Tapping Screw BZ4,8x63 MM	1	-,-	2	11
	85 2 600 409 014	Shrinkable Tube 25-1MM	1	-,-	1	11
	95 3 601 110 152	Sticker	1	-,-	1	15
	101 3 605 110 026	Gear Housing	1	-,-	1	60
101/20	2 917 500 122	Straight Pin 4H 8x20 DIN 7	1	-,-	1	10
	102 3 607 401 000	Lubricating Nipple	1	-,-	1	14
	103 1 900 905 203	groove ball bearing 17x40x12	1	-,-	1	-
	104 2 916 660 019	Spring retaining ring DIN 472-42x1,75MM	1	-,-	1	16
	105 3 606 110 004	Eccentric Shaft	1	-,-	1	50
	106 1 900 900 351	groove ball bearing 15x42x13	1	-,-	1	32
	107 3 602 300 002	Parallel Key	1	-,-	2	19
	109 1 600 910 013	Needle bearing	1	-,-	1	18
	110 3 606 317 000	Cylindrical Gear Z=47	1	-,-	1	46
	111 1 600 100 631	Shim 0,5 MM THICK	1	-,-	1	11
	112 3 606 320 000	Spindle With Gear Z=10/31	1	-,-	1	50
	113 2 916 650 006	Retaining clip DIN 471-15x1-FSt	1	-,-	1	11
	115 3 602 001 002	Connecting Rod	1	-,-	1	46
	116 3 600 915 000	Needle-Roller Assembly	1	-,-	1	27
	117 2 916 650 011	Spring retaining ring DIN 471 20x1,2	1	-,-	1	11
	118 3 603 070 001	Tappet	1	-,-	1	54
	119 3 603 200 004	Conrod Pin	1	-,-	1	20
	120 3 600 313 005	Bushing	1	-,-	1	44
	122 3 603 463 003	Adjusting Screw	1	-,-	1	20
	123 2 917 610 186	Straight Pin 8M6x50DIN7C35K	1	-,-	2	11
	124 2 608 635 195	Upper Blade	1	-,-	1	34
	125 2 608 635 196	Lower Blade	1	-,-	1	31
	126 3 608 042 003	Blade Holder	1	-,-	1	57
	128 2 910 141 195	Hex Socket Head Cap Screw DIN 912-M6x14-12.9	1	-,-	1	10
	129 2 910 141 197	Hex Socket Head Cap Screw DIN 912-M6x16-8.8	1	-,-	1	10
	130 2 916 070 233	Locking Washer	1	-,-	2	10
	131 2 916 010 013	Plain Washer DIN 433-6,4-ST 50	1	-,-	2	10
	132 2 910 141 479	Hex Socket Head Cap Screw DIN 912-M18x40-8.8	1	-,-	1	25
	133 2 912 041 203	Set screw M 6x25 DIN 913-45 H	1	-,-	1	11
	134 3 603 435 044	Hex Nut	1	-,-	1	10
	135 2 603 230 001	Ball BLUE	1	-,-	1	11
	651 1 602 025 022	Auxiliary Handle M14 BLACK	1	-,-	1	26
	652 2 610 364 015	Hexagon Socket Screw Key 5 MM	1	-,-	1	15
	653 2 610 364 015	Hexagon Socket Screw Key 5 MM	1	-,-	1	15

Item	Part Number	Description	Illustration	Price	Quantity	Price Group
654	1 907 950 504	Single-Head Eng. Wrench DIN 894 SW10	1	-,-	1	24
655	1 607 990 001	Sliding Tee Bar	1	-,-	1	10
656	3 607 960 010	Feeler Gauge	1	-,-	1	24
657	3 607 950 011	Grinding Gauge	1	-,-	1	18
658	1 615 437 502	Grease Gun	1	-,-	1	-
659	1 615 430 005	Grease Tube 45 ML	1	-,-	1	21
803	1 604 011 928	Armature With Fan 115-120V	1	-,-	1	-
808	1 601 11A 3H3	Nameplate	1	-,-	1	13
810	1 607 014 106	Carbon-Brush Set	1	-,-	1	27
816	3 604 336 012	Brush Holder	1	-,-	2	18
841	3 605 500 063	Sealing cap BLUE	1	-,-	1	16

Illustration - Type E

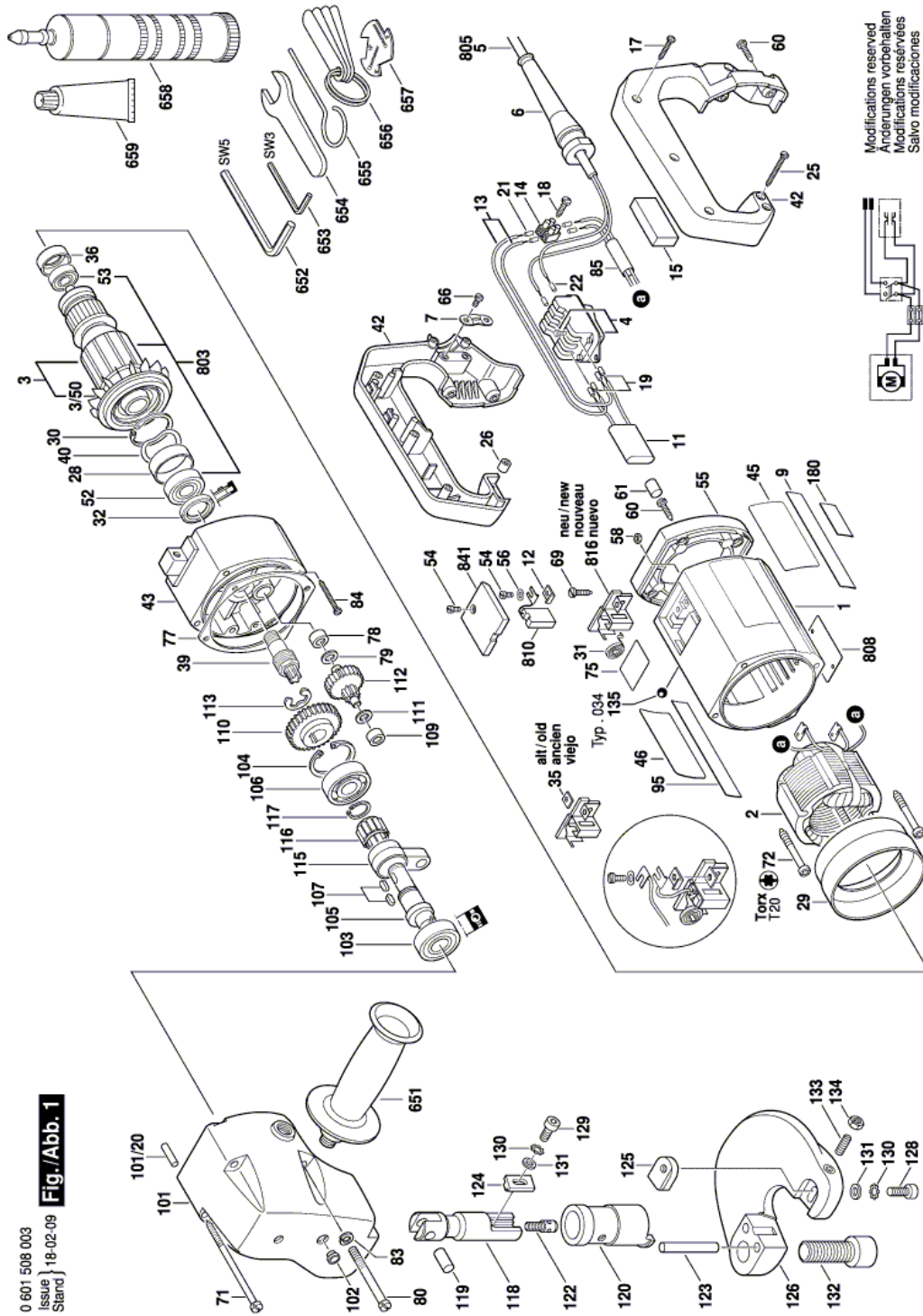
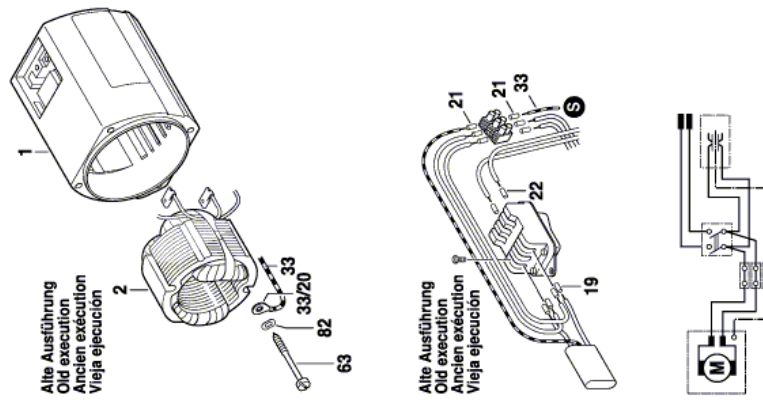

Illustration - Type E

0 601 508 003  
Issue 06-07-26  
Stand

**Fig./Abb. 2**



Modifications reserved  
Änderungen vorbehalten  
Modificaciones reservadas  
Salvo modificaciones

Information subject to change without further notice.