

## Angle Grinder - 0 601 329 039 - 1329

www.powertools-aftersaleservice.com



**BOSCH**

Item	Part Number	Description	Illustration	Price	Quantity	Price Group
	1 3 605 108 145	Motor Housing BLUE	1	-,-	1	32
	2 1 604 220 137	Field 115V	1	-,-	1	40
	3 1 604 010 155	Armature 115V	1	-,-	1	51
	4 1 607 200 064	Switch	1	-,-	1	35
	5 1 614 460 010	Power supply cord USA/CAN/SMA 2,15m 2 x 0,82mm SJ 16/2	1	-,-	1	25
	6 3 600 703 011	Grommet Ø9,2-Ø12x120 MM	1	-,-	1	13
	7 1 601 302 014	Fastening Clamp	1	-,-	1	11
	8 1 601 106 032	Nameplate 26x52 MM	1	-,-	1	13
	9 1 601 110 046	Sticker	1	-,-	2	11
	13 1 601 110 358	Reference Plate CAUTION	1	-,-	1	11
	14 1 601 110 058	Reference Plate DOUBLE INSULATION	1	-,-	1	11
	15 1 605 806 340	Gear Housing	1	-,-	1	43
	16 3 605 132 054	Handle BLACK	1	-,-	1	30
	17 1 605 805 051	Flanged Bearing	1	-,-	1	33
17/02	1 607 000 229	Bearing Flange	1	-,-	1	27
	18 1 600 502 012	Air-Deflector Ring	1	-,-	1	13
	19 1 605 500 129	Sealing cap	1	-,-	2	-
	20 1 601 037 007	Cover Plate	1	-,-	1	11
	21 1 600 306 001	Grommet	1	-,-	1	11
	22 1 600 502 011	Intermediate Ring	1	-,-	1	11
	23 1 602 026 030	Control Lever	1	-,-	1	19
23/01	1 600 205 008	Felt Washer	1	-,-	1	11
	24 1 604 336 017	Brush Holder	1	-,-	2	17
	25 1 601 030 022	Tab Washer	1	-,-	2	11
	26 1 600 150 008	Spring Washer Ø27,5xØ34,8x0,5 MM	1	-,-	1	-
	28 1 601 014 000	Sealing Cord	1	-,-	1	13
	30 1 600 500 022	Spacer Bushing	1	-,-	1	17
	31 1 605 808 054	Bearing cover	1	-,-	1	14
	32 1 603 523 092	Grinding Spindle 5/8"-UNC-2A	1	-,-	1	31
32/02	1 603 523 092	Grinding Spindle 5/8"-UNC-2A	1	-,-	1	31
	34 1 600 102 012	Cover Disc	1	-,-	1	11
	35 1 600 190 023	Shim 0,1 MM THICK	1	-,-	2	14
	35 1 600 190 024	Shim 0,2 MM THICK	1	-,-	1	13

Item	Part Number	Description	Illustration	Price	Quantity	Price Group
39	1 604 652 006	Spiral Spring	1	-,-	2	11
40	2 600 910 001	Needle bearing Ø14 MM	1	-,-	1	16
41/01	1 601 353 003	Terminal lug	1	-,-	1	11
42	1 608 039 008	Storage Ledge	1	-,-	1	17
43	1 600 113 013	Seal	1	-,-	1	11
45	1 600 905 008	Deep-Groove Ball Bearing 15x32x9	1	-,-	1	26
46	2 600 905 032	Deep-Groove Ball Bearing 7x19x6	1	-,-	1	17
47	1 900 905 281	Deep-Groove Ball Bearing 17x40x12	1	-,-	1	33
48	2 910 011 164	Socket head cap screw DIN 84-AM5x25-5.8	1	-,-	1	10
49	2 911 051 382	Hex Screw DIN 933-M 14x16-5.8	1	-,-	1	-
50	2 910 211 006	Tapping Screw DIN 7971-BZ2,9x13	1	-,-	2	10
51	2 910 011 157	Socket head cap screw DIN 84-AM5x15-5.8	1	-,-	4	10
52/01	2 910 011 120	Socket head cap screw DIN 84-AM4x10-5.8	1	-,-	2	10
53	2 910 021 118	Socket head cap screw DIN 84-AM4x8-8.8	1	-,-	4	10
54	2 910 011 162	Socket head cap screw DIN 84-AM5x20-5.8	1	-,-	3	10
55	2 910 211 011	Tapping Screw DIN 7971-BZ3,5x13	1	-,-	2	10
56	1 603 435 005	Tapping Screw B4,8x65 MM	1	-,-	2	11
57	2 910 211 038	Tapping Screw DIN 7971-ST4,8x38-F	1	-,-	4	11
58	3 603 415 560	Thread-forming tap. Screw B 4,8x45 MM	1	-,-	4	11
59	2 915 011 005	Hex Nut DIN 934 -M4-m-8	1	-,-	2	10
60	2 916 011 005	Plain Washer DIN 433-3,2-ST 50	1	-,-	2	10
62	2 916 660 014	Spring retaining ring DIN 472 35x1,5 MM	1	-,-	1	13
64	2 910 021 196	Socket head cap screw DIN 84-AM6x15-8.8	1	-,-	2	10
65	1 600 283 004	Rotary shaft lip seal Ø35x22x6/6,5 MM	1	-,-	3	20
66	2 910 211 009	Tapping Screw DIN 7971-BZ-3,5x6,5	1	-,-	1	-
67	1 601 300 004	Clamp	1	-,-	1	12
68	1 605 703 061	Connecting Flange	1	-,-	1	32
69	2 910 211 021	Tapping Screw DIN 7971-ST3,9x22-F	1	-,-	3	10
70	1 604 652 006	Spiral Spring	1	-,-	2	11
650	1 602 025 022	Auxiliary Handle M14 BLACK	1	-,-	1	26
650	1 602 025 030	Auxiliary Handle M14, Ø37x115 MM BLACK	1	-,-	1	28
651	2 607 950 511	Single-Head Eng. Wrench SW17	N/A	-,-	1	15
800	1 607 014 126	Carbon-Brush Set	1	-,-	1	27
802/04	2 910 091 118	Pan head screw DIN 85-AM4x8-4.8	1	-,-	6	10
803	3 605 132 048	Handle DARK BLUE	1	-,-	1	40
804	1 606 333 168	Crown Gear Z=74	1	-,-	1	44
805	1 607 000 230	Parts Set	1	-,-	1	43
810	1 603 133 000	Round-Head Grooved Pin	1	-,-	2	-
811	1 607 000 065	Seal Kit	N/A	-,-	1	21

Illustration - Type E

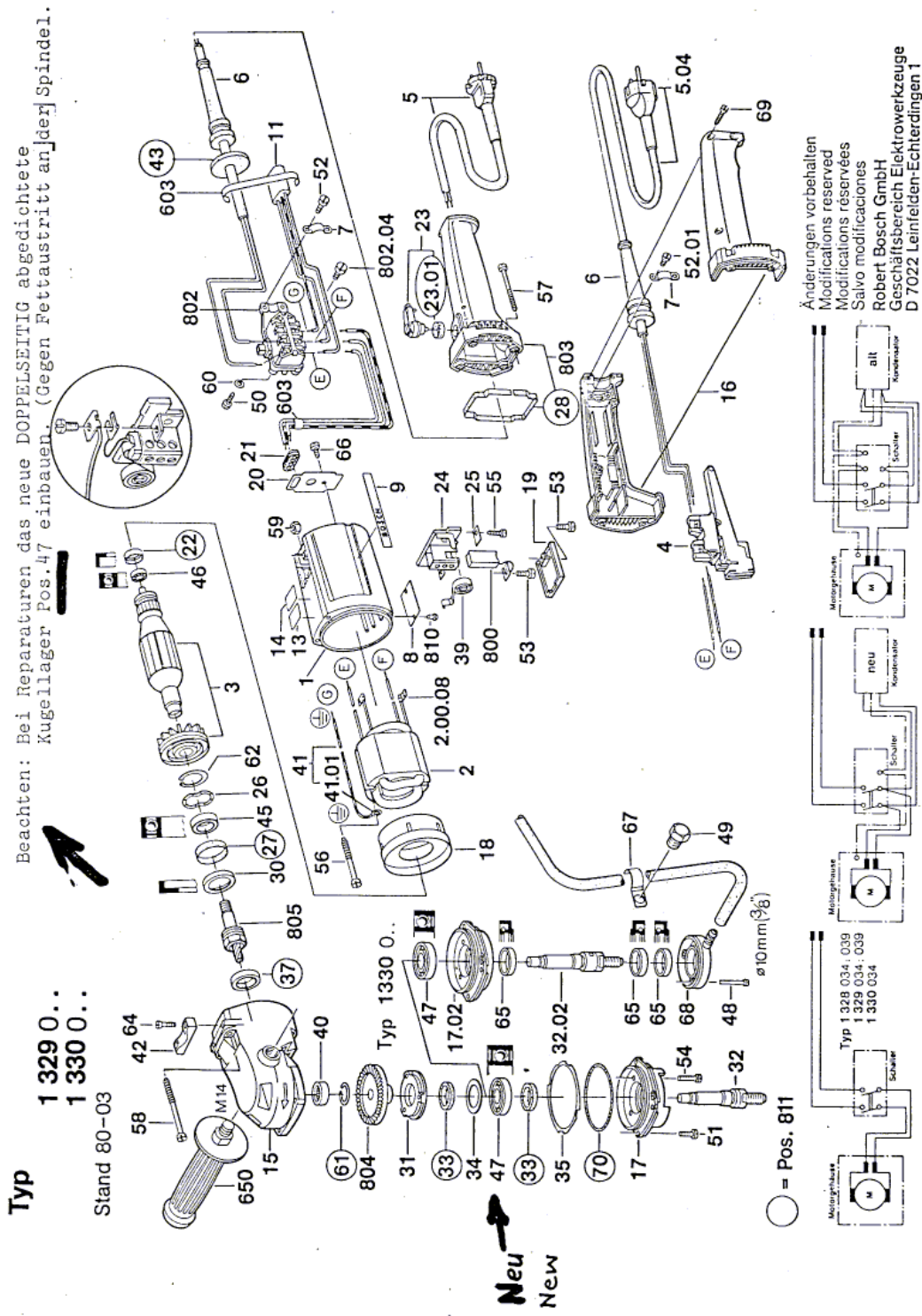

Information subject to change without further notice.