



SERVICE PARTS LIST

BUL. 54-08-2221

1/2" ELECTRIC DRILL

REVISED BUL 6134-2 DATE FEB. '68

Catalog No. 1200-1

Starting Serial No. 134-2469

WIRING INSTR.

Both Model and Serial No. must be furnished to obtain correct parts.

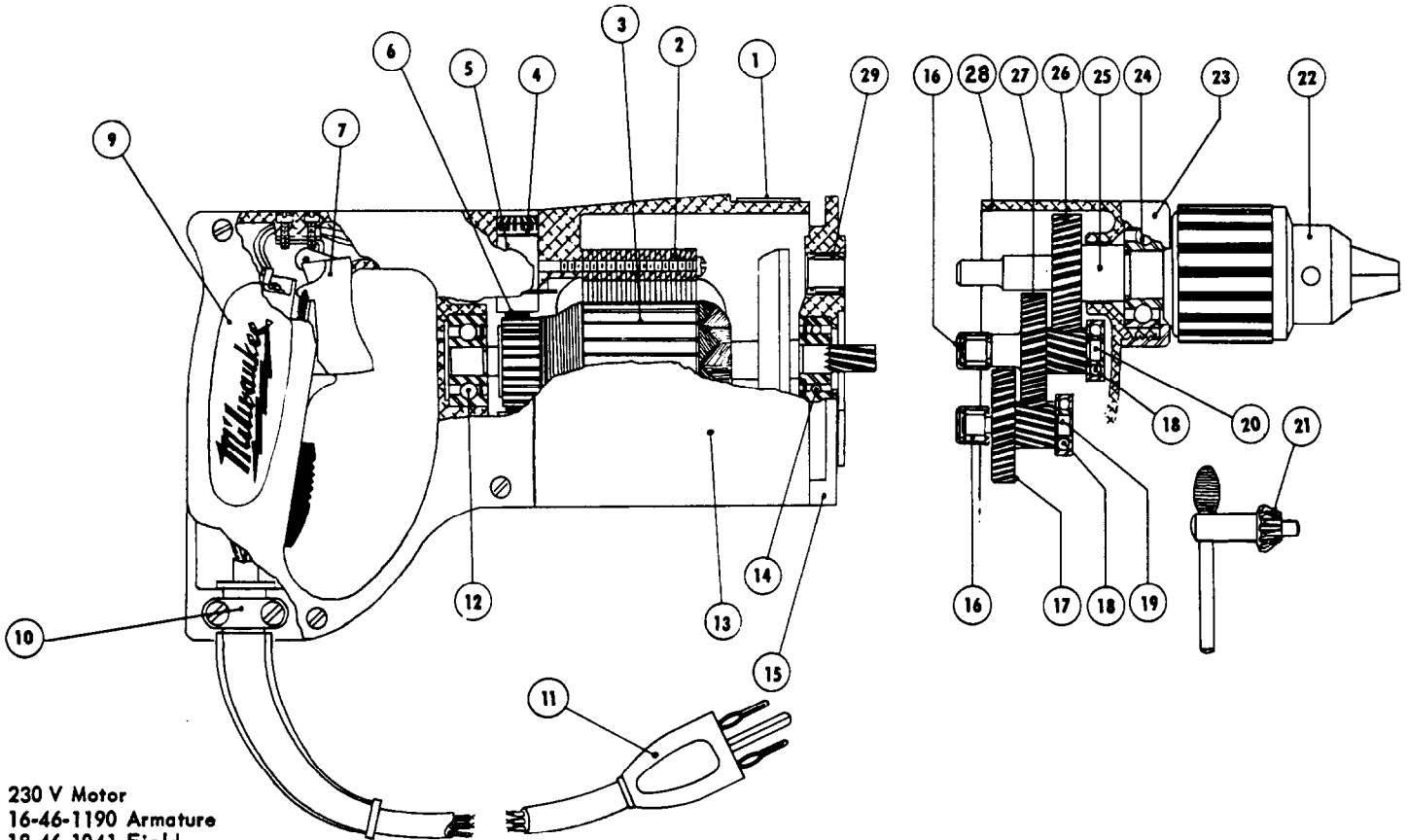

230 V Motor
16-46-1190 Armature
18-46-1041 Field

FIG. PART NO. DESCRIPTION OF PART

1	12-98-0800	Name Plate
2	18-42-1041	Field Assembly
3	16-42-1210	Armature Assembly
4	23-44-0060	Brush Retaining Screw
5	22-22-0080	Brush Holder Assembly
6	22-18-0100	Carbon Brush Assembly
7	23-66-0440	Switch
9	28-20-3141	Handle Cover
10	28-17-0400	Cord Clamp Strap
11	22-64-0170	Cord Set
12	02-04-0970	Ball Bearing (Comm. End)
13	28-50-4488	Motor Housing
14	02-04-0940	Ball Bearing (Pinion End)
15	28-28-0661	Diaphragm
16	02-50-1640	Ball Bearing

ILLUSTRATED PARTS

FIG.	PART NO.	DESCRIPTION OF PART	
17	32-40-1241	Intermediate Gear	
18	02-04-0640	Ball Bearing	
19	36-66-2801	Intermediate Pinion Shaft	
(2)	20	36-66-2401	Intermediate Pinion Shaft
(2)	21	48-66-3280	Chuck Key
(2)	22	48-66-1360	Chuck (1/2-20 Thread 3-Jaw)
23	42-52-0071	Bearing Cap	
24	02-04-1560	Ball Bearing	
25	38-50-3651	Spindle	
26	32-75-1861	Spindle Gear	
27	32-75-2041	Spindle Gear	
28	28-14-0961	Gear Case	
29	02-50-2110	Needle Bearing	

MISCELLANEOUS PARTS NOT SHOWN

PART NO. DESCRIPTION OF PART

43-62-0160	Handle
44-90-0130	Handle Ring
06-42-0800	Woodruff Keys
06-81-8400	4-40x1/4 Rd.Hd. Name Plate Screws
06-81-5790	6-32x1/4 Fil. Hd. Sw. Mtg. Sems
23-86-0110	Brush Holder Insul. Washer

PART NO. DESCRIPTION OF PART

06-81-6150	8-32x1/2" Fil.Hd.Sems	Cord Clamp Strap Screws	(2)	
06-81-8625	6-32x1/4" Rd.Hd. Ground Screw (Brass)			
(3)	06-81-6350	8-32x1 Fil.Hd. Sems	Gear Case Screws	
(2)	06-81-6650	8-32x1 1/4 Fil.Hd. Sems	Gear Case Screws	(2)
(2)	06-81-6600	8-32x1 1/4 Fil.Hd. Sems	Field Screws	(2)
(2)	06-83-2650	1/4-20x3/8 Hd'less	Brush Holder Set Screws	(2)
	06-81-3700	8-32x7/8 Oval. Hd.	Handle Cover Screws	(4)

48-03-0010 Attachment Plug Adaptor

Numbers in brackets indicate number required.