

Universal Rotary Hammer - 0 611 203 034 - ----

www.powertools-aftersaleservice.com



BOSCH

Item	Part Number	Description	Illustration	Price	Quantity	Price Group
1	1 615 102 072	Motor Housing	1	-,-	1	-
2	1 614 220 045	Field 115V	1	-,-	1	41
2/10	1 901 350 003	Terminal lug 1,5-4x4	N/A	-,-	2	10
2/20	1 610 452 003	End Splice Ø1,3xØ1,6x10 MM	N/A	-,-	2	11
3	1 610 205 000	Seal Ring	1	-,-	1	-
4	1 610 910 052	Needle-Roller Bearing	1	-,-	1	30
5	1 614 011 029	Armature 115V	1	-,-	1	50
6	1 615 805 045	Flanged Bearing	1	-,-	1	42
7	1 610 905 000	groove ball bearing	1	-,-	1	24
8	1 611 038 015	Intermediate Plate	1	-,-	1	21
9	1 616 610 044	Fan	1	-,-	1	-
10	1 615 500 123	Housing Cover	1	-,-	1	22
12	1 614 652 000	Spiral Spring	1	-,-	2	12
13	3 615 500 502	Sealing cap	1	-,-	2	15
16	1 615 820 050	Bearing Housing	1	-,-	1	-
17	1 610 910 051	Needle bearing Ø35xØ42x12 MM	1	-,-	2	20
19	1 610 910 048	Needle bearing	1	-,-	1	28
20	1 616 110 019	Eccentric Shaft Z=47	1	-,-	1	46
20/10	1 613 100 007	Bearing bolt	N/A	-,-	1	19
21	1 616 317 013	Cylindrical Gear Z=18	1	-,-	1	32
22	1 610 300 043	Bushing	1	-,-	1	24
23	1 615 806 017	Gear Housing	1	-,-	1	45
24	1 612 317 003	Guide Rail	1	-,-	2	31
26	1 618 700 033	Hammer Piston	1	-,-	1	50
27	1 618 710 030	Striker	1	-,-	1	41
30	1 610 322 004	Spacer Bushing	1	-,-	1	38
31	1 610 114 012	Supporting Disc	1	-,-	1	23
33	1 618 598 062	Bit holder	1	-,-	1	43
34	1 610 224 001	Retaining snap ring	1	-,-	1	11
40	1 615 500 194	Sealing cap	1	-,-	1	19
41	1 615 133 019	Handle	1	-,-	1	40
42	2 100 102 016	Shim Ø32xØ25x0,3 MM	1	-,-	1	-
43	1 617 200 017	On-Off Switch	1	-,-	1	33

Item	Part Number	Description	Illustration	Price	Quantity	Price Group
43/10	2 603 410 001	Socket head cap screw M3x6,5-4.8	1	-,-	2	11
44/10	1 610 452 003	End Splice Ø1,3xØ1,6x10 MM	1	-,-	4	11
45	1 610 920 000	Thrust Needle Rim	1	-,-	1	16
46	1 610 102 015	Thrust Bearing Disc 1,0 MM THICK	1	-,-	1	14
47	1 604 460 092	Power supply cord USA/CDN 2,15m 2 x 2,08mm SJ 14/2	1	-,-	1	28
47/10	1 610 452 003	End Splice Ø1,3xØ1,6x10 MM	N/A	-,-	2	11
47/20	1 901 350 003	Terminal lug 1,5-4x4	N/A	-,-	1	10
48	1 600 703 009	Grommet Ø11,5-Ø15,0x150 MM	1	-,-	1	16
48	3 600 703 011	Grommet Ø9,2-Ø12x120 MM	1	-,-	1	13
49	1 601 302 013	Fastening Clamp	1	-,-	1	11
50	1 611 091 004	Rubber Buffer	1	-,-	1	-
51	1 601 110 058	Reference Plate DOUBLE INSULATION	N/A	-,-	1	11
52	1 601 11A 3H3	Nameplate	N/A	-,-	1	13
54	1 610 501 031	Sealing cap	1	-,-	1	-
56	1 600 210 010	O-Ring 35,0x1,5 MM	1	-,-	1	11
56	2 916 603 012	Retaining ring 22 DIN 9045	1	-,-	1	-
57	1 600 102 623	Plain Washer 1,0 MM THICK	1	-,-	1	11
58	1 600 150 006	Spring Washer DIN 137-A4	1	-,-	2	17
58	1 611 331 007	Tab Washer	1	-,-	2	11
59	1 610 210 015	O-Ring 28,0x6,0 MM	1	-,-	1	13
61	1 602 381 001	Insulating Strip 33x10x6 MM	1	-,-	1	11
62	2 916 660 011	Spring retaining ring DIN 472-28x1,2 MM	1	-,-	1	11
63	2 916 680 006	Spring Lock Washer DIN 127-B 5	1	-,-	2	10
64	2 917 721 035	Round-Head Grooved Pin DIN 1476-2x8-ST	1	-,-	2	10
65	2 916 600 014	Retaining ring 26 DIN 9045	1	-,-	1	11
66	1 611 015 006	Sealing Plate	1	-,-	1	14
67	1 611 015 007	Sealing Plate	1	-,-	1	15
68	1 611 015 015	Sealing Plate 1,5 MM	1	-,-	1	12
70	2 915 061 005	Hex Nut DIN 985-M8-8	1	-,-	1	13
74	2 910 021 116	Socket head cap screw DIN 84-AM4x6-8.8	1	-,-	2	11
74	2 910 211 018	Tapping Screw DIN 7971-ST3,9x13-F	1	-,-	2	10
74	2 910 021 118	Socket head cap screw DIN 84-AM4x8-8.8	1	-,-	2	10
75	2 910 011 120	Socket head cap screw DIN 84-AM4x10-5.8	1	-,-	2	10
77	2 910 021 174	Socket head cap screw DIN 84-BM5x50-8.8	1	-,-	2	10
80	3 603 414 028	Hex Socket Head Cap Screw	1	-,-	4	11
80	1 613 414 005	Hex Socket Head Cap Screw M5x20 MM	1	-,-	4	-
82	2 910 151 164	Hex Socket Head Cap Screw M5x25 DIN 912-10.9	1	-,-	10	11
83	1 617 000 120	Parts Set 2 PIECE	1	-,-	1	14
84	1 617 000 121	Hex Socket Head Cap Screw	1	-,-	4	-
85	2 910 211 007	Tapping Screw DIN 7971-BZ2,9x16	1	-,-	1	11
86	2 910 601 118	Tapping Screw DIN 7972-B3,9x13	1	-,-	2	10
87	2 910 211 011	Tapping Screw DIN 7971-BZ3,5x13	1	-,-	1	10
88	2 910 211 021	Tapping Screw DIN 7971-ST3,9x22-F	1	-,-	3	10
89	1 616 309 006	Cylindrical Gear Z=43	1	-,-	1	-
91	1 616 490 004	Kick-Out Coupling	1	-,-	1	52
92	1 900 210 125	O-Ring 25x2,5 MM	1	-,-	2	16
94	1 903 230 009	Ball DIN 5401-5 G28	1	-,-	20	10
95	1 616 490 004	Kick-Out Coupling	1	-,-	1	52
97	1 616 432 004	Coupling Half	1	-,-	1	36
98	1 614 612 001	Compression Spring	1	-,-	2	11
99	1 614 437 007	Connecting Cable L=230 MM	1	-,-	2	14
99/10	1 610 452 003	End Splice Ø1,3xØ1,6x10 MM	N/A	-,-	2	11

Item	Part Number	Description	Illustration	Price	Quantity	Price Group
103	2 910 141 199	Hex Socket Head Cap Screw DIN 912-M6x18-8.8	1	-,-	4	15
103	1 613 414 005	Hex Socket Head Cap Screw M5x20 MM	1	-,-	1	-
106	1 611 110 194	Manufacturer's nameplate	1	-,-	2	-
106	1 601 110 481	Manufacturer's nameplate SHADOW SIDE	1	-,-	1	12
106	1 611 110 468	Manufacturer's nameplate	1	-,-	1	14
650	1 613 001 003	Depth-Gauge SW 6x330 MM	2	-,-	1	-
651	1 615 438 142	Carrying Case	2	-,-	1	-
651	1 615 438 065	Carrying Case	2	-,-	1	-
654	2 607 950 004	Offset Screwdriver DIN 911-4	N/A	-,-	1	11
654	1 907 950 006	Offset Screwdriver DIN 911-SW5 BLACK	N/A	-,-	1	16
700	2 600 508 018	Sealing cap	N/A	-,-	1	13
701	1 618 598 006	Bit holder	N/A	-,-	1	-
800	1 617 000 022	Parts Set	1	-,-	1	-
801	1 616 490 004	Kick-Out Coupling	1	-,-	1	52
805	1 617 000 018	Wear and Tear Part Set	2	-,-	1	33
806	1 617 000 016	Tool Holder Set	1	-,-	1	52
807	1 617 000 014	Locking Bolt Set	1	-,-	1	33
808	1 617 014 110	Carbon-Brush Set	1	-,-	1	28
809	1 617 010 004	Parts Set	1	-,-	1	24
810	1 616 333 001	Bevel Gear Z=29	1	-,-	1	42
811	1 616 333 004	Toothed Shaft Z=8	1	-,-	1	40
813	1 617 000 018	Wear and Tear Part Set	N/A	-,-	1	33

Illustration - Type E

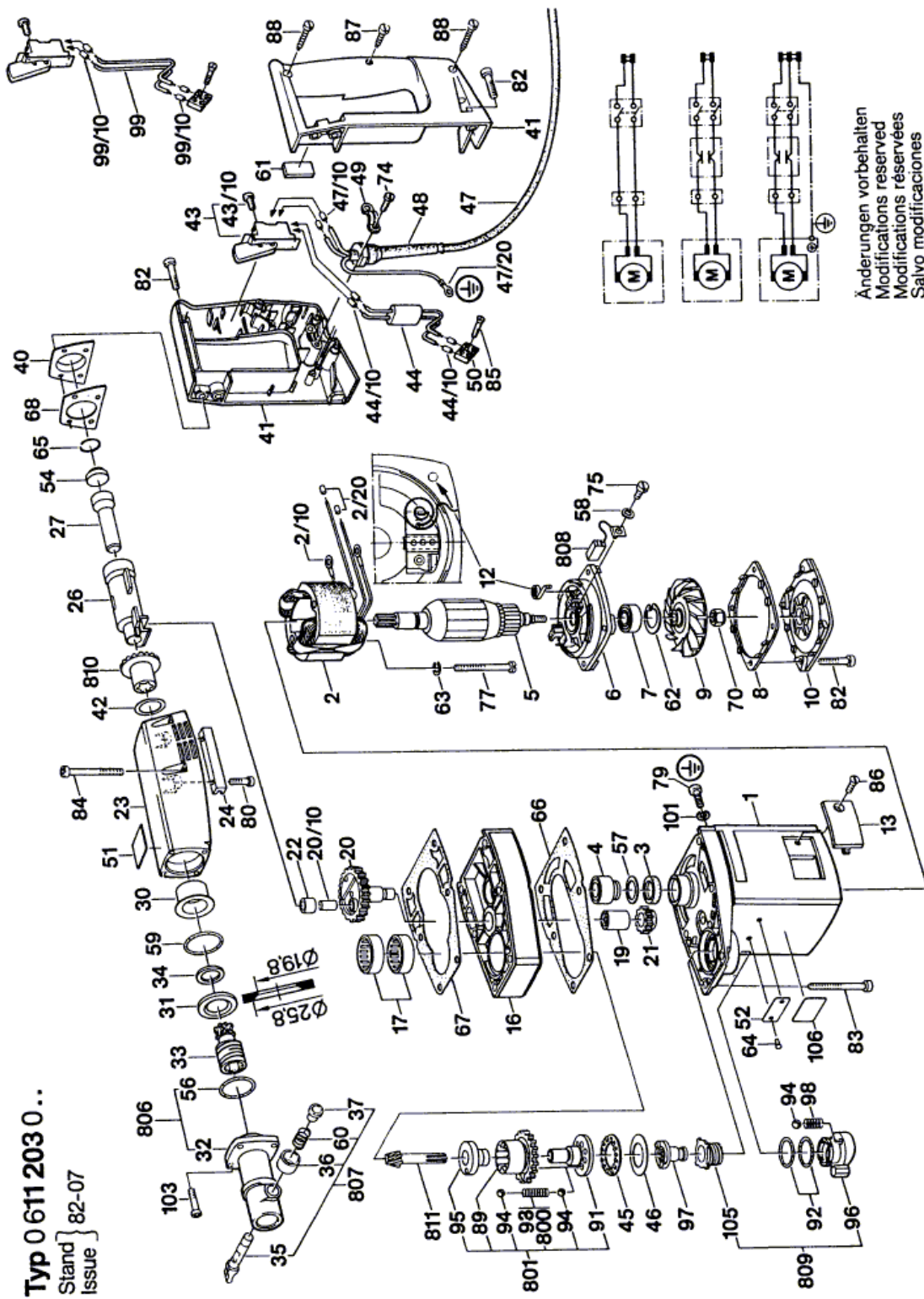
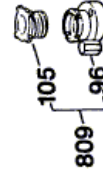
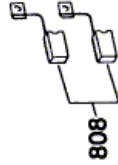
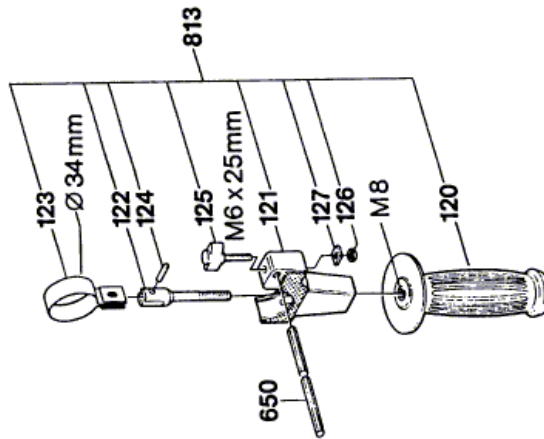
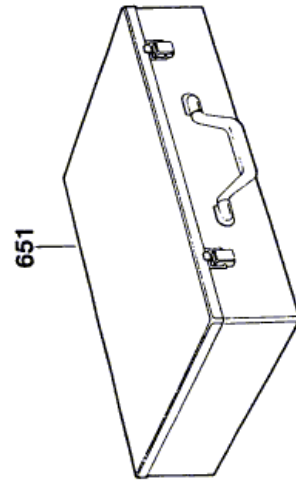
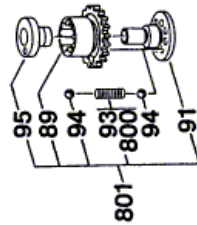
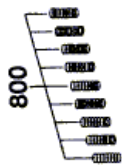
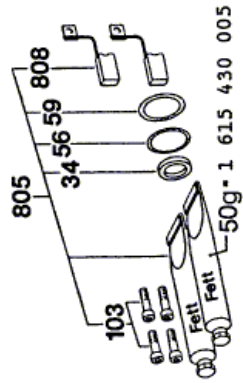

Illustration - Type E

Typ 0 611 203 0 ..
 Stand } 82-07
 Issue }



Änderungen vorbehalten
 Modifications reserved
 Modifications réservées
 Salvo modificaciones
Robert Bosch GmbH
Geschäftsbereich Elektrowerkzeuge
D 7022 Leinfelden-Echterdingen 1