



SERVICE PARTS LIST

BUL. 54-08-2124

1/2" ELECTRIC DRILL

REVISED BUL 6133-5 DATE FEB. '68

Catalog No. 1100-1

Starting Serial No. 133-16795

WIRING INSTR.

Both Model and Serial No. must be furnished to obtain correct parts.

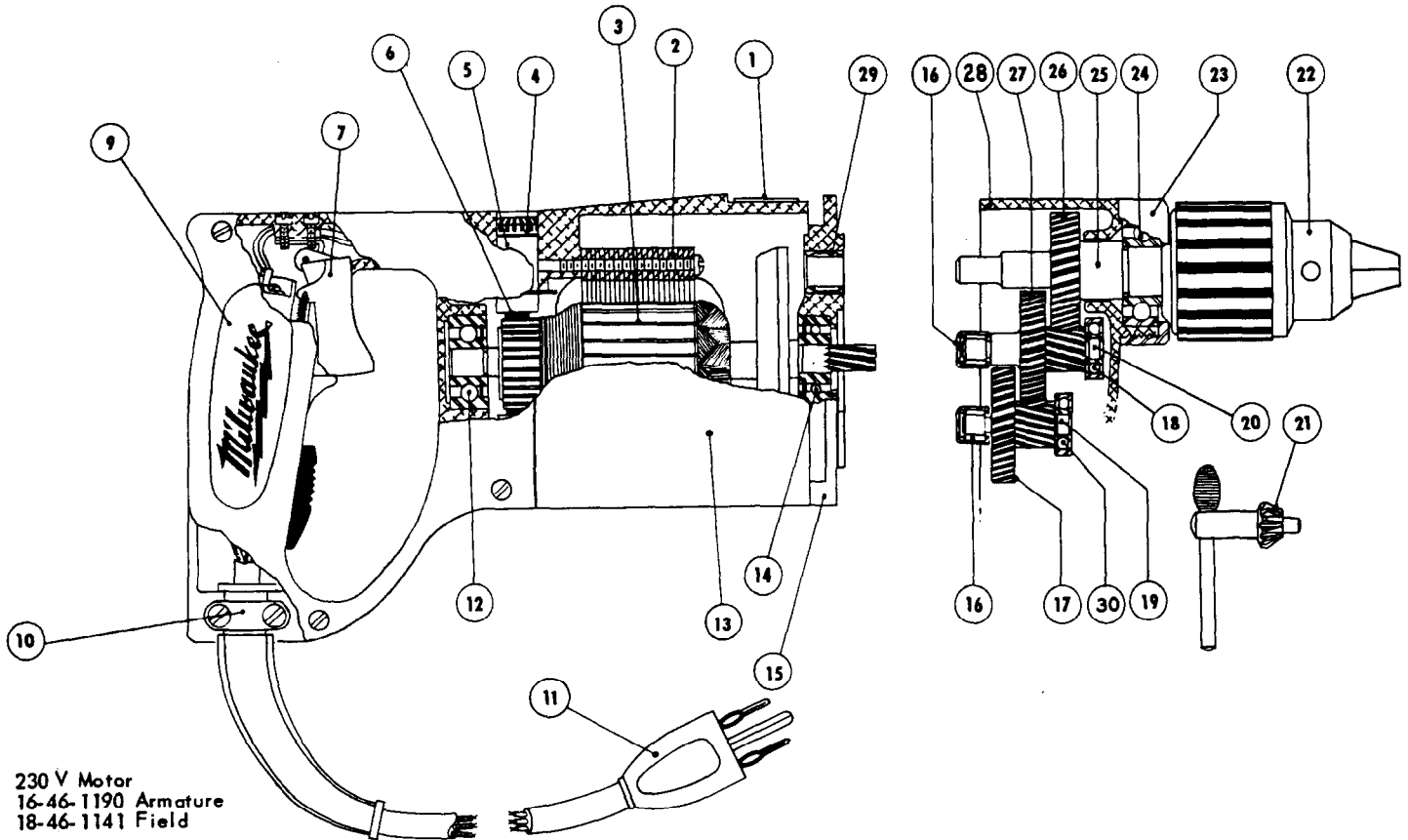

230 V Motor
16-46-1190 Armature
18-46-1141 Field

ILLUSTRATED PARTS

FIG.	PART NO.	DESCRIPTION OF PART
1	12-98-0800	Name Plate
2	18-42-1141	Field Assembly
3	16-42-1210	Armature Assembly
4	23-44-0060	Brush Retaining Screw
5	22-22-0080	Brush Holder Assembly
6	22-18-0100	Carbon Brush Assembly
★ 7	23-66-0440	Switch
9	28-20-3601	Handle Cover
10	28-17-0400	Cord Clamp Strap
11	22-64-0170	Cord Set
12	02-04-0970	Ball Brg. (Comm. End)
13	28-50-4488	Motor Housing
14	02-04-0940	Ball Brg. (Pinion End)
15	28-28-0661	Diaphragm

NO.REQ.	FIG.	PART NO.	DESCRIPTION OF PART
	16	02-50-1640	Needle Bearing
	17	32-40-1241	Intermediate Gear
	18	02-04-0820	Ball Bearing
(2)	19	36-66-2801	Intermediate Pinion Shaft
(2)	20	36-66-4001	Intermediate Pinion Shaft
(2)	21	48-66-3280	Chuck Key
	22	48-66-1360	Chuck (1/2-20 Thread 3 Jaw)
	23	42-52-0071	Bearing Cap
	24	02-04-1560	Ball Bearing
	25	38-50-3651	Spindle
	26	32-75-2061	Spindle Gear
	27	32-75-2041	Spindle Gear
	28	28-14-1261	Gear Case
	29	02-50-2110	Needle Bearing
	30	02-04-0640	Ball Bearing

MISCELLANEOUS PARTS NOT SHOWN

PART NO.	DESCRIPTION OF PART	NO.REQ.	PART NO.	DESCRIPTION OF PART	NO.REQ.
45-36-0210	Spacer		06-75-3150	1/4-20x1L.H. Allen Hd. Cap Rev. Chuck Scr.	
43-62-0160	Handle		06-81-6150	Cord Clamp Strap Screws 8-32x1/2" Fil. Hd.	(2)
44-90-0130	Handle Ring		06-81-8625	Ground Screw (Brass) 6-32x 1/4" Rd. Hd.	
06-42-0800	Woodruff Keys	(3)	06-81-6350	Gear Case Screws (Sem) 8-32 x 1" Fil. Hd.	(2)
06-81-8400	4-40 x 1/4 Rd. Hd. Name Plate Screws	(2)	06-81-6650	Gear Case Screws 8-32 x 1-3/4" Fil. Hd.	(2)
06-81-5790	6-32 x 1/4 Fil. Hd. Sw. Mtg. Sems	(2)	06-83-2650	1/4-20 x 3/8 Hd'less Brush Holder Set Scs.	(2)
23-86-0110	Brush Holder Insul. Washer	(2)	06-81-3700	8-32x 7/8 Oval Hd. Handle Cover Screws	(4)
48-03-0010	Attachment Plug Adaptor		06-81-6600	8-32 x 1-3/4" Fil. Hd. Field Screws (Sem)	(2)
			23-16-0340	Switch Insulator	